



Chipsmall Limited consists of a professional team with an average of over 10 year of expertise in the distribution of electronic components. Based in Hongkong, we have already established firm and mutual-benefit business relationships with customers from,Europe,America and south Asia,supplying obsolete and hard-to-find components to meet their specific needs.

With the principle of “Quality Parts,Customers Priority,Honest Operation,and Considerate Service”,our business mainly focus on the distribution of electronic components. Line cards we deal with include Microchip,ALPS,ROHM,Xilinx,Pulse,ON,Everlight and Freescale. Main products comprise IC,Modules,Potentiometer,IC Socket,Relay,Connector.Our parts cover such applications as commercial,industrial, and automotives areas.

We are looking forward to setting up business relationship with you and hope to provide you with the best service and solution. Let us make a better world for our industry!



Contact us

Tel: +86-755-8981 8866 Fax: +86-755-8427 6832

Email & Skype: info@chipsmall.com Web: www.chipsmall.com

Address: A1208, Overseas Decoration Building, #122 Zhenhua RD., Futian, Shenzhen, China



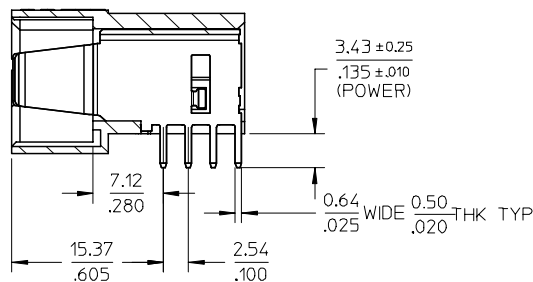
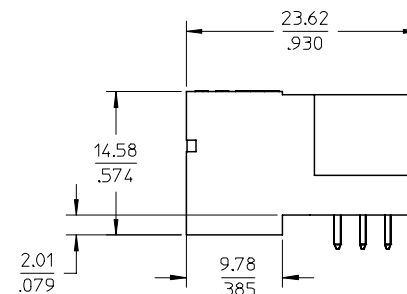
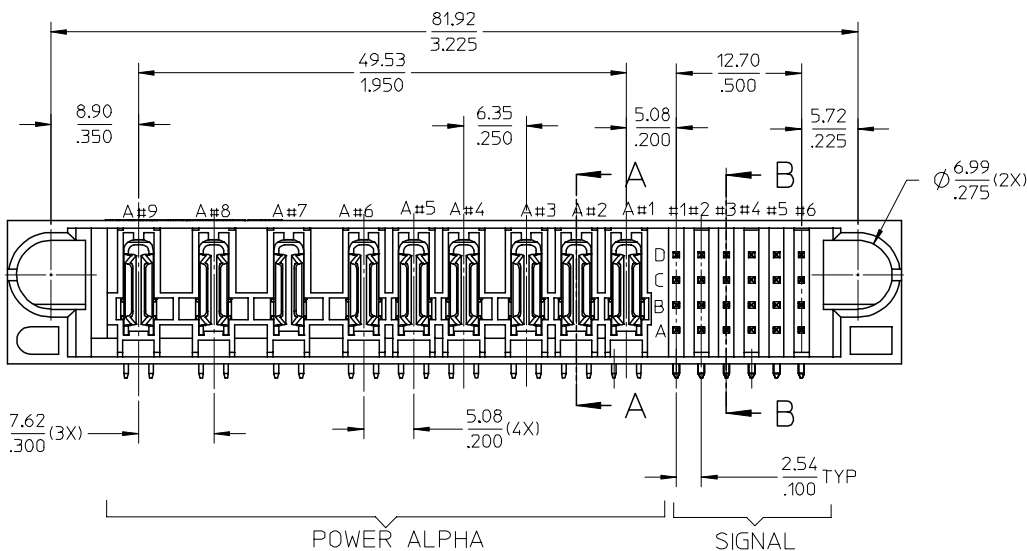
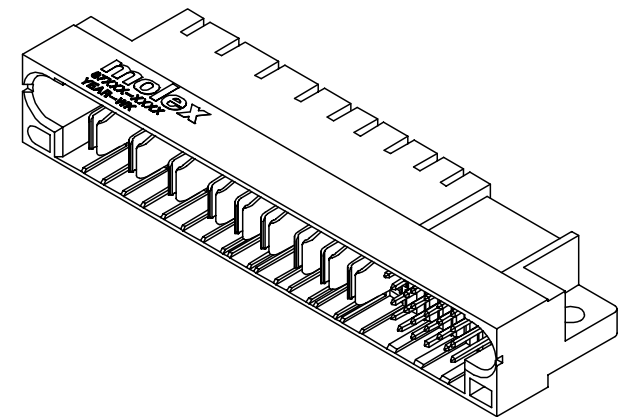
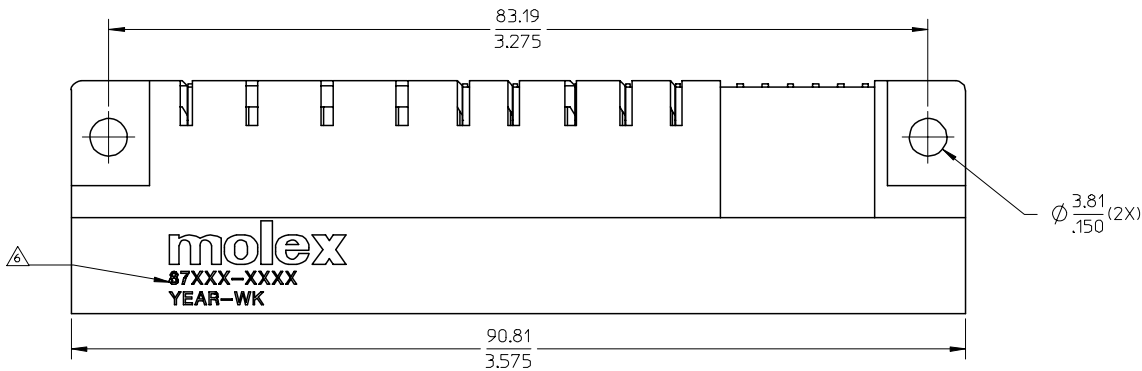

SECTION A-A

PDR#S-001553-00-00	2007/03/29
EC NO: S2007-0840	2007/03/29
DRWN:GEMENARLY	2007/03/29
CHKD:SKANG	2007/03/30
APPR:MLONG	2007/03/30
REV	DESCRIPTION
B2	

QUALITY SYMBOLS	▽=0
	▽=0

GENERAL TOLERANCES (UNLESS SPECIFIED)	mm	INCH
4 PLACES	± ---	± ---
3 PLACES	± ---	± .010
2 PLACES	± 0.25	± ---
1 PLACE	± ---	± ---
ANGULAR ± 3 °		
DRAFT WHERE APPLICABLE MUST REMAIN WITHIN DIMENSIONS		

DIMENSION STYLE		MM/IN
DRAWN BY	DATE	TITLE
BHLOW	2004/07/16	HEADER, 5.08MM P-S CONFIG., MULTI CTRS. R/A, T/H, S/M
CHECKED BY	DATE	
KCLING	2004/08/16	MOLEX INCORPORATED
APPROVED BY	DATE	
SCLOW	2004/08/16	DOCUMENT NO.
MATERIAL NO.		SD-87874-010
SIZE		SHEET NO.
A3		1 OF 2

SCALE	DESIGN UNITS	THIRD ANGLE PROJECTION
NTS	METRIC	
MOLEX INCORPORATED		
SD-87874-010		
THIS DRAWING CONTAINS INFORMATION THAT IS PROPRIETARY TO MOLEX INCORPORATED AND SHOULD NOT BE USED WITHOUT WRITTEN PERMISSION		

PART NUMBER	S-P CONFIGURATION		STD SIGNAL PIN LENGTH	RECESSED SIGNAL PIN		VOID PIN LOCATION	PLATING OPTION	PACKAGING
	POWER ALPHA	SIGNAL		LENGTH	LOCATION			
87874-2001	9	24	6.86/270	5.59/220	A1,A5,B1,B2, C1,C2,D2	NIL	TIN	TRAY
87874-2002					B3			
87874-2003					A1-A5, B2-B6 C2-C6, D1-D6			
87874-2004					A5,B5,B6,C5,C6 D2,D6			

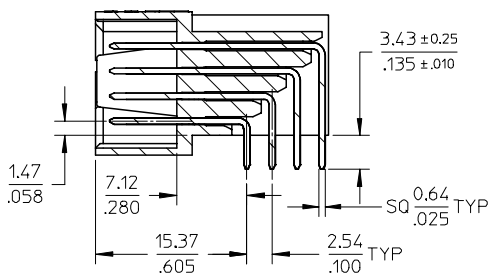

SECTION B-B

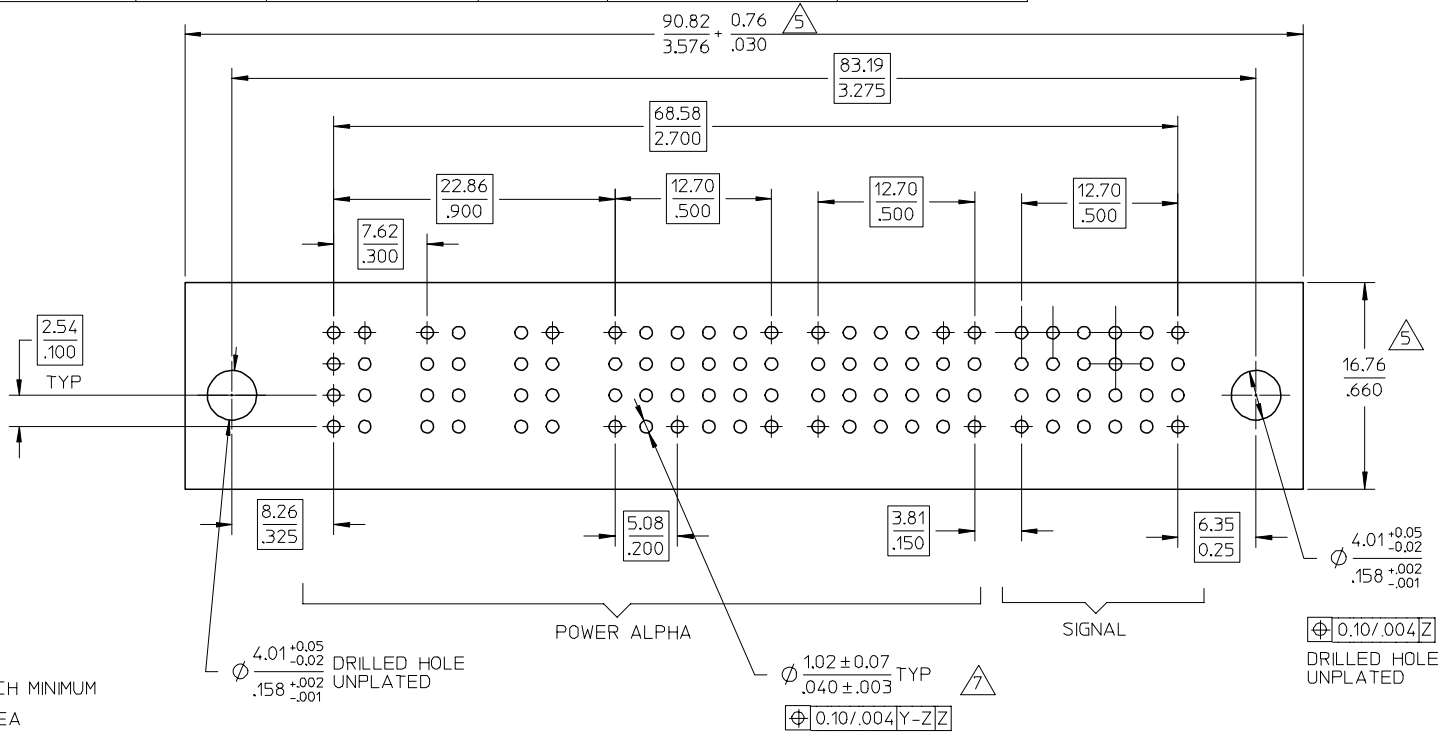

- NOTES:
- MATERIALS: HOUSING TEMPERATURE, LCP
GLASS FILLED, UL94V-0, COLOUR: BLACK
POWER PINS - COPPER ALLOY
SIGNAL PINS - COPPER ALLOY
BOARDLOCK - COPPER ALLOY
 - FINISHES: POWER & SIGNAL PINS:
SELECTIVE GOLD IN CONTACT AREA.
THICKNESS= 0.76 MICROMETER/ 30 MICROINCH MINIMUM
SELECTIVE TIN ALLOY IN THE PC TAIL AREA
THICKNESS= 2.54 MICROMETER/100 MICROINCH MINIMUM
NICKEL OVERALL.
 - PRODUCT SPECIFICATION: PS-87805-006.
 - SEE SHEET 2 FOR RECOMMENDED PCB LAYOUT AND THICKNESS.
5. COMPONENT STAY AWAY ZONE FROM CONNECTOR.
6. MANUFACTURER LOGO, PART NUMBER AND YEAR-WEEK CODE.
7. PCB NOTE FOR DIAMETER 1.02/.040 PLATED HOLE.
- DRILLED HOLE SIZE IS 1.151/.0453.
- PLATED WITH 0.007/.0003 MINIMUM TIN OVER 0.03/.001
TO 0.08/.003 COPPER PLATING TO ACHIEVE 1.02±0.08/.040±.003 HOLE.

PDR#S-001553-00-00 EC NO: S2007-0840 DRWG:GEMENARLY 2007/03/29 CHKD:SKANG 2007/03/29 APPR:MLONG 2007/03/30	QUALITY SYMBOLS ▽=0 ▽=0	GENERAL TOLERANCES (UNLESS SPECIFIED)		DIMENSION STYLE		SCALE	DESIGN UNITS	THIRD ANGLE PROJECTION		
				MM/IN		NTS	METRIC			
						DRAWN BY DATE		TITLE		MOLEX INCORPORATED SD-87874-010
						CHECKED BY DATE				
				APPROVED BY DATE				SHEET NO.		
				MATERIAL NO.		DOCUMENT NO.		2 OF 2		
				DRAFT WHERE APPLICABLE MUST REMAIN WITHIN DIMENSIONS		SEE TABLE				
				SIZE						
				A3						