



Chipsmall Limited consists of a professional team with an average of over 10 year of expertise in the distribution of electronic components. Based in Hongkong, we have already established firm and mutual-benefit business relationships with customers from,Europe,America and south Asia,supplying obsolete and hard-to-find components to meet their specific needs.

With the principle of "Quality Parts,Customers Priority,Honest Operation,and Considerate Service",our business mainly focus on the distribution of electronic components. Line cards we deal with include Microchip,ALPS,ROHM,Xilinx,Pulse,ON,Everlight and Freescale. Main products comprise IC,Modules,Potentiometer,IC Socket,Relay,Connector.Our parts cover such applications as commercial,industrial, and automotives areas.

We are looking forward to setting up business relationship with you and hope to provide you with the best service and solution. Let us make a better world for our industry!



Contact us

Tel: +86-755-8981 8866 Fax: +86-755-8427 6832

Email & Skype: info@chipsmall.com Web: www.chipsmall.com

Address: A1208, Overseas Decoration Building, #122 Zhenhua RD., Futian, Shenzhen, China



10 9 8 7 6 5 4 3 2 1

Part Number	CKT SIZE	VOID POSITION	DIMENSION						PACKING TYPE
			A	B	M	H	T	F	
87951-0001	8	-----	19.90	17.50	10.00	10.30	3.50	23.80	TRAY
87951-0002	8	-----	19.90	17.50	10.00	15.30	3.50	28.80	TRAY

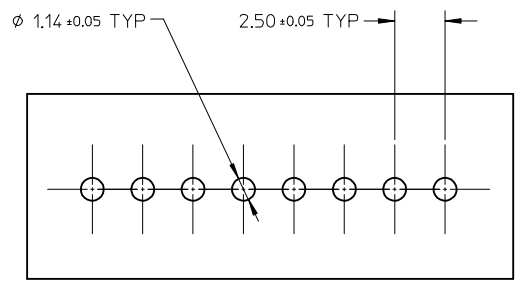
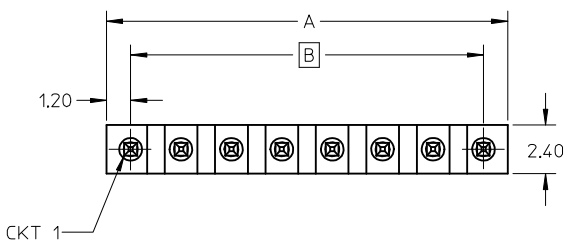

RECOMMENDED P.C.B. HOLE LAYOUT

NOTE:

1. WAFER TO BE FLAT WITHIN 0.003in/in or mm/mm.
2. MATERIAL: HSG: PA66, GLASS FILLED, UL-94V-2, COLOR: NATURAL. PIN: COPPER ALLOY
3. PLATING FINISH: 100μNCHES MIN TIN OVER 50μNCHES MIN NICKEL UNDERPLATE OVERALL.
4. PIN PUSHOUT FORCE: 1KG MIN. IN EITHER DIRECTION.
5. HEADER MAY BE BROKEN TO DESIRE CKT SIZE, SLIGHTLY FLASHES SHOULD BE ACCEPTED.
6. PARTS TO BE PACKED IN TRAY.

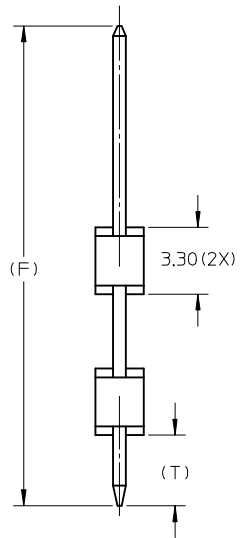
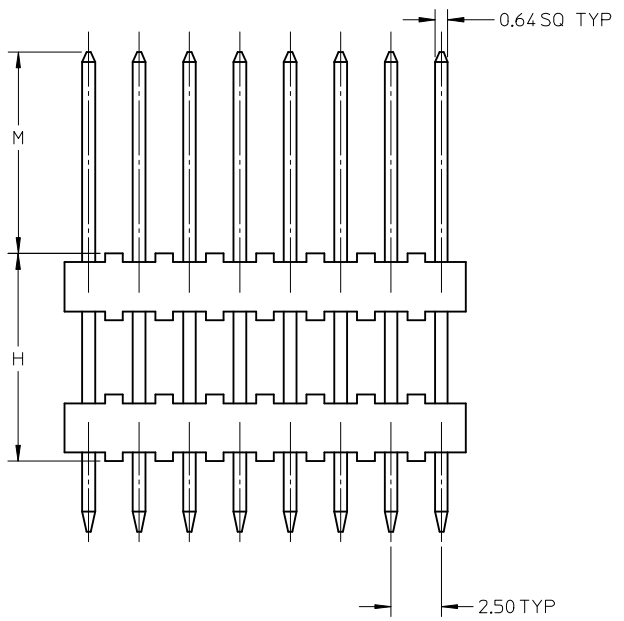

EC NO: S2005-1060 2005/07/22 DRWN:KCHO 2005/07/22 CHKD:RAOVLN 2005/07/25 APPR:PTLIJ	DESCRIPTION REV	QUALITY SYMBOLS	GENERAL TOLERANCES (UNLESS SPECIFIED)	DIMENSION STYLE	SCALE	DESIGN UNITS	THIRD ANGLE PROJECTION	
		▼=0 Ⓢ=0	mm INCH 4 PLACES ± --- ± --- 3 PLACES ± --- ± --- 2 PLACES ± 0.25 ± --- 1 PLACE ± --- ± --- ANGULAR ± 3 °	MM ONLY	NTS	METRIC		
			DRAFT WHERE APPLICABLE MUST REMAIN WITHIN DIMENSIONS	DRAWN BY: YLQ1A0 CHECKED BY: KMG0H APPROVED BY: SCL0W DATE: 2004/10/20 DATE: 2004/10/26 DATE: 2004/10/26	TITLE	SALES DRAWING SINGLE ROW DUAL WAFER 2.50MM PITCH, T/H		
		A1		MATERIAL NO. SEE TABLE SIZE A3 THIS DRAWING CONTAINS INFORMATION THAT IS PROPRIETARY TO MOLEX INCORPORATED AND SHOULD NOT BE USED WITHOUT WRITTEN PERMISSION	MOLEX INCORPORATED DOCUMENT NO. SD-87951-001 SHEET NO. 1 OF 1			

9 8 7 6 5 4 3 2 1