



Chipsmall Limited consists of a professional team with an average of over 10 year of expertise in the distribution of electronic components. Based in Hongkong, we have already established firm and mutual-benefit business relationships with customers from,Europe,America and south Asia,supplying obsolete and hard-to-find components to meet their specific needs.

With the principle of “Quality Parts,Customers Priority,Honest Operation,and Considerate Service”,our business mainly focus on the distribution of electronic components. Line cards we deal with include Microchip,ALPS,ROHM,Xilinx,Pulse,ON,Everlight and Freescale. Main products comprise IC,Modules,Potentiometer,IC Socket,Relay,Connector.Our parts cover such applications as commercial,industrial, and automotives areas.

We are looking forward to setting up business relationship with you and hope to provide you with the best service and solution. Let us make a better world for our industry!



Contact us

Tel: +86-755-8981 8866 Fax: +86-755-8427 6832

Email & Skype: info@chipsmall.com Web: www.chipsmall.com

Address: A1208, Overseas Decoration Building, #122 Zhenhua RD., Futian, Shenzhen, China



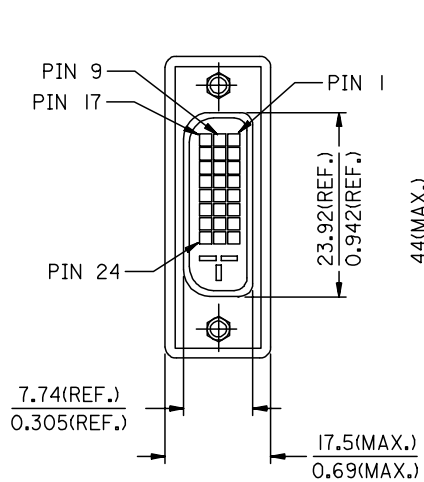

DVI-D(F)

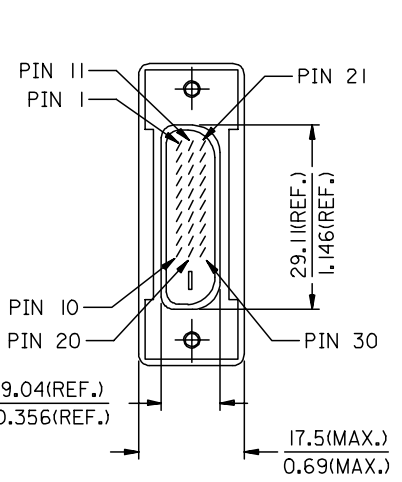
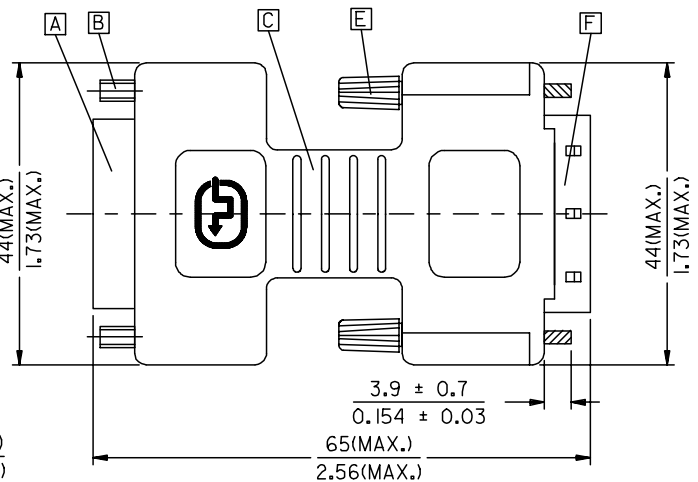

P&D-D(M)

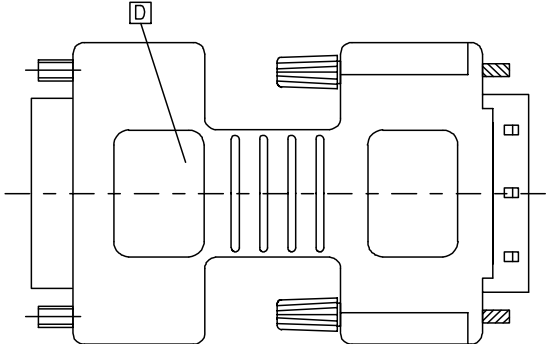

BACK SIDE

ENTER DESCRIPTION EC NO: DG2006-0186 DRWN:PDAI CHKD: APPR:TKAN	2006/03/09 2006/03/09 2006/03/10	QUALITY SYMBOLS ▽=0 ◻=0	GENERAL TOLERANCES (UNLESS SPECIFIED)		DIMENSION STYLE MM/IN		SCALE ---	DESIGN UNITS METRIC	THIRD ANGLE PROJECTION			
	DESCRIPTION		mm	INCH	DRAWN BY	DATE	TITLE					
	REV		4 PLACES	± ---	± ---	PDAI	2006/03/07	DVI_D(F)-P&D(M) ADAPTER				
			3 PLACES	± ---	± ---	CHECKED BY	DATE	MOLEX INCORPORATED				
			2 PLACES	± ---	± ---	ZXDENG	2006/03/07					
	1 PLACE	± ---	± ---	APPROVED BY	DATE	MATERIAL NO.	DOCUMENT NO.	SHEET NO.				
		ANGULAR ± ---°		BORON	2006/03/07	88741-9200	SD-88741-013	1 OF 2				
DRAFT WHERE APPLICABLE MUST REMAIN WITHIN DIMENSIONS			THIS DRAWING CONTAINS INFORMATION THAT IS PROPRIETARY TO MOLEX INCORPORATED AND SHOULD NOT BE USED WITHOUT WRITTEN PERMISSION									

NOTE:1. PLASTIC COVER: SNOW WHITE UL GRADE ABS.
 2. DVI CONNCEOTOR SPECIFICATION
 2.1 REFER TO PRODUCT SPEC. PS74320-0001.
 2.2 CONTACT PLATING: AU FLASH.
 3. ELECTRICAL PERFORMANCE
 3.1 INSULATION RESISANCE: 20 M Ohms MIn
 3.2 DIELECTRIC STRENGTH: 300V DC FOR 10 MILLISECONDS.
 4. ADAPTOR SPECIFICATION
 4.1 REFER TO PRODUCT SPEC. PS88741-8800.
 5. THIS PRODUCT MUST MEET MX RoHS COMPLIANCE.

7. MATERIAL LIST

F	P&D CONNECTOR ASSY 674850009
E	ADAPTER SCREW 887806003
D	DVI(F) TO P&D(M) ADAPTER BOTTOM COVER 887899308
C	DVI(F) TO P&D(M) ADAPTER TOP COVER 887899301
B	DVI_D FEMALE SCREW 887806066
A	DVI_D FEMALE CONNECTOR 743207000
ITEM	DESCRIPTION

6. CONNECTION DIAGRAM

SHIELD	SHIEDL	GROUND
PIN 24	PIN 15	TMDS CLOCK-
PIN 23	PIN 14	TMDS CLOCK+
PIN 22	PIN 7	TMDS CLOCK SHIELD
PIN 19	PIN 23	TMDS DATA 0 SHIELD
PIN 18	PIN 21	TMDS DATA 0+
PIN 17	PIN 22	TMDS DATA 0-
PIN 16	PIN 8	HOT PLUG DETECT
PIN 15	PIN 25	GROUND(+5V & HV SYNC.)
PIN 14	PIN 28	POWER +5V
PIN 11	PIN 13	TMDS DATA 1 SHIELD
PIN 10	PIN 11	TMDS DATA 1+
PIN 9	PIN 12	TMDS DATA 1-
PIN 7	PIN 26	DDC DATA
PIN 6	PIN 27	DDC CLOCK
PIN 3	PIN 3	TMDS DATA 2 SHIELD
PIN 2	PIN 1	TMDS DATA 2+
PIN 1	PIN 2	TMDS DATA 2-
DVI-D(F)	P&D-D(M)	CABLE FUNCTION

ENTER DESCRIPTION EC NO: DG2006-0186 DRWN: PDAI CHKD: APPR: TKAN 2006/03/09 2006/03/09 2006/03/10 DESCRIPTION REV	QUALITY SYMBOLS	GENERAL TOLERANCES (UNLESS SPECIFIED)	DIMENSION STYLE	SCALE	DESIGN UNITS	THIRD ANGLE PROJECTION															
	▽=0 ▽=0	<table border="1"> <tr> <th></th> <th>mm</th> <th>INCH</th> </tr> <tr> <td>4 PLACES</td> <td>±---</td> <td>±---</td> </tr> <tr> <td>3 PLACES</td> <td>±---</td> <td>±---</td> </tr> <tr> <td>2 PLACES</td> <td>±---</td> <td>±---</td> </tr> <tr> <td>1 PLACE</td> <td>±---</td> <td>±---</td> </tr> </table> ANGULAR ±---°		mm	INCH	4 PLACES	±---	±---	3 PLACES	±---	±---	2 PLACES	±---	±---	1 PLACE	±---	±---	MM/IN	---	METRIC	THIRD ANGLE PROJECTION
		mm	INCH																		
	4 PLACES	±---	±---																		
3 PLACES	±---	±---																			
2 PLACES	±---	±---																			
1 PLACE	±---	±---																			
	DRAFT WHERE APPLICABLE MUST REMAIN WITHIN DIMENSIONS	DRAWN BY PDAI CHECKED BY ZXDENG APPROVED BY BORON DATE 2006/03/07 DATE 2006/03/07 DATE 2006/03/07	TITLE																		
						DVI_D(F)-P&D_D(M) ADAPTER MOLEX INCORPORATED MATERIAL NO. 88741-9200 DOCUMENT NO. SD-88741-013 SHEET NO. 2 OF 2															