



Chipsmall Limited consists of a professional team with an average of over 10 year of expertise in the distribution of electronic components. Based in Hongkong, we have already established firm and mutual-benefit business relationships with customers from,Europe,America and south Asia,supplying obsolete and hard-to-find components to meet their specific needs.

With the principle of “Quality Parts,Customers Priority,Honest Operation,and Considerate Service”,our business mainly focus on the distribution of electronic components. Line cards we deal with include Microchip,ALPS,ROHM,Xilinx,Pulse,ON,Everlight and Freescale. Main products comprise IC,Modules,Potentiometer,IC Socket,Relay,Connector.Our parts cover such applications as commercial,industrial, and automotives areas.

We are looking forward to setting up business relationship with you and hope to provide you with the best service and solution. Let us make a better world for our industry!



## Contact us

Tel: +86-755-8981 8866 Fax: +86-755-8427 6832

Email & Skype: info@chipsmall.com Web: www.chipsmall.com

Address: A1208, Overseas Decoration Building, #122 Zhenhua RD., Futian, Shenzhen, China



MATERIALS AND FINISHES

SMA JACK:  
SEE SD-73391-026

MCX PLUG:  
SEE SD-73366-001

CABLE: RG316

SHRINK TUBE: VERSAFIT OR  
EQUIVALENT

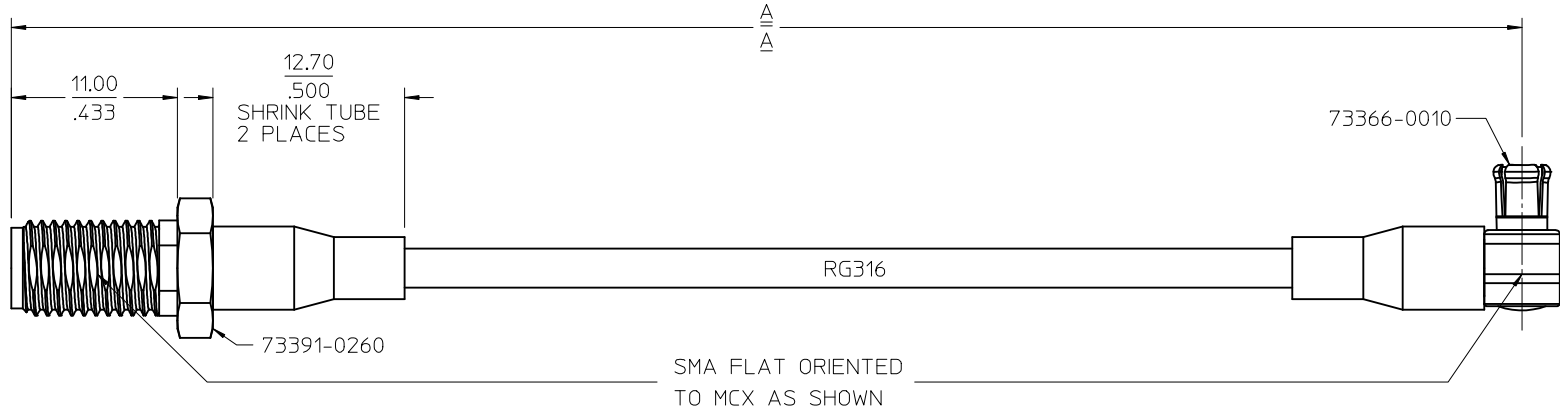
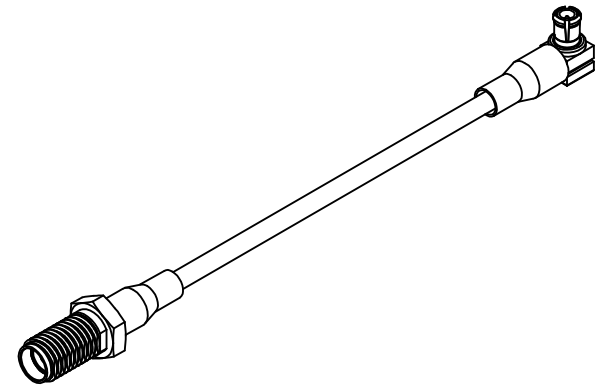

SMA FLAT ORIENTED  
TO MCX AS SHOWN

CABLES WILL BE INDIVIDUALLY BAGGED

BAG LABEL:  
MOLEX: P/N  
DATE CODE

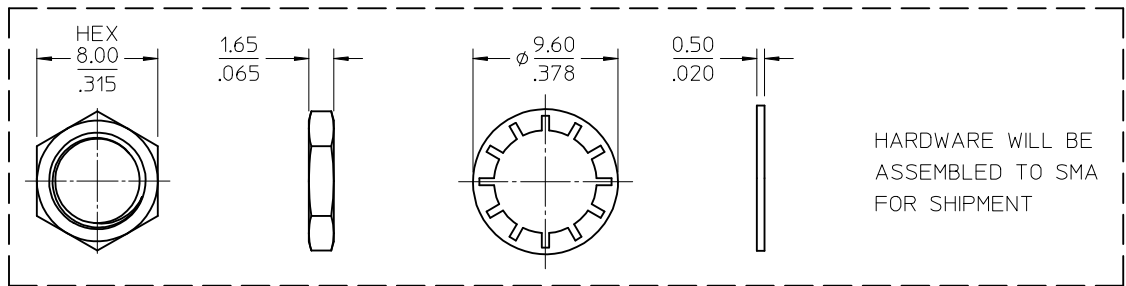

89761-6772	18.00±.35	457.20±8.89	POLYBAG
89761-6771	12.00±.25	304.80±6.35	POLYBAG
89761-6770	6.00±.25	152.40±6.35	POLYBAG
PART NO.	IN	MM	PACKAGING
	DIM A	DIM A	

CECC-22-220	INTERFACE MCX
MIL-STD-348A, FIG. 310.2	INTERFACE SMA
SPECIFICATION	DESCRIPTION

CHG: REGENERATED IN SYSTEM PER RF12-E082 EC NO: URF2013-0035 DRWNR: YEH CHKD: APPR: MHIANG 2012/07/11 2012/07/28 A2	QUALITY SYMBOLS ∇=0 ∇=0 ∇=0	DESCRIPTION REV	GENERAL TOLERANCES (UNLESS SPECIFIED)		DIMENSION STYLE	SCALE	DESIGN UNITS	THIRD ANGLE PROJECTION	
					MM/IN	4:1	METRIC		
					DRAWN BY	DATE	TITLE CA SMA JACK STR BKHD TO MCX PLUG R/A WITH RG316 CA-SMAJ/MCXP, EWR-3874 <b>molex</b>		
					CHECKED BY	DATE			
		APPROVED BY		DATE	DOCUMENT NO. SD-89761-677 SHEET NO. 1 OF 1				
		JDW		2009/01/08					
		MATERIAL NO.		THIS DRAWING CONTAINS INFORMATION THAT IS PROPRIETARY TO MOLEX INCORPORATED AND SHOULD NOT BE USED WITHOUT WRITTEN PERMISSION					
		SEE TABLE							