



Chipsmall Limited consists of a professional team with an average of over 10 year of expertise in the distribution of electronic components. Based in Hongkong, we have already established firm and mutual-benefit business relationships with customers from,Europe,America and south Asia,supplying obsolete and hard-to-find components to meet their specific needs.

With the principle of "Quality Parts,Customers Priority,Honest Operation,and Considerate Service",our business mainly focus on the distribution of electronic components. Line cards we deal with include Microchip,ALPS,ROHM,Xilinx,Pulse,ON,Everlight and Freescale. Main products comprise IC,Modules,Potentiometer,IC Socket,Relay,Connector.Our parts cover such applications as commercial,industrial, and automotives areas.

We are looking forward to setting up business relationship with you and hope to provide you with the best service and solution. Let us make a better world for our industry!



## Contact us

Tel: +86-755-8981 8866 Fax: +86-755-8427 6832

Email & Skype: info@chipsmall.com Web: www.chipsmall.com

Address: A1208, Overseas Decoration Building, #122 Zhenhua RD., Futian, Shenzhen, China



Alle Rechte vorbehalten/ All rights reserved

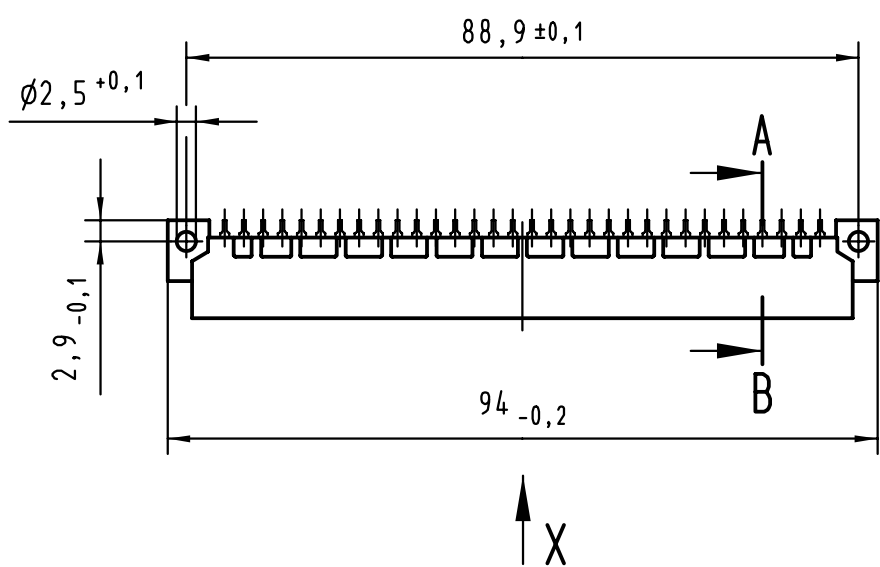
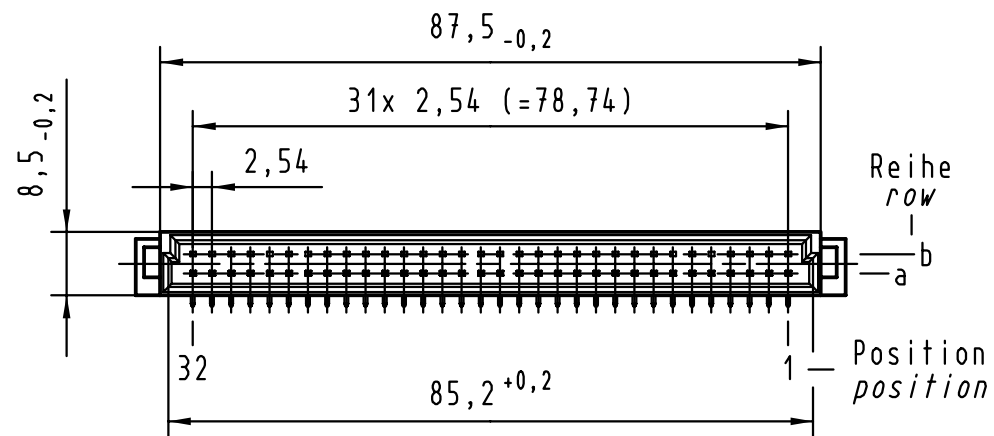
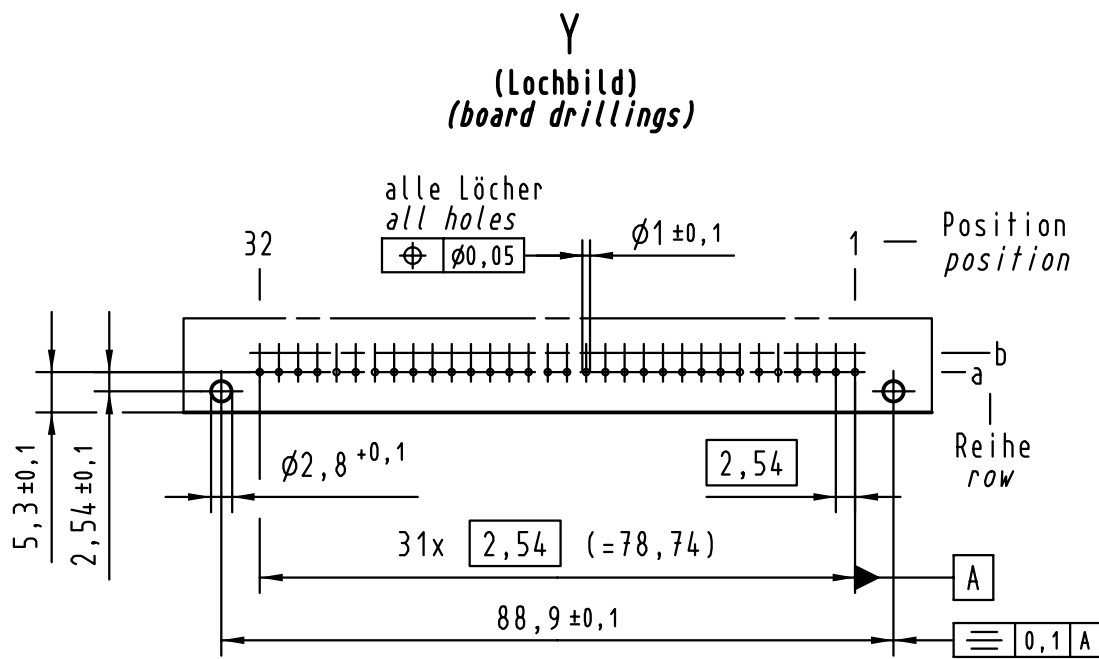

X Kontaktbelegung  
contact loading

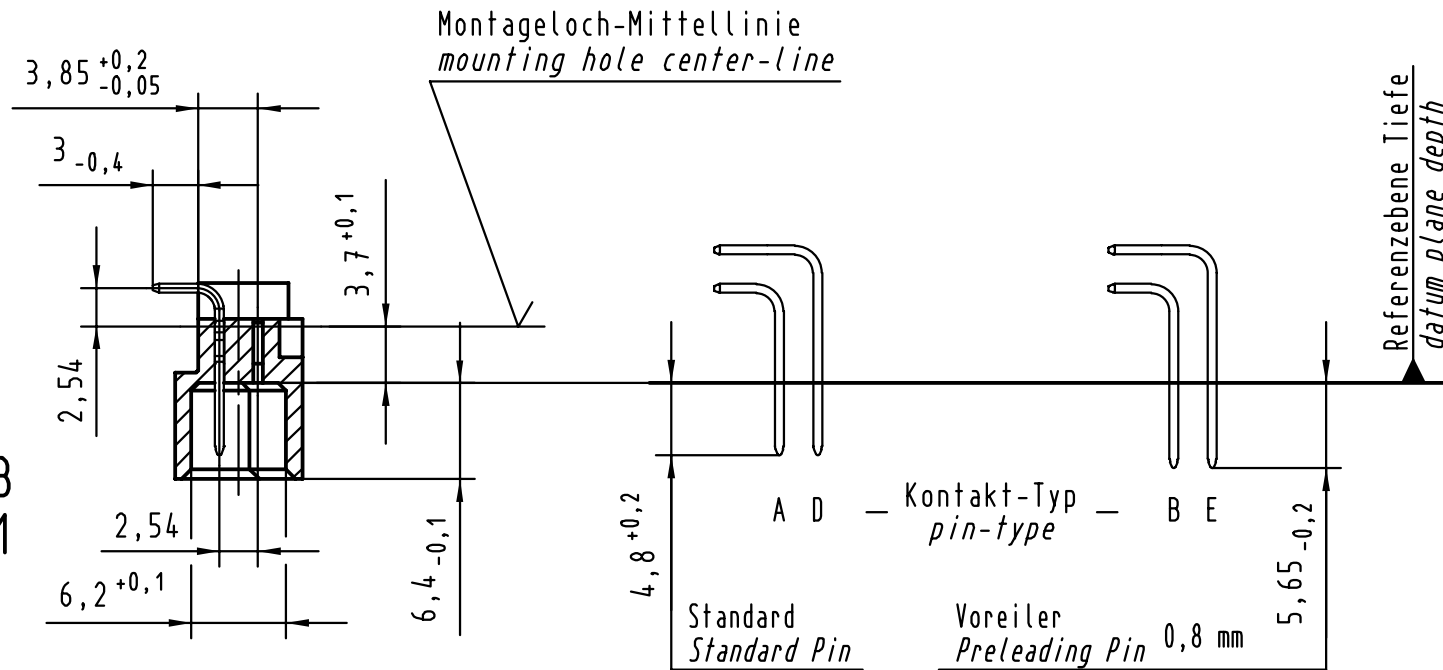
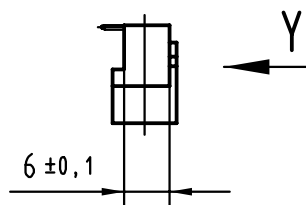
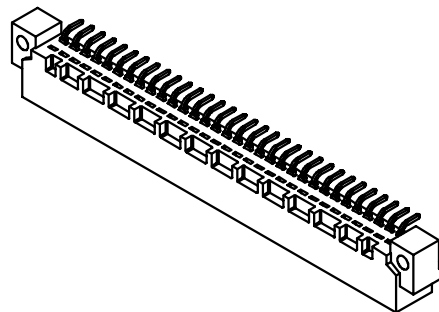
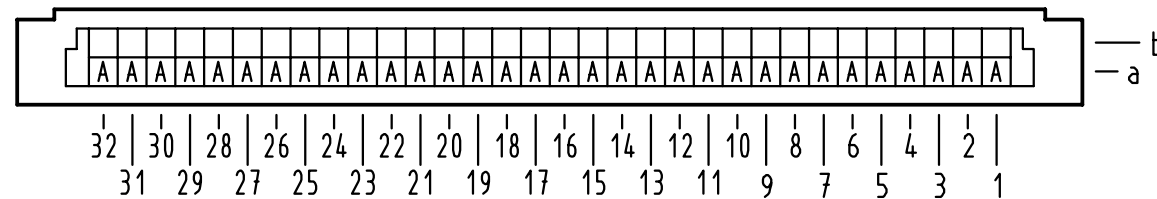

09 02 132 5931	-	min.0,76µm (30µm) Au über/over min.1,27µm (50µm) Ni
09 02 132 4931	VG	Au über/over Ni
09 02 132 7931	3	Au über/over Ni
09 02 132 6931	2	Au über/over Ni
09 02 132 2931	1	Au über/over Ni
Bestell-Nr. Part-No.	Anforderungsstufe nach IEC performance level per IEC	Kontaktoberfläche Contact Plating

	Techn. Character.			Nicht tolerierte Maß/Free size tolerances siehe /see IEC 603-2
		Dat.	Name	
	Detail.	11.07.00	Rie.	
	Insp.	11.07.00	Pa.	
	Stand.			Maßstab/Scale <b>1:1</b> (2:1)
28027	HARTING KGaA			
Mod.	Dat.	Name	D-32339 ESPELKAMP	
				Bauform B Messerleiste Einlöt, 32 pol. type B male connector solder, 32 pol.
				TB 09 02 132 x931
				Blatt/ page