



Chipsmall Limited consists of a professional team with an average of over 10 year of expertise in the distribution of electronic components. Based in Hongkong, we have already established firm and mutual-benefit business relationships with customers from,Europe,America and south Asia,supplying obsolete and hard-to-find components to meet their specific needs.

With the principle of “Quality Parts,Customers Priority,Honest Operation,and Considerate Service”,our business mainly focus on the distribution of electronic components. Line cards we deal with include Microchip,ALPS,ROHM,Xilinx,Pulse,ON,Everlight and Freescale. Main products comprise IC,Modules,Potentiometer,IC Socket,Relay,Connector.Our parts cover such applications as commercial,industrial, and automotives areas.

We are looking forward to setting up business relationship with you and hope to provide you with the best service and solution. Let us make a better world for our industry!



## Contact us

Tel: +86-755-8981 8866 Fax: +86-755-8427 6832

Email & Skype: [info@chipsmall.com](mailto:info@chipsmall.com) Web: [www.chipsmall.com](http://www.chipsmall.com)

Address: A1208, Overseas Decoration Building, #122 Zhenhua RD., Futian, Shenzhen, China



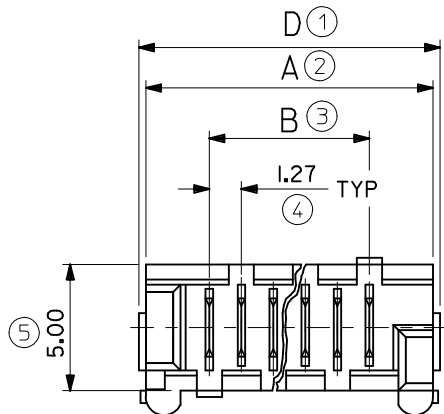

MOULD BASE COLOUR: NATURAL

POLARISING  
PEG'S  
NOTE 8

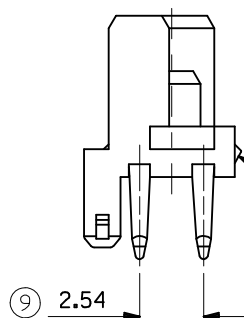
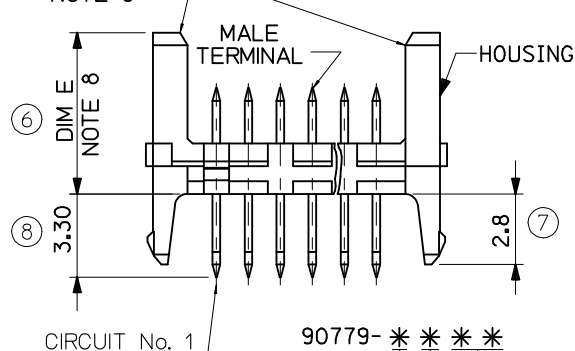

LATCH FOR FEMALE  
CONNECTOR

CIRCUIT SIZE 04CKT TO 26CKT  
-SEE TABLE ABOVE FOR PART CODE

0= 4-6um TIN ASSY  
3= 0.6um PALLADIUM NICKEL ASSY  
7= 0.6um PALLADIUM NICKEL, TUBED  
9= 4-6um TIN ASSY TUBED

#### NOTES

1. HOUSING, NYLON 46, GLASS FILLED UL 94 V-0, NATURAL (WHITE).  
2. TERMINAL, BRASS  
PLATING, TIN: 127 MICROMETRE MIN NICKEL  
UNDER 4-6 MICROMETRE TIN

PLATING PALLADIUM NICKEL (PdNi): 127 MICROMETRE MIN. NICKEL  
UNDER 3-5 MICROMETRE TIN SELECTIVE  
AND 0.6 MICROMETRE PdNi UNDER 0.05 MICROMETRE GOLD FLASH

3. APPLICATION CLASS TO DIN 40040 HME (-25°C/+100°C)  
4. PIN PUSH FORCE 7N  
5. TEST VOLTAGE: 750V.A.C./1 MIN  
6. COMPATIBLE WITH MOLEX PART 90327  
7. PRODUCT SPECIFICATION: PS-99020-0011  
8. POLARISING PEG AVAILABLE IN 2 OPTIONS  
DIM E: STANDARD 6.40mm  
DIM E: SHORT VERSION 4.10mm  
9. PACKAGING SPECIFICATION: PK-90325-002

LAST INSPECTION NUMBER USED: 9

90779-***13	26	36.80	31.75	35.35	37.26
***12	24	34.26	29.21	32.81	34.72
***11	22	31.72	26.67	30.27	32.18
***10	20	29.18	24.13	27.73	29.64
***08	18	26.64	21.59	25.19	27.10
***07	16	24.10	19.05	22.65	24.56
***06	14	21.56	16.51	20.11	22.02
***05	12	19.02	13.97	17.57	19.48
***04	10	16.48	11.43	15.03	16.94
***03	8	13.94	8.89	12.49	14.40
***02	6	11.40	6.35	9.95	11.86
90779-***01	4	8.86	3.81	7.41	9.32
PART NO.	NO. OF CKTS	DIM. A	DIM. B	DIM. C	DIM. D

PCB LAYOUT VIEWED  
FROM SOLDER SIDE.  
BOARD 1.60±0.14 THK

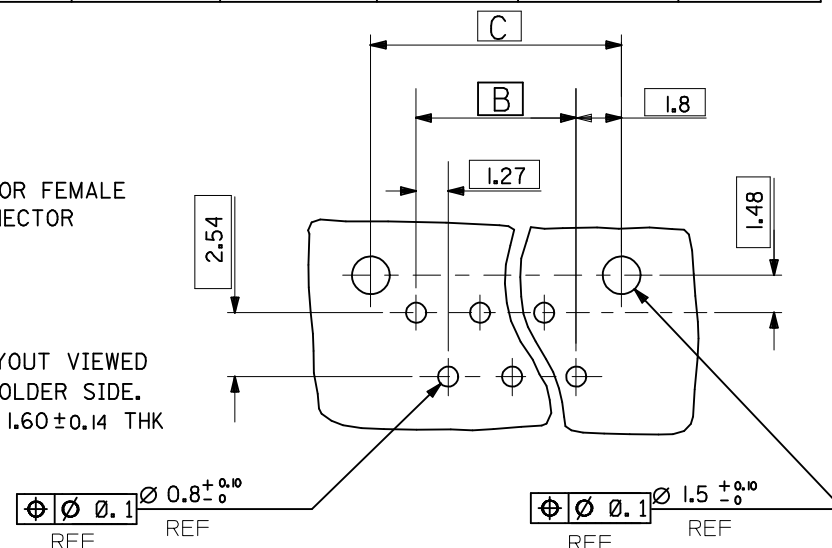

REMOVED GOLD OPTION ADDED PACKAGING SPEC EC NO: IPG2012-0576	2012/03/22	2012/03/29	2012/07/17
DRW:DBYRNES	CHKD:SMCGREVV	APPR:EFOLAN	
DESCRIPTION			
REV			

QUALITY  
SYMBOLS  
▽=0  
C=0

GENERAL TOLERANCES  
(UNLESS SPECIFIED)

	mm	INCH
4 PLACES	±---	±---
3 PLACES	±0.20	±---
2 PLACES	±0.20	±---
1 PLACE	±---	±---

ANGULAR ±---°

DRAFT WHERE APPLICABLE  
MUST REMAIN  
WITHIN DIMENSIONS

DRAWN BY	DATE	TITLE
BGB	1992/08/21	HEADER ASSEMBLY
CHECKED BY	DATE	
DMORIARTY	2004/12/03	
APPROVED BY	DATE	
JDENNEHY	2004/12/03	
MATERIAL NO.		

SCALE  
5:1

DESIGN UNITS  
METRIC

THIRD ANGLE  
PROJECTION

MOLEX

MOLEX INCORPORATED

DOCUMENT NO.

SDA-90779

SHEET NO.

1 OF 1

THIS DRAWING CONTAINS INFORMATION THAT IS PROPRIETARY TO MOLEX  
INCORPORATED AND SHOULD NOT BE USED WITHOUT WRITTEN PERMISSION