



Chipsmall Limited consists of a professional team with an average of over 10 year of expertise in the distribution of electronic components. Based in Hongkong, we have already established firm and mutual-benefit business relationships with customers from,Europe,America and south Asia,supplying obsolete and hard-to-find components to meet their specific needs.

With the principle of “Quality Parts,Customers Priority,Honest Operation,and Considerate Service”,our business mainly focus on the distribution of electronic components. Line cards we deal with include Microchip,ALPS,ROHM,Xilinx,Pulse,ON,Everlight and Freescale. Main products comprise IC,Modules,Potentiometer,IC Socket,Relay,Connector.Our parts cover such applications as commercial,industrial, and automotives areas.

We are looking forward to setting up business relationship with you and hope to provide you with the best service and solution. Let us make a better world for our industry!



## Contact us

Tel: +86-755-8981 8866 Fax: +86-755-8427 6832

Email & Skype: info@chipsmall.com Web: www.chipsmall.com

Address: A1208, Overseas Decoration Building, #122 Zhenhua RD., Futian, Shenzhen, China



CCT	DIM A	DIM B	DIM C	TOL
2	5.00	10.20	12.30	+/-0.30
3	10.00	15.20	17.30	
4	15.00	20.20	22.30	
5	20.00	25.20	27.30	
6	25.00	30.20	32.30	
7	30.00	35.20	37.30	
8	35.00	40.20	42.30	
9	40.00	45.20	47.30	
10	45.00	50.20	52.30	
11	50.00	55.20	57.30	
12	55.00	60.20	62.30	

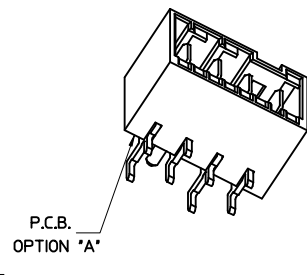
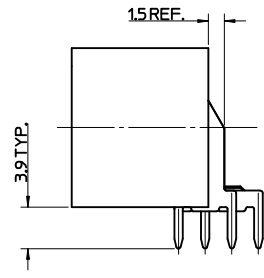
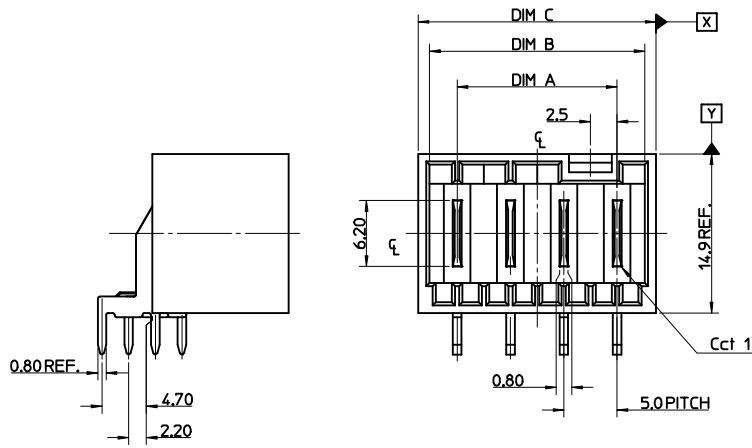

HOLES ON SOME TOOLED VERSIONS

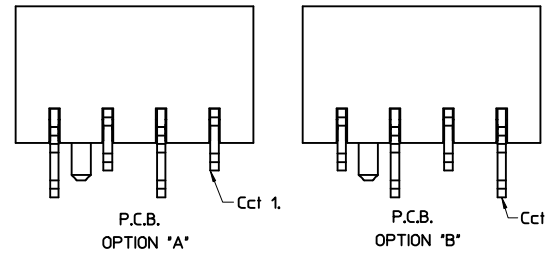
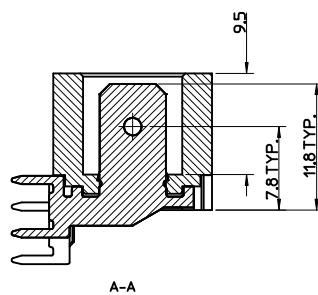
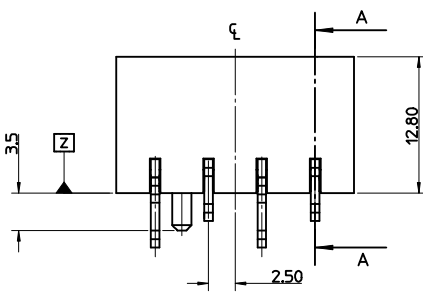
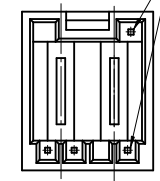

RECOMMENDED PCB LAYOUT

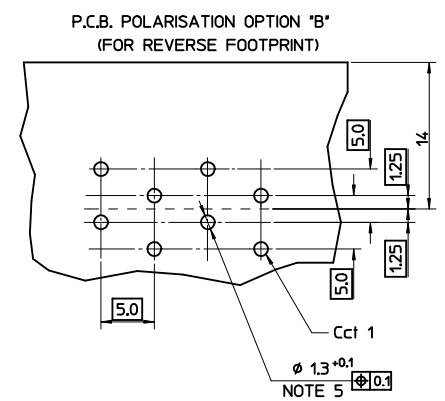
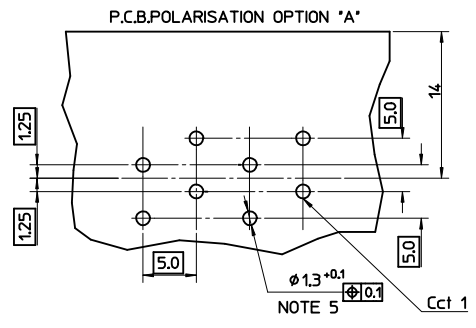

- NOTES:
- MATERIAL:  
HOUSING: 30% GLASS-FILLED PBT, UL94 V-0  
TERMINAL: BRASS 0.80REF. THICK  
PLATING: OPTIONAL (SEE CHARTS SHEETS 2-7)  
TIN PLATING OPTION : 34m TIN OVER 1.274m NICKEL.  
SELECTIVE SILVER  
CONTACT AREA : 24m SILVER OVER 1.274m NICKEL. ALL OTHER AREA FLASH SILVER
  - PRODUCT CONFORMS TO SPECIFICATION PS-99020-0037
  - MATES WITH MOLEX 91338, 90833, 90835, 91777, 91778 & 91779
  - PARTS PACKAGED LOOSE IN PLASTIC BAGS
  - PLATED THRU HOLE
  - RECOMMENDED PCB THICKNESS: 1.4+0.1mm.
  - PCB VIEW IS FROM SOLDER SIDE

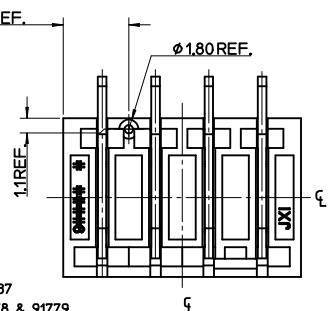

PLATING SPEC CHANGE EC NO: IFC2013-0344 DRAWN: BRUTTLE 2012/09/07 CHKD: APPR: EFOLAN 2012/09/21	QUALITY SYMBOLS ▽=0 ▽=0	GENERAL TOLERANCES (UNLESS SPECIFIED) <table border="1"> <thead> <tr> <th></th> <th>mm</th> <th>INCH</th> </tr> </thead> <tbody> <tr> <td>4 PLACES</td> <td>± ---</td> <td>± ---</td> </tr> <tr> <td>3 PLACES</td> <td>± ---</td> <td>± ---</td> </tr> <tr> <td>2 PLACES</td> <td>± 0.1</td> <td>± ---</td> </tr> <tr> <td>1 PLACE</td> <td>± 0.2</td> <td>± ---</td> </tr> <tr> <td>0 PLACE</td> <td>±</td> <td>±</td> </tr> </tbody> </table>		mm	INCH	4 PLACES	± ---	± ---	3 PLACES	± ---	± ---	2 PLACES	± 0.1	± ---	1 PLACE	± 0.2	± ---	0 PLACE	±	±	DIMENSION STYLE MM ONLY	SCALE 1:1	DESIGN UNITS METRIC	THIRD ANGLE PROJECTION
		mm	INCH																					
	4 PLACES	± ---	± ---																					
	3 PLACES	± ---	± ---																					
2 PLACES	± 0.1	± ---																						
1 PLACE	± 0.2	± ---																						
0 PLACE	±	±																						
DRAWN BY NMCNAMAR 2004/05/22	DATE 2004/05/22	TITLE RAST 5 R.A. HDR																						
CHECKED BY JDENNEHY 2004/05/23	DATE 2004/05/23	APPROVED BY BMAGUIRE 2004/05/27					MATERIAL NO. SEE SHEETS 2-7	DOCUMENT NO. SD-90879-001	SHEET NO. 1 OF 7															
DRAFT WHERE APPLICABLE MUST REMAIN WITHIN DIMENSIONS		THIS DRAWING CONTAINS INFORMATION THAT IS PROPRIETARY TO MOLEX INCORPORATED AND SHOULD NOT BE USED WITHOUT WRITTEN PERMISSION																						

# 2 CIRCUIT

PART NO. (TIN)	TERM NO. (TIN)	HOUSING NO.	COLOUR	UNBLOCKED POSITION KEYS	UNBLOCKED CODING KEYS	LATCH POSITION	CONFIGURATION (SEE NOTES)	LUNBERG K REF	TERM NO. (SILVER)	PART NO. (SILVER)	P.C.B. POLARISATION OPTION	SEE CODE DESIGNATION TABLE FOR NUMBERING FORMAT WHEN ADDING NEW PART NUMBERS
90879-0003	91703-0005/8	91704-0002	NATURAL	1b 2a	01c d20	1/2		K01	91703-0006/9	90879-0499	A	
90879-0046	91703-0005/8	91704-0003	NATURAL	1a 2b	01c	1/2		K02	91703-0006/9	90879-0498	A	
90879-0026	91703-0005/8	91704-0004	NATURAL	1b 2b	01c	1/2		K09	91703-0006/9	90879-0488	A	
90879-0018	91703-0005/8	91704-0005	NATURAL	2a	01c, d20	1/2		K03	91703-0006/9	90879-0495	A	
90879-0021	91703-0005/8	91704-0006	NATURAL	1b	01c, d20	1/2		K16	91703-0006/9	90879-0492	A	
90879-0022	91703-0005/8	91704-0007	NATURAL	1a 2b	NONE	1/2		K06	91703-0006/9	90879-0491	A	
90879-0019	91703-0005/8	91704-0008	NATURAL	1a 2b	d20	1/2		K05	91703-0006/9	90879-0478	A	
90879-0058	91703-0005/8	91704-0009	NATURAL	2b	NONE	1/2		K11	91703-0006/9	90879-0476	A	
90879-0029	91703-0005/8	91704-0010	NATURAL	1a 1b	d20	1/2		K13	91703-0006/9	90879-0486	A	
90879-0030	91703-0005/8	91704-0011	NATURAL	2a 2b	NONE	1/2		K31	91703-0006/9	90879-0485	A	
90879-0059	91703-0005/8	91704-0012	NATURAL	2b	d20	1/2		K38	91703-0006/9	90879-0475	A	
90879-0060	91703-0005/8	91704-0013	NATURAL	1a 2a	01c d20	1/2		K44	91703-0006/9	90879-0474	A	
90879-0061	91703-0005/8	91704-0014	NATURAL	1a 1b	NONE	1/2		K40	91703-0006/9	90879-0473	A	
90879-0020	91703-0005/8	91704-0015	NATURAL	1a 1b	01c	1/2		K04	91703-0006/9	90879-0493	A	
90879-0062	91703-0005/8	91704-0016	NATURAL	2b	01c d20	1/2		K15	91703-0006/9	90879-0472	A	
90879-0057	91703-0005/8	91704-0017	NATURAL	1a	01c d20	1/2		K12	91703-0006/9	90879-0477	A	
90879-0009	91703-0005/8	91704-0018	NATURAL	1a 2a	01c	1/2		K10	91703-0006/9	90879-0496	A	
90879-0049	91703-0005/8	91704-0019	NATURAL	ALL	d20	1/2		K34	91703-0006/9	90879-0481	A	
90879-0056	91703-0005/8	91704-0020	NATURAL	1b 2a 2b	d20	1/2		K07	91703-0006/9	90879-0479	A	
90879-0063	91703-0005/8	91704-0002	NATURAL	1b 2a	01c d20	1/2		K01	91703-0006/9	90879-0471	B	
90879-0064	91703-0005/8	91704-0021	NATURAL	2a	01c	1/2		K42	91703-0006/9	90879-0470	A	

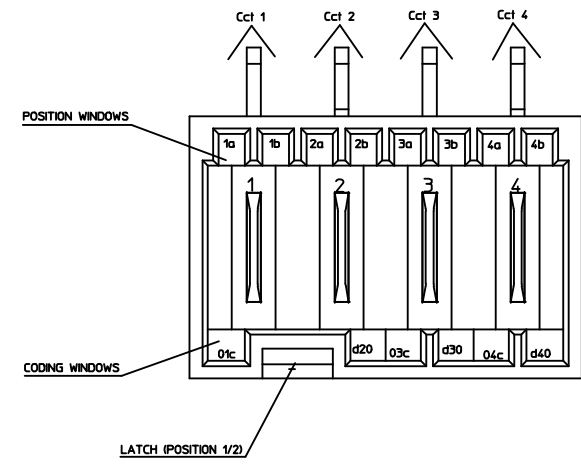

KEYING, CODING & LATCH POSITION  
(4CCT EXAMPLE SHOWN)  
VIEW INMATING DIRECTION

<b>SEE SHEET 1</b> EC NO: PG2003-0344 DRWN: BRUTTLE CHKD: APPR: REFOLAN 2012/09/21	QUALITY SYMBOLS ▽=0 ▽=0	GENERAL TOLERANCES (UNLESS SPECIFIED) mm INCH 4 PLACES ± --- ± --- 3 PLACES ± --- ± --- 2 PLACES ± 0.1 ± --- 1 PLACE ± 0.2 ± --- 0 PLACE ± ±	DIMENSION STYLE <b>MM ONLY</b>	SCALE 1:1	DESIGN UNITS METRIC	THIRD ANGLE PROJECTION	
	DRAWN BY NMCNAMAR	DATE 2004/05/22	CHECKED BY JDENNEHY	DATE 2004/05/23	TITLE <b>RAST 5 R.A. HDR</b>		
	APPROVED BY BMAGUIRE	DATE 2004/05/27	MATERIAL NO. <b>SEE CHARTS</b>			DOCUMENT NO. SD-90879-001	SHEET NO. 2 OF 7
	DRAFT WHERE APPLICABLE MUST REMAIN WITHIN DIMENSIONS			THIS DRAWING CONTAINS INFORMATION THAT IS PROPRIETARY TO MOLEX INCORPORATED AND SHOULD NOT BE USED WITHOUT WRITTEN PERMISSION			

3 CIRCUIT											P.C.B. POLARISATION OPTION
SEE CODE DESIGNATION TABLE FOR NUMBERING FORMAT WHEN ADDING NEW PART NUMBERS											
PART NO. (TIN)	TERM NO. (TIN)	MOLEX HOUSING NO	COLOUR	UNBLOCKED POSITION KEYS	UNBLOCKED CODING KEYS	LATCH POSITION	CONFIGURATION (SEE NOTES)	LUMBERG K REF	TERM NO. (SILVER)	PART NO. (SILVER)	
90879-0502	91703-0005/8	91704-1000	NATURAL	1b	01c, d20	1/2		K01	91703-0006/9	90879-1249	A
90879-0508	91703-0005/8	91704-1001	NATURAL	1a	03c	1/2		K04	91703-0006/9	90879-1248	A
90879-0528	91703-0005/8	91704-1002	NATURAL	1a 1b	d30	1/2		K05	91703-0006/9	90879-1247	A
90879-0512	91703-0005/8	91704-1003	NATURAL	1a 3b	01c	1/2		K06	91703-0006/9	90879-1246	A
90879-0519	91703-0005/8	91704-1004	NATURAL	1b	d20 03c	1/2		K09	91703-0006/9	90879-1245	A
90879-0529	91703-0005/8	91704-1005	NATURAL	1b 2a 2b	d30	1/2		K33	91703-0006/9	90879-1244	A
90879-0530	91703-0005/8	91704-1006	NATURAL	2b	d20	1/2		K56	91703-0006/9	90879-1243	A
90879-0526	91703-0005/8	91704-1007	NATURAL	ALL	d10 d30	2/3		K38	91703-0006/9	90879-1242	A
90879-0527	91703-0005/8	91704-1008	NATURAL	ALL	d20	1/2		K40	91703-0006/9	90879-1241	A
90879-0531	91703-0005/8	91704-1014	NATURAL	2b, 3a	d10, d30	2/3		K---	91703-0006/9	90879-1240	A
90879-0532	91703-0005/8	91704-1015	NATURAL	2b, 3b	d10, 02c	2/3		K---	91703-0006/9	90879-1239	A
90879-0533	91703-0005/8	91704-1000	NATURAL	1b	01c, d20	1/2		K01	91703-0006/9	90879-1238	B
90879-0534	91703-0005/8	91704-1016	NATURAL	1b, 2a, 2b, 3b	NONE	2/3		K---	91703-0006/9	90879-1237	B

4 CIRCUIT											P.C.B. POLARISATION OPTION
SEE CODE DESIGNATION TABLE FOR NUMBERING FORMAT WHEN ADDING NEW PART NUMBERS											
PART NO. (TIN)	TERM NO. (TIN)	MOLEX HOUSING NO.	COLOUR	UNBLOCKED POSITION KEYS	UNBLOCKED CODING KEYS	LATCH POSITION	CONFIGURATION (SEE NOTES)	LUMBERG K REF	TERM NO. (SILVER)	PART NO. (SILVER)	
90879-1254	91703-0005/8	91704-2000	NATURAL	1b	03c d40	1/2 3/4		K01	91703-0006/9	90879-1999	A
90879-1264	91703-0005/8	91704-2001	NATURAL	1a 4b	d40	1/2 3/4		K03	91703-0006/9	90879-1997	A
90879-1265	91703-0005/8	91704-2002	NATURAL	2a 4b	d20	1/2 3/4		K07	91703-0006/9	90879-1996	A
90879-1267	91703-0005/8	91704-2003	NATURAL	1b 2a 3a 4b	01c d40	1/2 3/4		K37	91703-0006/9	90879-1994	A
90879-1278	91703-0005/8	91704-2004	NATURAL	1a 2b 4b	01c 03c d40	1/2 3/4		K44	91703-0006/9	90879-1988	A
90879-1279	91703-0005/8	91704-2005	NATURAL	1a 3a 3b	01c d20 d40	1/2 3/4		K32	91703-0006/9	90879-1987	A
90879-1280	91703-0005/8	91704-2006	NATURAL	1b 2a 4b	01c d20 03c	1/2 3/4		K61	91703-0006/9	90879-1986	A
90879-1281	91703-0005/8	91704-2007	NATURAL	1a 3a	d40	1/2 3/4		K06	91703-0006/9	90879-1985	A
90879-1282	91703-0005/8	91704-2008	NATURAL	1a 2b 3b 4a	01c 03c d40	1/2 3/4		K65	91703-0006/9	90879-1984	A
90879-1266	91703-0005/8	91704-2009	NATURAL	2a 4b	d20 03c	1/2 3/4		K30	91703-0006/9	90879-1995	A
90879-1276	91703-0005/8	91704-2010	NATURAL	3b	d30	2/3		K04	91703-0006/9	90879-1989	A
90879-1283	91703-0005/8	91704-2014	NATURAL	1b, 2a, 3a, 4b	d20, d04	1/2 3/4		K109	91703-0006/9	90879-1983	A
90879-1284	91703-0005/8	91704-2015	NATURAL	ALL	03c d04	1/2 3/4		K**	91703-0006/9	90879-1982	A

<b>SEE SHEET 1</b> IEC NO: IP02013-0344 DRAWN BY: DRWINBRUTLE CHKD: APPR:EFOLAN 2012/09/07 2012/09/21	<b>QUALITY SYMBOLS</b> 	<b>GENERAL TOLERANCES (UNLESS SPECIFIED)</b>		<b>DIMENSION STYLE</b> <b>MM ONLY</b>		SCALE <b>1:1</b>	DESIGN UNITS <b>METRIC</b>	<b>THIRD ANGLE PROJECTION</b>	
		4 PLACES ± --- ± ---	3 PLACES ± --- ± ---	DRAWN BY NMCNAMAR	DATE 2004/05/22	TITLE <b>RAST 5 R.A. HDR</b>			
		2 PLACES ± 0.1 ± ---	1 PLACE ± 0.2 ± ---	CHECKED BY JDENNEHY	DATE 2004/05/23	MATERIAL NO. <b>SD-90879-001</b>			
		0 PLACE ± ±	ANGULAR ± 2 °	APPROVED BY BMAGUIRE	DATE 2004/05/27	DOCUMENT NO. <b>SD-90879-001</b>			
DRAFT WHERE APPLICABLE MUST REMAIN WITHIN DIMENSIONS		<b>SEE CHARTS</b>		SHEET NO. <b>3 OF 7</b>		THIS DRAWING CONTAINS INFORMATION THAT IS PROPRIETARY TO MOLEX INCORPORATED AND SHOULD NOT BE USED WITHOUT WRITTEN PERMISSION			

### 5 CIRCUIT

SEE CODE DESIGNATION TABLE FOR NUMBERING  
FORMAT WHEN ADDING NEW PART NUMBERS

PART NO. (TIN)	TERM NO. (TIN)	MOLEX HOUSING NO.	COLOUR	UNBLOCKED POSITION KEYS	LATCH POSITION	CONFIGURATION (SEE NOTES)	LUMBERG K REF	TERM NO. (SILVER)	PART NO. (SILVER)	P.C.B. POLARISATION OPTION
90879-2000	91703-0005/8	91704-3000	NATURAL	1a 5b	1/2 2/3		K01	91703-0006/9	90879-2749	A
90879-2001	91703-0005/8	91704-3001	NATURAL	1a 3a	1/2 4/5		K30	91703-0006/9	90879-2748	A
90879-2002	91703-0005/8	91704-3002	NATURAL	1a 5b	1/2 3/4		K31	91703-0006/9	90879-2747	A
90879-2003	91703-0005/8	91704-3003	NATURAL	1b 2a 3b 5a	1/2 3/4		K35	91703-0006/9	90879-2746	A
90879-2023	91703-0005/8	91704-3004	NATURAL	1a 2a 2b 4b 5b	1/2 2/3 4/5		K36	91703-0006/9	90879-2732	A
90879-2024	91703-0005/8	91704-3005	NATURAL	2a	2/3 4/5		K43	91703-0006/9	90879-2731	A
90879-2025	91703-0005/8	91704-3006	NATURAL	2a 4b	1/2 3/4		K44	91703-0006/9	90879-2730	A
90879-2026	91703-0005/8	91704-3007	NATURAL	2b	1/2 4/5		K02	91703-0006/9	90879-2729	A
90879-2027	91703-0005/8	91704-3008	NATURAL	4b 5a	1/2 4/5		K45	91703-0006/9	90879-2728	A
90879-2028	91703-0005/8	91704-3009	NATURAL	NONE	1/2 3/4		K46	91703-0006/9	90879-2727	A
90879-2029	91703-0005/8	91704-3010	NATURAL	1a 4b	1/2 4/5		K04	91703-0006/9	90879-2726	A
90879-2030	91703-0005/8	91704-3011	NATURAL	1a 5b	1/2 3/4		K77	91703-0006/9	90879-2725	A
90879-2005	91703-0005/8	91704-3012	NATURAL	1b 2b 4a	1/2 4/5		K40	91703-0006/9	90879-2744	A
90879-2016	91703-0005/8	91407-3013	NATURAL	3b 4a 5b	2/3 4/5		K47	91703-0006/9	90879-2738	A
90879-2018	91703-0005/8	91704-3014	NATURAL	1a 4b	1/2 3/4		K48	91703-0006/9	90879-2736	A
90879-2020	91703-0005/8	91704-3015	NATURAL	1a 5b	2/3		K50	91703-0006/9	90879-2734	A
90879-2021	91703-0005/8	91704-3016	NATURAL	1b 2a 4a	1/2 4/5		K51	91703-0006/9	90879-2733	A
90879-2022	91703-0005/8	91704-3017	NATURAL	2b 3b 4a	1/2 3/4		K52	91703-0006/9	90879-2735	A

### 6 CIRCUIT

SEE CODE DESIGNATION TABLE FOR NUMBERING  
FORMAT WHEN ADDING NEW PART NUMBERS

PART NO. (TIN)	TERM NO. (TIN)	MOLEX HOUSING NO.	COLOUR	UNBLOCKED POSITION KEYS	UNBLOCKED CODING KEYS	LATCH POSITION	CONFIGURATION (SEE NOTES)	LUMBERG K REF	TERM NO. (SILVER)	PART NO. (SILVER)	P.C.B. POLARISATION OPTION
90879-2753	91703-0005/8	91704-4000	NATURAL	1b	03c d60	1/2 4/5		K01	91703-0006/9	90879-3499	A
90879-2754	91703-0005/8	91704-4001	NATURAL	1a 3b 4b	01c d50 06c	1/2 4/5		K30	91703-0006/9	90879-3498	A
90879-2755	91703-0005/8	91704-4002	NATURAL	1a 1b 2b 3a 3b 4b	d30 04c d50	1/2 2/3 4/5		K37	91703-0006/9	90879-3497	A
90879-2756	91703-0005/8	91704-4003	NATURAL	1a 1b 4a 4b	d10 d50	2/3 4/5		K39	91703-0006/9	90879-3496	A
90879-2757	91703-0005/8	91704-4004	NATURAL	2a 4b 5a 6b	d20 03c 05c	1/2 3/4 5/6		K42	91703-0006/9	90879-3495	A
90879-2758	91703-0005/8	91704-4005	NATURAL	1a 2b 3a 3b 5b 6b	01c d40 d60	1/2 3/4 5/6		K43	91703-0006/9	90879-3494	A
90879-2759	91703-0005/8	91704-4006	NATURAL	1b 2a 3a 4b 5a 5b 6b	01c 03c d60	1/2 3/4 5/6		K44	91703-0006/9	90879-3493	A
90879-2760	91703-0005/8	91704-4007	NATURAL	2b	d20 d60	1/2 5/6		K46	91703-0006/9	90879-3492	A
90879-2761	91703-0005/8	91704-4008	NATURAL	2b 3b 4a	01c d50 06c	1/2 4/5		K36	91703-0006/9	90879-3491	A
90879-2762	91703-0005/8	91704-4009	NATURAL	1b 4b	d20 03c d50 06c	1/2 4/5		K58	91703-0006/9	90879-3486	A
90879-2764	91703-0005/8	91704-4010	NATURAL	1a 2b 3b 4a 6b	01c 03c d40 05c d60	1/2 3/4 5/6		K59	91703-0006/9	90879-3485	A
90879-2765	91703-0005/8	91704-4011	NATURAL	1a 2b 4a 6b	01c d40	1/2 3/4 5/6		K62	91703-0006/9	90879-3484	A
90879-2763	91703-0005/8	91704-4012	NATURAL	1b 2b 3b	01c 05c d60	1/2 3/4 5/6		K51	91703-0006/9	90879-3490	A
90879-2766	91703-0005/8	91704-4013	NATURAL	1b	d20 03c	1/2 4/5		K55	91703-0006/9	90879-3489	A
90879-2767	91703-0005/8	91704-4014	NATURAL	1b 2a 3a 5a 5b	01c d20 03c d40 d60	1/2 3/4 5/6		K56	91703-0006/9	90879-3488	A
90879-2771	91703-0005/8	91704-4015	NATURAL	1a 3a 3b 5b 6a	01c d20 240 05c d60	1/2 3/4 5/6		K60	91703-0006/9	90879-3487	A

<b>SEE SHEET 1</b> EC NO: IPG203-0344 DRAWN BY: DRWBRUTTLE CHKD: APPR:EFOLAN 2012/09/21	QUALITY SYMBOLS ▽=0 ▽=0	GENERAL TOLERANCES (UNLESS SPECIFIED)		DIMENSION STYLE <b>MM ONLY</b>		SCALE 1:1	DESIGN UNITS METRIC	THIRD ANGLE PROJECTION	
		4 PLACES ± --- ± --- 3 PLACES ± --- ± --- 2 PLACES ± 0.1 ± --- 1 PLACE ± 0.2 ± --- 0 PLACE ± ±	mm INCH	DRAWN BY DATE NMCNAMAR 2004/05/22	CHECKED BY DATE JDENNEHY 2004/05/23	TITLE <b>RAST 5 R.A. HDR</b>			
		ANGULAR ± 2 °		SEE CHARTS		DOCUMENT NO. <b>SD-90879-001</b>			
		DRAFT WHERE APPLICABLE MUST REMAIN WITHIN DIMENSIONS		MATERIAL NO.		SHEET NO. 4 OF 7			

THIS DRAWING CONTAINS INFORMATION THAT IS PROPRIETARY TO MOLEX INCORPORATED AND SHOULD NOT BE USED WITHOUT WRITTEN PERMISSION

### 7 CIRCUIT

SEE CODE DESIGNATION TABLE FOR NUMBERING FORMAT WHEN ADDING NEW PART NUMBERS											P.C.B. POLARISATION OPTION
PART NO. (TIN)	TERM NO. (TIN)	MOLEX HOUSING NO.	COLOR	UNLOCKED POSITION KEYS	UNLOCKED CODING KEYS	LATCH POSITION	CONFIGURATION (SEE NOTES)	LUMBERG K REF	TERM NO. (SILVER)	PART NO. (SILVER)	
90879-3500	91703-0005/8	91704-5000	NATURAL	NONE	03c d40 07c	1/2 5/6		K01	91703-0006/9	90879-4220	A
90879-3512	91703-0005/8	91704-5001	NATURAL	3a 4a	d30 d70	1/2 5/6		K30	91703-0006/9	90879-4248	A
90879-3504	91703-0005/8	91704-5002	NATURAL	2b	d20 d60	1/2 5/6		K32	91703-0006/9	90879-4247	A
90879-3513	91703-0005/8	91704-5003	NATURAL	1a 1b 3a 4b 5a	01c 07c	1/2 3/4 5/6		K40	91703-0006/9	90879-4240	A
90879-3514	91703-0005/8	91704-5004	NATURAL	2a	01c d50	2/3 4/5		K41	91703-0006/9	90879-4239	A
90879-3515	91703-0005/8	91704-5005	NATURAL	7b	01c d40 d70	1/2 3/4 6/7		K43	91703-0006/9	90879-4238	A
90879-3516	91703-0005/8	91704-5006	NATURAL	1b	03c d60	1/2 4/5		K31	91703-0006/9	90879-4237	A
90879-3517	91703-0005/8	91704-5007	NATURAL	1a 3a 4b 7b	01c d20 03c 06c	1/2 3/4 6/7		K45	91703-0006/9	90879-4236	A
90879-3518	91703-0005/8	91704-5008	NATURAL	1b 7a	02c d50	2/3 6/7		K48	91703-0006/9	90879-4235	A
90879-3519	91703-0005/8	91704-5009	NATURAL	1a 2b 3a 4b 6a	d20 03c d40 d50 d70	1/2 3/4 6/7		K51	91703-0006/9	90879-4234	A
90879-3520	91703-0005/8	91704-5010	NATURAL	1b 6a	d20 03c d50 d70	1/2 3/4 6/7		K69	91703-0006/9	90879-4233	A
90879-3505	91703-0005/8	91704-5011	NATURAL	1b 2a 5a 5b 7b	d20 d50 06c d70	1/2 4/5 6/7		K34	91703-0006/9	90879-4246	A
90879-3506	91703-0005/8	91704-5012	NATURAL	2b	d20 07c	1/2 3/4 5/6		K35	91703-0006/9	90879-4245	A
90879-3507	91703-0005/8	91704-5013	NATURAL	2a 2b 4b 5b 6a	d20 03c d40 d60	1/2 3/4 5/6		K38	91703-0006/9	90879-4244	A
90879-3510	91703-0005/8	91704-5014	NATURAL	2b 4a 4b 5b 6a	01c d20 d40 d60	1/2 3/4 5/6		K42	91703-0006/9	90879-4241	A

### 8 CIRCUIT

SEE CODE DESIGNATION TABLE FOR NUMBERING FORMAT WHEN ADDING NEW PART NUMBERS											P.C.B. POLARISATION OPTION
PART NO. (TIN)	TERM NO. (TIN)	MOLEX HOUSING NO.	COLOR	UNLOCKED POSITION KEYS	UNLOCKED CODING KEYS	LATCH POSITION	CONFIGURATION (SEE NOTES)	LUMBERG K REF	TERM NO. (SILVER)	PART NO. (SILVER)	
90879-4252	91703-0005/8	91704-6000	NATURAL	4a 6b	03c d60	1/2 3/4 5/6 7/8		K30	91703-0006/9	90879-4998	A
90879-4253	91703-0005/8	91704-6001	NATURAL	1a 2a 3a 3b 6a 7a 7b 8b	01c 05c d60	1/2 3/4 5/6 7/8		K33	91703-0006/9	90879-4997	A
90879-4254	91703-0005/8	91704-6002	NATURAL	2b 3b 4b 5a 5b 7a 8b	01c d60 d80	1/2 4/5 7/8		K41	91703-0006/9	90879-4996	A
90879-4255	91703-0005/8	91704-6003	NATURAL	1b 4b 7b 8b	01c d20 04c d50 07c	1/2 4/5 7/8		K45	91703-0006/9	90879-4995	A
90879-4256	91703-0005/8	91704-6004	NATURAL	1a 1b 3b 5a 6b 7a 8b	01c 03c d40 d60	1/2 3/4 5/6 7/8		K46	91703-0006/9	90879-4993	A
90879-4257	91703-0005/8	91704-6005	NATURAL	1b 5a 6b 8a	03c d40 05c 07c d80	1/2 3/4 5/6 7/8		K48	91703-0006/9	90879-4995	A
90879-4259	91703-0005/8	91704-6006	NATURAL	8b	02c d30 07c	2/3 7/8			91703-0006/9	90879-4996	A
90879-4258	91703-0005/8	91704-6007	NATURAL	1a 4b 5b 6a 8b	d40 d60 07c d80	1/2 3/4 5/6 7/8		K44	91703-0006/9	90879-4994	A
90879-4263	91703-0005/8	91704-6008	NATURAL	8b	02c d30	2/3		K49	91703-0006/9	90879-4990	A

<b>SEE SHEET 1</b> EC NO: IP52043-0344 DRAWING BRITTLE CHKD: APPR: P. COLAN 2012/09/17	QUALITY SYMBOLS 	GENERAL TOLERANCES (UNLESS SPECIFIED)		DIMENSION STYLE <b>MM ONLY</b>		SCALE 1:1	DESIGN UNITS METRIC	THIRD ANGLE PROJECTION								
		4 PLACES ± --- ± ---	3 PLACES ± --- ± ---	2 PLACES ± 0.1 ± ---	1 PLACE ± 0.2 ± ---	0 PLACE ± ±	ANGULAR ± 2 °	DRAWN BY NMCNAMAR	DATE 2004/05/22	CHECKED BY JDENNEHY	DATE 2004/05/23	APPROVED BY BMAGUIRE	DATE 2004/05/27	MATERIAL NO.	DOCUMENT NO. <b>SD-90879-001</b>	SHEET NO. 5 OF 7
		DRAFT WHERE APPLICABLE MUST REMAIN WITHIN DIMENSIONS		SEE CHARTS		THIS DRAWING CONTAINS INFORMATION THAT IS PROPRIETARY TO MOLEX INCORPORATED AND SHOULD NOT BE USED WITHOUT WRITTEN PERMISSION										
		RAST 5 R.A. HDR														



