



Chipsmall Limited consists of a professional team with an average of over 10 year of expertise in the distribution of electronic components. Based in Hongkong, we have already established firm and mutual-benefit business relationships with customers from,Europe,America and south Asia,supplying obsolete and hard-to-find components to meet their specific needs.

With the principle of “Quality Parts,Customers Priority,Honest Operation,and Considerate Service”,our business mainly focus on the distribution of electronic components. Line cards we deal with include Microchip,ALPS,ROHM,Xilinx,Pulse,ON,Everlight and Freescale. Main products comprise IC,Modules,Potentiometer,IC Socket,Relay,Connector.Our parts cover such applications as commercial,industrial, and automotives areas.

We are looking forward to setting up business relationship with you and hope to provide you with the best service and solution. Let us make a better world for our industry!



## Contact us

Tel: +86-755-8981 8866 Fax: +86-755-8427 6832

Email & Skype: [info@chipsmall.com](mailto:info@chipsmall.com) Web: [www.chipsmall.com](http://www.chipsmall.com)

Address: A1208, Overseas Decoration Building, #122 Zhenhua RD., Futian, Shenzhen, China



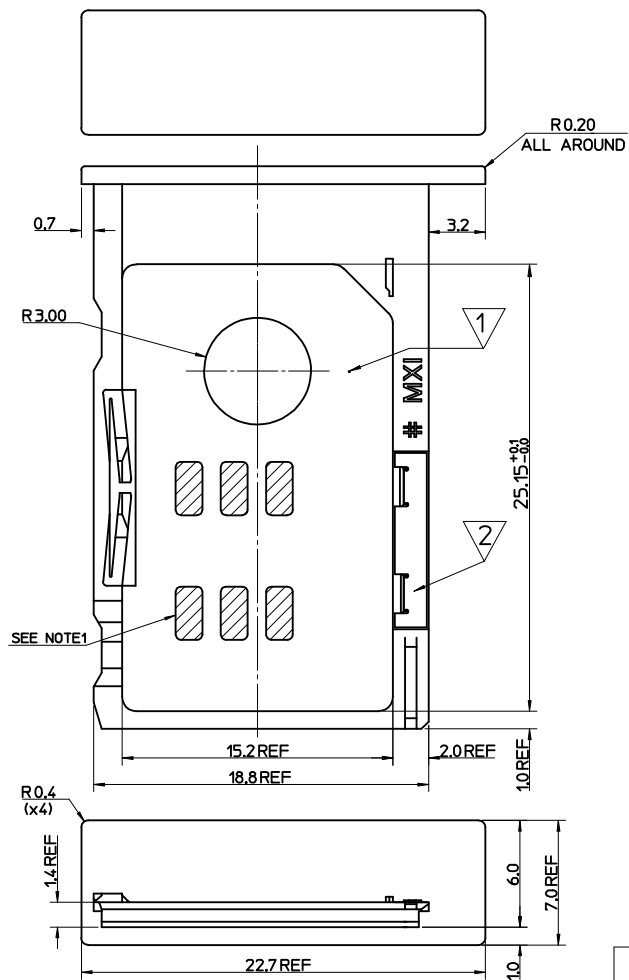

ITEM	COMPONENT	QTY	MATERIAL
1	HOUSING	1	LCP E130I, 30% GLASS FILL, UL-94 V-0 COLOUR BLACK
2	TERMINAL	1	0.15 PHOSPHOR BRONZE Au OVER Pd/Ni IN CONTACT AREA

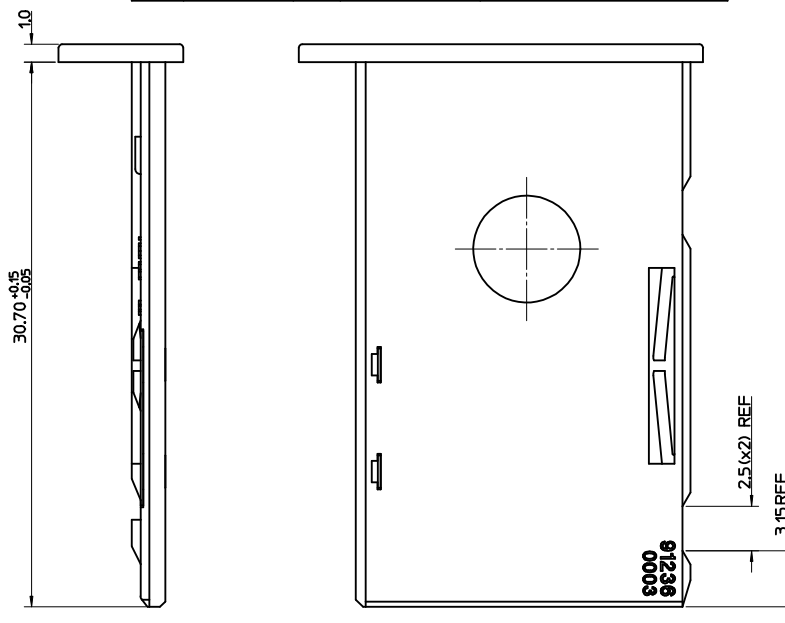

- NOTES:
1. POLISHED SURFACE FINISH IN SHADED AREA
  2. PACKAGING: LOOSE IN BAG
  3. FOR ALL UNSPECIFIED DIMENSIONS AND NOTES SEE SHEET 1

ADDED GATE ECN NO: E2002-0530 DRWN: FDUGGAN 2001/12/11 CHKD: APPR:	QUALITY SYMBOLS ▽ - 0 ▽ - 0	GENERAL TOLERANCES (UNLESS SPECIFIED) 4 PLACES ± --- ± --- 3 PLACES ± --- ± --- 2 PLACES ± 0.05 ± --- 1 PLACE ± 0.10 ± --- ANGULAR ± 2 ° DRAFT WHERE APPLICABLE MUST REMAIN WITHIN DIMENSIONS	SCALE 5:1	DESIGN UNITS METRIC	THIRD ANGLE PROJECTION	REVISE ON CAD ONLY
			DIMENSION STYLE MM ONLY		TITLE CARD HOLDER	
			DRAWN BY MINDORAK	DATE 00/05/31	MOLEX INCORPORATED MATERIAL NO. 912360003 DOCUMENT NO. SDA-91236 SHEET NO. 3 OF 6	
			CHECKED BY DHANNON	DATE 00/07/13		
J	REV		APPROVED BY MWILHITE	DATE 00/07/13	THIS DRAWING CONTAINS INFORMATION THAT IS PROPRIETARY TO MOLEX INCORPORATED AND SHOULD NOT BE USED WITHOUT WRITTEN PERMISSION	
					A2	

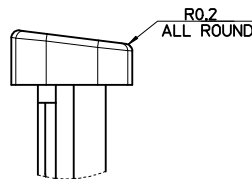
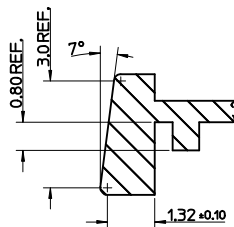
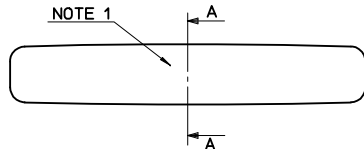

ITEM	COMPONENT	QTY	MATERIAL
▽	HOUSING	1	POLYSTER (PBT), 45% GLASS FILL, UL94 V-0 COLOUR BLACK
▽	TERMINAL	1	0.15 PHOSPHOR BRONZE Au OVER Pb/Ni IN CONTACT AREA

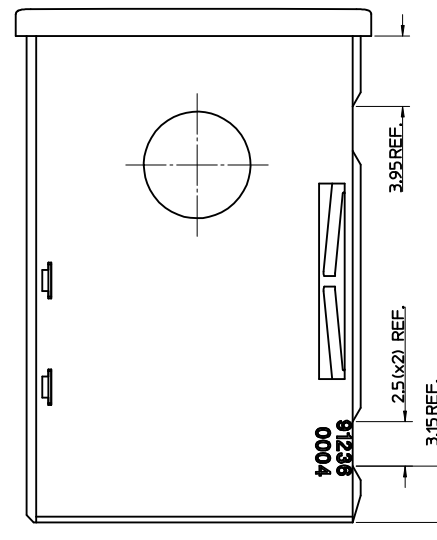
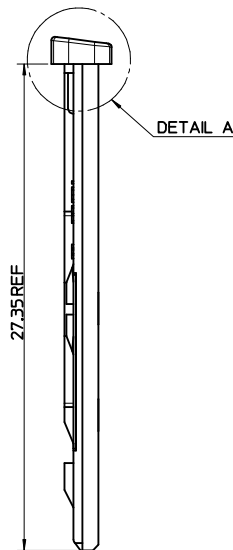
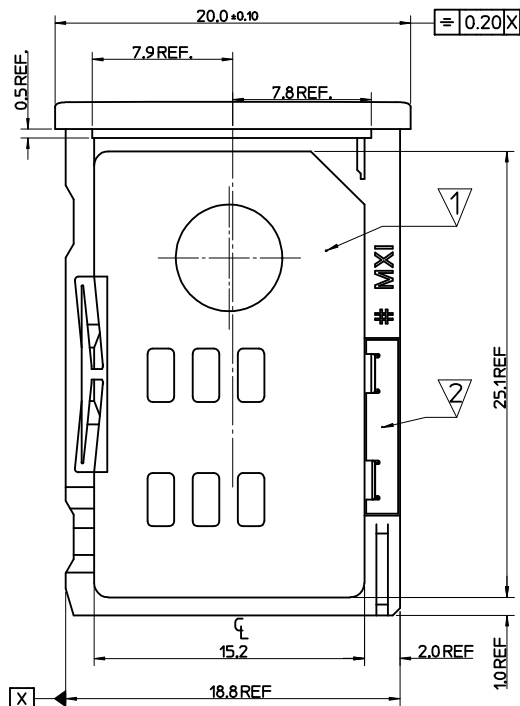

- NOTES:
- VDI 3400 NO. 27 SURFACE FINISH
  - PACKAGING: LOOSE IN BAG
  - FOR ALL UNSPECIFIED DIMENSIONS AND NOTES SEE SHEET 1

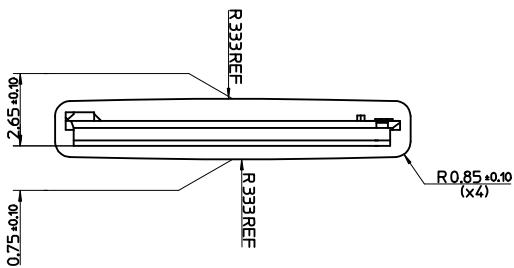

SEE SHEET 1	EC NO: DRWN:FDUGGAN 2001/12/11 CHKD: 2002/01/04 APPR:BMAGUIRE 2002/01/04	QUALITY SYMBOLS ▽ - 0 ▽ - 0	GENERAL TOLERANCES (UNLESS SPECIFIED) 4 PLACES ± --- ± --- 3 PLACES ± --- ± --- 2 PLACES ± 0.05 ± --- 1 PLACE ± 0.10 ± --- ANGULAR ± 2 ° DRAFT WHERE APPLICABLE MUST REMAIN WITHIN DIMENSIONS	SCALE 5:1 DESIGN UNITS METRIC DIMENSION STYLE MM ONLY DRAWN BY MINDORAK DATE 00/05/31 CHECKED BY DHANNON DATE 00/07/13 APPROVED BY MWILHITE DATE 00/07/13	THIRD ANGLE PROJECTION REVISE ON CAD ONLY TITLE CARD HOLDER molex MOLEX INCORPORATED MATERIAL NO. 912360004 DOCUMENT NO. SDA-91236 SHEET NO. 4 OF 6	THIS DRAWING CONTAINS INFORMATION THAT IS PROPRIETARY TO MOLEX INCORPORATED AND SHOULD NOT BE USED WITHOUT WRITTEN PERMISSION

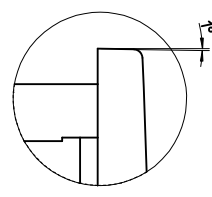
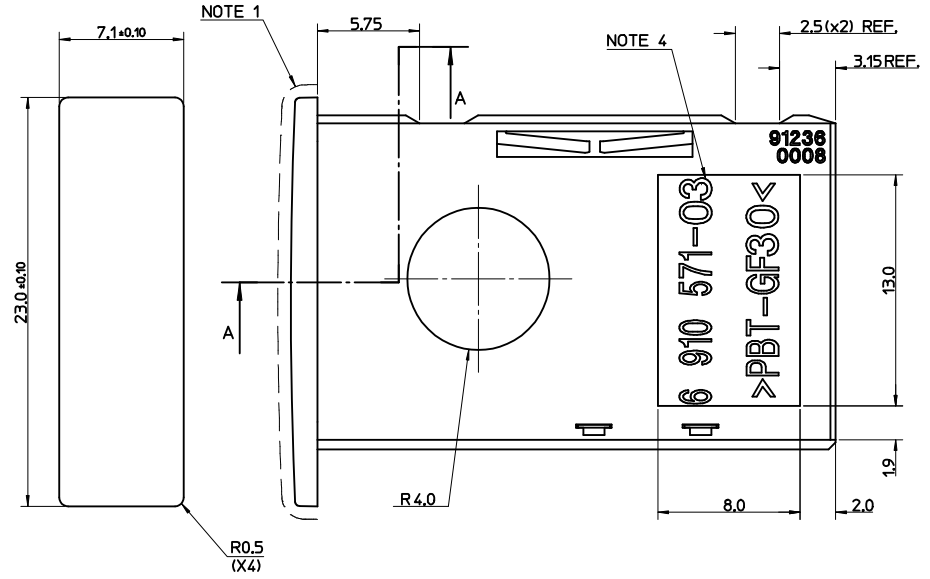
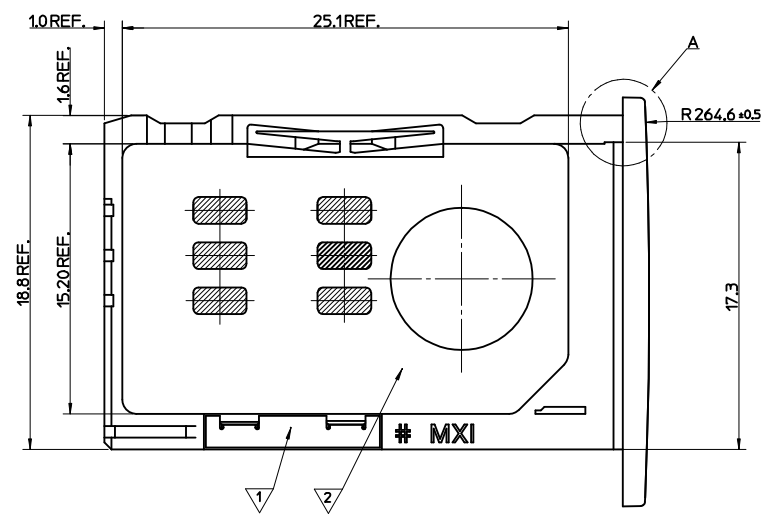
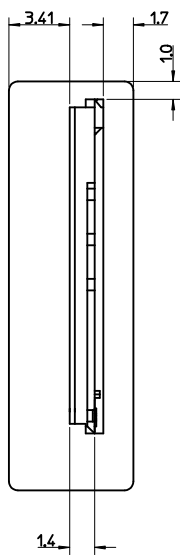

DETAIL A  
(SCALE 10:1)

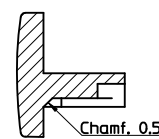
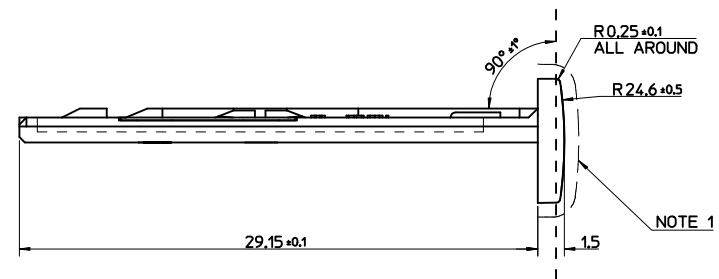

A-A

- NOTES:
1. VISIBLE AREA: NO PARTING LINES PERMISSIBLE IN THIS AREA  
FEINNAERBE K (ÄTZSTRUKTUR) SURFACE FINISH
  2. SEE PRODUCT SPECIFICATION: TBD
  3. PACKAGING: LOOSE IN BAG
  4. EXCHANGEABLE INSERT AREA 0.1 RECESSED, LETTERING 0.1 RAISED
  5. FOR ALL UNSPECIFIED DIMENSIONS AND NOTES SEE SHEET 1

ITEM	COMPONENT	QTY	MATERIAL
▽	TERMINAL	1	0.15 PHOSPHOR BRONZE 0.1um MIN Au OVER Pd/Ni IN CONTACT AREA
▽	HOUSING	1	GF PBT, BLACK

SEE SHEET 1	EC NO: DRWN:FDUGGAN 2001/12/11 CHKD: 2002/01/04 APPR:BMAGUIRE 2002/01/04	QUALITY SYMBOLS ▽ - 0 ▽ - 0	GENERAL TOLERANCES (UNLESS SPECIFIED) 4 PLACES ± --- ± --- 3 PLACES ± --- ± --- 2 PLACES ± 0.05 ± --- 1 PLACE ± 0.10 ± --- ANGULAR ± 2 ° DRAFT WHERE APPLICABLE MUST REMAIN WITHIN DIMENSIONS	SCALE 5:1	DESIGN UNITS METRIC	THIRD ANGLE PROJECTION	REVISE ON CAD ONLY	TITLE CARD HOLDER	MATERIAL NO. 912360008	DOCUMENT NO. SDA-91236	SHEET NO. 5 OF 6

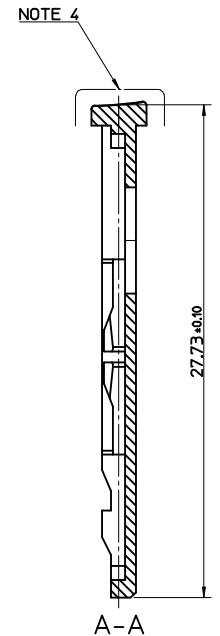
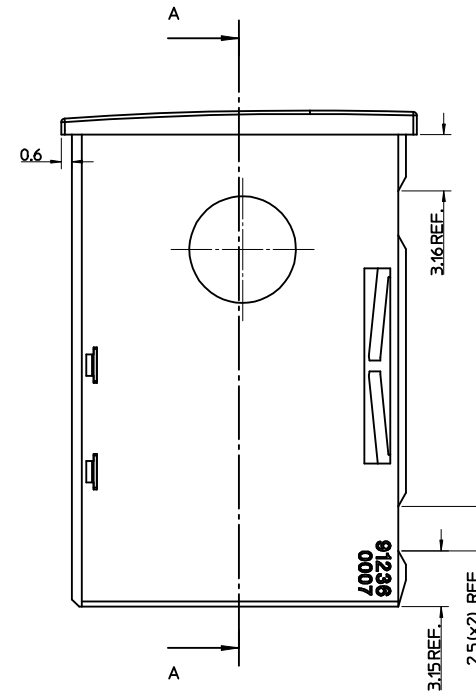
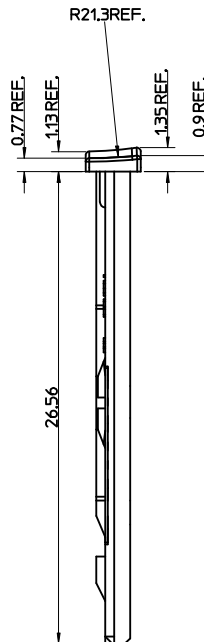
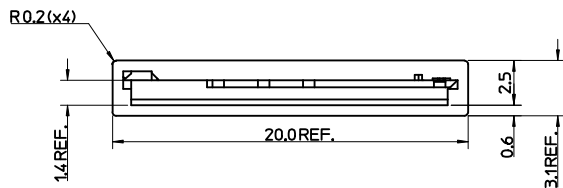
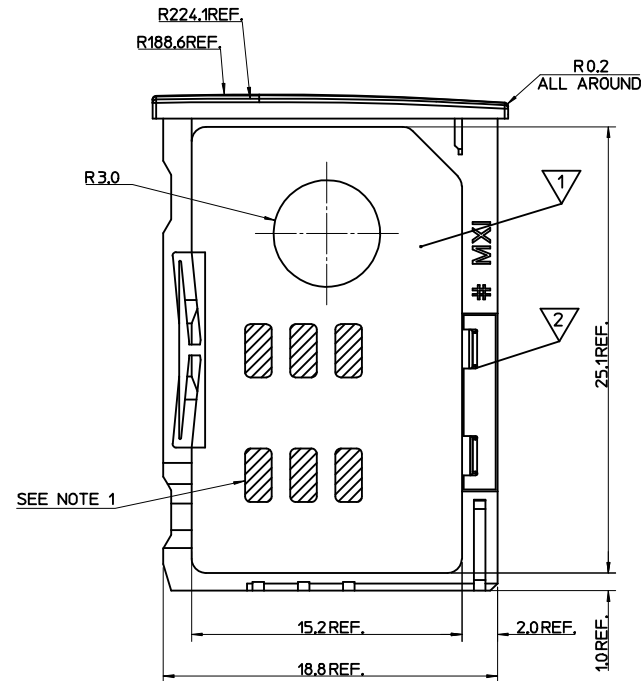
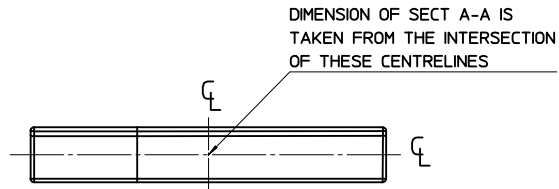

NOTES:

1. POLISHED SURFACE FINISH IN SHADED AREA.
2. PACKAGING: LOOSE IN BAG.
3. FOR ALL UNSPECIFIED DIMENSIONS AND NOTES SEE SHEET 1.
4. MOLDTECH 11010 SURFACE FINISH.

ITEM	COMPONENT	QTY	MATERIAL
1	HOUSING	1	POLYESTER (PBT), 30% GLASS FILL, UL-94 V-0 COLOUR BLACK
2	TERMINAL	1	0.15 PHOSPHOR BRONZE Au IN CONTACT AREA

SEE SHEET 1	QUALITY SYMBOLS - 0 C - 0	GENERAL TOLERANCES (UNLESS SPECIFIED) 4 PLACES ± --- 3 PLACES ± --- 2 PLACES ± 0.05 1 PLACE ± 0.10 ANGULAR ± 2 ° DRAFT WHERE APPLICABLE MUST REMAIN WITHIN DIMENSIONS	SCALE 5:1	DESIGN UNITS METRIC	THIRD ANGLE PROJECTION	REVISE ON CAD ONLY	TITLE CARD HOLDER	MATERIAL NO. 912360007	DOCUMENT NO. SDA-91236	SHEET NO. 6 OF 6
EC NO: DRWN:FDUGGAN 2001/12/11 CHKD: APPR:	DESCRIPTION REV									
THIS DRAWING CONTAINS INFORMATION THAT IS PROPRIETARY TO MOLEX INCORPORATED AND SHOULD NOT BE USED WITHOUT WRITTEN PERMISSION				A2						