



Chipsmall Limited consists of a professional team with an average of over 10 year of expertise in the distribution of electronic components. Based in Hongkong, we have already established firm and mutual-benefit business relationships with customers from,Europe,America and south Asia,supplying obsolete and hard-to-find components to meet their specific needs.

With the principle of “Quality Parts,Customers Priority,Honest Operation,and Considerate Service”,our business mainly focus on the distribution of electronic components. Line cards we deal with include Microchip,ALPS,ROHM,Xilinx,Pulse,ON,Everlight and Freescale. Main products comprise IC,Modules,Potentiometer,IC Socket,Relay,Connector.Our parts cover such applications as commercial,industrial, and automotives areas.

We are looking forward to setting up business relationship with you and hope to provide you with the best service and solution. Let us make a better world for our industry!



Contact us

Tel: +86-755-8981 8866 Fax: +86-755-8427 6832

Email & Skype: info@chipsmall.com Web: www.chipsmall.com

Address: A1208, Overseas Decoration Building, #122 Zhenhua RD., Futian, Shenzhen, China



POSITION OF COLOUR STRIPE (see note 3)

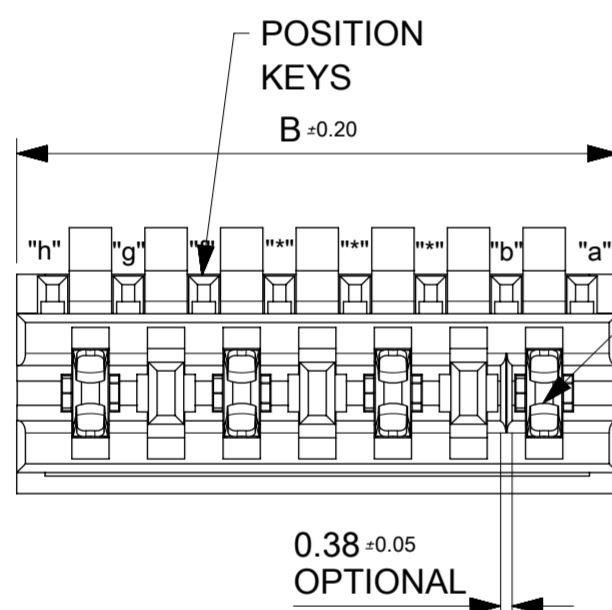
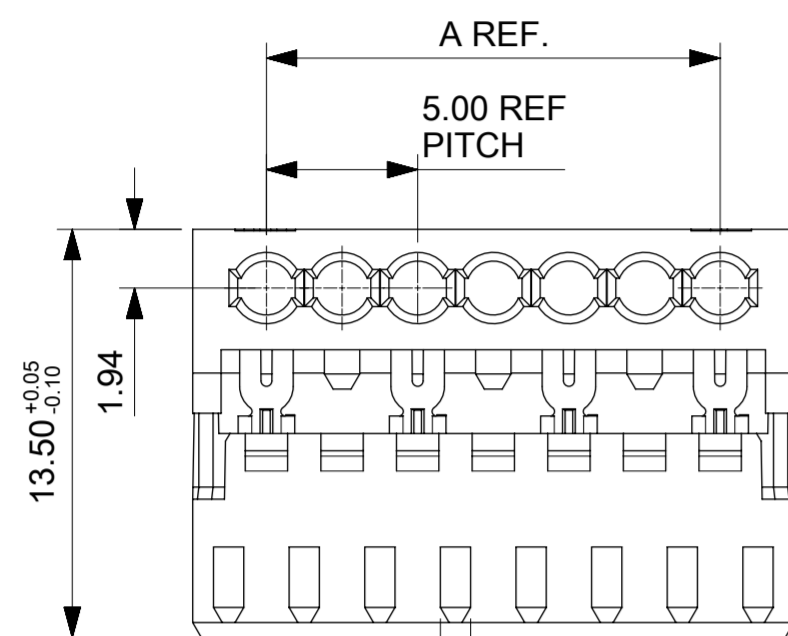
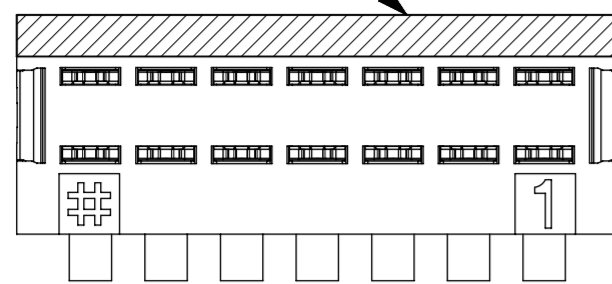

CIRCUIT 1

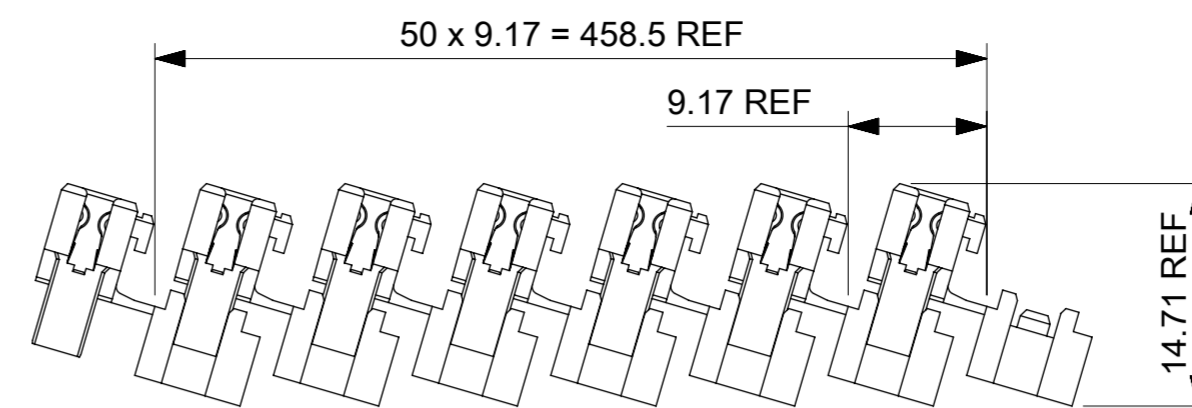

SHIPPING ARRANGEMENT

CCT	A	B
2	5.0	9.875
3	10.0	14.875
4	15.0	19.875
5	20.0	24.875
6	25.0	29.875
7	30.0	34.875
8	35.0	39.875
9	40.0	44.875
10	45.0	49.875

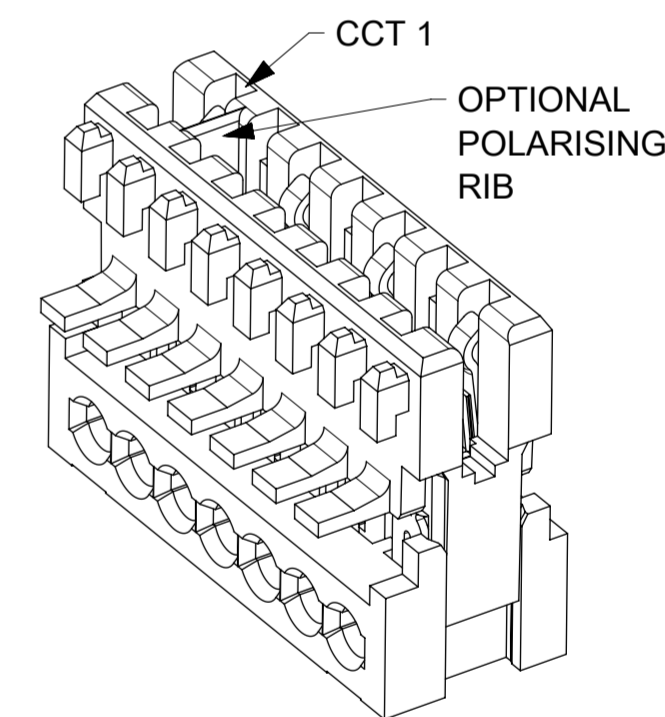
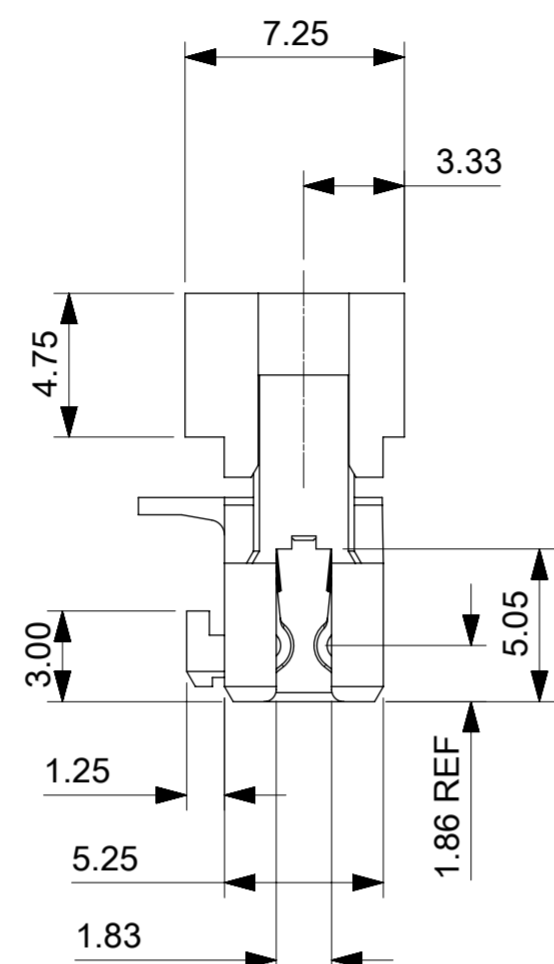

OPEN END WALLS OPTION.

NOTES:

- REFER TO PRODUCT SPECIFICATION: PS-99020-0040.
- MATERIAL: HOUSING - NYLON PA6 UL94-V0, COLOUR: NATURAL (WHITE).
TERMINAL: PHOSPHOR BRONZE 0.30 REF. THICK - PLATING HOT TIN DIP.
- COLOUR STRIPE IS OPTIONAL. AVAILABLE IN THE FOLLOWING COLOURS: BLACK, RED, GREEN, BLUE
- REFER TO PACKAGING SPEC (PK-90871-001).
- REFER TO APPLICATION SPEC (AS-99033-0008)

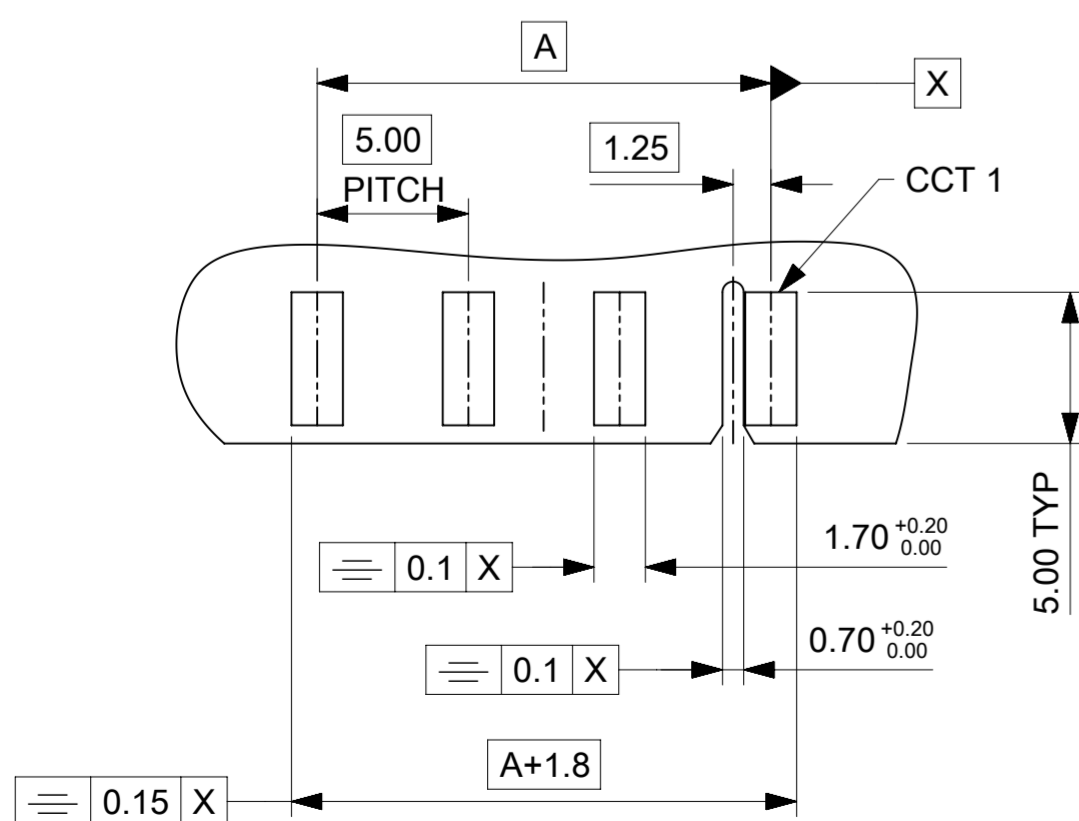

- PCB LAYOUT FOR 4CCT (5mm) CONNECTOR (WITH OPTIONAL POSITIONAL RIB SLOT BETWEEN CCT 1 & 2)
- RECOMMENDED PCB THICKNESS 1.5±0.14MM

THIS DRAWING CONTAINS INFORMATION THAT IS PROPRIETARY TO MOLEX ELECTRONIC TECHNOLOGIES, LLC AND SHOULD NOT BE USED WITHOUT WRITTEN PERMISSION

NX - RELEASE EC NO: 105096 DRWN: CFISHER01 CHKD: CMONAHAN REV: APPR: BRUTTLE	2016/05/06	2016/06/12	2016/07/01	GENERAL TOLERANCES (UNLESS SPECIFIED)	DIMENSION UNITS	SCALE	
				ANGULAR TOL ± 0.5 °	MM		
	4 PLACES	±		CFISHER01	DATE	2016/05/06	
	3 PLACES	±	0.05	CHK'D BY	DATE	CMONAHAN 2016/06/12	
2 PLACES	±	0.1	APPR BY	DATE	BRUTTLE 2016/07/01	PRODUCT CUSTOMER DRAWING	
1 PLACE	±	0.2	DRAFT WHERE APPLICABLE MUST REMAIN WITHIN DIMENSIONS			DRAWING SIZE	THIRD ANGLE PROJECTION
0 PLACES	±					A2	
				SERIES		MATERIAL NUMBER	CUSTOMER
				91717		917170001	
				DOC TYPE	DOC PART	SHEET NUMBER	
				PSD	000	1 OF 4	

2 CIRCUIT

PART NUMBER	HOUSING USED	REMOVED POSITION KEYS	CONFIGURATION	FIRST ENDWALL	LAST ENDWALL	POLARIZING RIB BETWEEN	COLOUR STRIPE
91717-0002	91715-0003	NONE		OPEN	OPEN	NONE	NONE
91717-0003	91715-0003	a		OPEN	OPEN	NONE	NONE
91717-0004	91715-0003	b		OPEN	OPEN	NONE	NONE
91717-0005	91715-0003	c		OPEN	OPEN	NONE	NONE
91717-0006	91715-0003	d		OPEN	OPEN	NONE	NONE
91717-0007	91715-0003	b d		OPEN	OPEN	NONE	NONE
91717-0008	91715-0003	a c		OPEN	OPEN	NONE	NONE
91717-0009	91715-0003	a d		OPEN	OPEN	NONE	NONE
91717-0010	91715-0003	a b		OPEN	OPEN	NONE	NONE
91717-0011	91715-0003	b c		OPEN	OPEN	NONE	NONE
91717-0012	91715-0003	c d		OPEN	OPEN	NONE	NONE
91717-0013	91715-0003	b c		OPEN	OPEN	NONE	RED
91717-0014	91715-0003	b c d		OPEN	OPEN	NONE	NONE
91717-0015	91715-0003	b c d		OPEN	OPEN	NONE	BLUE
91717-0016	91715-0003	c d		OPEN	OPEN	NONE	BLUE
91717-0017	91715-0203	NONE		OPEN	OPEN	CCT 2&3	NONE
91717-0018	91715-0103	NONE		OPEN	OPEN	CCT 1&2	NONE
91717-0019	91715-0003	NONE		OPEN	OPEN	NONE	BLUE
91717-0020	91715-0003	a c		OPEN	OPEN	NONE	BLUE
91717-0021	91715-0003	b c		OPEN	OPEN	NONE	GREEN
91717-0022	91715-0003	a d		OPEN	OPEN	NONE	GREEN
91717-0023	91715-0003	NONE		OPEN	OPEN	NONE	GREEN
91717-0024	91715-0103	d		OPEN	OPEN	CCT 1&2	RED
91717-0025	91715-0103	a c		OPEN	OPEN	CCT 1&2	RED
91717-0026	91715-0203	a		OPEN	OPEN	CCT 2&3	NONE
91717-0027	91715-0203	NONE		OPEN	OPEN	CCT 2&3	RED
91717-0028	91715-0003	a		OPEN	OPEN	NONE	RED
91717-0029	91715-0003	NONE		OPEN	OPEN	NONE	RED
91717-0030	91715-0103	b c d		OPEN	OPEN	CCT 1&2	RED
91717-0031	91715-0203	a		OPEN	OPEN	CCT 2&3	RED

2 CIRCUIT (CONT)

PART NUMBER	HOUSING USED	REMOVED POSITION KEYS	CONFIGURATION	FIRST ENDWALL	LAST ENDWALL	POLARIZING RIB BETWEEN	COLOUR STRIPE
91717-0032	91715-0003	b		OPEN	OPEN	NONE	RED
91717-0033	91715-0003	d		OPEN	OPEN	NONE	YELLOW
91717-0035	91715-0003	b d		OPEN	OPEN	NONE	GREEN
91717-0036	91715-0103	NONE		OPEN	OPEN	CCT 1&2	RED
91717-0037	91715-0103	b d		OPEN	OPEN	CCT 1&2	RED
91717-0038	91715-0203	a c		OPEN	OPEN	CCT 2&3	NONE
91717-0039	91715-0003	a b d		OPEN	OPEN	NONE	NONE
91717-0040	91715-0003	a		OPEN	OPEN	NONE	BLUE

NOTES

- + DENOTES TERMINAL VOIDED POSITION
⊕ DENOTES TERMINAL LOADED POSITION
| DENOTES POLARIZING RIB POSITION
- MOLEX HOUSING NO. FOR REFERENCE ONLY

THIS DRAWING CONTAINS INFORMATION THAT IS PROPRIETARY TO MOLEX ELECTRONIC TECHNOLOGIES, LLC AND SHOULD NOT BE USED WITHOUT WRITTEN PERMISSION

NX - RELEASE EC NO: 105096 DRWN: CFISHER01 CHKD: CMONAHAN REV / APPR: BRUTTLE	2016/05/06	2016/06/12	2016/07/01	GENERAL TOLERANCES (UNLESS SPECIFIED)	DIMENSION UNITS	SCALE	
				ANGULAR TOL ± 0.5 °	MM		
				4 PLACES ±	CFISHER01	2016/05/06	
				3 PLACES ± 0.05	CHK'D BY	DATE	
			2 PLACES ± 0.1	CMONAHAN	2016/06/12	PRODUCT CUSTOMER DRAWING	
			1 PLACE ± 0.2	APPR BY	DATE	SERIES MATERIAL NUMBER CUSTOMER	
			0 PLACES ±	BRUTTLE	2016/07/01	91717	
			DRAFT WHERE APPLICABLE MUST REMAIN WITHIN DIMENSIONS	DRAWING SIZE	THIRD ANGLE PROJECTION	DOCUMENT NUMBER 917170001 DOC TYPE PSD DOC PART 000 SHEET NUMBER 2 OF 4	
A				A2			

3 CIRCUIT							
PART NUMBER	HOUSING USED	REMOVED POSITION KEYS	CONFIGURATION	FIRST ENDWALL	LAST ENDWALL	POLARIZING RIB BETWEEN	COLOUR STRIPE
91717-1001	91715-0005	NONE		OPEN	OPEN	NONE	NONE
91717-1002	91715-0005	b		OPEN	OPEN	NONE	NONE
91717-1003	91715-0005	c		OPEN	OPEN	NONE	NONE
91717-1004	91715-0005	c d e		OPEN	OPEN	NONE	NONE
91717-1005	91715-0405	NONE		OPEN	OPEN	CCT 4&5	NONE
91717-1007	91715-0105	NONE		OPEN	OPEN	CCT 1&2	NONE
91717-1008	91715-0005	d e f		OPEN	OPEN	NONE	RED
91717-1009	91715-0005	a b c		OPEN	OPEN	NONE	RED
91717-1010	91715-0005	a c d e		OPEN	OPEN	NONE	NONE
91717-1011	91715-0005	a c d e		OPEN	OPEN	NONE	BLUE
91717-1012	91715-0005	b c d e		OPEN	OPEN	NONE	NONE
91717-1013	91715-0005	a c e		OPEN	OPEN	NONE	NONE
91717-1014	91715-0005	a e		OPEN	OPEN	NONE	NONE
91717-1015	91715-0005	a e		OPEN	OPEN	NONE	BLACK
91717-1016	91715-0005	d e f		OPEN	OPEN	NONE	NONE
91717-1017	91715-0005	NONE		OPEN	OPEN	NONE	GREEN
91717-1018	91715-0005	d f		OPEN	OPEN	NONE	NONE
91717-1019	91715-0425	NONE		CLOSED	CLOSED	CCT 4&5	NONE
91717-1020	91715-0005	d		OPEN	OPEN	NONE	NONE

4 CIRCUIT							
PART NUMBER	HOUSING USED	REMOVED POSITION KEYS	CONFIGURATION	FIRST ENDWALL	LAST ENDWALL	POLARIZING RIB BETWEEN	COLOUR STRIPE
91717-2001	91715-0007	NONE		OPEN	OPEN	NONE	NONE
91717-2002	91715-0007	a		OPEN	OPEN	NONE	NONE
91717-2003	91715-0007	b		OPEN	OPEN	NONE	NONE
91717-2004	91715-0007	d f		OPEN	OPEN	NONE	NONE
91717-2005	91715-0007	a e g		OPEN	OPEN	NONE	RED
91717-2006	91715-0007	c e		OPEN	OPEN	NONE	NONE
91717-2007	91715-0007	a b d e g		OPEN	OPEN	NONE	NONE
91717-2008	91715-0007	NONE		OPEN	OPEN	NONE	BLUE
91717-2009	91715-0007	a d g		OPEN	OPEN	NONE	BROWN
91717-2010	91715-0007	a b f g h		OPEN	OPEN	NONE	BROWN
91717-2011	91715-0007	NONE		OPEN	OPEN	NONE	GREEN
91717-2014	91715-0007	a c f		OPEN	OPEN	NONE	NONE

NOTES

- + DENOTES TERMINAL VOIDED POSITION
⊕ DENOTES TERMINAL LOADED POSITION
| DENOTES POLARIZING RIB POSITION
- MOLEX HOUSING NO. FOR REFERENCE ONLY

THIS DRAWING CONTAINS INFORMATION THAT IS PROPRIETARY TO MOLEX ELECTRONIC TECHNOLOGIES, LLC AND SHOULD NOT BE USED WITHOUT WRITTEN PERMISSION

NX - RELEASE EC NO: 105096 DRWN: CFISHER01 CHKD: CMONAHAN APPR: BRUTTLE	2016/05/06 2016/06/12 2016/07/01	GENERAL TOLERANCES (UNLESS SPECIFIED) ANGULAR TOL ± 0.5 °	DIMENSION UNITS: MM SCALE:		
	DRWN BY: CFISHER01 DATE: 2016/05/06	4 PLACES ± 3 PLACES ± 0.05 2 PLACES ± 0.1 1 PLACE ± 0.2 0 PLACES ±	CHK'D BY: CMONAHAN DATE: 2016/06/12		APPLI-MATE 2.5 FEMALE 5MM TERMINAL PITCH (MATL: NYLON PA6)
	APPR BY: BRUTTLE DATE: 2016/07/01	DRAFT WHERE APPLICABLE MUST REMAIN WITHIN DIMENSIONS	DRAWING SIZE: A2 THIRD ANGLE PROJECTION		
	A	SERIES: 91717 MATERIAL NUMBER: 917170001 DOCUMENT NUMBER: 917170001	CUSTOMER:		DOC TYPE: PSD DOC PART: 000 SHEET NUMBER: 3 OF 4

5 CIRCUIT							
PART NUMBER	HOUSING USED	REMOVED POSITION KEYS	CONFIGURATION	FIRST ENDWALL	LAST ENDWALL	POLARIZING RIB BETWEEN	COLOUR STRIPE
91717-3001	91715-0009	NONE		OPEN	OPEN	NONE	NONE
91717-3002	91715-0009	b c g h i		OPEN	OPEN	NONE	GREEN
91717-3003	91715-0009	ALL		OPEN	OPEN	NONE	NONE
91717-3004	91715-0009	NONE		OPEN	OPEN	NONE	RED

6 CIRCUIT							
PART NUMBER	HOUSING USED	REMOVED POSITION KEYS	CONFIGURATION	FIRST ENDWALL	LAST ENDWALL	POLARIZING RIB BETWEEN	COLOUR STRIPE
91717-4001	91715-0011	NONE		OPEN	OPEN	NONE	NONE
91717-4002	91715-0011	b c d e f g h i k		OPEN	OPEN	NONE	NONE
91717-4003	91715-0011	NONE		OPEN	OPEN	NONE	GREEN

7 CIRCUIT							
PART NUMBER	HOUSING USED	REMOVED POSITION KEYS	CONFIGURATION	FIRST ENDWALL	LAST ENDWALL	POLARIZING RIB BETWEEN	COLOUR STRIPE
91717-5001	91715-0013	a c e g i k m		OPEN	OPEN	NONE	NONE

8 CIRCUIT							
PART NUMBER	HOUSING USED	REMOVED POSITION KEYS	CONFIGURATION	FIRST ENDWALL	LAST ENDWALL	POLARIZING RIB BETWEEN	COLOUR STRIPE
91717-6001	91715-0015	NONE		OPEN	OPEN	NONE	NONE

9 CIRCUIT							
PART NUMBER	HOUSING USED	REMOVED POSITION KEYS	CONFIGURATION	FIRST ENDWALL	LAST ENDWALL	POLARIZING RIB BETWEEN	COLOUR STRIPE
91717-7001	91715-0017	NONE		OPEN	OPEN	NONE	NONE

10 CIRCUIT							
PART NUMBER	HOUSING USED	REMOVED POSITION KEYS	CONFIGURATION	FIRST ENDWALL	LAST ENDWALL	POLARIZING RIB BETWEEN	COLOUR STRIPE
91717-8001	91715-0019	NONE		OPEN	OPEN	NONE	NONE

NOTES

- + DENOTES TERMINAL VOIDED POSITION
- ⊕ DENOTES TERMINAL LOADED POSITION
- | DENOTES POLARIZING RIB POSITION
- MOLEX HOUSING NO. FOR REFERENCE ONLY

THIS DRAWING CONTAINS INFORMATION THAT IS PROPRIETARY TO MOLEX ELECTRONIC TECHNOLOGIES, LLC AND SHOULD NOT BE USED WITHOUT WRITTEN PERMISSION												
NX - RELEASE EC NO: 105096 DRWN: CFISHER01 CHKD: CMONAHAN REV APPR: BRUTTLE	2016/05/06	2016/06/12	2016/07/01	GENERAL TOLERANCES (UNLESS SPECIFIED)	DIMENSION UNITS	SCALE	molex APPLI-MATE 2.5 FEMALE 5MM TERMINAL PITCH (MATL: NYLON PA6)					
				ANGULAR TOL ± 0.5 °	MM							
				4 PLACES ±	DRWN BY	DATE	PRODUCT CUSTOMER DRAWING					
				3 PLACES ± 0.05	CFISHER01	2016/05/06						
				2 PLACES ± 0.1	CHK'D BY	DATE	SERIES MATERIAL NUMBER CUSTOMER					
			1 PLACE ± 0.2	CMONAHAN	2016/06/12							
			0 PLACES ±	APPR BY	DATE	91717						
			DRAFT WHERE APPLICABLE MUST REMAIN WITHIN DIMENSIONS	BRUTTLE	2016/07/01							
A	DRAWING SIZE		THIRD ANGLE PROJECTION		A2		DOCUMENT NUMBER		DOC TYPE		DOC PART	SHEET NUMBER
						917170001		PSD		000		4 OF 4