



Chipsmall Limited consists of a professional team with an average of over 10 year of expertise in the distribution of electronic components. Based in Hongkong, we have already established firm and mutual-benefit business relationships with customers from,Europe,America and south Asia,supplying obsolete and hard-to-find components to meet their specific needs.

With the principle of "Quality Parts,Customers Priority,Honest Operation,and Considerate Service",our business mainly focus on the distribution of electronic components. Line cards we deal with include Microchip,ALPS,ROHM,Xilinx,Pulse,ON,Everlight and Freescale. Main products comprise IC,Modules,Potentiometer,IC Socket,Relay,Connector.Our parts cover such applications as commercial,industrial, and automotives areas.

We are looking forward to setting up business relationship with you and hope to provide you with the best service and solution. Let us make a better world for our industry!



Contact us

Tel: +86-755-8981 8866 Fax: +86-755-8427 6832

Email & Skype: info@chipsmall.com Web: www.chipsmall.com

Address: A1208, Overseas Decoration Building, #122 Zhenhua RD., Futian, Shenzhen, China



X Lochbild board drillings

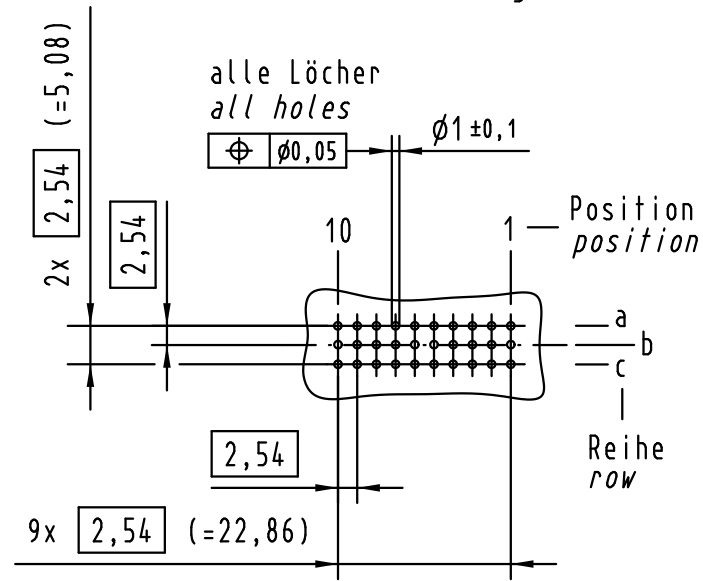

X Kontaktanordnung contact arrangement

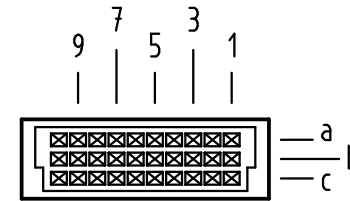

30 Einlöt Kontakte
30 solder contacts

- ☒ = Einlöt Kontakt
= solder contact
- = Kontaktposition nicht belegt
= position without contact

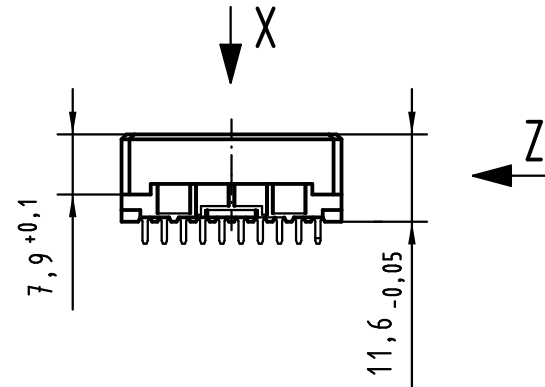

Z (2:1)

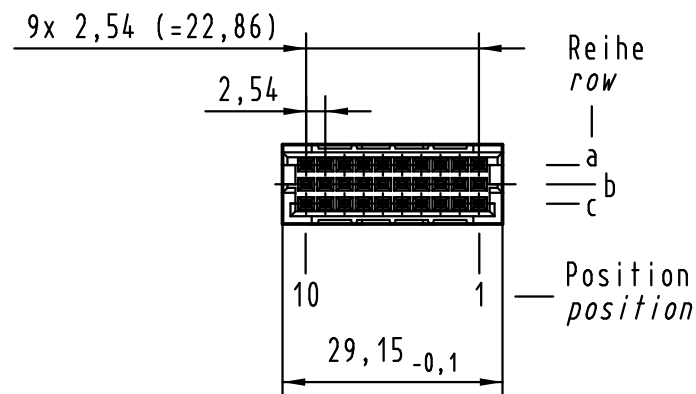
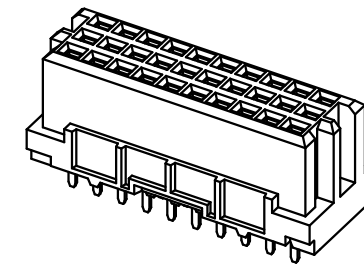
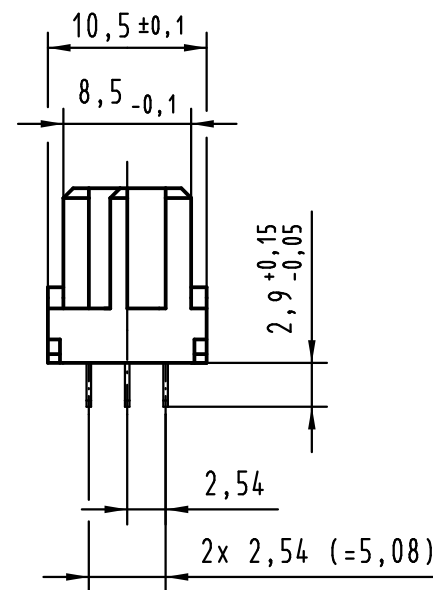

1 weitere Informationen siehe: DS 09 03 213 02 01
further information see: DS 09 03 213 02 01

All Dimensions in mm Original Size DIN A 3			Techn. Character.			Nicht tolerierte Maße/Free size tolerances IEC 60603-2	
				Dat.	Name	Maßstab/Scale	
			Detail.	29.04.09	MR	1:1	har-bus 3C Federleiste ohne Flansch Einlöt 2,9 , 30-polig, SMC (Hochtemperatur) har-bus 3C female connector without flange solder 2.9 , 30-pole, SMC (high temperature)
			Insp.	29.04.09	RA		
			Stand.				
36392	02.08.11	HL.	HARTING Electronics GmbH & Co. KG D-32339 ESPELKAMP			TB 09 25 230 x414	Blatt/ page
35607							
Mod.	Dat.	Name				Sub.	