



Chipsmall Limited consists of a professional team with an average of over 10 year of expertise in the distribution of electronic components. Based in Hongkong, we have already established firm and mutual-benefit business relationships with customers from,Europe,America and south Asia,supplying obsolete and hard-to-find components to meet their specific needs.

With the principle of “Quality Parts,Customers Priority,Honest Operation,and Considerate Service”,our business mainly focus on the distribution of electronic components. Line cards we deal with include Microchip,ALPS,ROHM,Xilinx,Pulse,ON,Everlight and Freescale. Main products comprise IC,Modules,Potentiometer,IC Socket,Relay,Connector.Our parts cover such applications as commercial,industrial, and automotives areas.

We are looking forward to setting up business relationship with you and hope to provide you with the best service and solution. Let us make a better world for our industry!



## Contact us

Tel: +86-755-8981 8866 Fax: +86-755-8427 6832

Email & Skype: info@chipsmall.com Web: www.chipsmall.com

Address: A1208, Overseas Decoration Building, #122 Zhenhua RD., Futian, Shenzhen, China



MATERIAL NO. ON STRIP	MATERIAL NO. LOOSE PIECE	CABLE SIZE	DIM "A"	DIM "B"	USE WITH HOUSING ASSY
933030003	933030005	2.5mm <sup>2</sup> / 14AWG	3.58	3.94	93301-0101
933030004	933030006	4.0-6.0mm <sup>2</sup> / 12-10AWG	4.90	5.51	

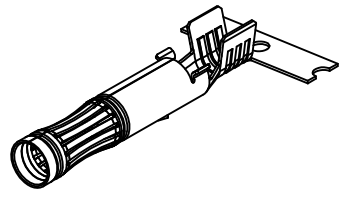
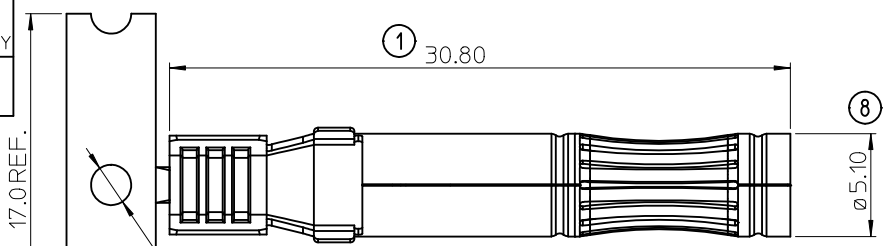

4.0-6.0mm<sup>2</sup>(12-10AWG)  
SCALE 2:1

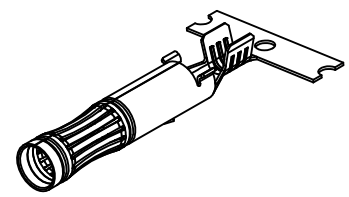
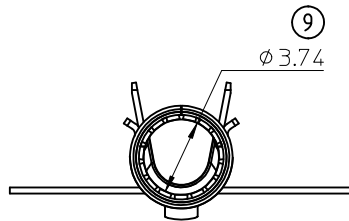
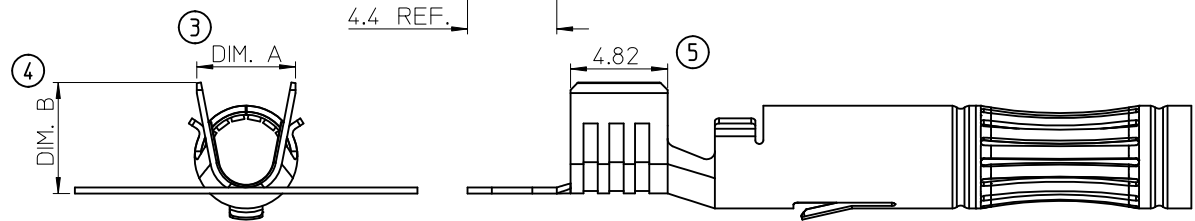

2.5mm<sup>2</sup>(14AWG)  
SCALE 2:1

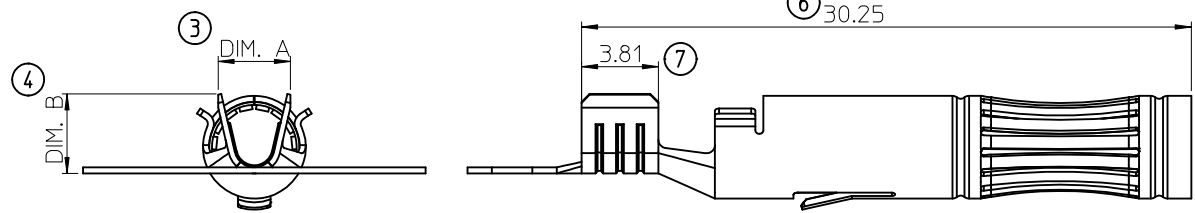

2.5mm<sup>2</sup>(14AWG)  
SAME AS 4-6mm<sup>2</sup>(12-10AWG)  
EXCEPT AS NOTED

NOTES:

1. MATERIAL: COPPER ALLOY 0.30 THK.
2. FINISH: SELECTIVE SILVER OVER NICKEL.
3. TERMINAL FOR USE WITH 93301 SERIES SOCKET HOUSING ASSEMBLY. SEE CHART FOR APPLICABLE PART NUMBERS.
4. PRODUCT SPECIFICATION: PS-93301-001
5. PACKAGING SPEC: PK-93303-001
6. APPLICATION TOOLING AND CRIMP SPECIFICATION: CONSULT FACTORY.
7. PARTS ARE ROHS COMPLIANT.

LAST INSPECTION No USED: 9

ORIGINAL RELEASE EC NO: E2011-0292	DRW:DBYRNES 2011/07/04	QUALITY SYMBOLS ▽=0 ◻=0	GENERAL TOLERANCES (UNLESS SPECIFIED)		DIMENSION STYLE MM ONLY		SCALE 4:1	DESIGN UNITS METRIC	THIRD ANGLE PROJECTION	
	CHKD:SMCGREEVY 2011/08/16		mm	INCH	DRAWN BY DBYRNES	DATE 2011/07/04	TITLE SOLARSPEC SOCKET CONTACT PV SOLAR PANEL MOUNT 2.5MM <sup>2</sup> & 4-6MM <sup>2</sup>			
	APPR:EFOLAN 2011/08/26		4 PLACES ± --- ± ---	3 PLACES ± --- ± ---	CHECKED BY SMCGREEVY	DATE 2011/08/16	MOLEX INCORPORATED			
	1 PLACE ± 0.20 ± ---		ANGULAR ± 2 °		APPROVED BY EFOLAN	DATE 2011/08/26	MATERIAL NO. SEE CHART		DOCUMENT NO. SD-93303-001	SHEET NO. 1 OF 1
1	REV	DRAFT WHERE APPLICABLE MUST REMAIN WITHIN DIMENSIONS		SIZE A3	THIS DRAWING CONTAINS INFORMATION THAT IS PROPRIETARY TO MOLEX INCORPORATED AND SHOULD NOT BE USED WITHOUT WRITTEN PERMISSION					