



Chipsmall Limited consists of a professional team with an average of over 10 year of expertise in the distribution of electronic components. Based in Hongkong, we have already established firm and mutual-benefit business relationships with customers from,Europe,America and south Asia,supplying obsolete and hard-to-find components to meet their specific needs.

With the principle of “Quality Parts,Customers Priority,Honest Operation,and Considerate Service”,our business mainly focus on the distribution of electronic components. Line cards we deal with include Microchip,ALPS,ROHM,Xilinx,Pulse,ON,Everlight and Freescale. Main products comprise IC,Modules,Potentiometer,IC Socket,Relay,Connector.Our parts cover such applications as commercial,industrial, and automotives areas.

We are looking forward to setting up business relationship with you and hope to provide you with the best service and solution. Let us make a better world for our industry!



## Contact us

Tel: +86-755-8981 8866 Fax: +86-755-8427 6832

Email & Skype: info@chipsmall.com Web: www.chipsmall.com

Address: A1208, Overseas Decoration Building, #122 Zhenhua RD., Futian, Shenzhen, China



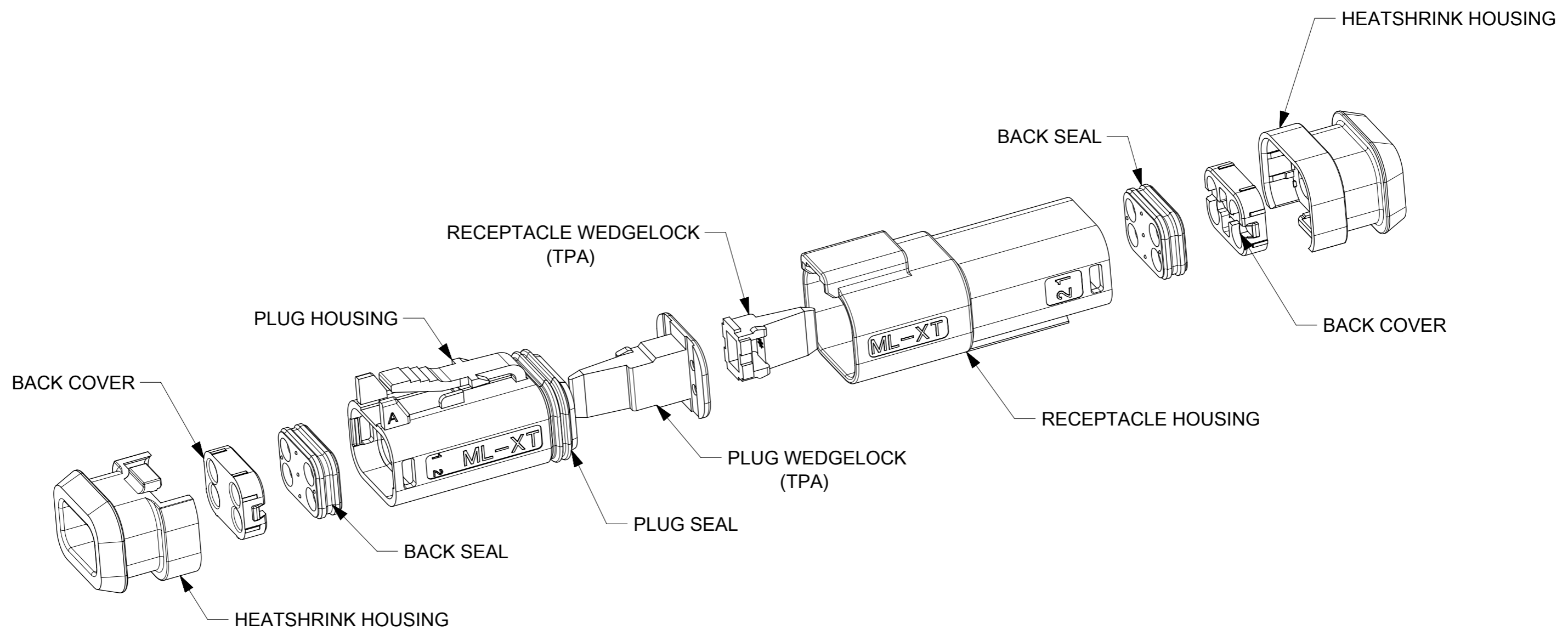

**NOTES**  
 1. SEE SHEETS 2 TO 7 FOR ALL UNSPECIFIED NOTES, DIMENSIONS AND PART NUMBERS

THIS DRAWING CONTAINS INFORMATION THAT IS PROPRIETARY TO MOLEX ELECTRONIC TECHNOLOGIES, LLC AND SHOULD NOT BE USED WITHOUT WRITTEN PERMISSION													
<b>QUALITY SYMBOLS</b> ▽A = 0 ▽E = 0 ▽F = 0 ▼ = 0 ▽C = 0 ⊗ = 0 ■ = 0 ▽ = 0		EC NO: 110489 DRWN: JFLETCHER CHK'D: FDUGGAN REV APPR: JDWALLACE			2016/11/16 2016/11/18 2017/01/03		GENERAL TOLERANCES (UNLESS SPECIFIED) ANGULAR TOL ± 2.0 ° 4 PLACES ± 3 PLACES ± 2 PLACES ± 0.1 1 PLACE ± 0.2 0 PLACES ± DRAFT WHERE APPLICABLE MUST REMAIN WITHIN DIMENSIONS		DIMENSION UNITS: MM SCALE: 1.5:1 DRWN BY: JFLETCHER DATE: 2015/11/02 CHK'D BY: NDOWDS DATE: 2015/11/10 APPR BY: JDWALLACE DATE: 2015/11/16 DRAWING SIZE: A3 THIRD ANGLE PROJECTION		<b>molex</b> 4CCT ML-XT CV CONNECTOR PRODUCT CUSTOMER DRAWING SERIES: 93443 MATERIAL NUMBER: SEE CHART CUSTOMER: GENERAL MARKET DOCUMENT NUMBER: 934430030 DOC TYPE: PSD DOC PART: 000 SHEET NUMBER: 1 OF 9		
RELEASE STATUS: ER RELEASE DATE: 18.11.2016 14:21:32		A2											

4CCT RECEPTACLE CONNECTOR

4CCT RECEPTACLE CONNECTOR WITH HEATSHRINK HOUSING ULTRASONICALLY WELDED IN PLACE

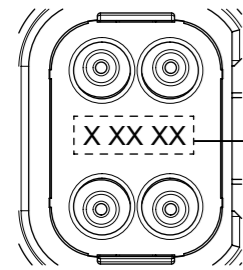
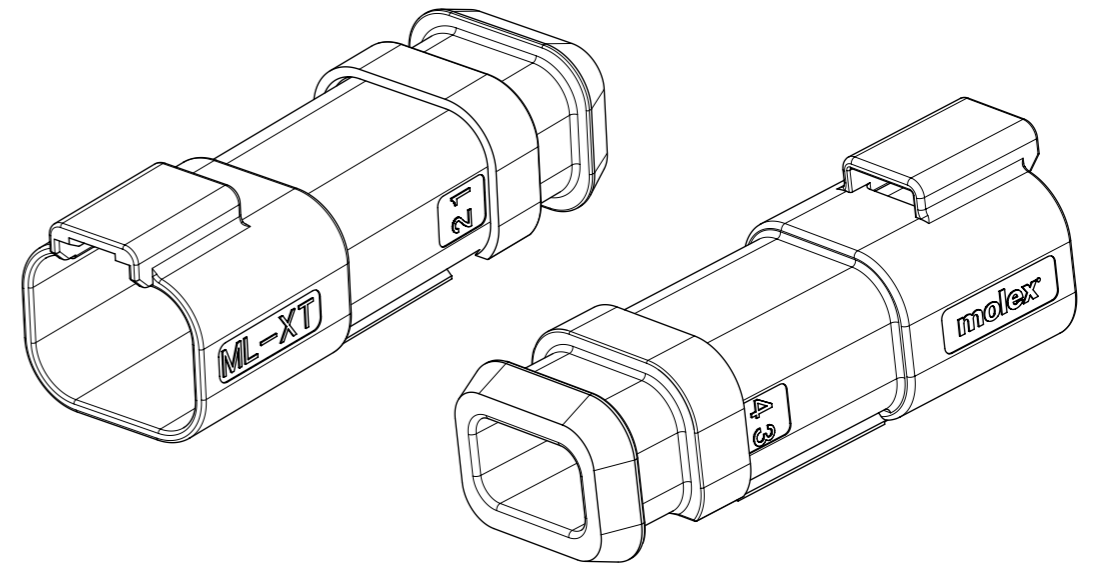
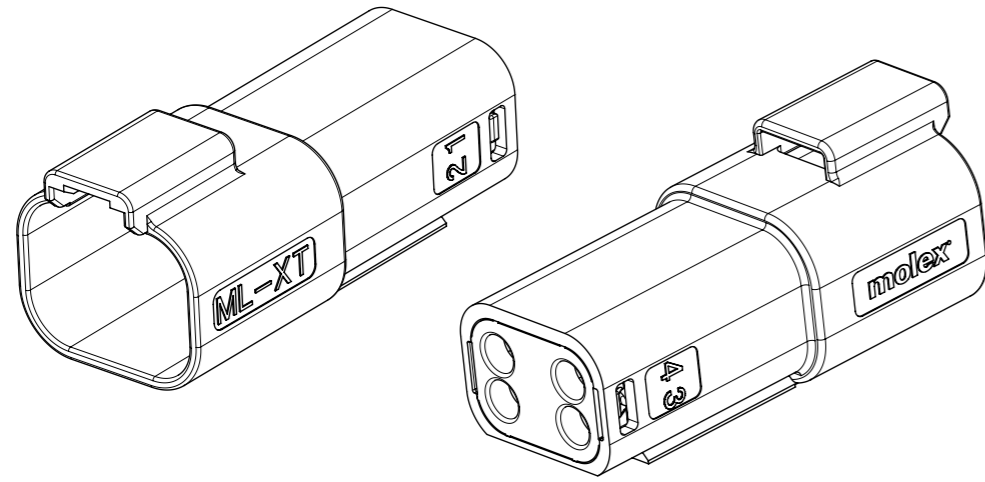

DATE CODE: X XX XX  
 X — DAY: 1-7  
 X — WEEK: 01 - 52  
 X — YEAR: 00 - 99  
 # — MACHINE NO. 1  
 EXAMPLE: 11315 = DAY 1, WEEK 13, YEAR 15  
 i.e. 23rd OF MARCH 2015

DETAIL A  
SCALE 2:1

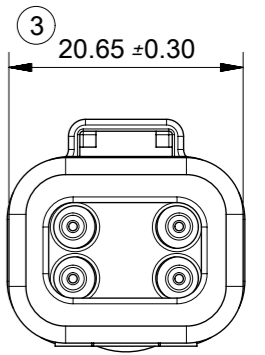
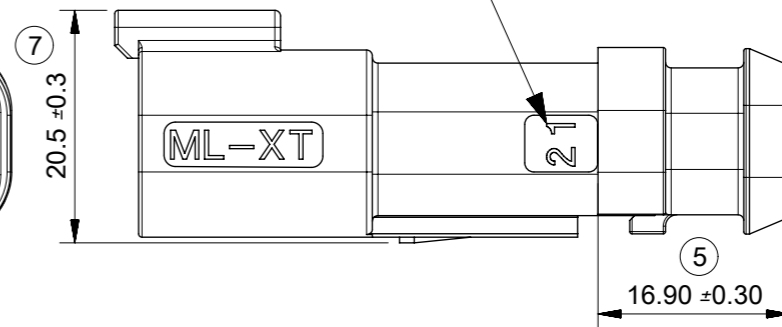
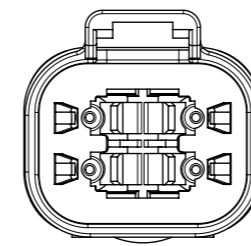
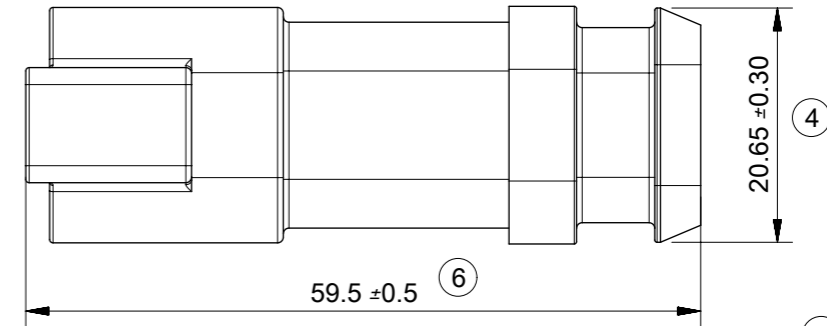
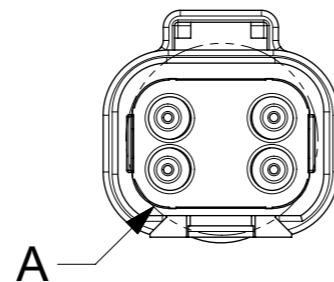
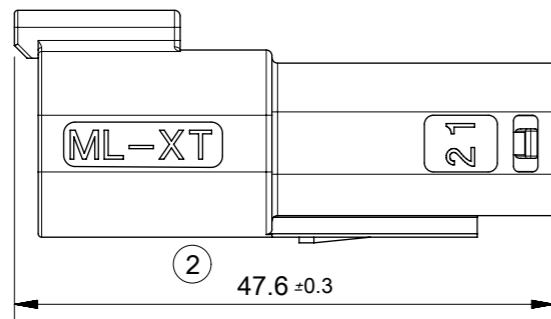
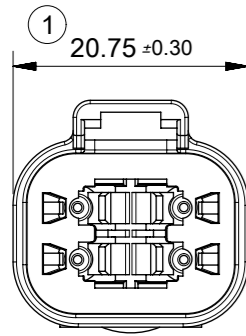

NOTE 2

1. MATERIAL  
HOUSING: NYLON 30%GF  
BACK SEAL: HIGH CONSISTENCY RUBBER
2. CIRCUIT IDENTIFICATION
3. JACKET RANGE LARGE = Ø2.7MM TO 3.6MM (SEAL COLOUR: LIGHT BLUE)  
JACKET RANGE SMALL = Ø1.4MM TO 2.7MM (SEAL COLOUR: BURNT ORANGE)
4. SEE SHEET 3 FOR FINAL PART NUMBER
5. SEE 934430010 PS P FOR PRODUCT SPECIFICATION
6. SEE 934430002 PS K OR 934430010 PS K FOR PACKAGING SPECIFICATION
- INSPECTION NUMBERS 1 - 50 RESERVED FOR SHEET 2
- LAST INSPECTION NO. 7

THIS DRAWING CONTAINS INFORMATION THAT IS PROPRIETARY TO MOLEX ELECTRONIC TECHNOLOGIES, LLC AND SHOULD NOT BE USED WITHOUT WRITTEN PERMISSION										
QUALITY SYMBOLS	EC NO: 110489 DRWN: JFLETCHER CHK'D: FDUGGAN APPR: JDWALLACE	2016/11/16 2016/11/18 2017/01/03	GENERAL TOLERANCES (UNLESS SPECIFIED)		DIMENSION UNITS	SCALE				
			ANGULAR TOL ± 2.0 °		MM	1.5:1				
▽ = 0	SEE LONG TEXT	A2	4 PLACES ±	DRAFT WHERE APPLICABLE MUST REMAIN WITHIN DIMENSIONS	DRWN BY	DATE	4CCT ML-XT CV CONNECTOR			
▽ = 0			3 PLACES ±		JFLETCHER	2015/11/02				
▽ = 0			2 PLACES ± 0.1		CHK'D BY	DATE	PRODUCT CUSTOMER DRAWING			
▽ = 0			1 PLACE ± 0.2		NDOWDS	2015/11/10				
▽ = 0			0 PLACES ±		APPR BY	DATE	SERIES	MATERIAL NUMBER	CUSTOMER	
▽ = 0							93443	SEE CHART	GENERAL MARKET	
▽ = 0				DRAWING SIZE	THIRD ANGLE PROJECTION	DOCUMENT NUMBER	DOC TYPE	DOC PART	SHEET NUMBER	
				A3		934430030	PSD	000	2 OF 9	

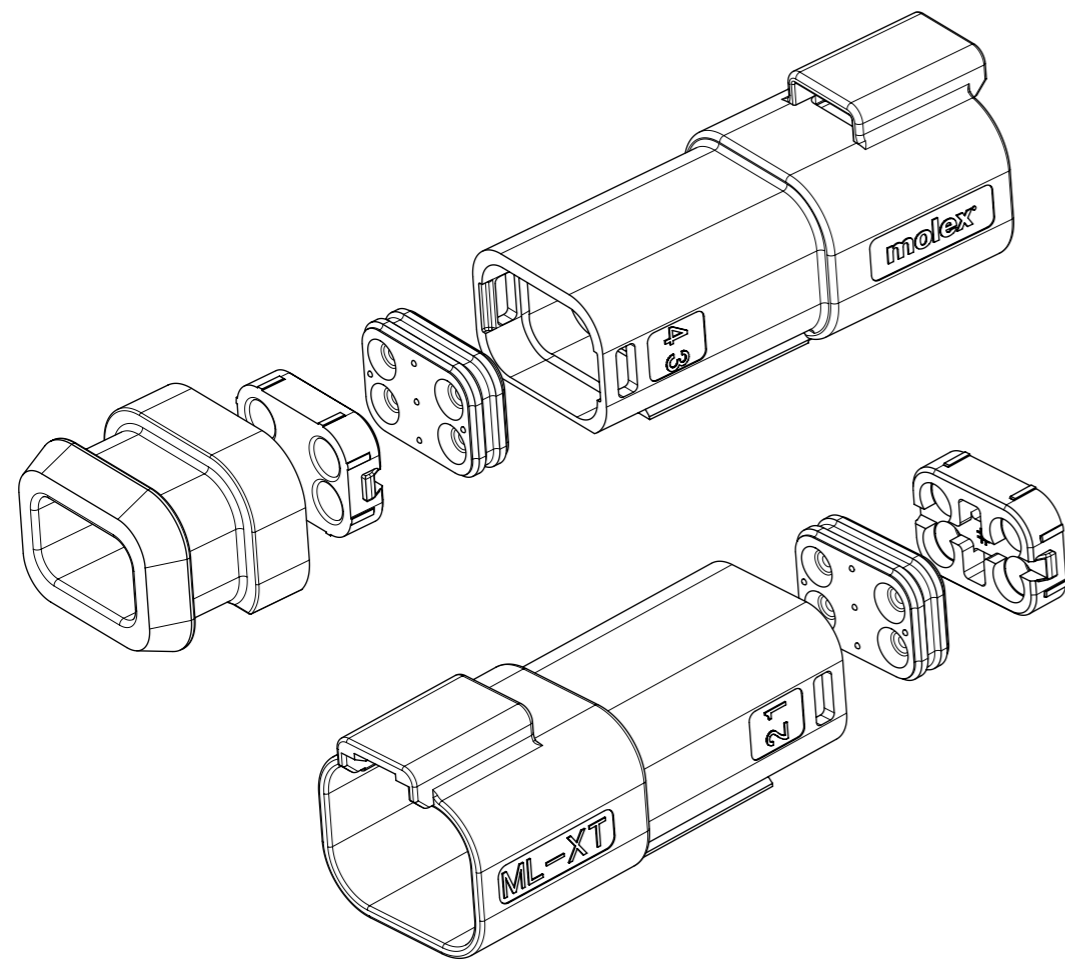

**4CCT RECEPTACLE CONNECTOR**

**SERIES No.** 93444

**CIRCUIT SIZE**  
3 = 4CCT

**ASSEMBLY OPTIONS:**  
 1 = RECEP ASSEMBLY FOR WIRE JACKET RANGE: Ø1.4mm-2.7mm (NOTE 2)  
 2 = RECEP ASSEMBLY FOR WIRE JACKET RANGE: Ø2.7mm-3.6mm (NOTE 2)  
 5 = RECEP ASSEMBLY & HEATSHRINK FOR WIRE JACKET RANGE: Ø1.4mm-2.7mm  
 6 = RECEP ASSEMBLY & HEATSHRINK FOR WIRE JACKET RANGE: Ø2.7mm-3.6mm

**COLOUR**  
 01=BLACK 06=WHITE  
 02=GREY 07=BROWN  
 03=GREEN 08=ORANGE  
 04=BLUE 09=RED

**EXAMPLE:**  
 4cct RECEP BLACK WITH LARGE SEAL AND HEATSHRINK = 93444-3601

**NOTES**  
 1. SEE SHEET 2 FOR UNSPECIFIED NOTES AND DIMENSIONS  
 2. BACK COVER HOUSING COLOUR BLACK  
 3. HEATSHRINK HOUSING COLOUR BLACK

<b>QUALITY SYMBOLS</b> ▽A = 0 ▽E = 0 ▽F = 0 ▽ = 0 ▽C = 0 ▽X = 0 ▽ = 0 ▽ = 0	THIS DRAWING CONTAINS INFORMATION THAT IS PROPRIETARY TO MOLEX ELECTRONIC TECHNOLOGIES, LLC AND SHOULD NOT BE USED WITHOUT WRITTEN PERMISSION										
	SEE LONG TEXT EC NO: 110489 DRWN: JFLETCHER CHK'D: FDUGGAN APPR: JDWALLACE	GENERAL TOLERANCES (UNLESS SPECIFIED)		DIMENSION UNITS	SCALE						
		ANGULAR TOL ± 2.0 °		MM	1:1						
		4 PLACES ±	DRWN BY		DATE	<b>4CCT ML-XT CV CONNECTOR</b>					
		3 PLACES ±	JFLETCHER		2015/11/02						
		2 PLACES ± 0.1	CHK'D BY		DATE	<b>PRODUCT CUSTOMER DRAWING</b>					
	1 PLACE ± 0.2	NDOWDS		2015/11/10							
	0 PLACES ±	APPR BY		DATE	SERIES		MATERIAL NUMBER		CUSTOMER		
	DRAFT WHERE APPLICABLE MUST REMAIN WITHIN DIMENSIONS	JDWALLACE		2015/11/16	93443	SEE CHART		GENERAL MARKET			
		DRAWING SIZE		THIRD ANGLE PROJECTION	DOCUMENT NUMBER		DOC TYPE	DOC PART	SHEET NUMBER		
	A3			934430030		PSD	000	3 OF 9			

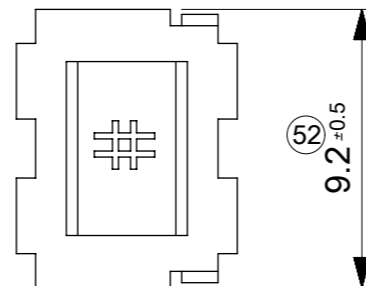
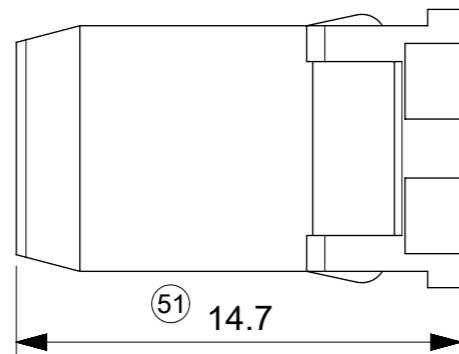
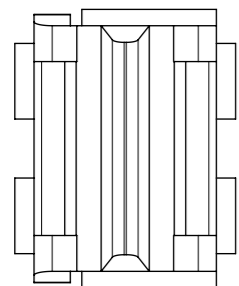
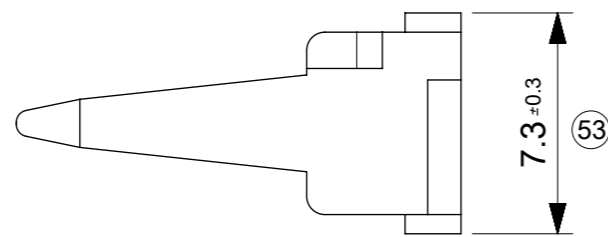
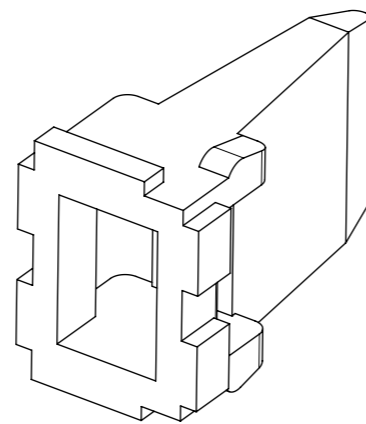
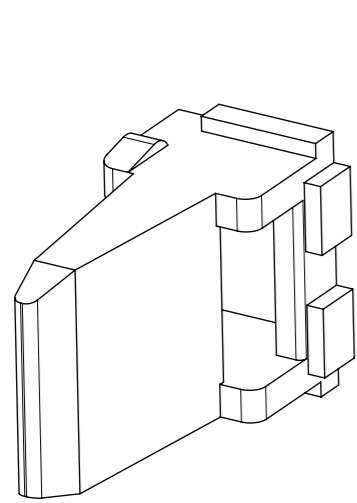

4CCT RECEP. WEDGELOCK

SERIES NO. 93447 3 0 --

CIRCUIT SIZE  
3 = 4CCT

COLOUR/KEYING  
03 = GREEN (NO KEY)  
12 = GREY A KEY  
21 = BLACK B KEY  
33 = GREEN C KEY  
47 = BROWN D KEY

NOTES

1. MATERIAL  
HOUSING: NYLON 30%GF
2. INSPECTION NUMBERS 51-100  
RESERVED FOR SHEET 4
3. PART NUMBER 934473003 SHOWN  
LAST INSPECTION NUMBER 53

THIS DRAWING CONTAINS INFORMATION THAT IS PROPRIETARY TO MOLEX ELECTRONIC TECHNOLOGIES, LLC AND SHOULD NOT BE USED WITHOUT WRITTEN PERMISSION											
QUALITY SYMBOLS		EC NO: 110489		GENERAL TOLERANCES (UNLESS SPECIFIED)		DIMENSION UNITS		SCALE			
▽A	= 0	2016/11/16		ANGULAR TOL ± 2.0 °		MM		1.5:1			
▽E	= 0	DRWN: JFLETCHER		4 PLACES ±		DRWN BY		DATE		4CCT ML-XT CV CONNECTOR	
▽EB	= 0	2016/11/18		3 PLACES ±		JFLETCHER		2015/11/02			
▽	= 0	CHK'D: FDUGGAN		2 PLACES ± 0.1		CHK'D BY		DATE		PRODUCT CUSTOMER DRAWING	
▽C	= 0	2017/01/03		1 PLACE ± 0.2		NDOWDS		2015/11/10			
▽	= 0	APPR: JDWALLACE		0 PLACES ±		APPR BY		DATE		SERIES: 93443 MATERIAL NUMBER: SEE CHART CUSTOMER: GENERAL MARKET	
▽	= 0	REV		DRAFT WHERE APPLICABLE MUST REMAIN WITHIN DIMENSIONS		JDWALLACE		2015/11/16			
▽	= 0	A2				DRAWING SIZE		THIRD ANGLE PROJECTION		DOCUMENT NUMBER: 934430030 DOC TYPE: PSD DOC PART: 000 SHEET NUMBER: 4 OF 9	
▽	= 0					A3					

934473012 (KEY A)  
COLOUR GREY

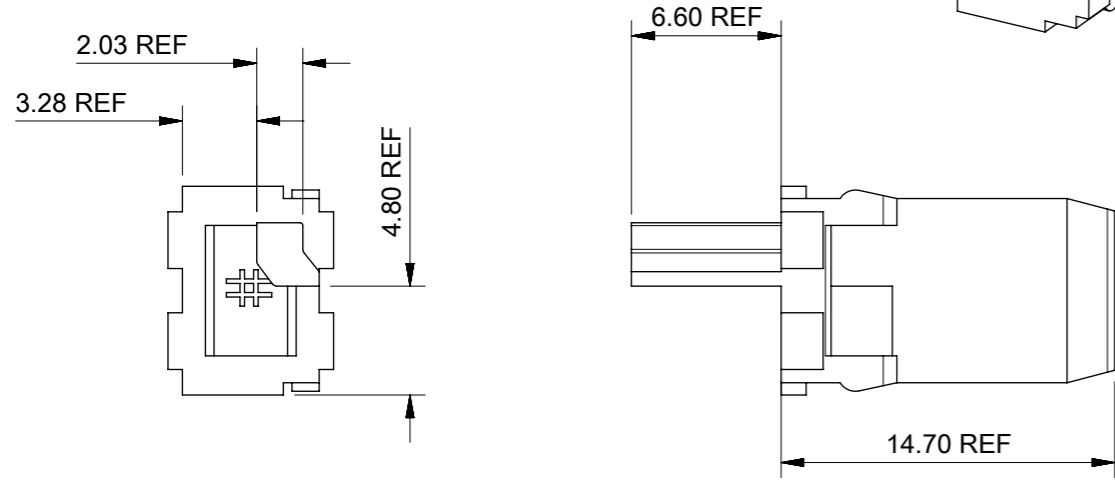

934473021 (KEY B)  
COLOUR BLACK

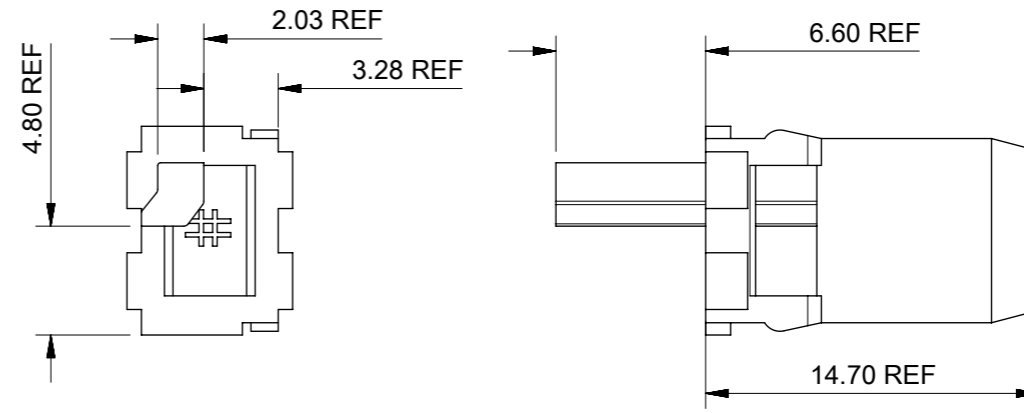

934473033 (KEY C)  
COLOUR GREEN

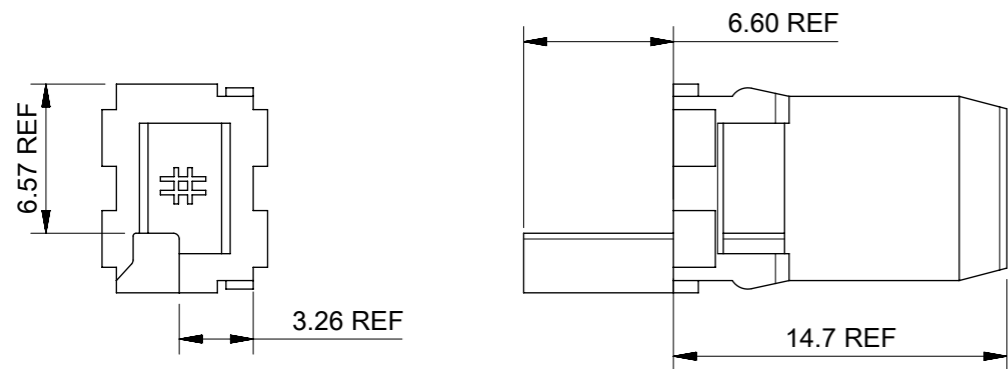

934473047 (KEY D)  
COLOUR BROWN

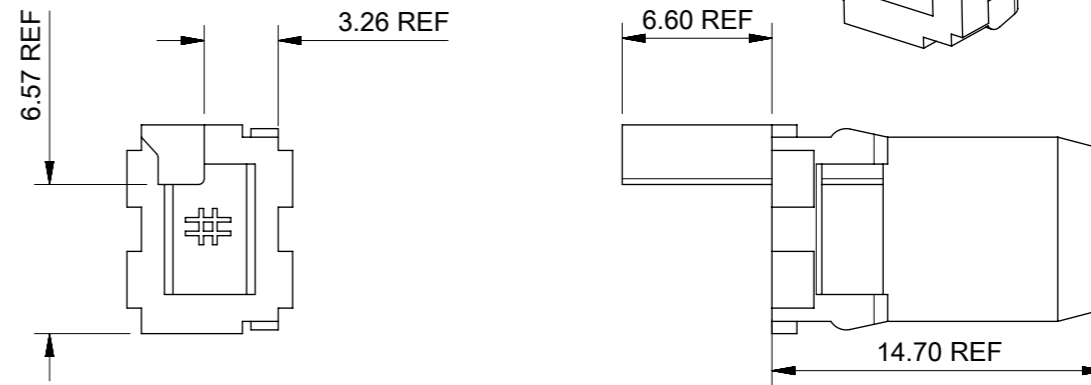

NOTES:  
1. MATERIAL PA66 30%GF  
2. SEE SHEET 4 FOR UNSPECIFIED NOTES & DIMENSIONS

THIS DRAWING CONTAINS INFORMATION THAT IS PROPRIETARY TO MOLEX ELECTRONIC TECHNOLOGIES, LLC AND SHOULD NOT BE USED WITHOUT WRITTEN PERMISSION											
QUALITY SYMBOLS		2016/11/16 2016/11/18 2017/01/03		GENERAL TOLERANCES (UNLESS SPECIFIED)		DIMENSION UNITS		SCALE		 <b>4CCT ML-XT CV CONNECTOR</b> PRODUCT CUSTOMER DRAWING	
▽A	= 0	SEE LONG TEXT	EC NO: 110489 DRWN: JFLETCHER CHK'D: FDUGGAN APP: JDWALLACE	4 PLACES ±		MM		3:1			
▽E	= 0			ANGULAR TOL ± 2.0 °		DRWN BY		DATE			
▽B	= 0			3 PLACES ±		JFLETCHER		2015/11/02			
▽	= 0			2 PLACES ± 0.1		CHK'D BY		DATE			
▽C	= 0			1 PLACE ± 0.2		NDOWDS		2015/11/10			
▽D	= 0			0 PLACES ±		APP BY		DATE			
▽	= 0	DRAFT WHERE APPLICABLE MUST REMAIN WITHIN DIMENSIONS		JDWALLACE		2015/11/16		DRAWING SIZE		THIRD ANGLE PROJECTION	
▽	= 0	A2		A3		A3		A3		A3	
RELEASE STATUS		ER		RELEASE DATE		18.11.2016		14:21:32		SERIES	
										93443	
										MATERIAL NUMBER	
										934430030	
										CUSTOMER	
										GENERAL MARKET	
										DOCUMENT NUMBER	
										934430030	
										DOC TYPE	
										PSD	
										DOC PART	
										000	
										SHEET NUMBER	
										5 OF 9	

4CCT PLUG CONNECTOR

4CCT PLUG CONNECTOR WITH HEATSHRINK HOUSING ULTRASONICALLY WELDED IN PLACE

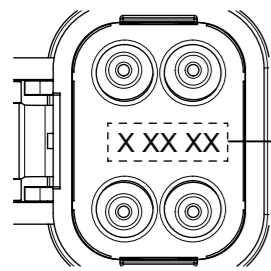
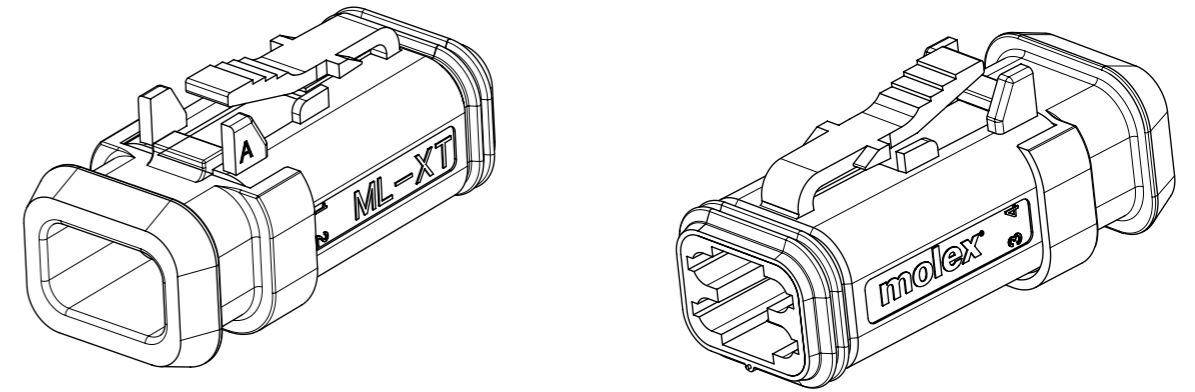
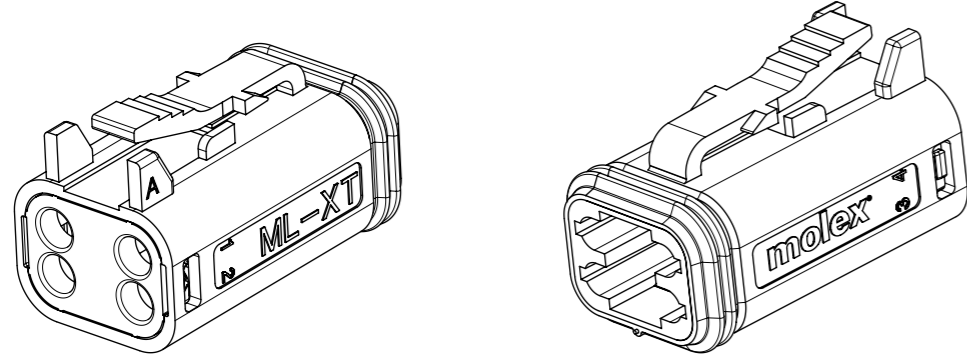

DATE CODE: X XX XX  
 X— DAY: 1- 7  
 X — WEEK: 01 - 52  
 X — YEAR: 00 - 99  
 # — MACHINE NO. 1  
 EXAMPLE: 11315 = DAY 1, WEEK 13, YEAR 15  
 i.e. 23rd OF MARCH 2015

DETAIL B  
SCALE 2:1

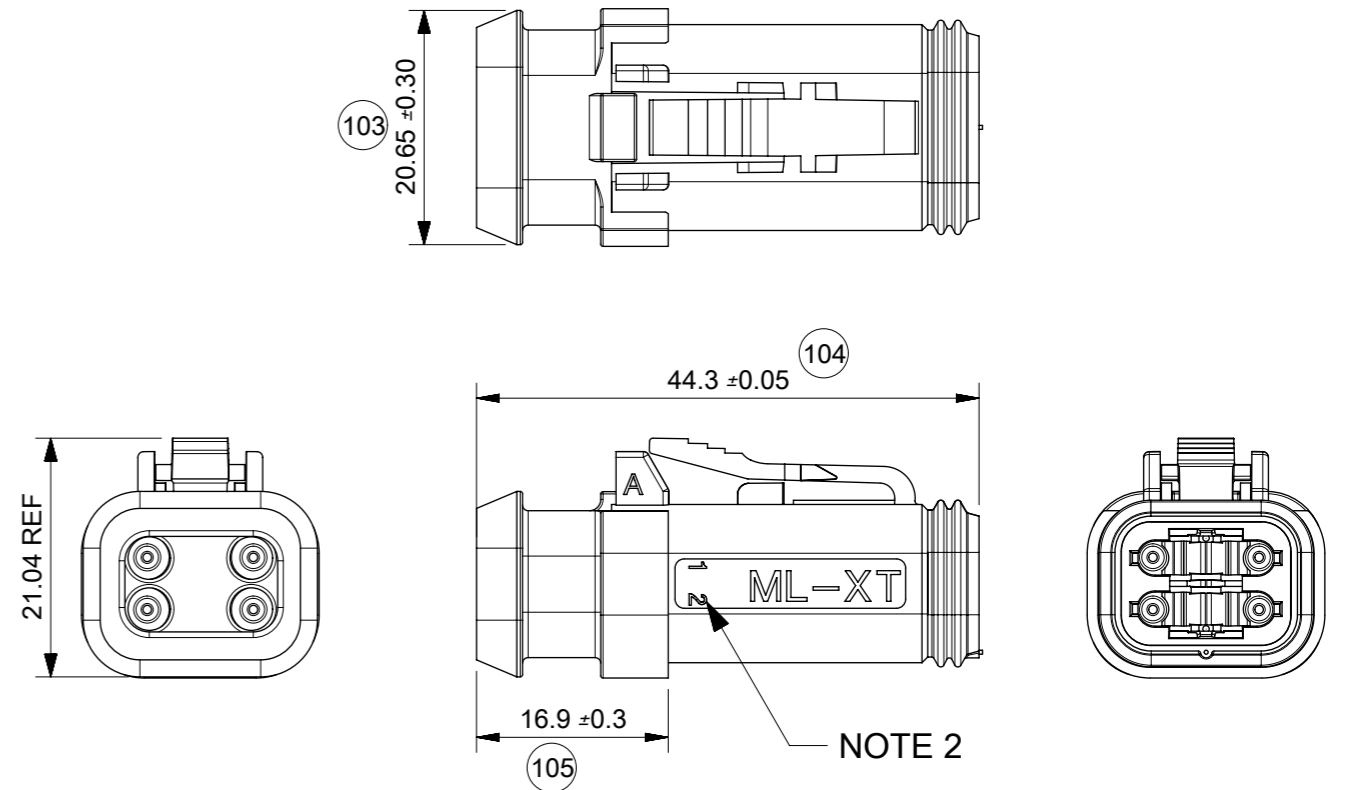
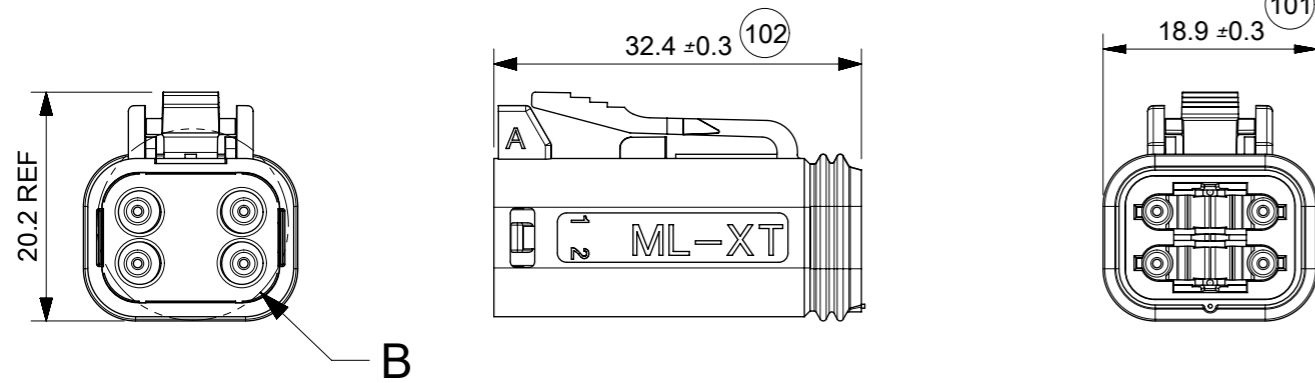

NOTES

- MATERIAL:  
 HOUSING: NYLON 30% GF  
 PLUG SEAL: SILICONE RUBBER  
 BACK SEAL: HIGH CONSISTENCY RUBBER
- CIRCUIT IDENTIFICATION
- JACKET RANGE LARGE = Ø2.7MM TO 3.6MM (SEAL COLOUR: LIGHT BLUE)  
 JACKET RANGE SMALL = Ø1.4MM TO 2.7MM (SEAL COLOUR: BURNT ORANGE)
- SEE SHEET 7 FOR FINAL PART NUMBER DESIGNATION  
 INSPECTION NUMBERS 101-150 RESERVED FOR SHEET 6  
 LAST INSPECTION NUMBER 105

THIS DRAWING CONTAINS INFORMATION THAT IS PROPRIETARY TO MOLEX ELECTRONIC TECHNOLOGIES, LLC AND SHOULD NOT BE USED WITHOUT WRITTEN PERMISSION											
QUALITY SYMBOLS ▽A = 0 ▽E = 0 ▽F = 0 ▼ = 0 ▽C = 0 ⊗ = 0 ■ = 0 ▽ = 0	SEE LONG TEXT EC NO: 110489 DRWN: JFLETCHER CHK'D: FDUGGAN APPR: JDWALLACE	GENERAL TOLERANCES (UNLESS SPECIFIED)		DIMENSION UNITS	SCALE						
		ANGULAR TOL ± 2.0 °		MM	1:1						
		4 PLACES ±	DATE		4CCT ML-XT CV CONNECTOR						
		3 PLACES ±	DATE		PRODUCT CUSTOMER DRAWING						
		2 PLACES ± 0.1	DATE		SERIES	MATERIAL NUMBER	CUSTOMER				
1 PLACE ± 0.2	DATE		93443	SEE CHART	GENERAL MARKET						
0 PLACES ±	DATE		DOCUMENT NUMBER								
DRAFT WHERE APPLICABLE MUST REMAIN WITHIN DIMENSIONS		DRAWING SIZE		THIRD ANGLE PROJECTION		DOC TYPE		DOC PART		SHEET NUMBER	
		A3				934430030		PSD		000 6 OF 9	

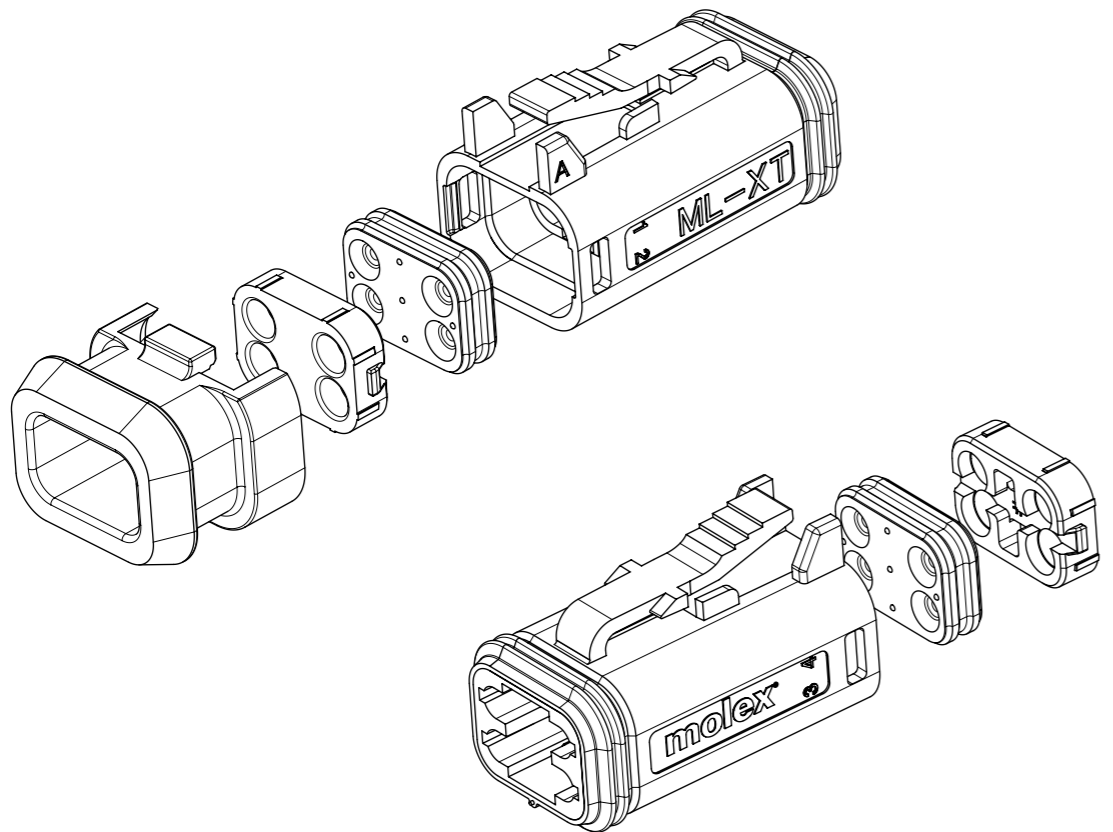

4CCT PLUG CONNECTOR

93445

3

-

--

SERIES No.

CIRCUIT SIZE  
3 = 4CCT

ASSEMBLY OPTIONS:

- 1 = PLUG ASSEMBLY FOR WIRE JACKET RANGE: Ø1.4mm-2.7mm (NOTE 2)
- 2 = PLUG ASSEMBLY FOR WIRE JACKET RANGE: Ø2.7mm-3.6mm (NOTE 2)
- 5 = PLUG ASSEMBLY & HEATSHRINK FOR WIRE JACKET RANGE: Ø1.4mm-2.7mm
- 6 = PLUG ASSEMBLY & HEATSHRINK FOR WIRE JACKET RANGE: Ø2.7mm-3.6mm

COLOUR

- 01=BLACK
- 02=GREY 06=WHITE
- 03=GREEN 07=BROWN
- 04=BLUE 08=ORANGE
- 05=YELLOW 09=RED

EXAMPLE:

4cct PLUG BLACK WITH LARGE SEAL AND HEATSHRINK = 93444-3601

NOTES

- 1. SEE SHEET 6 FOR UNSPECIFIED NOTES AND DIMENSIONS
- 2. BACK COVER HOUSING COLOUR BLACK
- 3. HEATSHRINK HOUSING COLOUR BLACK

THIS DRAWING CONTAINS INFORMATION THAT IS PROPRIETARY TO MOLEX ELECTRONIC TECHNOLOGIES, LLC AND SHOULD NOT BE USED WITHOUT WRITTEN PERMISSION											
<b>QUALITY SYMBOLS</b> ▽A = 0 ▽E = 0 ▽F = 0 ▽G = 0 ▽H = 0 ▽I = 0 ▽J = 0 ▽K = 0 ▽L = 0 ▽M = 0 ▽N = 0 ▽O = 0	SEE LONG TEXT EC NO: 110489 DRWN: JFLETCHER CHK'D: FDUGGAN APPR: JDWALLACE	<b>GENERAL TOLERANCES (UNLESS SPECIFIED)</b> ANGULAR TOL ± 2.0 °		DIMENSION UNITS <b>MM</b>	SCALE <b>1:1</b>						
		4 PLACES ±	DRWN BY <b>JFLETCHER</b>	DATE <b>2015/11/02</b>	<b>4CCT ML-XT CV CONNECTOR</b>						
		3 PLACES ±	CHK'D BY <b>NDOWDS</b>	DATE <b>2015/11/10</b>							
		2 PLACES ± 0.1	APPR BY <b>JDWALLACE</b>		DATE <b>2015/11/16</b>		<b>PRODUCT CUSTOMER DRAWING</b>				
		1 PLACE ± 0.2	DRAWING SIZE <b>A3</b>		THIRD ANGLE PROJECTION		SERIES <b>93443</b>	MATERIAL NUMBER <b>SEE CHART</b>	CUSTOMER <b>GENERAL MARKET</b>		
		0 PLACES ±	DRAFT WHERE APPLICABLE MUST REMAIN WITHIN DIMENSIONS				DOCUMENT NUMBER <b>934430030</b>		DOC TYPE <b>PSD</b>	DOC PART <b>000</b>	SHEET NUMBER <b>7 OF 9</b>



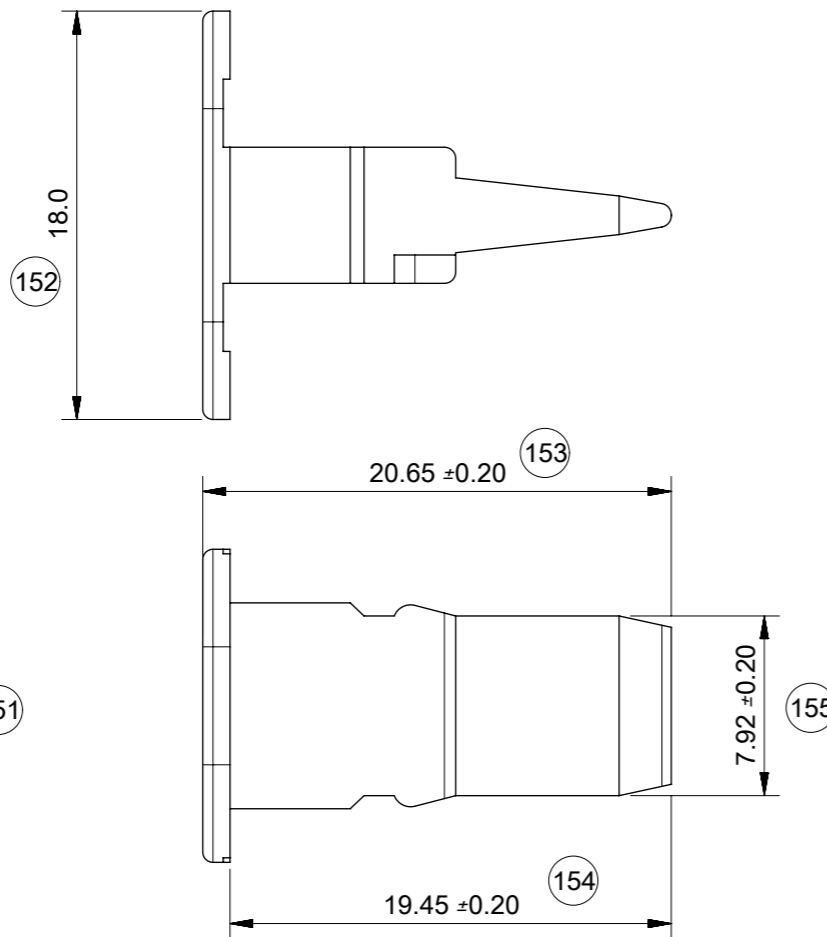
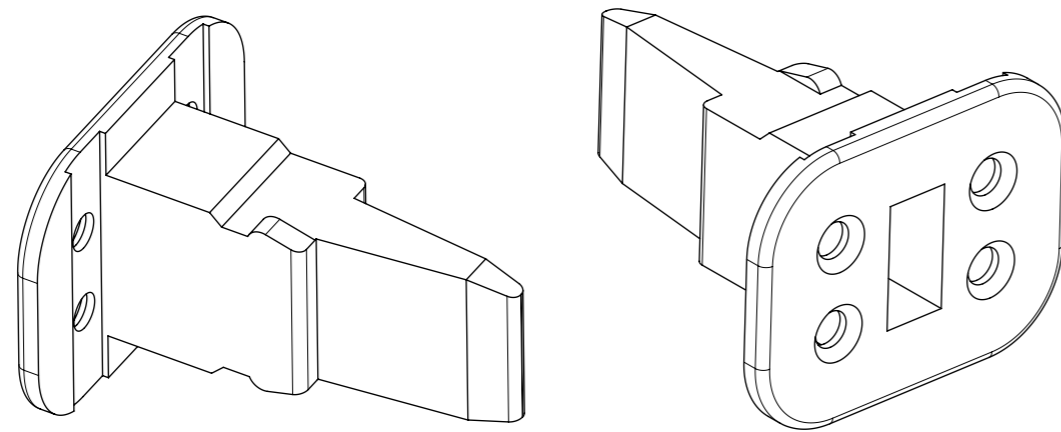

**4CCT PLUG WEDGELOCK**

SERIES NO. 93448

CIRCUIT SIZE 3 = 4CCT

COLOUR/KEYING  
 03 = GREEN (NO KEY)  
 12 = GREY A KEY  
 21 = BLACK B KEY  
 33 = GREEN C KEY  
 47 = BROWN D KEY

**NOTES**  
 1. MATERIAL  
 HOUSING: NYLON 30%GF  
 2. INSPECTION NUMBERS 151-200 RESERVED FOR SHEET 8  
 3. PART NUMBER 934483003 SHOWN  
 LAST INSPECTION NUMBER 155

<b>QUALITY SYMBOLS</b> A = 0 E = 0 F = 0 G = 0 H = 0 I = 0 J = 0 K = 0 L = 0 M = 0 N = 0 O = 0 P = 0 Q = 0 R = 0 S = 0 T = 0 U = 0 V = 0 W = 0 X = 0 Y = 0 Z = 0		THIS DRAWING CONTAINS INFORMATION THAT IS PROPRIETARY TO MOLEX ELECTRONIC TECHNOLOGIES, LLC AND SHOULD NOT BE USED WITHOUT WRITTEN PERMISSION		DIMENSION UNITS <b>MM</b>		SCALE <b>3:1</b>					
EC NO: 110489 DRWN: JFLETCHER CHK'D: FDUGGAN APPR: JDWALLACE		GENERAL TOLERANCES (UNLESS SPECIFIED) ANGULAR TOL ± 2.0 ° 4 PLACES ± 3 PLACES ± 2 PLACES ± 0.1 1 PLACE ± 0.2 0 PLACES ±		DRWN BY <b>JFLETCHER</b>		DATE <b>2015/11/02</b>					<b>4CCT ML-XT CV CONNECTOR</b>
SEE LONG TEXT		DRAFT WHERE APPLICABLE MUST REMAIN WITHIN DIMENSIONS		CHK'D BY <b>NDOWDS</b>		DATE <b>2015/11/10</b>		<b>PRODUCT CUSTOMER DRAWING</b>			
A2		REV		APPR BY <b>JDWALLACE</b>		DATE <b>2015/11/16</b>					SERIES <b>93443</b>
RELEASE STATUS <b>ER</b>		RELEASE DATE <b>18.11.2016 14:21:32</b>		DRAWING SIZE <b>A3</b>		THIRD ANGLE PROJECTION		DOCUMENT NUMBER <b>934430030</b>	DOC TYPE <b>PSD</b>	DOC PART <b>000</b>	SHEET NUMBER <b>8 OF 9</b>

934483012 (KEY A)  
COLOUR GREY

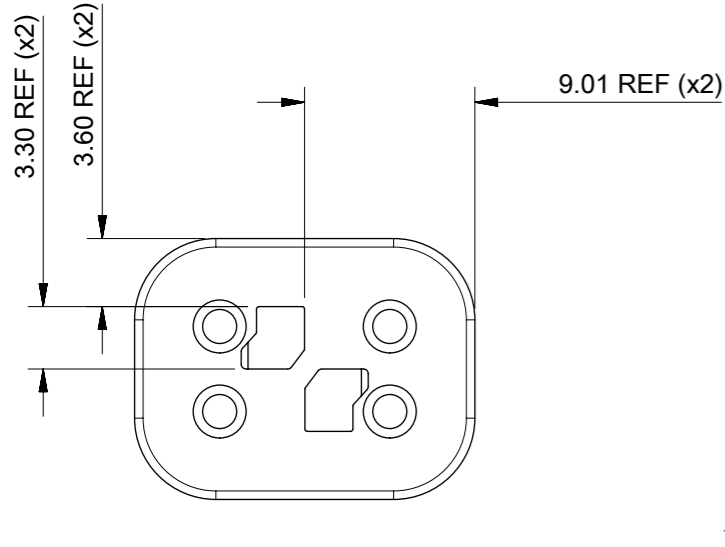
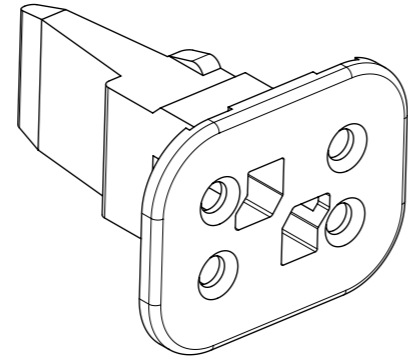

934483021 (KEY B)  
COLOUR BLACK

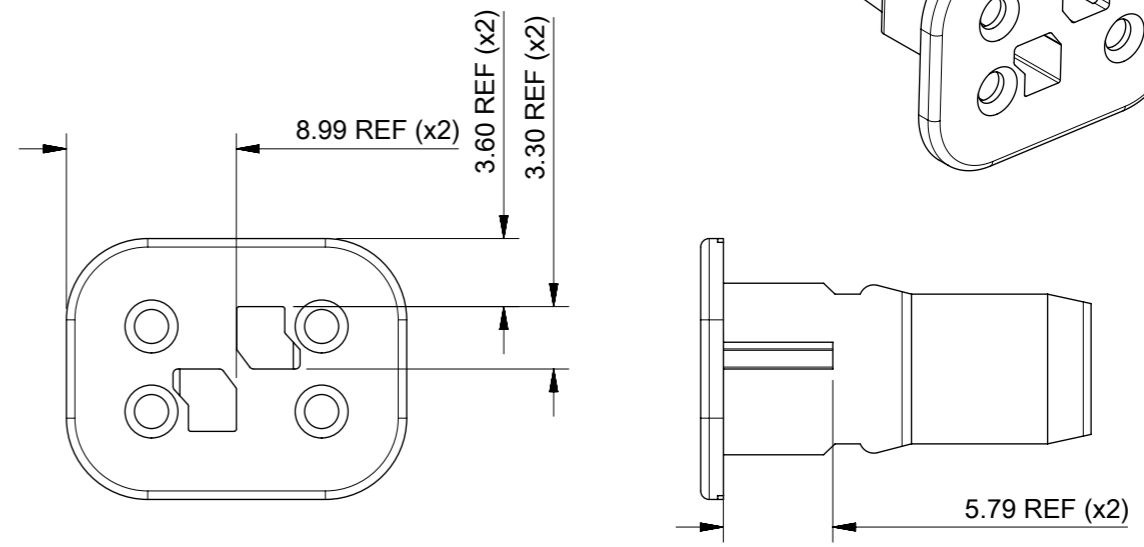
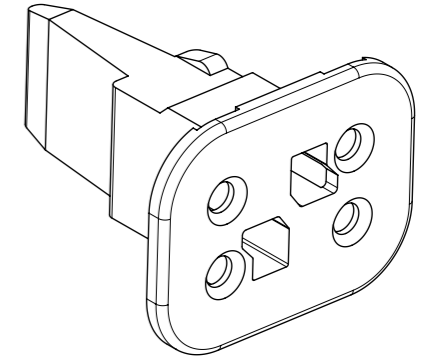

934483033 (KEY C)  
COLOUR GREEN

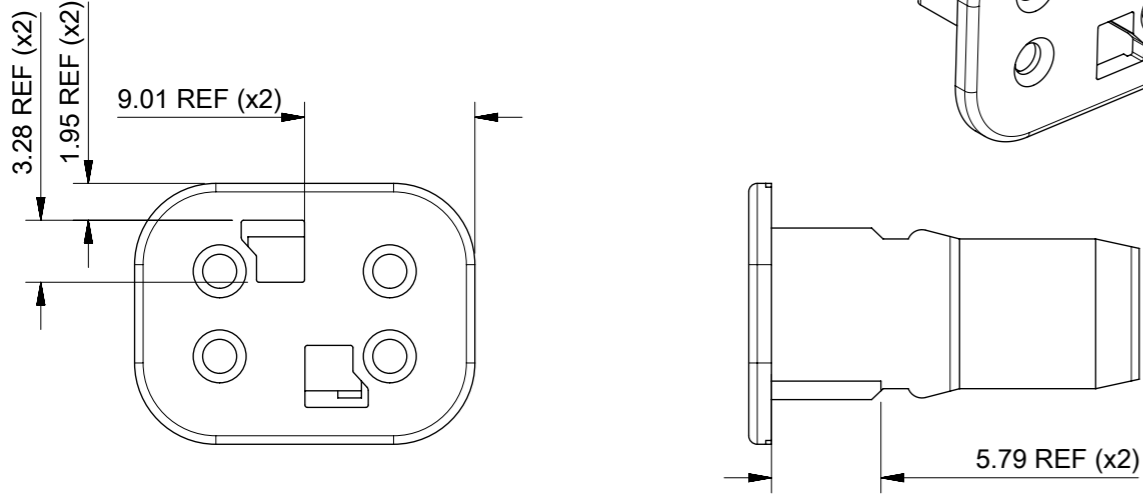
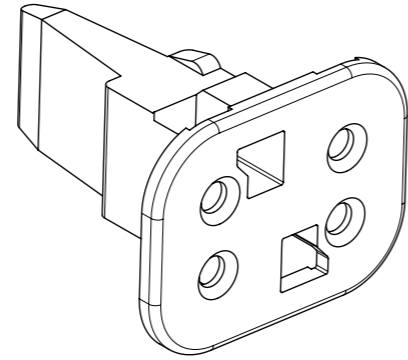

934483047 (KEY D)  
COLOUR BROWN

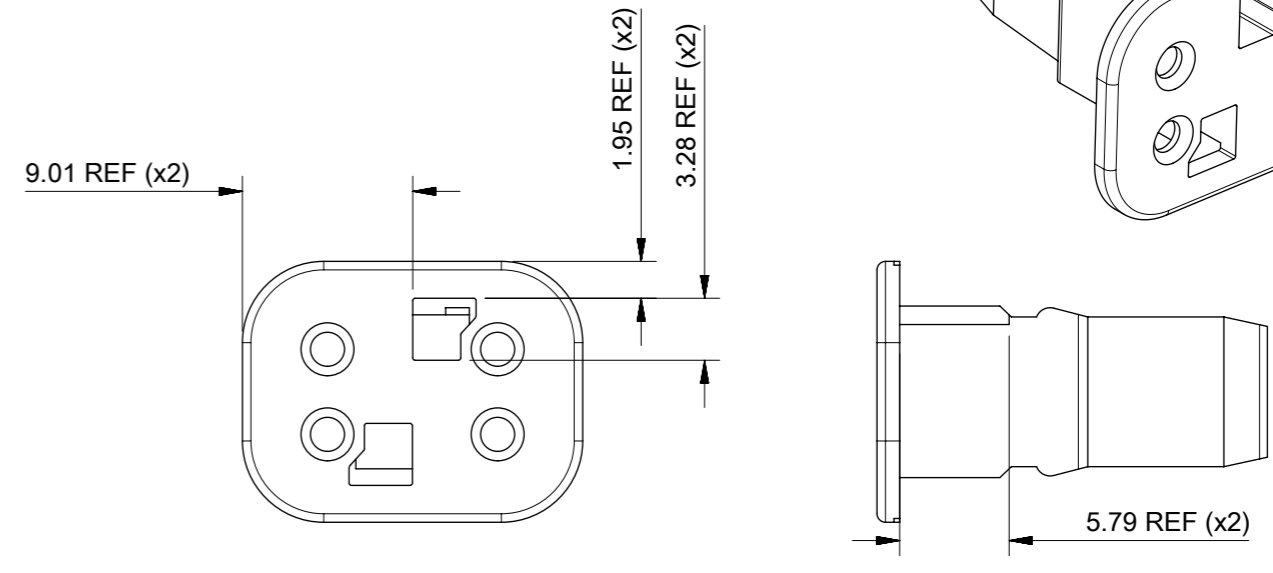
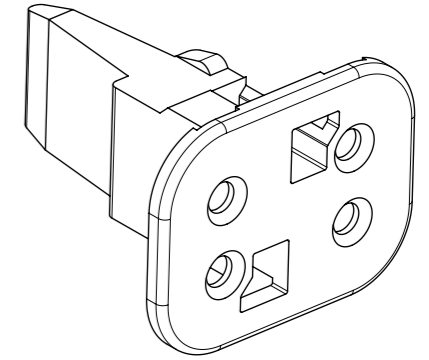

NOTES:  
1. MATERIAL PA66 30%GF  
2. SEE SHEET 4 FOR UNSPECIFIED NOTES & DIMENSIONS

THIS DRAWING CONTAINS INFORMATION THAT IS PROPRIETARY TO MOLEX ELECTRONIC TECHNOLOGIES, LLC AND SHOULD NOT BE USED WITHOUT WRITTEN PERMISSION											
QUALITY SYMBOLS		GENERAL TOLERANCES (UNLESS SPECIFIED)			DIMENSION UNITS		SCALE				
▽A	= 0	ANGULAR TOL ± 2.0 °			MM		2.5:1				
▽E	= 0	4 PLACES ±			DRWN BY		DATE		4CCT ML-XT CV CONNECTOR		
▽B	= 0	3 PLACES ±			JFLETCHER		2015/11/02				
▽	= 0	2 PLACES ± 0.1			CHK'D BY		DATE		PRODUCT CUSTOMER DRAWING		
▽C	= 0	1 PLACE ± 0.2			NDOWDS		2015/11/10				
⊗	= 0	0 PLACES ±			APPR BY		DATE		SERIES: 93443    MATERIAL NUMBER: SEE CHART    CUSTOMER: GENERAL MARKET		
■	= 0	DRAFT WHERE APPLICABLE MUST REMAIN WITHIN DIMENSIONS			JDWALLACE		2015/11/16				
▽	= 0	SEE LONG TEXT			DRAWING SIZE		THIRD ANGLE PROJECTION		DOCUMENT NUMBER: 934430030    DOC TYPE: PSD    DOC PART: 000    SHEET NUMBER: 9 OF 9		
A2		A3									