



Chipsmall Limited consists of a professional team with an average of over 10 year of expertise in the distribution of electronic components. Based in Hongkong, we have already established firm and mutual-benefit business relationships with customers from,Europe,America and south Asia,supplying obsolete and hard-to-find components to meet their specific needs.

With the principle of “Quality Parts,Customers Priority,Honest Operation,and Considerate Service”,our business mainly focus on the distribution of electronic components. Line cards we deal with include Microchip,ALPS,ROHM,Xilinx,Pulse,ON,Everlight and Freescale. Main products comprise IC,Modules,Potentiometer,IC Socket,Relay,Connector.Our parts cover such applications as commercial,industrial, and automotives areas.

We are looking forward to setting up business relationship with you and hope to provide you with the best service and solution. Let us make a better world for our industry!



## Contact us

Tel: +86-755-8981 8866 Fax: +86-755-8427 6832

Email & Skype: info@chipsmall.com Web: www.chipsmall.com

Address: A1208, Overseas Decoration Building, #122 Zhenhua RD., Futian, Shenzhen, China



9 8 7 6 5 4 3 2 1

E  
D  
C  
B  
A

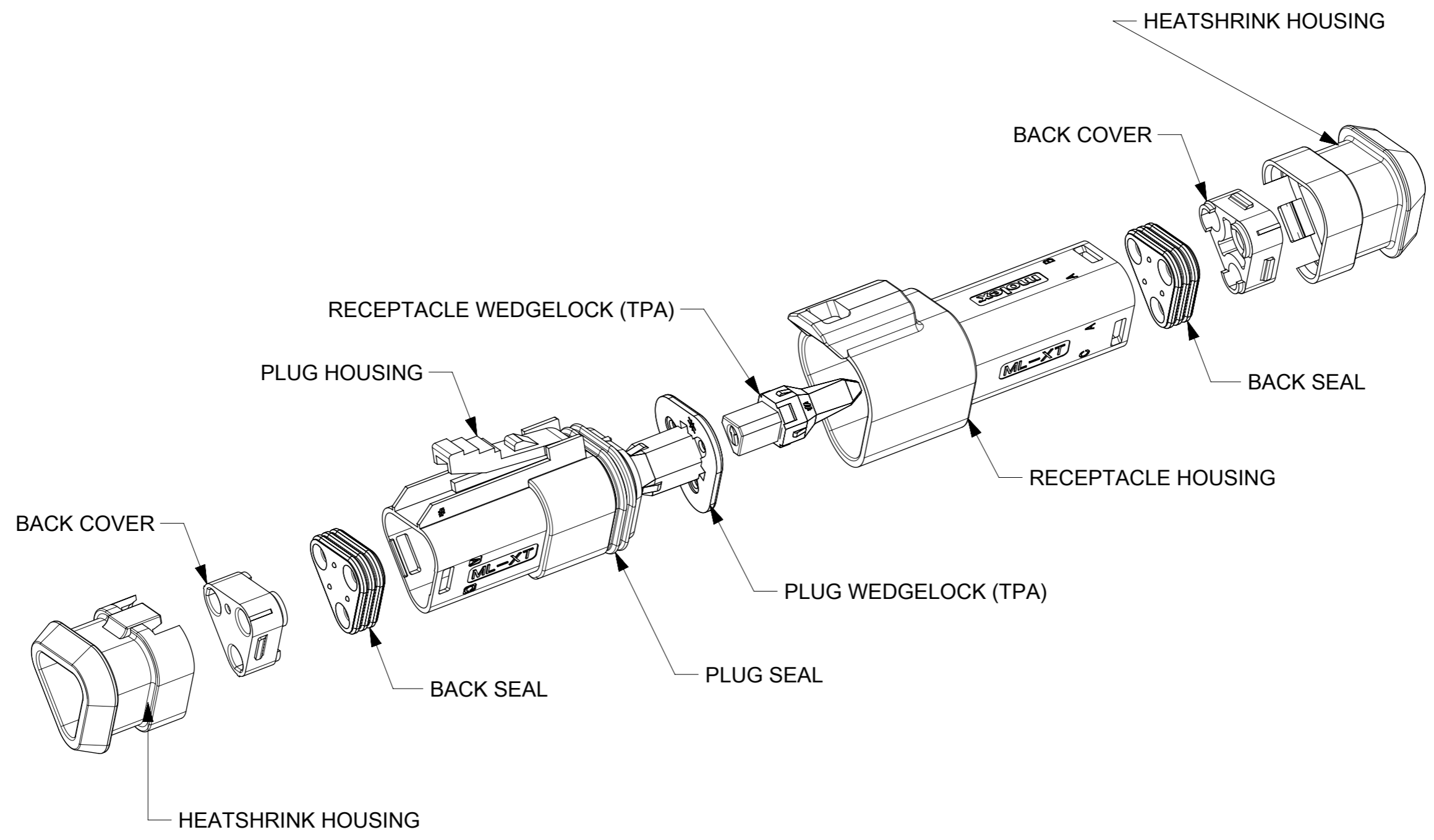

**NOTES**  
 1. SEE SHEETS 2 TO 7 FOR ALL UNSPECIFIED NOTES, DIMENSIONS AND PART NUMBERS

|         |                        |   |  |                             |  |                          |  |
|---------|------------------------|---|--|-----------------------------|--|--------------------------|--|
| SYMBOLS |                        | THIS DRAWING CONTAINS INFORMATION THAT IS PROPRIETARY TO MOLEX ELECTRONIC TECHNOLOGIES, LLC AND SHOULD NOT BE USED WITHOUT WRITTEN PERMISSION |  | CURRENT REV DESC: REVISED   |  | <b>molex</b>             |  |
| ▽ = 0   | mm                     | GENERAL TOLERANCES (UNLESS SPECIFIED)   |  | EC NO: 167662               |  |                          |  |
| ▽ = 0   | 4 PLACES ±             | ANGULAR TOL ± 2.0°  |  | DRWN: JFLETCHER 2017/12/08  |  | PRODUCT CUSTOMER DRAWING |  |
| ▽ = 0   | 3 PLACES ±             | INITIAL REVISION:   |  | CHK'D: JDWALLACE 2018/02/07 |  | DOCUMENT NUMBER          |  |
| ▽ = 0   | 2 PLACES ± 0.1         | DRWN: JFLETCHER 2014/12/12  |  | APPR: JDWALLACE 2018/02/14  |  | 934430020                |  |
| ▽ = 0   | 1 PLACE ± 0.2          | APPR: JALEXANDER 2015/01/22   |  | DOC TYPE                    |  | PSD                      |  |
| ▽ = 0   | 0 PLACES ±             | DRAFT WHERE APPLICABLE MUST REMAIN WITHIN DIMENSIONS  |  | SERIES                      |  | 000                      |  |
| ▽ = 0   | THIRD ANGLE PROJECTION | DRAWING   |  | MATERIAL NUMBER             |  | 000 D                    |  |
| ▽ = 0   | A3-SIZE                | 93443   |  | CUSTOMER                    |  | GENERAL MARKET           |  |
| ▽ = 0   |                        | SHEET NUMBER  |  |                             |  | 1 OF 7                   |  |

9 8 7 6 5 4 3 2 1

3CCT RECEPTACLE CONNECTOR

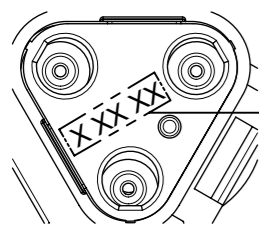
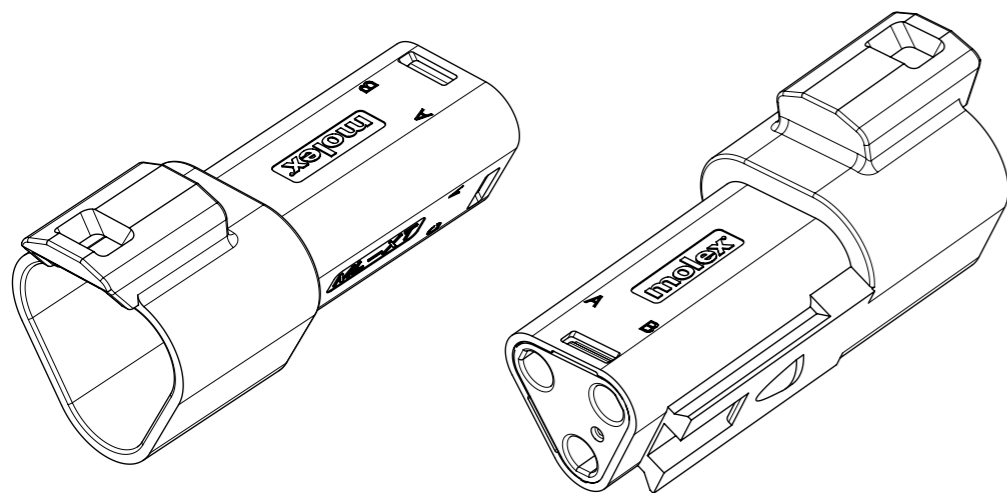

DETAIL A  
SCALE 2:1

DATE CODE: X XX XX  
 X—DAY: 1- 7  
 X — WEEK: 01 - 52  
 X — YEAR: 00 - 99  
 # — MACHINE NO. 1  
 EXAMPLE: 11315 = DAY 1, WEEK 13,  
 YEAR 15 i.e. 23rd OF MARCH 2015

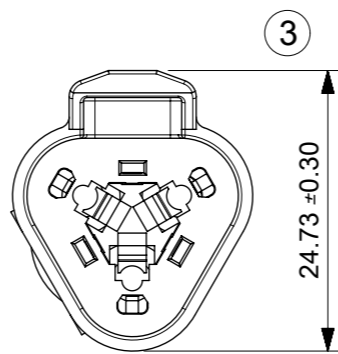
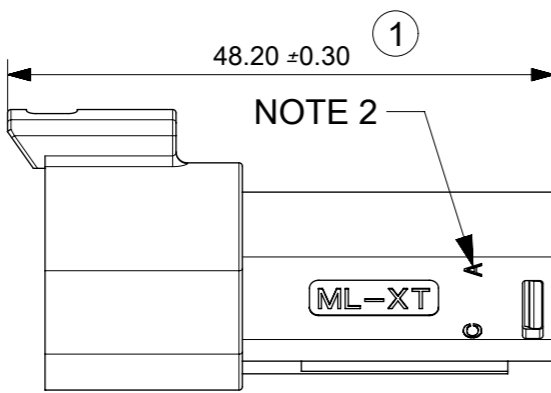
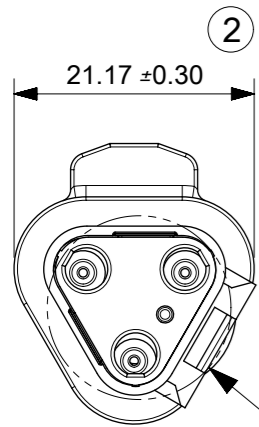

3CCT RECEPTACLE CONNECTOR WITH HEATSHRINK HOUSING ULTRASONICALLY WELDED IN PLACE

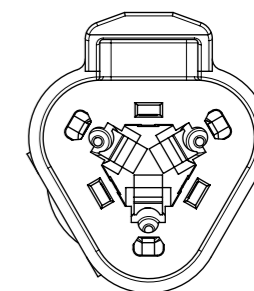
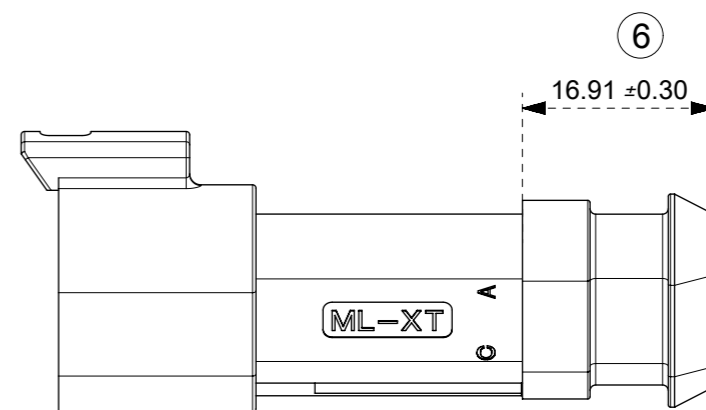
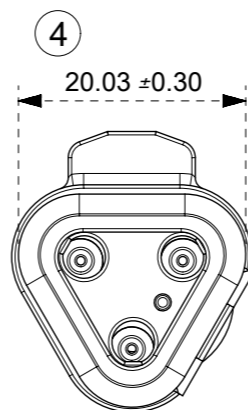
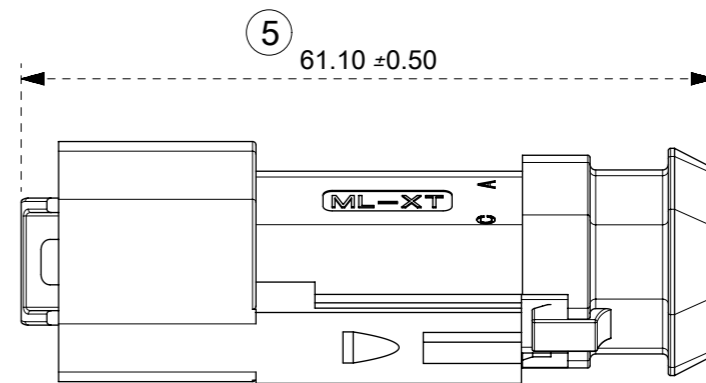
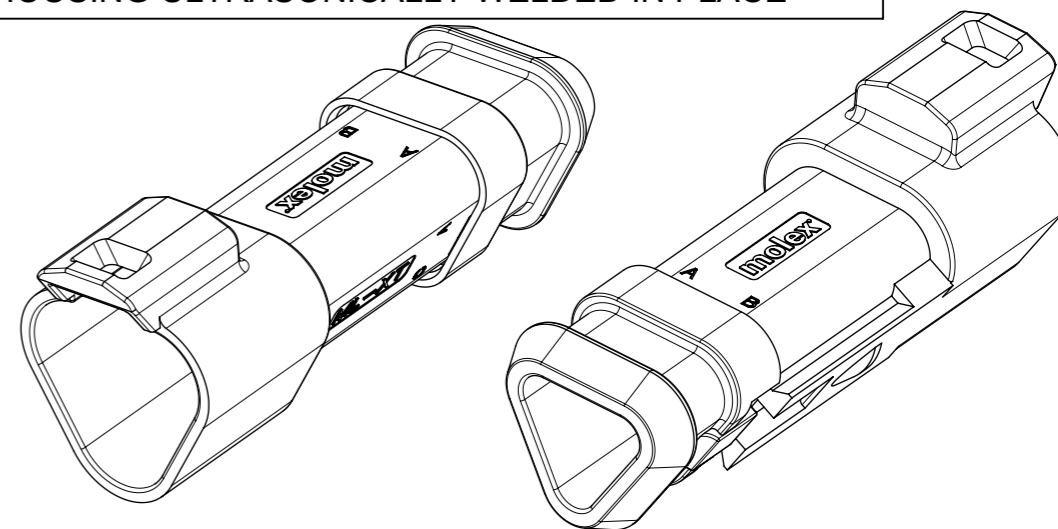

1. MATERIAL  
HOUSING: NYLON 30% GLASS FILLED  
BACK SEAL: HIGH CONSISTENCY RUBBER
  2. CIRCUIT IDENTIFICATION
  3. JACKET RANGE LARGE = Ø2.23MM TO 3.68MM (SEAL COLOUR: LIGHT BLUE)  
JACKET RANGE SMALL = Ø1.35MM TO 3.05MM (SEAL COLOUR: BURNT ORANGE)
  4. SEE SHEET 3 FOR FINAL PART NUMBER
  5. SEE 934430010 PS P FOR PRODUCT SPECIFICATION
  6. SEE 934430002 PS K FOR PACKAGING SPECIFICATION
- INSPECTION NUMBERS 1 - 50 RESERVED FOR SHEET 2  
 LAST INSPECTION NO. 6

|         |   |                                       |                             |                            |         |                            |                          |        |                         |
|---------|---|---------------------------------------|-----------------------------|----------------------------|---------|----------------------------|--------------------------|--------|-------------------------|
| SYMBOLS | THIS DRAWING CONTAINS INFORMATION THAT IS PROPRIETARY TO MOLEX ELECTRONIC TECHNOLOGIES, LLC AND SHOULD NOT BE USED WITHOUT WRITTEN PERMISSION |                                       | CURRENT REV DESC: REVISED   |                            |         | <b>molex</b>               |                          |        |                         |
|         | ▽ = 0   | mm                                    | SCALE                       |                            |         |                            |                          |        | 3CCT ML-XT CV CONNECTOR |
|         | ▽ = 0   | GENERAL TOLERANCES (UNLESS SPECIFIED) |                             | EC NO: 167662              |         |                            | PRODUCT CUSTOMER DRAWING |        |                         |
|         | ▽ = 0   | ANGULAR TOL ± 2.0°                    |                             | DRWN: JFLETCHER 2017/12/08 |         |                            | DOCUMENT NUMBER          |        |                         |
| ▽ = 0   | 4 PLACES ±  |                                       | CHK'D: JDWALLACE 2018/02/07 |                            |         | DOC TYPE DOC PART REVISION |                          |        |                         |
| ▽ = 0   | 3 PLACES ±  |                                       | APPR: JDWALLACE 2018/02/14  |                            |         | 934430020 PSD 000 D        |                          |        |                         |
| ▽ = 0   | 2 PLACES ± 0.1  |                                       | INITIAL REVISION:           |                            |         | MATERIAL NUMBER            |                          |        |                         |
| ▽ = 0   | 1 PLACE ± 0.2   |                                       | DRWN: JFLETCHER 2014/12/12  |                            |         | CUSTOMER                   |                          |        |                         |
| ▽ = 0   | 0 PLACES ±  |                                       | APPR: JALEXANDER 2015/01/22 |                            |         | SHEET NUMBER               |                          |        |                         |
| ■ = 0   | DRAFT WHERE APPLICABLE MUST REMAIN WITHIN DIMENSIONS  |                                       | THIRD ANGLE PROJECTION      |                            | DRAWING | SERIES                     | SEE CHART                |        |                         |
| ▽ = 0   |   |                                       | A3-SIZE                     |                            | 93443   | GENERAL MARKET             |                          | 2 OF 7 |                         |

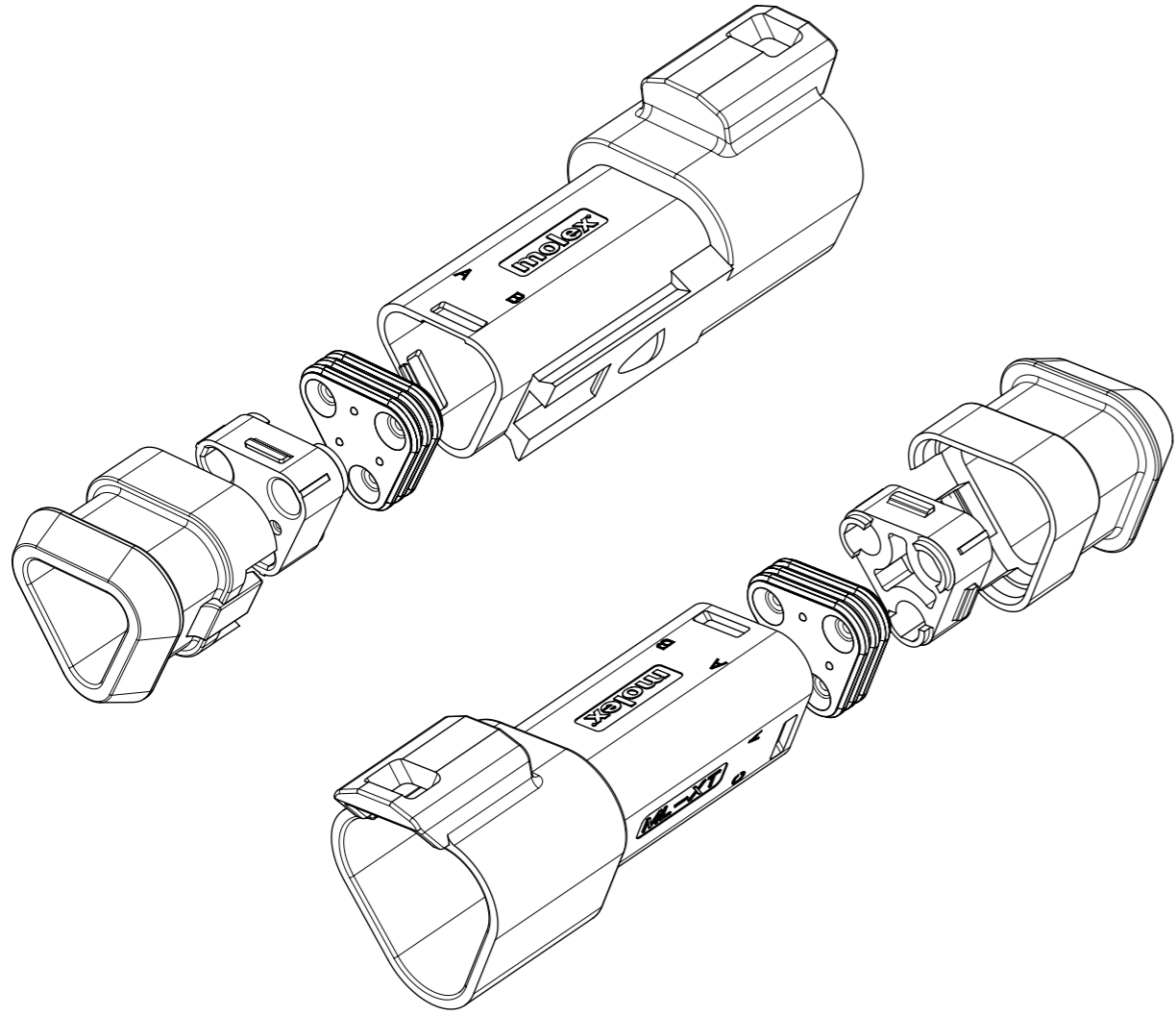

**3CCT RECEPTACLE CONNECTOR**

**SERIES No.** 93444 2 - --

**CIRCUIT SIZE**  
2 = 3CCT

**ASSEMBLY OPTIONS:**  
 1 = RECEP ASSEMBLY FOR WIRE JACKET RANGE:  $\varnothing$ 1.35mm-3.05mm (NOTE 2)  
 2 = RECEP ASSEMBLY FOR WIRE JACKET RANGE:  $\varnothing$ 2.23mm-3.68mm (NOTE 2)  
 5 = RECEP ASSEMBLY & HEATSHRINK FOR WIRE JACKET RANGE:  $\varnothing$ 1.35mm-3.05mm (NOTE 3)  
 6 = RECEP ASSEMBLY & HEATSHRINK FOR WIRE JACKET RANGE:  $\varnothing$ 2.23mm-3.68mm (NOTE 3)

**COLOUR**  
 01=BLACK  
 02=GREY 06=WHITE  
 03=GREEN 07=BROWN  
 04=BLUE 08=ORANGE  
 05=YELLOW 09=RED

**EXAMPLE:**  
 3cct RECEP BLACK WITH LARGE SEAL AND HEATSHRINK = 93444-2601

- NOTES**
- SEE SHEET 2 FOR UNSPECIFIED NOTES AND DIMENSIONS
  - BACK COVER HOUSING COLOUR BLACK
  - PLEASE CONTACT MOLEX REGARDING HEATSHRINK HOUSING (HEATSHRINK HOUSING COLOUR: BLACK)

|   |  |       |                             |  |         |        |                                     |  |                 |  |               |
|---|--|-------|-----------------------------|--|---------|--------|-------------------------------------|--|-----------------|--|---------------|
| THIS DRAWING CONTAINS INFORMATION THAT IS PROPRIETARY TO MOLEX ELECTRONIC TECHNOLOGIES, LLC AND SHOULD NOT BE USED WITHOUT WRITTEN PERMISSION |  |       |                             |  |         |        |                                     |  |                 |  |               |
| SYMBOLS   | DIMENSION UNITS                                      | SCALE | CURRENT REV DESC: REVISED   |  |         |        | <b>molex</b>                        |  |                 |  |               |
|   | mm   |       |                             |  |         |        |                                     |  |                 |  |               |
| ▽ = 0   | GENERAL TOLERANCES (UNLESS SPECIFIED)                |       | EC NO: 167662               |  |         |        | 3CCT ML-XT CV CONNECTOR             |  |                 |  |               |
| ▽ = 0   | ANGULAR TOL ± 2.0°                                   |       | DRWN: JFLETCHER 2017/12/08  |  |         |        |                                     |  |                 |  |               |
| ▽ = 0   | 4 PLACES ±   |       | CHK'D: JDWALLACE 2018/02/07 |  |         |        | PRODUCT CUSTOMER DRAWING            |  |                 |  |               |
| ▽ = 0   | 3 PLACES ±   |       | APPR: JDWALLACE 2018/02/14  |  |         |        |                                     |  |                 |  |               |
| ▽ = 0   | 2 PLACES ± 0.1                                       |       | INITIAL REVISION:           |  |         |        | DOCUMENT NUMBER<br><b>934430020</b> |  |                 |  |               |
| ▽ = 0   | 1 PLACE ± 0.2  |       | DRWN: JFLETCHER 2014/12/12  |  |         |        |                                     |  |                 |  |               |
| ▽ = 0   | 0 PLACES ±   |       | APPR: JALEXANDER 2015/01/22 |  |         |        | DOC TYPE<br>PSD                     |  | DOC PART<br>000 |  | REVISION<br>D |
| ■ = 0   | DRAFT WHERE APPLICABLE MUST REMAIN WITHIN DIMENSIONS |       | THIRD ANGLE PROJECTION      |  | DRAWING | SERIES | MATERIAL NUMBER                     |  | CUSTOMER        |  | SHEET NUMBER  |
| ▽ = 0   |  |       |                             |  | A3-SIZE | 93443  | SEE CHART                           |  | GENERAL MARKET  |  | 3 OF 7        |

RECEPTACLE WEDGELOCK STANDARD

RECEPTACLE WEDGELOCK J1939

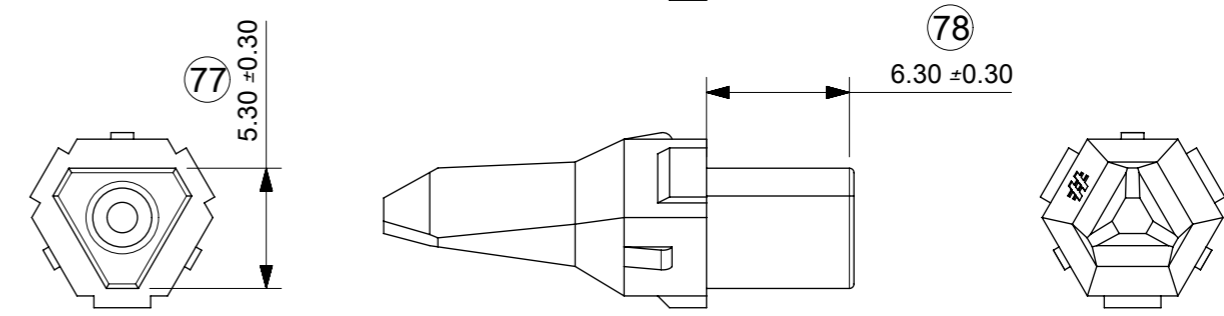
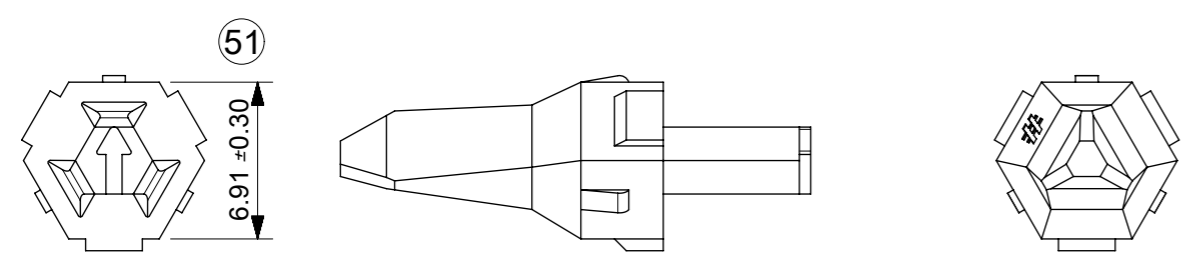
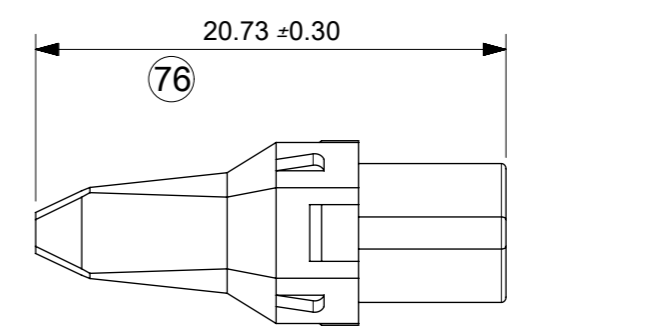
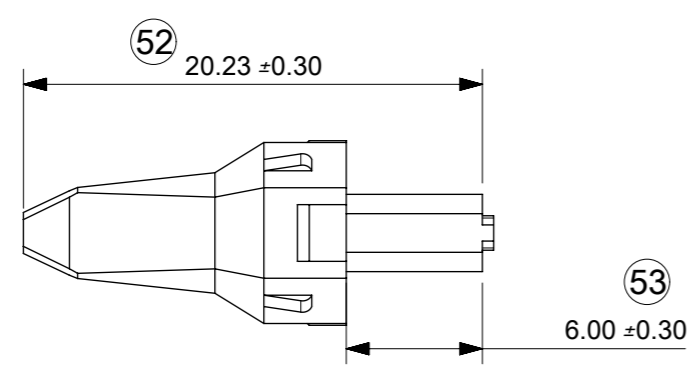
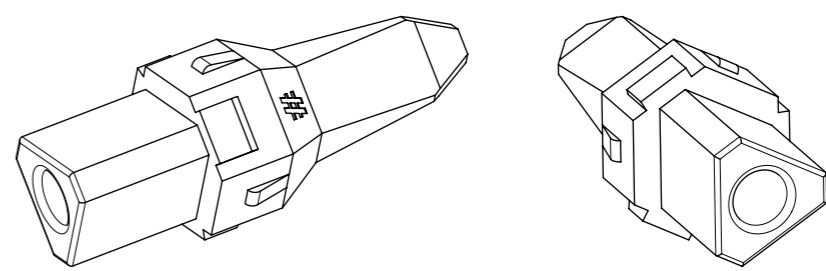
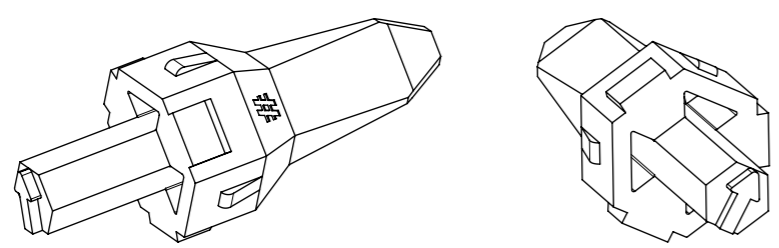

NOTES  
 1. MATERIAL  
 HOUSING: NYLON 30% GLASS FILLED  
 COLOUR: GREEN  
 2. PART NUMBER 934472003  
 KEYING : STANDARD  
 INSPECTION NUMBERS 51-75  
 LAST INSPECTION NUMBER 53

NOTES  
 1. MATERIAL  
 HOUSING: NYLON 30% GLASS FILLED  
 COLOUR: BLUE  
 2. PART NUMBER 934472004  
 KEYING: J1939  
 INSPECTION NUMBERS 76-100  
 LAST INSPECTION NUMBER 79

|         |                                       |   |                             |                             |                          |                 |          |              |          |
|---------|---------------------------------------|---|-----------------------------|-----------------------------|--------------------------|-----------------|----------|--------------|----------|
| SYMBOLS |                                       | THIS DRAWING CONTAINS INFORMATION THAT IS PROPRIETARY TO MOLEX ELECTRONIC TECHNOLOGIES, LLC AND SHOULD NOT BE USED WITHOUT WRITTEN PERMISSION |                             | CURRENT REV DESC: REVISED   |                          | <b>molex</b>    |          |              |          |
| ▽ = 0   | mm                                    | SCALE   |                             | EC NO: 167662               |                          |                 |          |              |          |
| ▽ = 0   | GENERAL TOLERANCES (UNLESS SPECIFIED) |   | DRWN: JFLETCHER 2017/12/08  |                             | 3CCT ML-XT CV CONNECTOR  |                 |          |              |          |
| ▽ = 0   | ANGULAR TOL ± 2.0°                    |   | CHK'D: JDWALLACE 2018/02/07 |                             | PRODUCT CUSTOMER DRAWING |                 |          |              |          |
| ▽ = 0   | 4 PLACES ±                            | APPR: JDWALLACE 2018/02/14  |                             | INITIAL REVISION:           |                          | DOCUMENT NUMBER | DOC TYPE | DOC PART     | REVISION |
| ▽ = 0   | 3 PLACES ±                            | DRWN: JFLETCHER 2014/12/12  |                             | DRWN: JFLETCHER 2014/12/12  |                          | 934430020       | PSD      | 000          | D        |
| ▽ = 0   | 2 PLACES ± 0.1                        | APPR: JALEXANDER 2015/01/22   |                             | APPR: JALEXANDER 2015/01/22 |                          | MATERIAL NUMBER |          | CUSTOMER     |          |
| ▽ = 0   | 1 PLACE ± 0.2                         | THIRD ANGLE PROJECTION  |                             | DRAWING                     |                          | SERIES          |          | SHEET NUMBER |          |
| ▽ = 0   | 0 PLACES ±                            | DRAFT WHERE APPLICABLE MUST REMAIN WITHIN DIMENSIONS  |                             | A3-SIZE                     |                          | 93443           |          | 4 OF 7       |          |

3CCT PLUG CONNECTOR

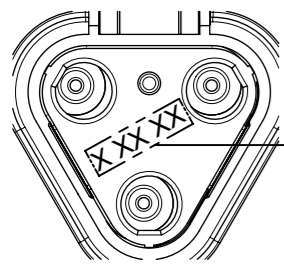
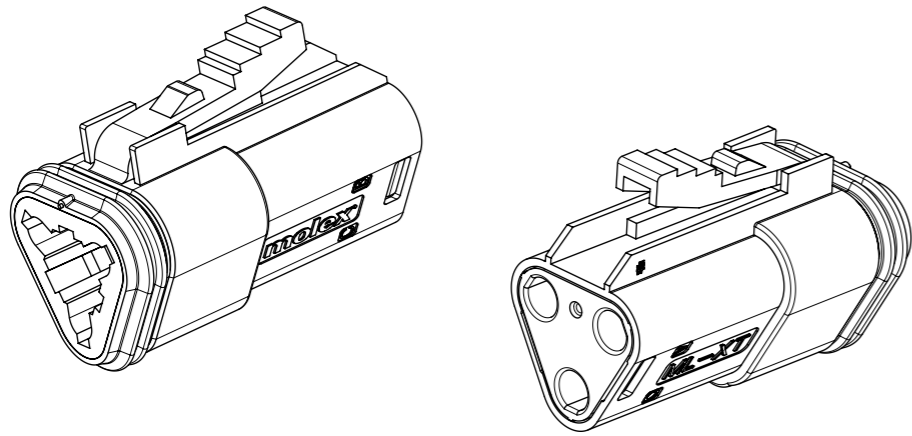

DETAIL B  
SCALE 2:1

DATE CODE: X XX XX  
 X — DAY: 1-7  
 X — WEEK: 01 - 52  
 X — YEAR: 00 - 99  
 # — MACHINE NO. 1  
 EXAMPLE: 11315 = DAY 1, WEEK 13, YEAR 15  
 i.e. 23rd OF MARCH 2015

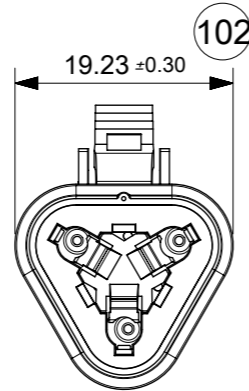
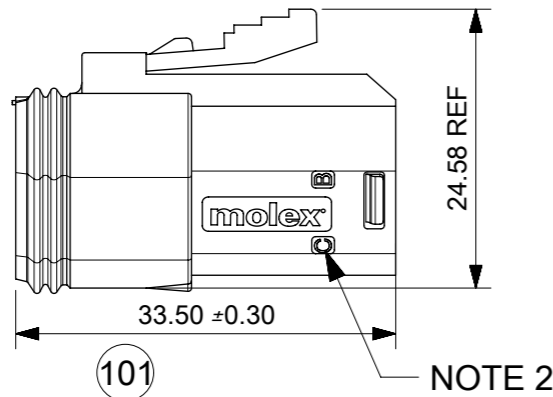
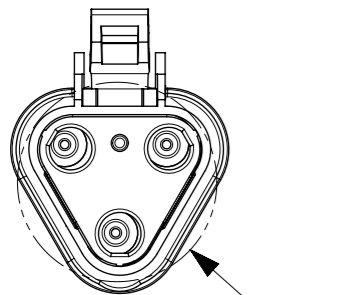

3CCT PLUG CONNECTOR WITH HEATSHRINK HOUSING ULTRA SONICALLY WELDED IN PLACE

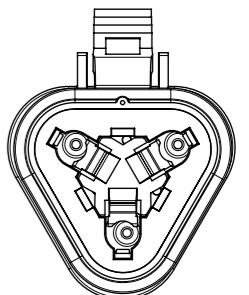
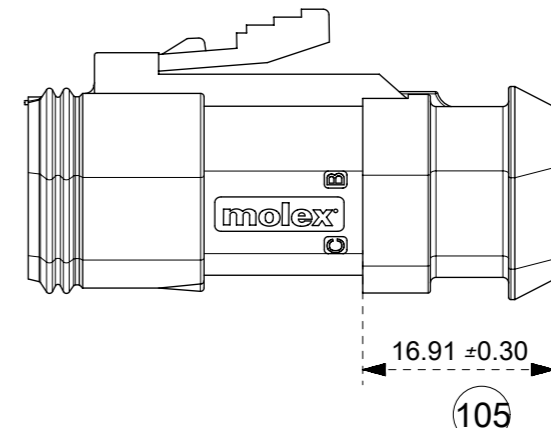
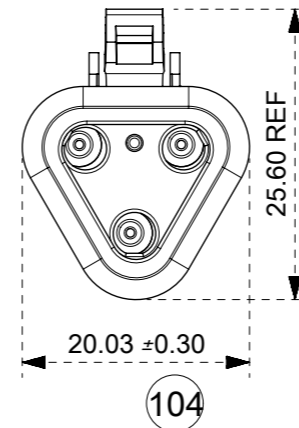
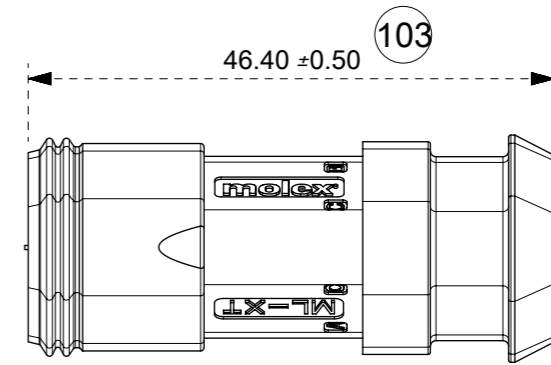
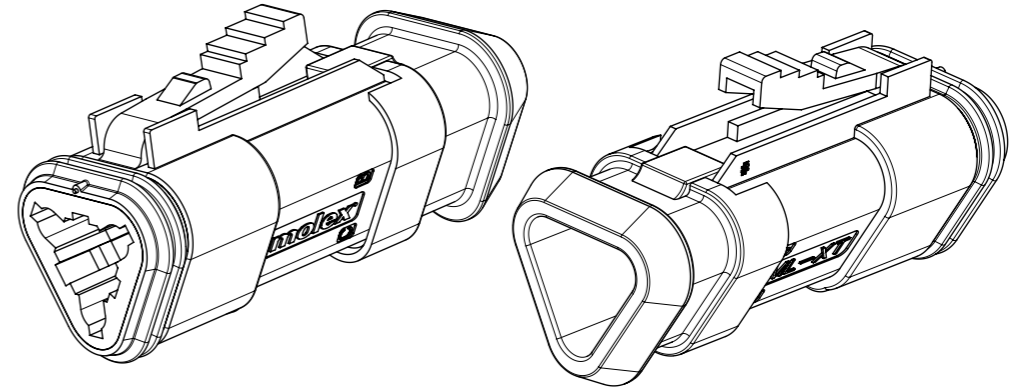

NOTES

- MATERIAL:  
 HOUSING: NYLON 30% GLASS FILLED  
 PLUG SEAL: SILICONE RUBBER  
 BACK SEAL: HIGH CONSISTENCY RUBBER
- CIRCUIT IDENTIFICATION
- JACKET RANGE LARGE =  $\varnothing$ 2.23MM TO 3.68MM (SEAL COLOUR: LIGHT BLUE)  
 JACKET RANGE SMALL =  $\varnothing$ 1.35MM TO 3.05MM (SEAL COLOUR: BURNT ORANGE)
- SEE SHEET 6 FOR FINAL PART NUMBER DESIGNATION
- INSPECTION NUMBERS 101-150 RESERVED FOR SHEET 5  
 LAST INSPECTION NUMBER 105

|         |                                       |   |  |                             |  |                            |  |
|---------|---------------------------------------|---|--|-----------------------------|--|----------------------------|--|
| SYMBOLS |                                       | THIS DRAWING CONTAINS INFORMATION THAT IS PROPRIETARY TO MOLEX ELECTRONIC TECHNOLOGIES, LLC AND SHOULD NOT BE USED WITHOUT WRITTEN PERMISSION |  | CURRENT REV DESC: REVISED   |  | <b>molex</b>               |  |
| ▽ = 0   | mm                                    | SCALE   |  | EC NO: 167662               |  |                            |  |
| ▽ = 0   | GENERAL TOLERANCES (UNLESS SPECIFIED) | 4 PLACES ±  |  | DRWN: JFLETCHER 2017/12/08  |  | 3CCT ML-XT CV CONNECTOR    |  |
| ▽ = 0   | ANGULAR TOL ± 2.0°                    | 3 PLACES ±  |  | CHK'D: JDWALLACE 2018/02/07 |  | PRODUCT CUSTOMER DRAWING   |  |
| ▽ = 0   | 2 PLACES ± 0.1                        | 1 PLACE ± 0.2   |  | APPR: JDWALLACE 2018/02/14  |  | DOCUMENT NUMBER            |  |
| ▽ = 0   | 0 PLACES ±                            | DRAFT WHERE APPLICABLE MUST REMAIN WITHIN DIMENSIONS  |  | INITIAL REVISION:           |  | 934430020                  |  |
| ▽ = 0   |                                       | THIRD ANGLE PROJECTION  |  | DRWN: JFLETCHER 2014/12/12  |  | DOC TYPE DOC PART REVISION |  |
| ▽ = 0   |                                       | DRAWING   |  | APPR: JALEXANDER 2015/01/22 |  | PSD 000 D                  |  |
|         |                                       | SERIES  |  | MATERIAL NUMBER             |  | CUSTOMER                   |  |
|         |                                       | A3-SIZE 93443   |  | SEE CHART                   |  | GENERAL MARKET             |  |
|         |                                       |   |  | SHEET NUMBER                |  | 5 OF 7                     |  |

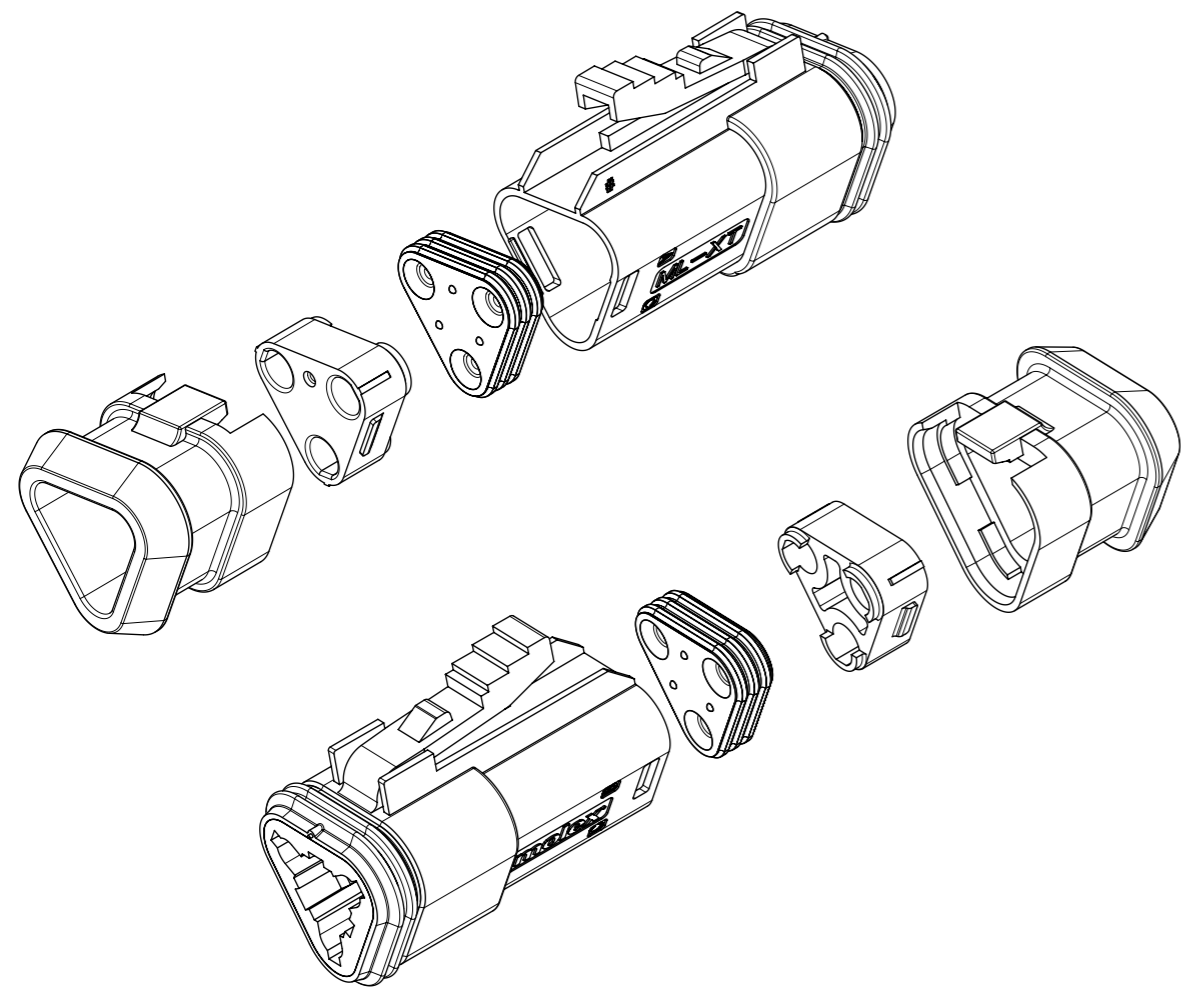

3CCT PLUG CONNECTOR

93445

2

-

--

SERIES No. \_\_\_\_\_

CIRCUIT SIZE  
2 = 3CCT

ASSEMBLY OPTIONS:

- 1 = PLUG ASSEMBLY FOR WIRE JACKET RANGE:  $\varnothing$ 1.35mm-3.05mm (NOTE 2)
- 2 = PLUG ASSEMBLY FOR WIRE JACKET RANGE:  $\varnothing$ 2.23mm-3.68mm (NOTE 2)
- 5 = PLUG ASSEMBLY & HEATSHRINK FOR WIRE JACKET RANGE:  $\varnothing$ 1.35mm-3.05mm (NOTE 3)
- 6 = PLUG ASSEMBLY & HEATSHRINK FOR WIRE JACKET RANGE:  $\varnothing$ 2.23mm-3.68mm (NOTE 3)

COLOUR

- 01=BLACK
- 02=GREY 06=WHITE
- 03=GREEN 07=BROWN
- 04=BLUE 08=ORANGE
- 05=YELLOW 09=RED

EXAMPLE:

3cct PLUG BLACK WITH LARGE SEAL AND HEATSHRINK = 93444-2601

NOTES

1. SEE SHEET 5 FOR UNSPECIFIED NOTES AND DIMENSIONS
2. BACK COVER HOUSING COLOUR BLACK
3. PLEASE CONTACT MOLEX REGARDING HEATSHRINK HOUSING (HEATSHRINK HOUSING COLOUR: BLACK)

|         |   |       |  |  |                |                            |              |  |
|---------|---|-------|--|--|----------------|----------------------------|--------------|--|
| SYMBOLS | THIS DRAWING CONTAINS INFORMATION THAT IS PROPRIETARY TO MOLEX ELECTRONIC TECHNOLOGIES, LLC AND SHOULD NOT BE USED WITHOUT WRITTEN PERMISSION |       | CURRENT REV DESC: REVISED                            |  |                | <b>molex</b>               |              |  |
|         | DIMENSION UNITS   | SCALE |  |  |                |                            |              |  |
| ▽ = 0   | mm  |       | EC NO: 167662  |  |                | PRODUCT CUSTOMER DRAWING   |              |  |
| ▽ = 0   | GENERAL TOLERANCES (UNLESS SPECIFIED)   |       | DRWN: JFLETCHER 2017/12/08                           |  |                | DOCUMENT NUMBER            |              |  |
| ▽ = 0   | ANGULAR TOL ± 2.0°  |       | CHK'D: JDWALLACE 2018/02/07                          |  |                | 934430020                  |              |  |
| ▽ = 0   | 4 PLACES ±  |       | APPR: JDWALLACE 2018/02/14                           |  |                | DOC TYPE DOC PART REVISION |              |  |
| ▽ = 0   | 3 PLACES ±  |       | INITIAL REVISION:                                    |  |                | PSD 000 D                  |              |  |
| ▽ = 0   | 2 PLACES ± 0.1  |       | DRWN: JFLETCHER 2014/12/12                           |  |                | MATERIAL NUMBER            |              |  |
| ▽ = 0   | 1 PLACE ± 0.2   |       | APPR: JALEXANDER 2015/01/22                          |  |                | CUSTOMER                   |              |  |
| ▽ = 0   | 0 PLACES ±  |       | DRAFT WHERE APPLICABLE MUST REMAIN WITHIN DIMENSIONS |  |                | SEE CHART                  |              |  |
| ▽ = 0   | THIRD ANGLE PROJECTION  |       | DRAWING  |  | SERIES         |                            | SHEET NUMBER |  |
| ▽ = 0   | A3-SIZE   |       | 93443  |  | GENERAL MARKET |                            | 6 OF 7       |  |

PLUG WEDGELOCK STANDARD

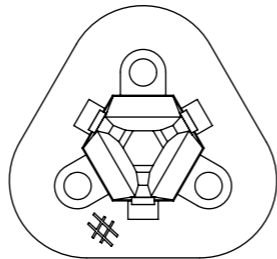
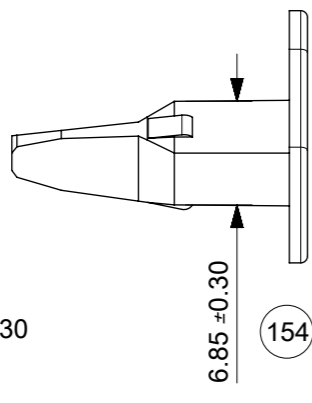
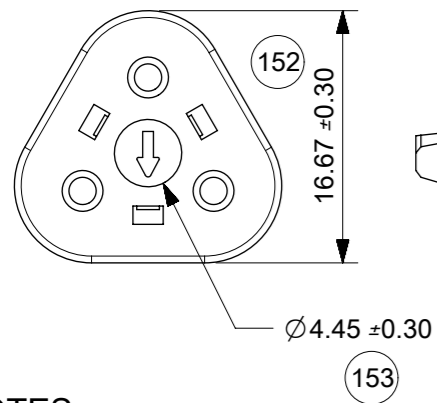
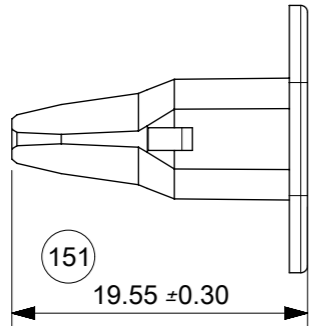

PLUG WEDGELOCK J1939

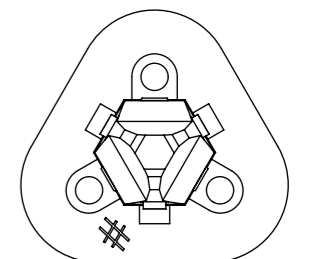
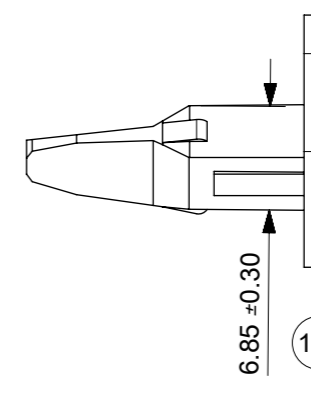
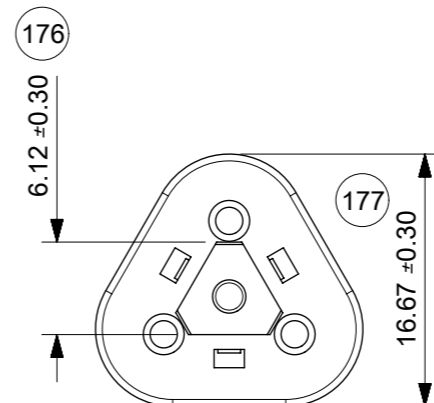
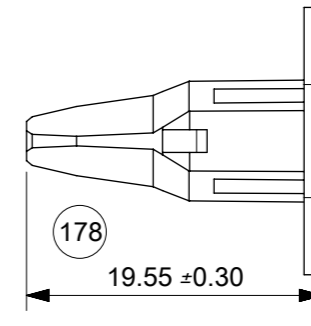
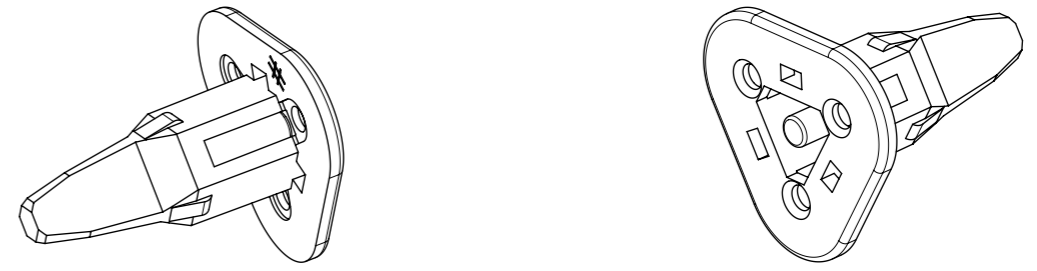

NOTES  
 1. MATERIAL  
 HOUSING: NYLON 30% GLASS FILLED  
 COLOUR: GREEN  
 2. PART NUMBER 934482003  
 KEYING : STANDARD  
 INSPECTION NUMBERS 151-175  
 LAST INSPECTION NUMBER 154

NOTES  
 1. MATERIAL  
 HOUSING: NYLON 30% GLASS FILLED  
 COLOUR: BLUE  
 2. PART NUMBER 934482004  
 KEYING : J1939  
 INSPECTION NUMBERS 176-200  
 LAST INSPECTION NUMBER 179

|         |   |       |                             |         |        |                            |                |              |
|---------|---|-------|-----------------------------|---------|--------|----------------------------|----------------|--------------|
| SYMBOLS | THIS DRAWING CONTAINS INFORMATION THAT IS PROPRIETARY TO MOLEX ELECTRONIC TECHNOLOGIES, LLC AND SHOULD NOT BE USED WITHOUT WRITTEN PERMISSION |       | CURRENT REV DESC: REVISED   |         |        | <b>molex</b>               |                |              |
|         | DIMENSION UNITS   | SCALE |                             |         |        |                            |                |              |
| ▽ = 0   | mm  |       |                             |         |        | 3CCT ML-XT CV CONNECTOR    |                |              |
| ▽ = 0   | GENERAL TOLERANCES (UNLESS SPECIFIED)   |       | EC NO: 167662               |         |        | PRODUCT CUSTOMER DRAWING   |                |              |
| ▽ = 0   | ANGULAR TOL ± 2.0°  |       | DRWN: JFLETCHER 2017/12/08  |         |        |                            |                |              |
| ▽ = 0   | 4 PLACES ±  |       | CHK'D: JDWALLACE 2018/02/07 |         |        | DOCUMENT NUMBER: 934430020 |                |              |
| ▽ = 0   | 3 PLACES ±  |       | APPR: JDWALLACE 2018/02/14  |         |        |                            |                |              |
| ▽ = 0   | 2 PLACES ± 0.1  |       | INITIAL REVISION:           |         |        | DOC PART: 000              |                |              |
| ▽ = 0   | 1 PLACE ± 0.2   |       | DRWN: JFLETCHER 2014/12/12  |         |        | REVISION: D                |                |              |
| ▽ = 0   | 0 PLACES ±  |       | APPR: JALEXANDER 2015/01/22 |         |        |                            |                |              |
| ■ = 0   | DRAFT WHERE APPLICABLE MUST REMAIN WITHIN DIMENSIONS  |       | THIRD ANGLE PROJECTION      | DRAWING | SERIES | MATERIAL NUMBER            | CUSTOMER       | SHEET NUMBER |
| ▽ = 0   |   |       |                             | A3-SIZE | 93443  | SEE CHART                  | GENERAL MARKET | 7 OF 7       |