



Chipsmall Limited consists of a professional team with an average of over 10 year of expertise in the distribution of electronic components. Based in Hongkong, we have already established firm and mutual-benefit business relationships with customers from,Europe,America and south Asia,supplying obsolete and hard-to-find components to meet their specific needs.

With the principle of "Quality Parts,Customers Priority,Honest Operation,and Considerate Service",our business mainly focus on the distribution of electronic components. Line cards we deal with include Microchip,ALPS,ROHM,Xilinx,Pulse,ON,Everlight and Freescale. Main products comprise IC,Modules,Potentiometer,IC Socket,Relay,Connector.Our parts cover such applications as commercial,industrial, and automotives areas.

We are looking forward to setting up business relationship with you and hope to provide you with the best service and solution. Let us make a better world for our industry!



## Contact us

Tel: +86-755-8981 8866 Fax: +86-755-8427 6832

Email & Skype: [info@chipsmall.com](mailto:info@chipsmall.com) Web: [www.chipsmall.com](http://www.chipsmall.com)

Address: A1208, Overseas Decoration Building, #122 Zhenhua RD., Futian, Shenzhen, China



# NOTES :

## 1- MATERIAL:

- HOUSING: LCP FIBER GLASS FILLED UL 94-V0  
COLOR BLACK.
  - TERMINAL: COPPER ALLOY
  - BASE FINISH: NICKEL
  - CONTACT SURFACE FINISH  
GOLD  
OR  
GOLD FLASH OVER PALLADIUM NICKEL  
EXCEEDS PRODUCT REQUIREMENTS BASED ON PS-95503-001
  - 2- JACK FOR MATING WITH F.C.C. 68 PLUGS  
90075 MOLEX SERIES.
  - 3. P.C.B. THICKNESS: 1.57
  - 4- PRODUCT SPECIFICATION PS-95503-001
  - 5- PACKAGING SPECIFICATION:
    - STANDARD PACKAGING PK-95003 SHEET 1.
    - TUBE PACKAGING FOR SMT VERSION PK-95003 SHEET 2.
    - TUBE PACKAGING FOR THROUGH HOLE VERSION  
PK-95003 SHEET 3.
    - TAPE AND REEL PACKAGING FOR THROUGH HOLE PK-95503-001.
  - 6- MANUFACTURING I.D. CAN BE MXF, MG OR MXI.
- INSPECTION NUMBERS USED: 1 - 50  
LAST INSPECTION NUMBER: 22

TYPE DIM.	POS. 4	POS. 6		POS. 8
	4 CKTS.	4 CKTS.	6 CKTS.	8 CKTS.
A	11.18	13.21	13.21	15.24
B	7.62	10.16	10.16	11.43
D	3.81	3.81	6.35	8.89

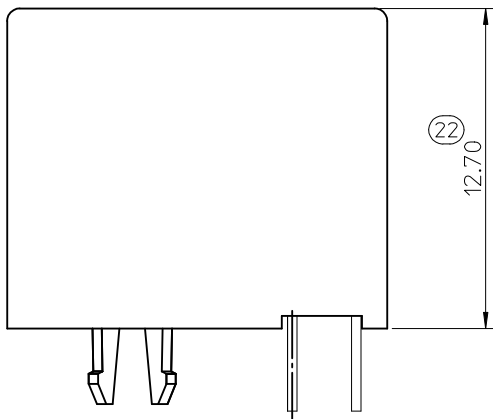

SHORT VERSION

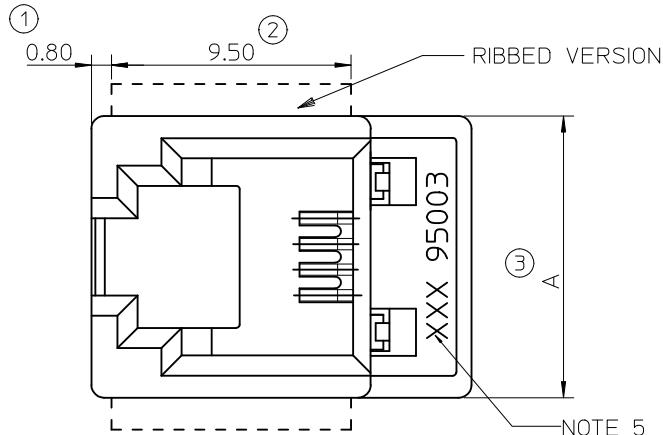

OPTIONAL KEYING

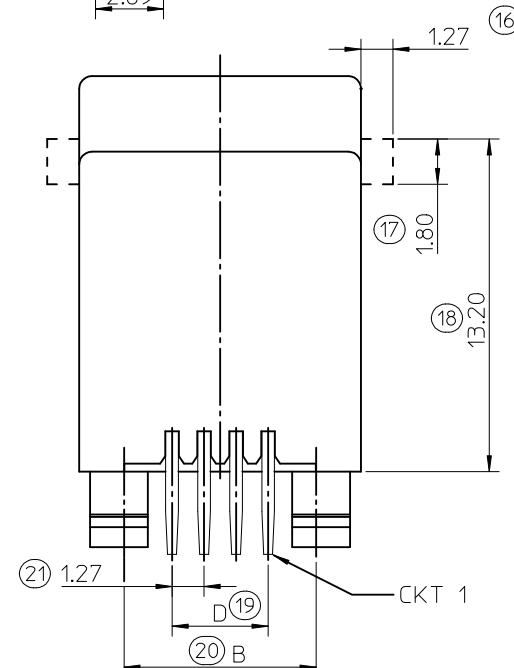
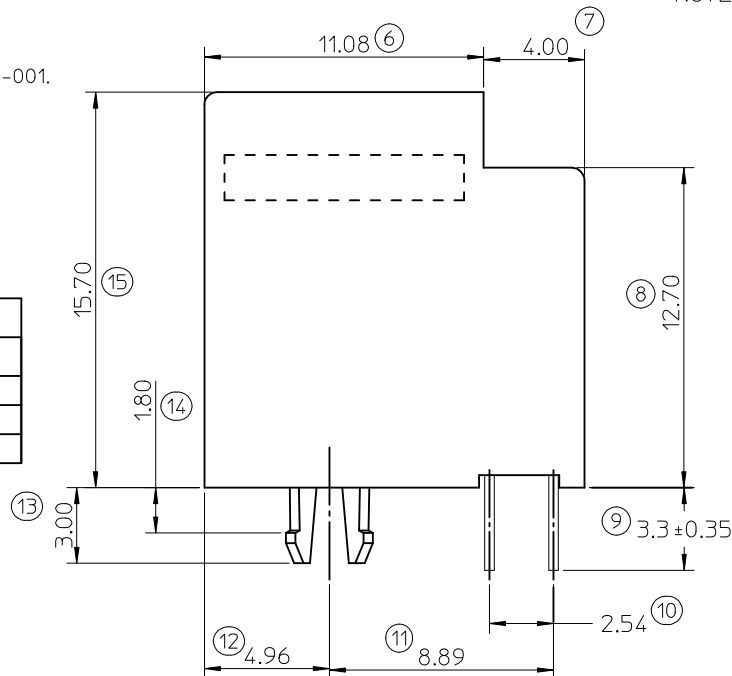
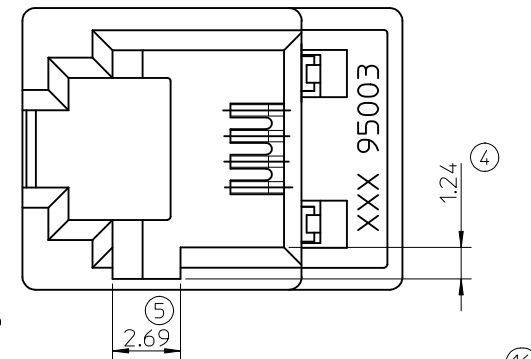

MODIFIED PLATING OPTION EC NO: IPG2012-0589 DRWN:DBYRNES 2012/03/29 CHKD:MSHAHAN 2012/03/30 APPR:EFOLAN 2012/06/28	QUALITY SYMBOLS  ▽=0 ▽=0	DESCRIPTION	REV	GENERAL TOLERANCES (UNLESS SPECIFIED)		DIMENSION STYLE MM ONLY		SCALE 5:1	DESIGN UNITS METRIC	THIRD ANGLE PROJECTION
						DRAWN BY DATE		TITLE  LOW PROFILE TOP ENTRY JACK (THROUGH HOLE VERSION)		
								</		

TYPE DIM.	POS. 4	POS. 6		POS. 8
	4 CKTS.	4 CKTS.	6 CKTS.	8 CKTS.
F ±0.05	7.62	10.16	10.16	11.43
G ±0.05	3.81	3.81	6.35	8.89

P.C.B MOUNTING PATTERNS - SEEN FROM COMPONENT SIDE

FOR SMT JACK (SURFACE MOUNT)

FOR STANDARD JACK (THROUGH HOLE)

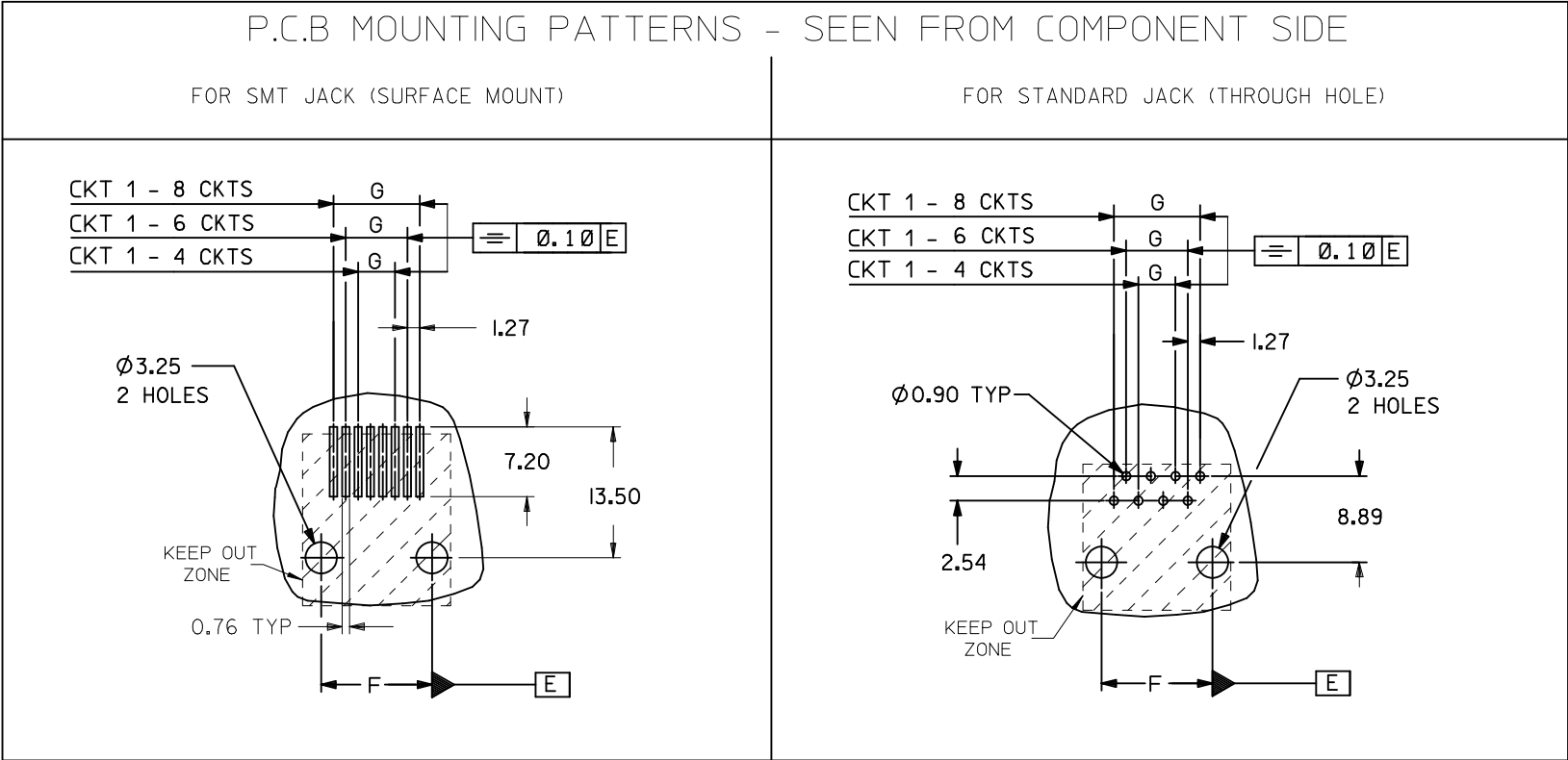

NOTES:  
ALL DIMENSIONS REF DIMENSIONS

REMOVED INCHES EC NO: E2012-0079 DRWN: JCONNOR CHKD: APPR: EFOLAN REV	DESCRIPTION 2011/03/04 2011/09/28	QUALITY SYMBOLS  ▽=0 ◻=0	GENERAL TOLERANCES (UNLESS SPECIFIED)		DIMENSION STYLE MM ONLY		SCALE 1:1	DESIGN UNITS METRIC	THIRD ANGLE PROJECTION		
			mm	INCH	DRAWN BY DATE	TITLE					
			4 PLACES	± ---	± ---	TMARTIN	2005/06/15	LOW PROFILE T/E JACK			
			3 PLACES	± ---	± ---	CHECKED BY	DATE				
			2 PLACES	± 0.15	± ---	FCARABETTA	2005/06/15				
			1 PLACE	± 0.25	± ---	APPROVED BY	DATE				
			ANGULAR ± .5 °			KNOLLER	2005/06/15	MOLEX INCORPORATED			
			DRAFT WHERE APPLICABLE MUST REMAIN WITHIN DIMENSIONS			MATERIAL NO.		DOCUMENT NO.		SHEET NO.	
						SEE SHT. 4, 5		SD-95503-003		3 OF 5	
			THIS DRAWING CONTAINS INFORMATION THAT IS PROPRIETARY TO MOLEX INCORPORATED AND SHOULD NOT BE USED WITHOUT WRITTEN PERMISSION								

F

E

D

C

B

A

HOUSING SIZE	LOADED CONTACTS
4	4
6	4
6	6
8	8

PART NO FOR JACK ASSEMBLY THROUGH HOLE STANDARD VERSION					
LCP FIBER GLASS FILLED 94V0 COLOR BLACK					
NO KEY	TOOLED	KEY	TOOLED		TOOLED
NO RIB	TOOLED	NO RIB	TOOLED		TOOLED
95503-244I	X				
95503-264I	X				
95503-266I	X				
95503-288I	X	95503-2882	X		

TRAY PACKAGING  
SEE PACKAGING SPEC PK-95003 SHEET 1

PART NO FOR JACK ASSEMBLY THROUGH HOLE SHORT VERSION					
LCP FIBER GLASS FILLED 94V0 COLOR BLACK					
NO KEY	TOOLED	KEY	TOOLED		TOOLED
NO RIB	TOOLED	NO RIB	TOOLED		TOOLED
95503-2884	X				

TRAY PACKAGING  
SEE PACKAGING SPEC PK-95003 SHEET 1

TOOLED	X
NOT TOOLED	

NOTES:  
  
PLATING: SEE SHEET ONE

ADDED PLATING OPTION  
EC NO: IPG2012-0589  
2012/03/29  
DRWN:DBYRNES  
CHKD:MSHAHAN  
2012/03/30  
APPR:EFOLAN  
2012/06/28

DESCRIPTION  
REV

QUALITY SYMBOLS  
=0  
=0

GENERAL TOLERANCES (UNLESS SPECIFIED)  
mm INCH  
4 PLACES ± --- ± ---  
3 PLACES ± --- ± ---  
2 PLACES ± --- ± ---  
1 PLACE ± --- ± ---  
ANGULAR ± ---°  
DRAFT WHERE APPLICABLE  
MUST REMAIN  
WITHIN DIMENSIONS

DIMENSION STYLE  
MM ONLY  
DRAWN BY DATE  
TMARTIN 2005/06/16  
CHECKED BY DATE  
FCARABETTA 2005/06/16  
APPROVED BY DATE  
KNOLLER 2005/06/16  
MATERIAL NO.  
SEE CHART

SCALE  
---

DESIGN UNITS  
METRIC

THIRD ANGLE  
PROJECTION

LOW PROFILE T/E JACK  
THROUGH HOLE VERS.

MOLEX INCORPORATED

DOCUMENT NO.  
SD-95503-003

SHEET NO.  
4 OF 5

THIS DRAWING CONTAINS INFORMATION THAT IS PROPRIETARY TO MOLEX  
INCORPORATED AND SHOULD NOT BE USED WITHOUT WRITTEN PERMISSION