



Chipsmall Limited consists of a professional team with an average of over 10 year of expertise in the distribution of electronic components. Based in Hongkong, we have already established firm and mutual-benefit business relationships with customers from,Europe,America and south Asia,supplying obsolete and hard-to-find components to meet their specific needs.

With the principle of “Quality Parts,Customers Priority,Honest Operation,and Considerate Service”,our business mainly focus on the distribution of electronic components. Line cards we deal with include Microchip,ALPS,ROHM,Xilinx,Pulse,ON,Everlight and Freescale. Main products comprise IC,Modules,Potentiometer,IC Socket,Relay,Connector.Our parts cover such applications as commercial,industrial, and automotives areas.

We are looking forward to setting up business relationship with you and hope to provide you with the best service and solution. Let us make a better world for our industry!



Contact us

Tel: +86-755-8981 8866 Fax: +86-755-8427 6832

Email & Skype: info@chipsmall.com Web: www.chipsmall.com

Address: A1208, Overseas Decoration Building, #122 Zhenhua RD., Futian, Shenzhen, China



5

4

3

2

1

Mating face according to : MIL-C-24308 / DIN 41652 / CECC 75301-802

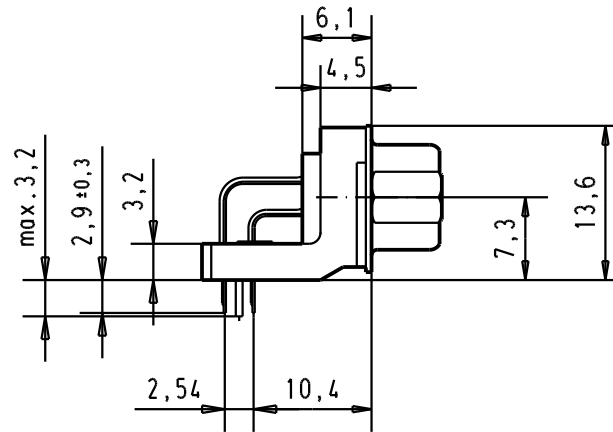
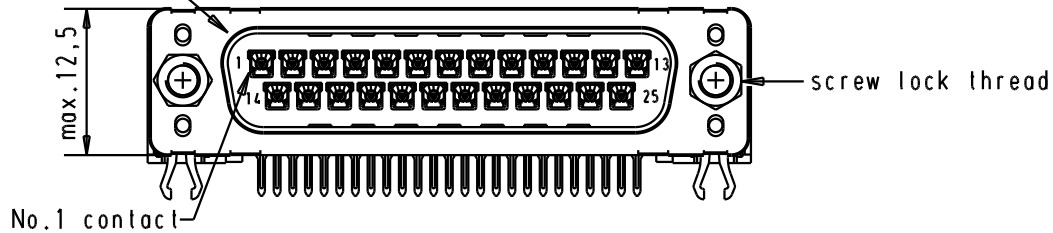

PCB layout hole component side

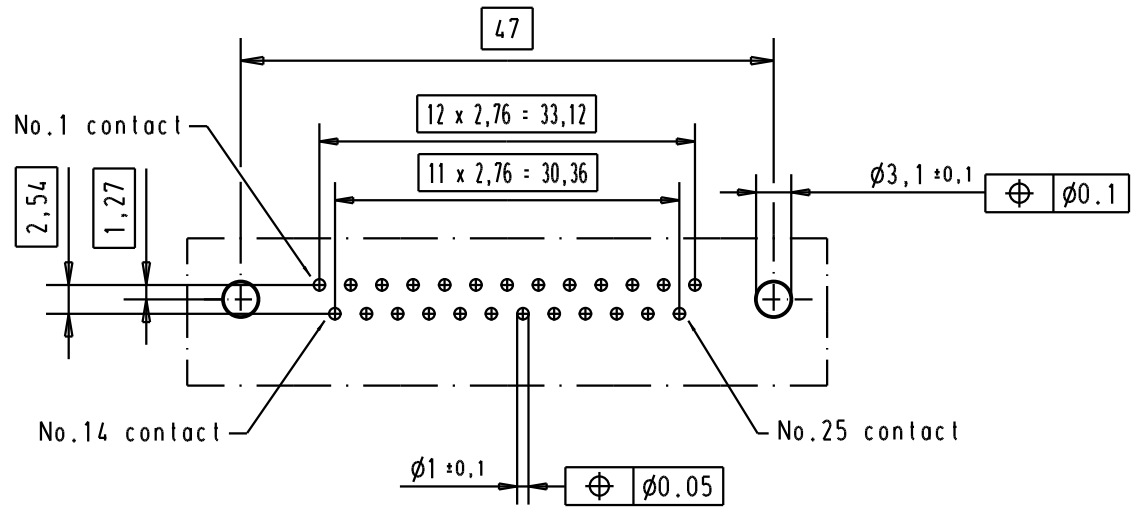
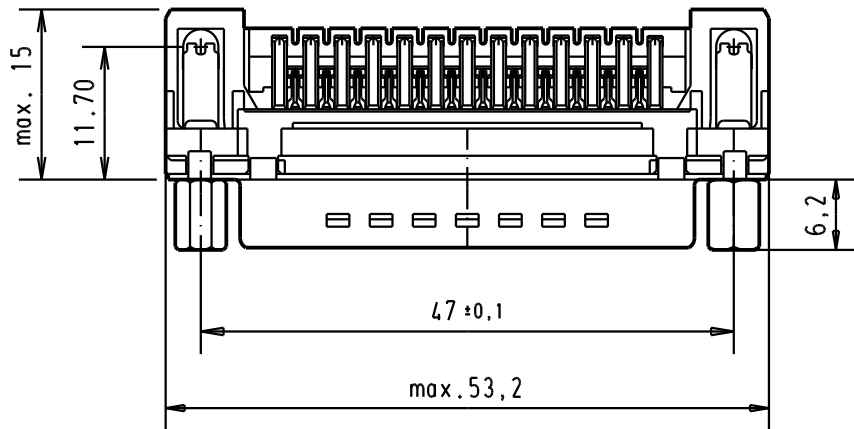

Connector retention and insertion forces on the PCB = 25 / 80 newtons

09 65 362 3833

M3

1

09 65 362 6833

M3

2

09 65 362 7833

M3

3

09 65 362 3813

4-40 UNC

1

09 65 362 6813

4-40 UNC

2

09 65 362 7813

4-40 UNC

3

31892 22/04/04 JH

31084 04/SEP/02 YT

HARTING EURL
F-95972 Paris

Dat.

Name

Detail.

04/SEP/02

YT

Insp.

Stand.



All Dim. in mm
Orig. Size DIN A 4

D-Sub, male, standard angle,
25 poles, with solder pin,
screw lock, grounding board lock

Maßstab/
Scale

1.5:1



TB 0965362x8x3

Blatt/ Page

1

Part number

Screw lock thread

Performance level

Mod.

Dat.

Name

Sub.