



Chipsmall Limited consists of a professional team with an average of over 10 year of expertise in the distribution of electronic components. Based in Hongkong, we have already established firm and mutual-benefit business relationships with customers from,Europe,America and south Asia,supplying obsolete and hard-to-find components to meet their specific needs.

With the principle of “Quality Parts,Customers Priority,Honest Operation,and Considerate Service”,our business mainly focus on the distribution of electronic components. Line cards we deal with include Microchip,ALPS,ROHM,Xilinx,Pulse,ON,Everlight and Freescale. Main products comprise IC,Modules,Potentiometer,IC Socket,Relay,Connector.Our parts cover such applications as commercial,industrial, and automotives areas.

We are looking forward to setting up business relationship with you and hope to provide you with the best service and solution. Let us make a better world for our industry!



Contact us

Tel: +86-755-8981 8866 Fax: +86-755-8427 6832

Email & Skype: info@chipsmall.com Web: www.chipsmall.com

Address: A1208, Overseas Decoration Building, #122 Zhenhua RD., Futian, Shenzhen, China



5

4

3

2

1

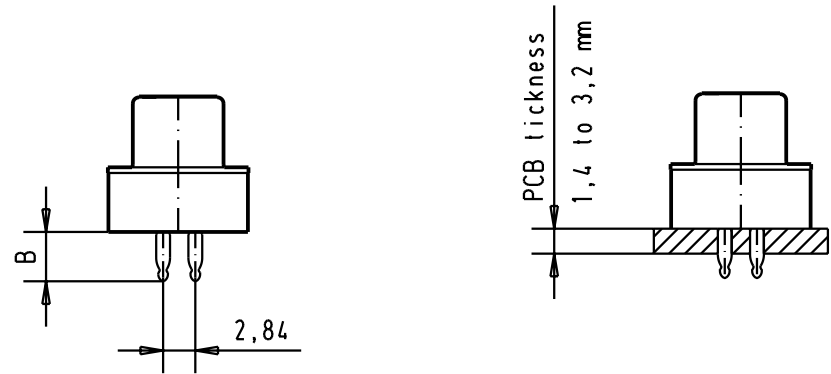
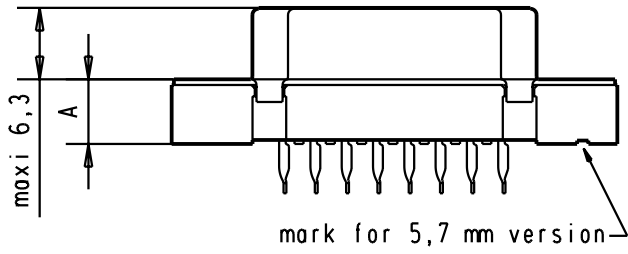

PCB layout hole component side
(PCB holes plating : Tin)

Mating face according to : MIL-C-24308 / DIN 41652 / CECC 75301-802

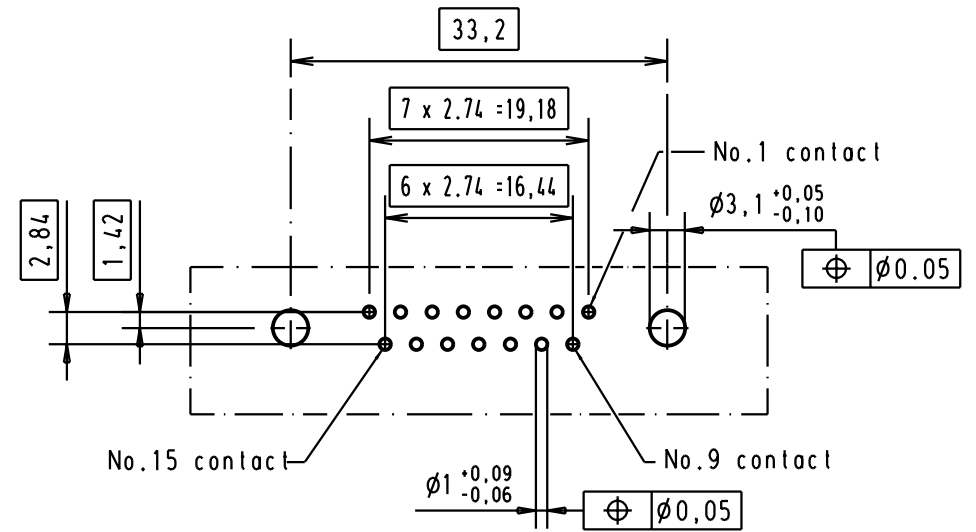
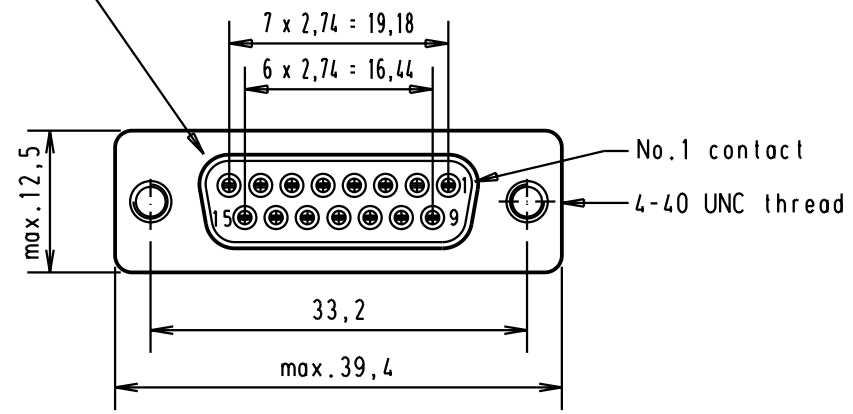

A	09662147502	3	6	4.20							<p>All Dim. in mm Orig. Size DIN A 3</p>	D-Sub 15 poles straight female connector with press-in termination, version nul. 2,5:1
	09662146502	2	6	4.20				Detail.	30/06/95	jfb		
	09662145502	0.76 μ m Au	6	4.20				Insp.				
	09662147506	3	5.7	4.35	31079	29-AUG-02	CV	Stand.				TB 0966214x50x 3
	09662146506	2	5.7	4.35	17971	04/14/97	jfb	HARTING EURL				
	09662145506	0.76 μ m Au	5.7	4.35	16236	30/06/95	jfb	F-95972 Paris				
	Part number	Performance level	A \pm 0.2	B \pm 0.2	Mod.	Dat.	Name			Sub.		