



Chipsmall Limited consists of a professional team with an average of over 10 year of expertise in the distribution of electronic components. Based in Hongkong, we have already established firm and mutual-benefit business relationships with customers from,Europe,America and south Asia,supplying obsolete and hard-to-find components to meet their specific needs.

With the principle of “Quality Parts,Customers Priority,Honest Operation,and Considerate Service”,our business mainly focus on the distribution of electronic components. Line cards we deal with include Microchip,ALPS,ROHM,Xilinx,Pulse,ON,Everlight and Freescale. Main products comprise IC,Modules,Potentiometer,IC Socket,Relay,Connector.Our parts cover such applications as commercial,industrial, and automotives areas.

We are looking forward to setting up business relationship with you and hope to provide you with the best service and solution. Let us make a better world for our industry!



## Contact us

Tel: +86-755-8981 8866 Fax: +86-755-8427 6832

Email & Skype: info@chipsmall.com Web: www.chipsmall.com

Address: A1208, Overseas Decoration Building, #122 Zhenhua RD., Futian, Shenzhen, China





## Features/Benefits

Models Available

- Long life—1,000,000 cycles
- Highly reliable contact design
- Process sealed—solder-proof and wash-proof
- Positive tactile feedback
- Thru-hole and surface mount models available

## Typical Applications

- Medical Equipment
- Hand-held devices
- Instrumentation equipment

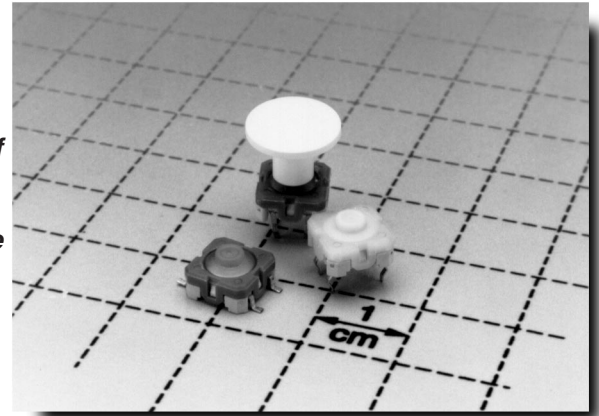

## How To Order

To order Racon 8, select switch/housing part number. To order Racon 8 H, select switch part number and plunger part number in catalog section L. These tactile switches are suitable for most common soldering techniques. Surface mount models can be mounted with automatic assembly machines. Other operating forces available, consult Customer Service Center.

## Specifications

CONTACT RATING: 0.01 - 100 mA @ 0.02 - 42 V AC/DC.

RATED POWER: 1 W max. resistive load.

CONTACT RESISTANCE: < 100 milliohms when new.

BOUNCE: < 5 ms.

CONTACT SYSTEM: Snap-action contact.

CONTACT ARRANGEMENT: SPST NO.

FIXING: By soldering.

OPERATING LIFE: 1,000,000 cycles min.

OPERATING FORCE: 2.5 + 0.7/- 0.5 N.

SWITCHING TRAVEL: 0.6 ± 0.2 mm.

AMBIENT OPERATING TEMPERATURE: - 40°C to + 80°C.;  
- 40°F to + 176°F.

AMBIENT STORAGE TEMPERATURE: - 50°C to + 85°C;  
- 58°F to + 185°F.

DEGREE OF PROTECTION: Solder-proof, wash-proof.

MOUNTING: SMT models can be mounted by automatic assembly machines.

PACKAGING: 8 & 8H thru-hole: Tube packaging, 65 switches;  
8 SMD: Tape & reel packaging, 1,000 switches;  
8H SMD: Tape & reel packaging, 750 switches.

## Materials

SWITCH HOUSING: LCP.

COVER: PTS.

CONTACT MATERIAL: Au.

TERMINALS: Tin-plated.

FLAMMABILITY OF PLASTIC MATERIALS: UL 94 HB.

## Racon 8

### Outward Solder Terminals for PCB

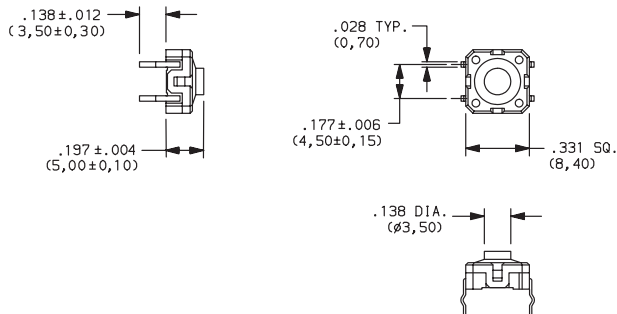

### PC MOUNTING

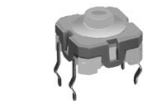
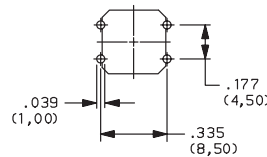

1.141100.0010000  
SPST N.O.

SWITCH & HOUSING		
PART NUMBER	FUNCTION	SCHEMATIC
1.141100.0010000	SPST N.O.	

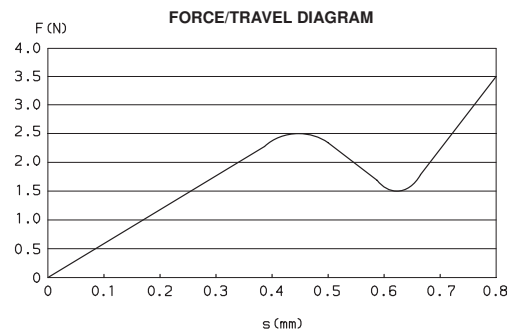

C

Tactile

# Racon 8 & 8 H Series Short Travel Tactile Switches



## Racon 8 Inward Solder Terminals for PCB



1.14100.0020000  
SPST N.O.

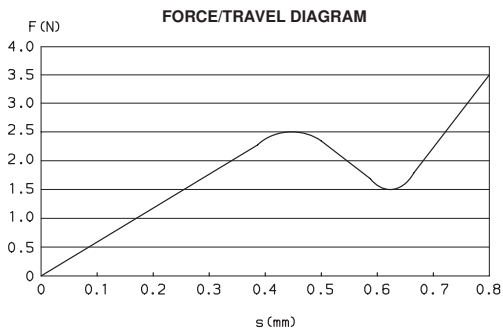
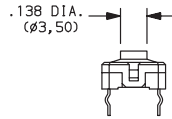
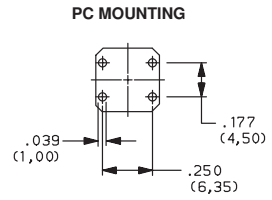
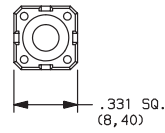
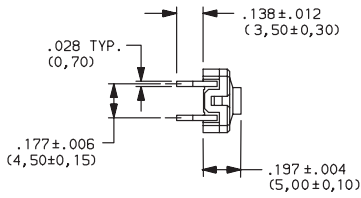

SWITCH & HOUSING		
PART NUMBER	FUNCTION	SCHEMATIC
1.14100.0020000	SPST N.O.	

## Racon 8 SMD Terminals

SMT



1.14100.0030000  
SPST N.O.

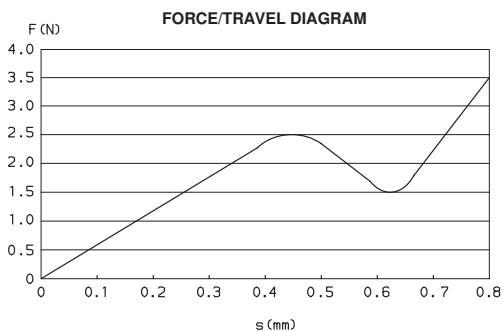
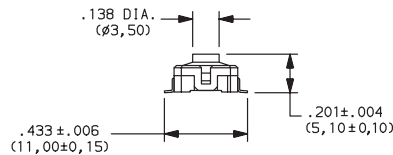
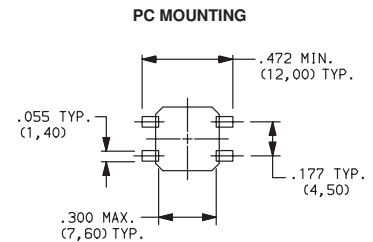
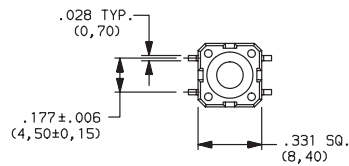

SWITCH & HOUSING		
PART NUMBER	FUNCTION	SCHEMATIC
1.14100.0030000	SPST N.O.	



## Racon 8 H Inward Solder Terminals for PCB

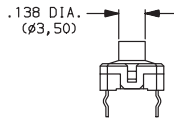
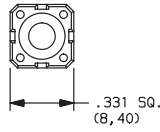
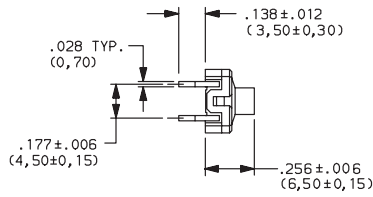

### PC MOUNTING

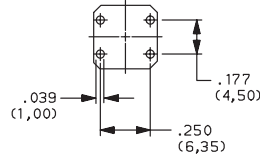

1.14100.0120000  
SPST N.O.

### PLUNGER



5.46067.090

SWITCH & HOUSING			PLUNGER ACCESSORY		
PART NUMBER	FUNCTION	SCHEMATIC	PART NUMBER	DIAMETER	OVERALL HEIGHT
1.14100.0120000	SPST N.O.		5.46067.0900000	8 mm	7.0 mm
			5.46067.0910000	8 mm	9.7 mm
			5.46067.0920000	8 mm	12.5 mm

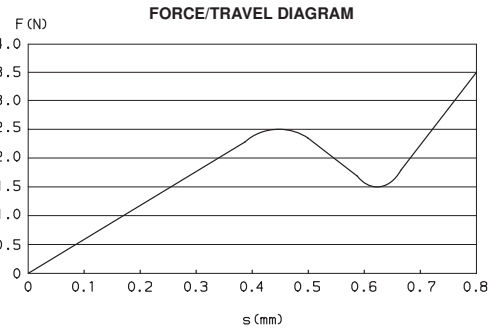

C

Tactile

## Racon 8 H SMD Gullwing Terminals

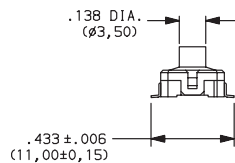
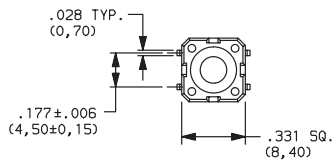
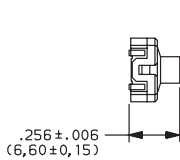

### PC MOUNTING

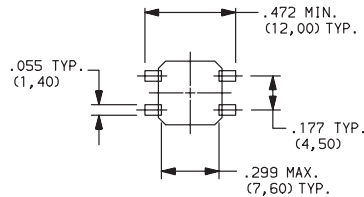

1.14100.0130000  
SPST N.O.

### PLUNGER



5.46067.090

SMT

SWITCH & HOUSING			PLUNGER ACCESSORY		
PART NUMBER	FUNCTION	SCHEMATIC	PART NUMBER	DIAMETER	OVERALL HEIGHT
1.14100.0130000	SPST N.O.		5.46067.0900000	8 mm	7.0 mm
			5.46067.0910000	8 mm	9.7 mm
			5.46067.0920000	8 mm	12.5 mm

