



Chipsmall Limited consists of a professional team with an average of over 10 year of expertise in the distribution of electronic components. Based in Hongkong, we have already established firm and mutual-benefit business relationships with customers from,Europe,America and south Asia,supplying obsolete and hard-to-find components to meet their specific needs.

With the principle of “Quality Parts,Customers Priority,Honest Operation,and Considerate Service”,our business mainly focus on the distribution of electronic components. Line cards we deal with include Microchip,ALPS,ROHM,Xilinx,Pulse,ON,Everlight and Freescale. Main products comprise IC,Modules,Potentiometer,IC Socket,Relay,Connector.Our parts cover such applications as commercial,industrial, and automotives areas.

We are looking forward to setting up business relationship with you and hope to provide you with the best service and solution. Let us make a better world for our industry!



Contact us

Tel: +86-755-8981 8866 Fax: +86-755-8427 6832

Email & Skype: info@chipsmall.com Web: www.chipsmall.com

Address: A1208, Overseas Decoration Building, #122 Zhenhua RD., Futian, Shenzhen, China



THIS DRAWING IS UNPUBLISHED. RELEASED FOR PUBLICATION

© COPYRIGHT BY TYCO ELECTRONICS CORPORATION. ALL RIGHTS RESERVED.

LOC	DIST	REVISIONS					
FT	0	P	LTR	DESCRIPTION	DATE	DWN	APVD
			B1	REVISED PER ECO-07-019157	8/21/07	SS	SRY

MATERIAL:
 HOUSING: THERMOPLASTIC PA, UL94V-0, BLACK.
 TERMINALS: BRIGHT TIN PLATE, COPPER ALLOY.
 SCREWS: 6-32, STEEL, ZINC PLATED AND CLEAR CHROMATE.

ELECTRICAL:
 UL CLASS C: 20A, 150V.
 UL CLASS D: 10A, 300V.
 CSA TYPE B: 20A, 300V.
 CSA TYPE C: 20A, 300V.
 CSA TYPE D: 10A, 300V.
 CSA TYPE E: 20A, 300V.
 WIRE RANGE: 12-22 AWG.

MECHANICAL:
 OPERATING TEMP.: -40°C TO +105°C.
 RECOMMENDED TIGHTENING TORQUE: 7 IN-LBS.

- ① TRIMMED TO LENGTH.
- ② PRELIMINARY PART NUMBER.

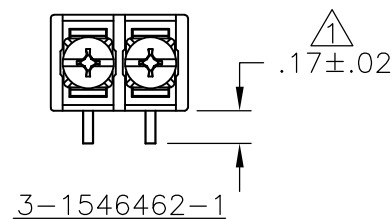
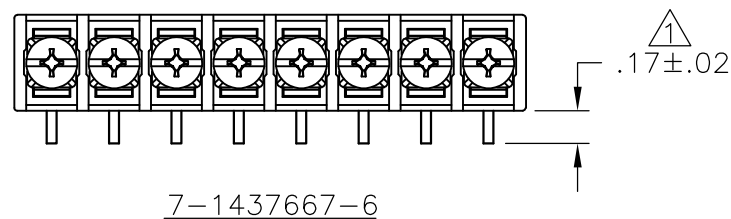
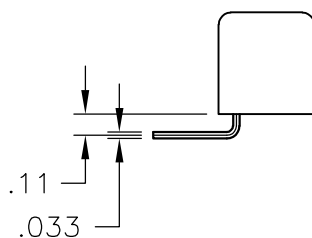
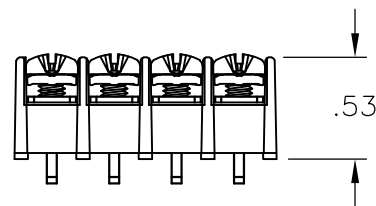
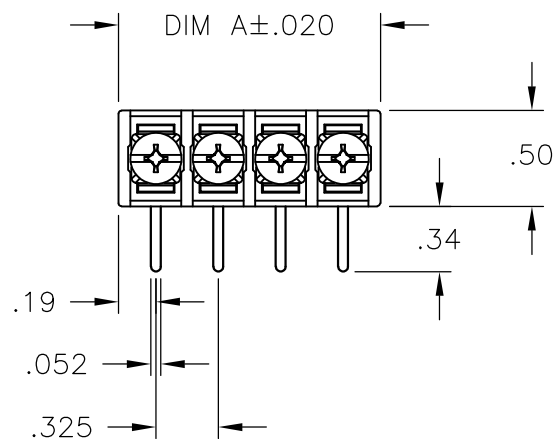

SEE FIGURE

SEE FIGURE

DIM A	NO OF POS	CATALOG NUMBER	PART NUMBER
9.815	30	4DB-R108-30	3-1546462-0
9.490	29	4DB-R108-29	2-1546462-9
9.165	28	4DB-R108-28	2-1546462-8
8.840	27	4DB-R108-27	2-1546462-7
8.515	26	4DB-R108-26	2-1546462-6
8.190	25	4DB-R108-25	2-1546462-5
7.865	24	4DB-R108-24	2-1546462-4
7.540	23	4DB-R108-23	1437668-7
7.215	22	4DB-R108-22	2-1546462-2
6.890	21	4DB-R108-21	2-1546462-1
6.565	20	4DB-R108-20	7-1437667-8
6.240	19	4DB-R108-19	1-1546462-9
5.915	18	4DB-R108-18	1-1546462-8
5.590	17	4DB-R108-17	1-1546462-7
5.265	16	4DB-R108-16	1-1546462-6
4.940	15	4DB-R108-15	7-1437667-7
4.615	14	4DB-R108-14	1-1546462-4
4.290	13	4DB-R108-13	1-1546462-3
3.965	12	4DB-R108-12	1-1546462-2
3.640	11	4DB-R108-11	1-1546462-1
3.315	10	4DB-R108-10	1-1546462-0
2.990	9	4DB-R108-09	1546462-9
2.665	8	4DB-R108-08-085	7-1437667-6
2.665	8	4DB-R108-08	1546462-8
2.340	7	4DB-R108-07	1546462-7
2.015	6	4DB-R108-06	7-1437667-5
1.690	5	4DB-R108-05	7-1437667-4
1.365	4	4DB-R108-04	7-1437667-3
1.040	3	4DB-R108-03	7-1437667-2
.715	2	4DB-R108-02-107	3-1546462-1
.715	2	4DB-R108-02	7-1437667-1

THIS DRAWING IS A CONTROLLED DOCUMENT.		DWN	S SCHLEGEL	1/21/03	Tyco Electronics Corporation Harrisburg, PA 17105-3608		
DIMENSIONS: INCHES		CHK	S YODER	1/21/03			
TOLERANCES UNLESS OTHERWISE SPECIFIED:		APVD	S YODER	1/21/03	NAME		
0 PLC ± - 1 PLC ± - 2 PLC ± .01 3 PLC ± .005 4 PLC ± - ANGLES ± 2°		PRODUCT SPEC		4DB SERIES R108 STYLE			
MATERIAL		APPLICATION SPEC		SIZE			
FINISH		WEIGHT		CAGE CODE		DRAWING NO	RESTRICTED TO
-		-		A3 00779		G-7-1437667-1	-
CUSTOMER DRAWING				SCALE	NTS	SHEET	1 OF 1
				REV	B1		