



Chipsmall Limited consists of a professional team with an average of over 10 year of expertise in the distribution of electronic components. Based in Hongkong, we have already established firm and mutual-benefit business relationships with customers from,Europe,America and south Asia,supplying obsolete and hard-to-find components to meet their specific needs.

With the principle of “Quality Parts,Customers Priority,Honest Operation,and Considerate Service”,our business mainly focus on the distribution of electronic components. Line cards we deal with include Microchip,ALPS,ROHM,Xilinx,Pulse,ON,Everlight and Freescale. Main products comprise IC,Modules,Potentiometer,IC Socket,Relay,Connector.Our parts cover such applications as commercial,industrial, and automotives areas.

We are looking forward to setting up business relationship with you and hope to provide you with the best service and solution. Let us make a better world for our industry!



Contact us

Tel: +86-755-8981 8866 Fax: +86-755-8427 6832

Email & Skype: info@chipsmall.com Web: www.chipsmall.com

Address: A1208, Overseas Decoration Building, #122 Zhenhua RD., Futian, Shenzhen, China



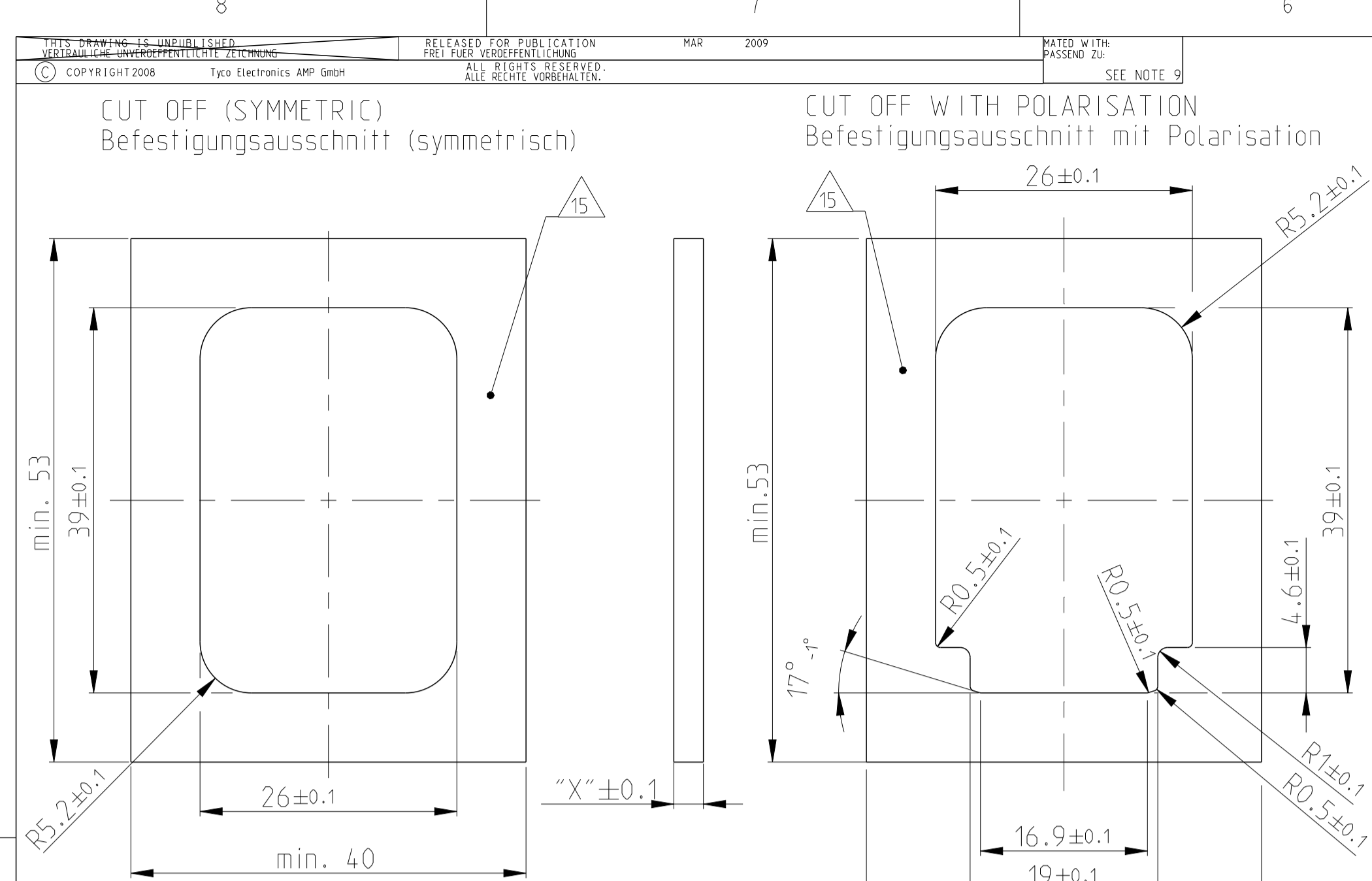

FIXING WITH SLIDE
Befestigung mit Schieber

W ALLTHICKNESS "X" Wandstaerke "X"	TE ORDER NO. TE Best.-Nr.
1.0mm	0-1564562-4
1.5mm	0-1564562-5
2.5mm	0-1564562-2
3.0mm	0-1564562-1
3.5mm	N.N.
4.0mm	N.N.

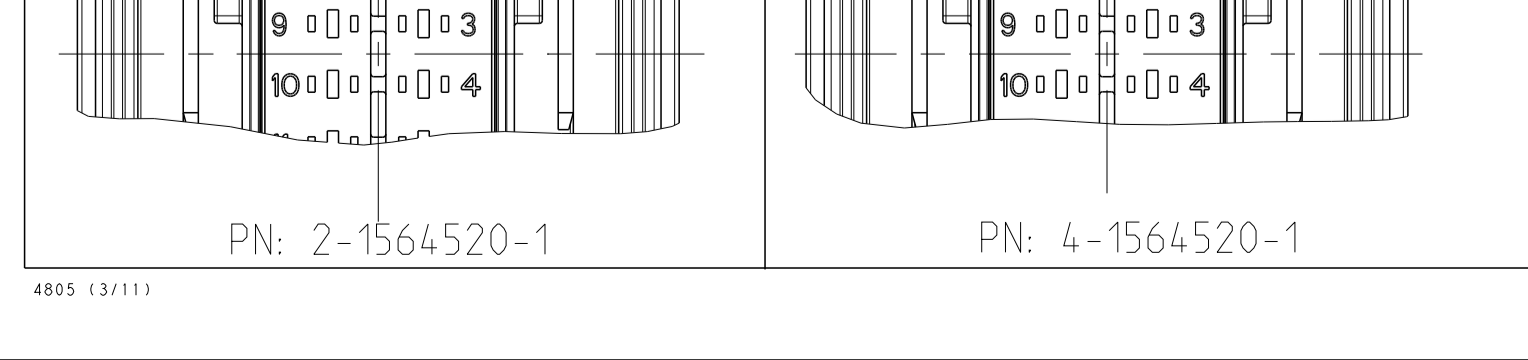
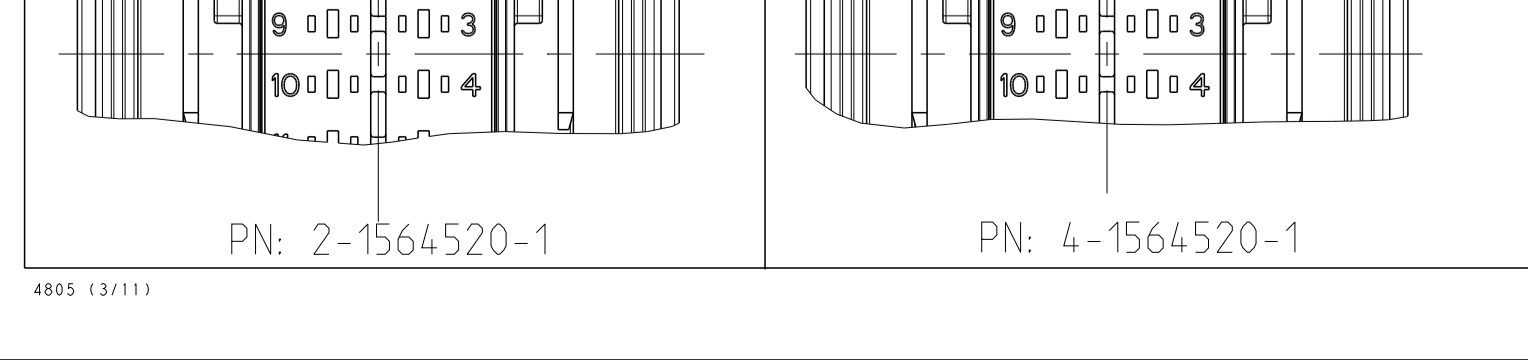
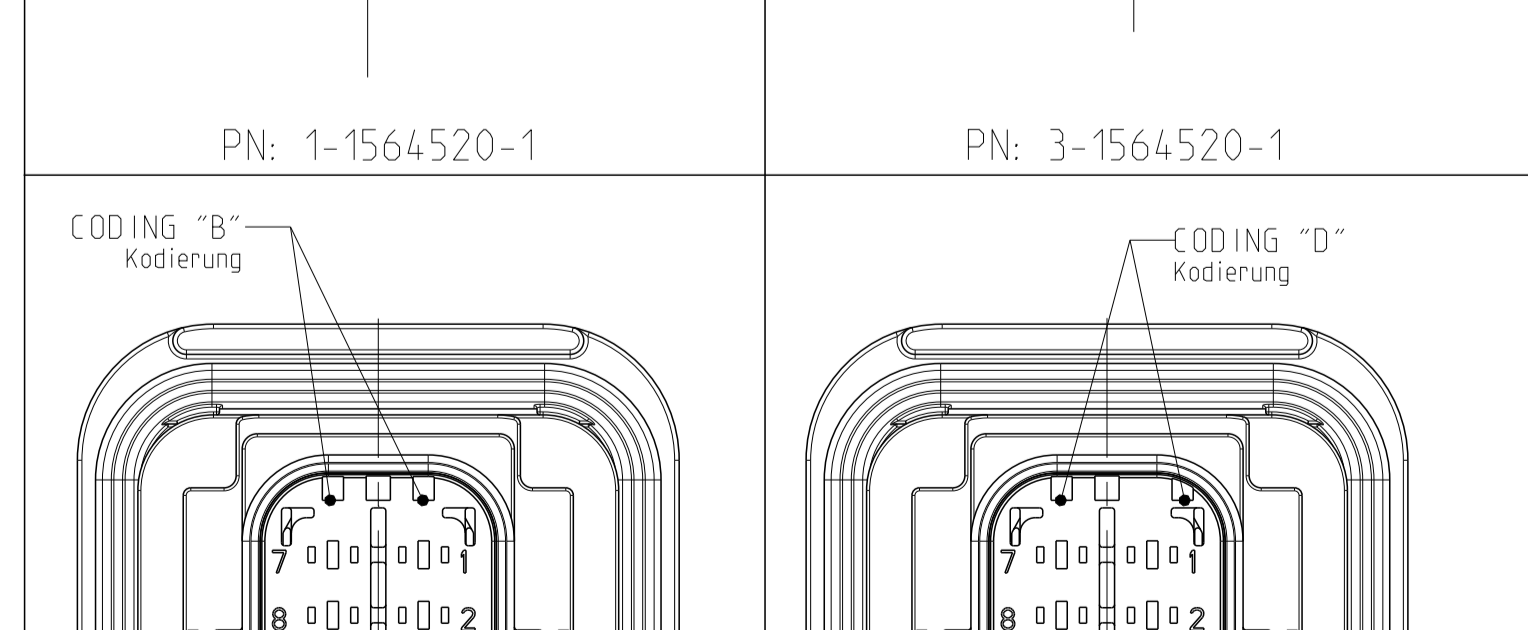
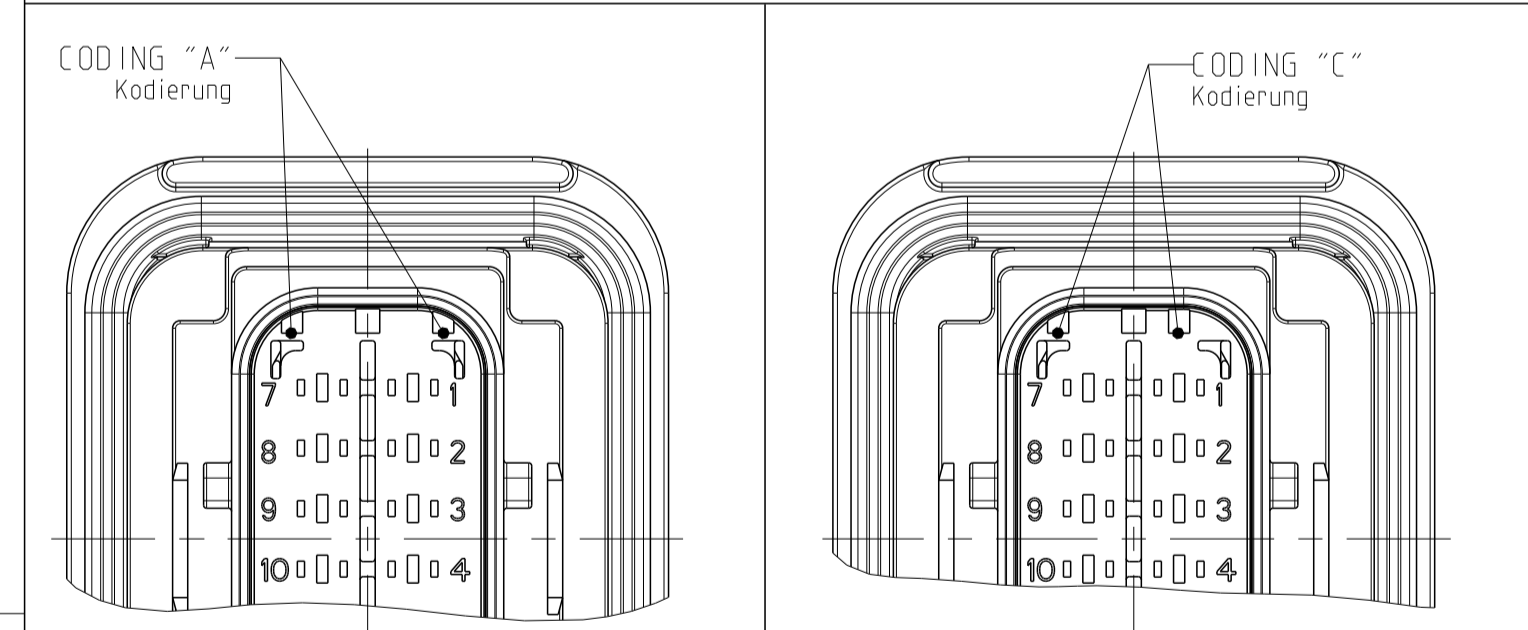
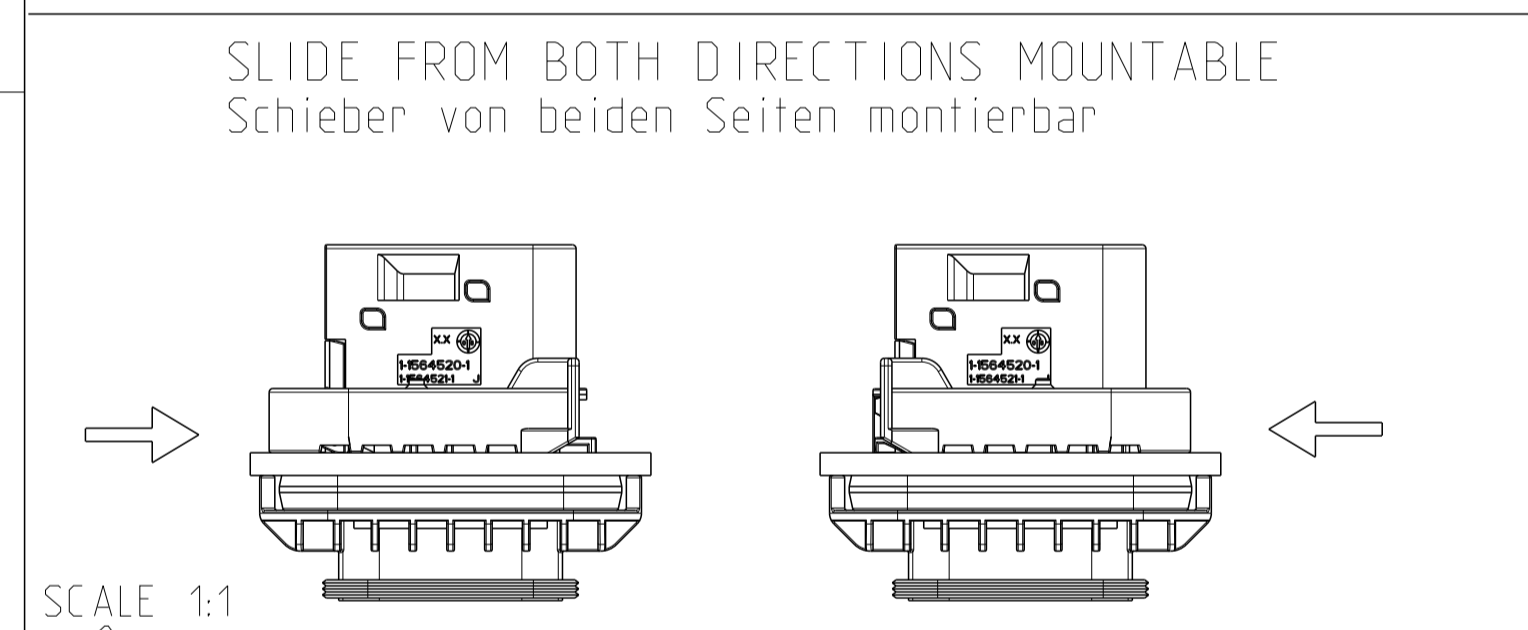
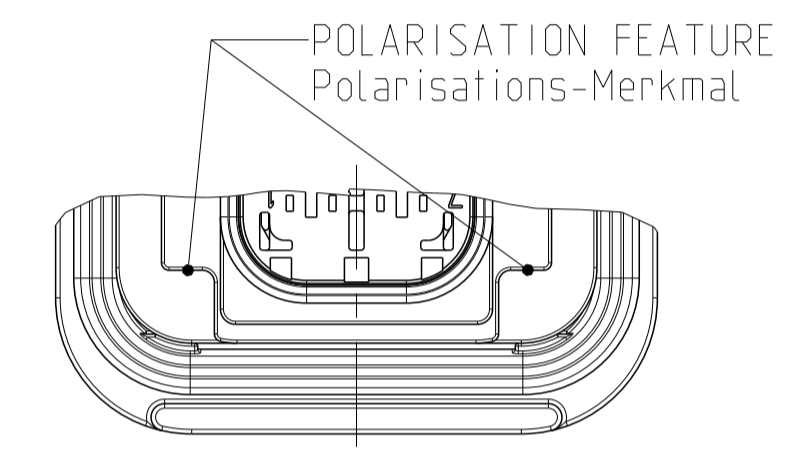

- NOTES
Bemerkungen
- TE ORDER-NO.
TE Bestell-Nr.
 - CAVITY NUMBERING
Kammerbezeichnung
 - PRODUCTION DATE
Produktionsdatum
 - LETTER-INSERT FOR THE REVISION STATUS OF THE MOULD
Schriftsatz fuer Aenderungszustand des Werkzeuges
 - MATERIAL MARKING ACCORDING TO VDA 260
Werkstoffkennzeichnung nach VDA 260
 - BULK PACKAGING IN CORRUGATED BOX
Schueftgut im Versandkarton
 - MOULD CAVITY MARKING
Nestmarkierung
 - TE LOGO
TE Logo
 - SUITABLE COUNTERPART SEE DRAWING: 1703639
passendes Gegenstueck siehe Zeichnung: 1703639
 - CAVITIES MATED WITH TAB 1.6x0.6 MM (SW S)
SEE PRODUCT GROUP DRAWING
TE NO: 1355055
MAX. WIRE SIZE: 1.0mm² FLR

WIRE SIZE: 1.5mm² FLR PERMITTED ONLY IN
ASSOCIATION WITH
SINGLE WIRE SEALING PN 0-2287497-1
ALLOWED TEMPERATURE 120 DEGREE CELSIUS

Kontaktkammer passend fuer Flachstecker 1.6x0.6 mm (EDS)
siehe Produktgruppenzeichnung
TE Nr: 1355055
max. Drahtgroessenbereich: 1.0mm² FLR

Es ist ein Drahtgroessenbereich von 1.5mm² FLR nur
in Verbindung
mit der Einzelleitendichtung PN 0-2287497-1
bis zu 120°C zugelassen
 - INTERFACE ACC. Drawing: 114-18807-1
Kragenanschluss nach Zeichnung: 114-18807-1
 - MATED WITH COVER SEE DRAWING: 1563110, 1563111
Passend zu Kappe siehe Zeichnung: 1563110, 1563111
 - SLIDING DISTANCE OF SECONDARY LOCKING
Verschiebeweg der zweiten Kontaktsicherung

1-1564520-1 AS SHOWN
1-1564520-1 wie gezeigt

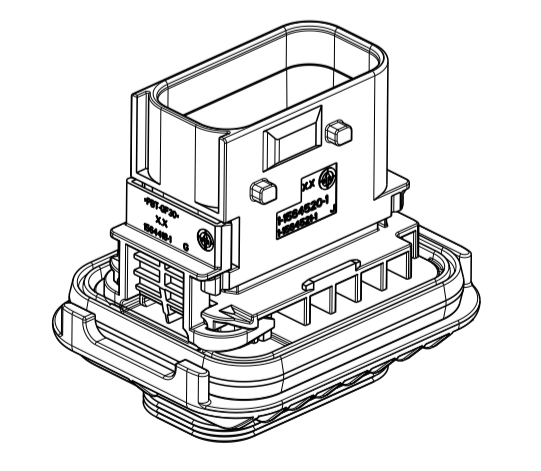
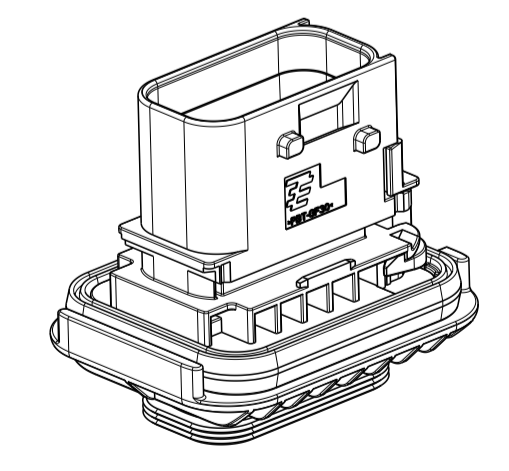
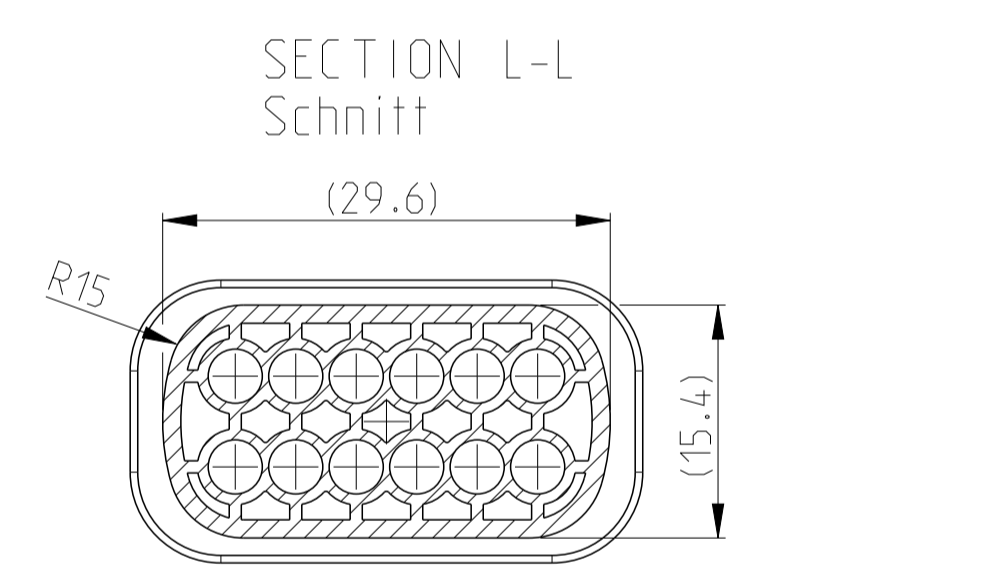
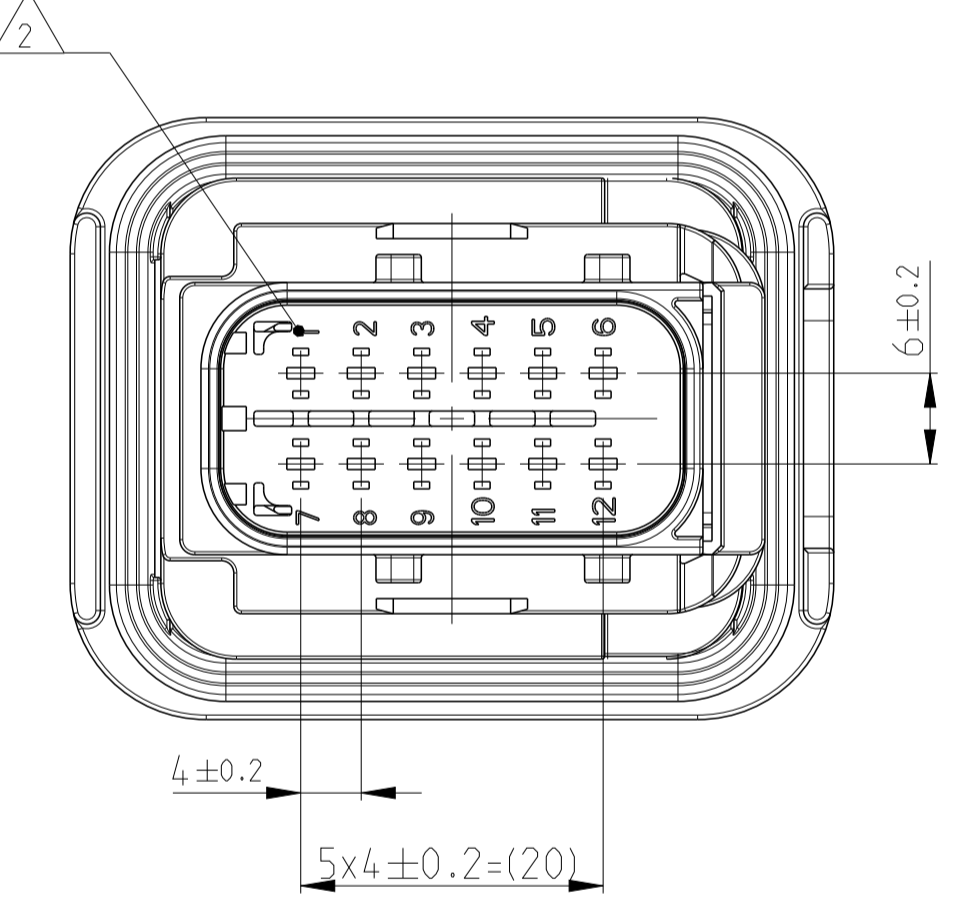
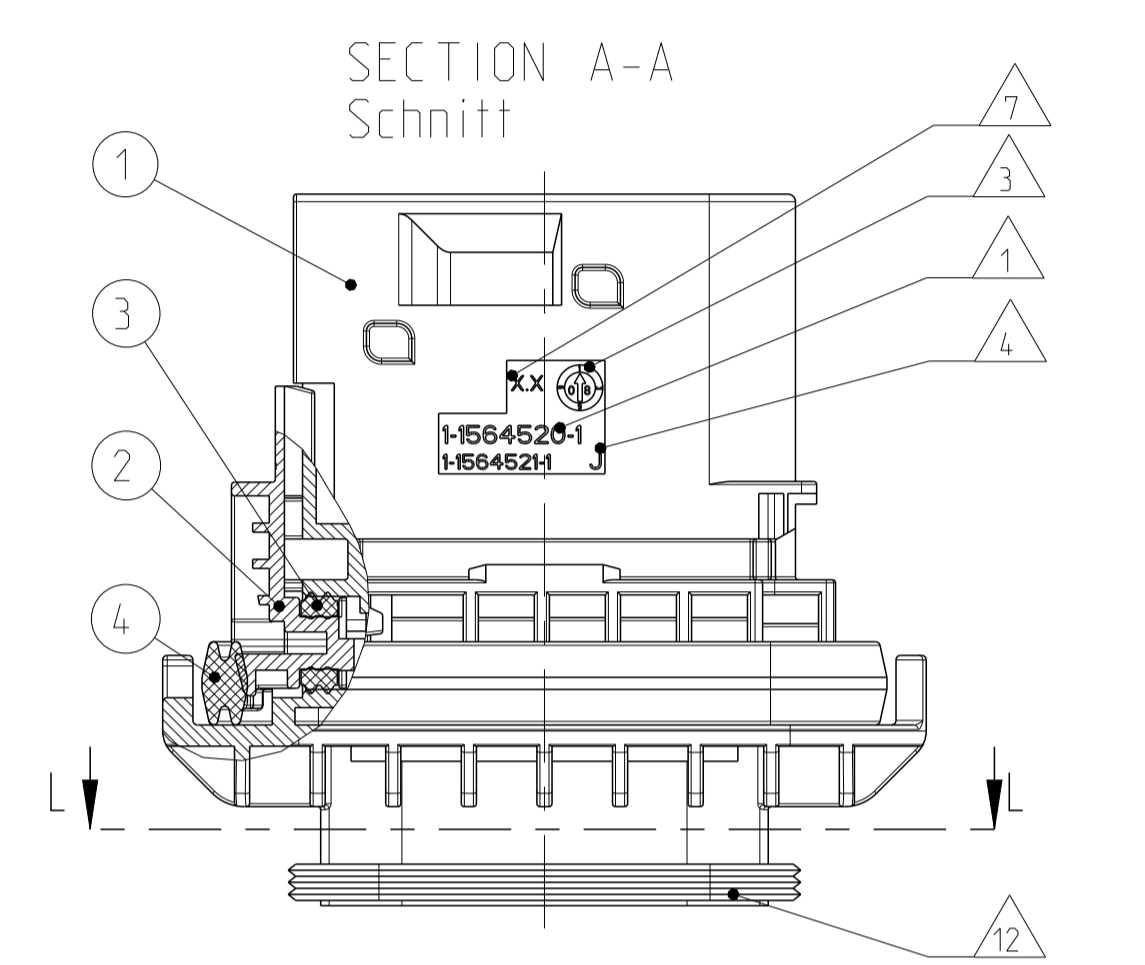
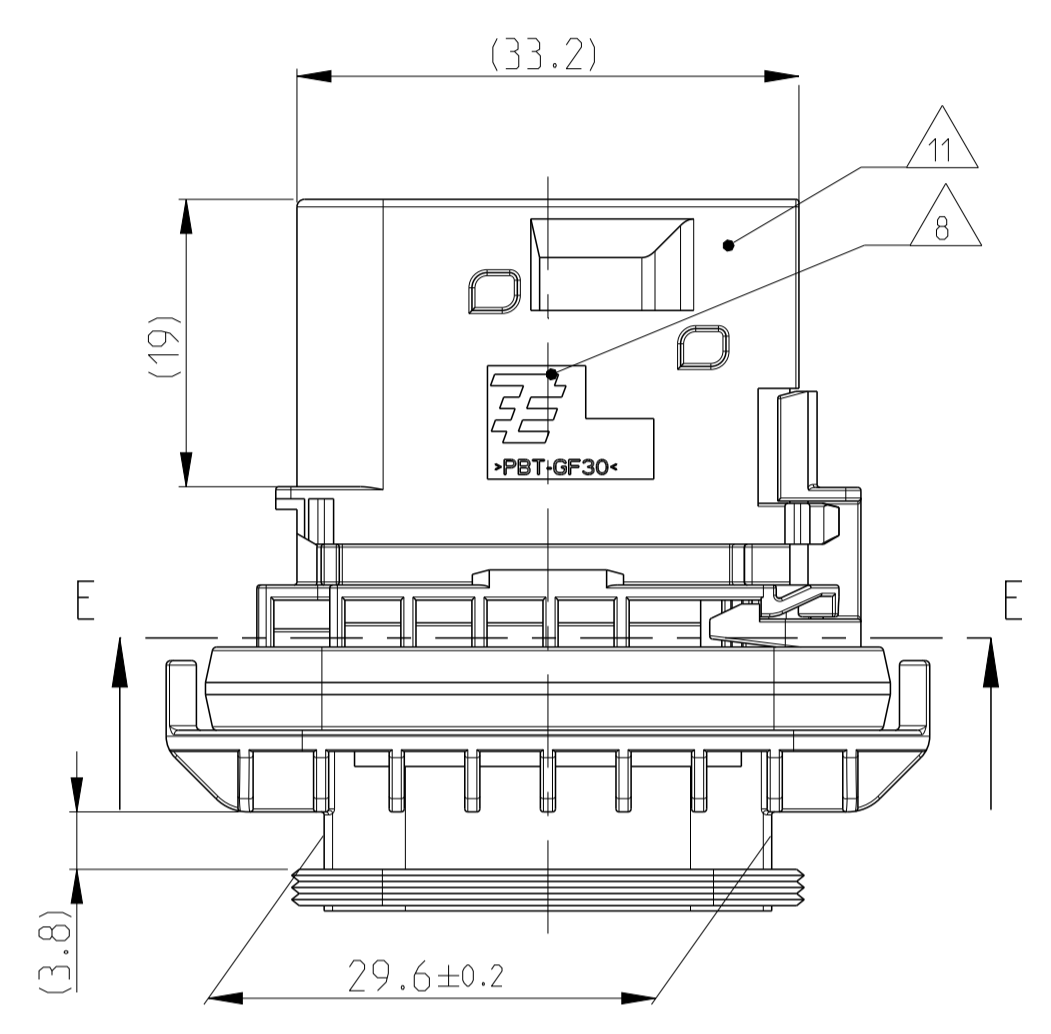
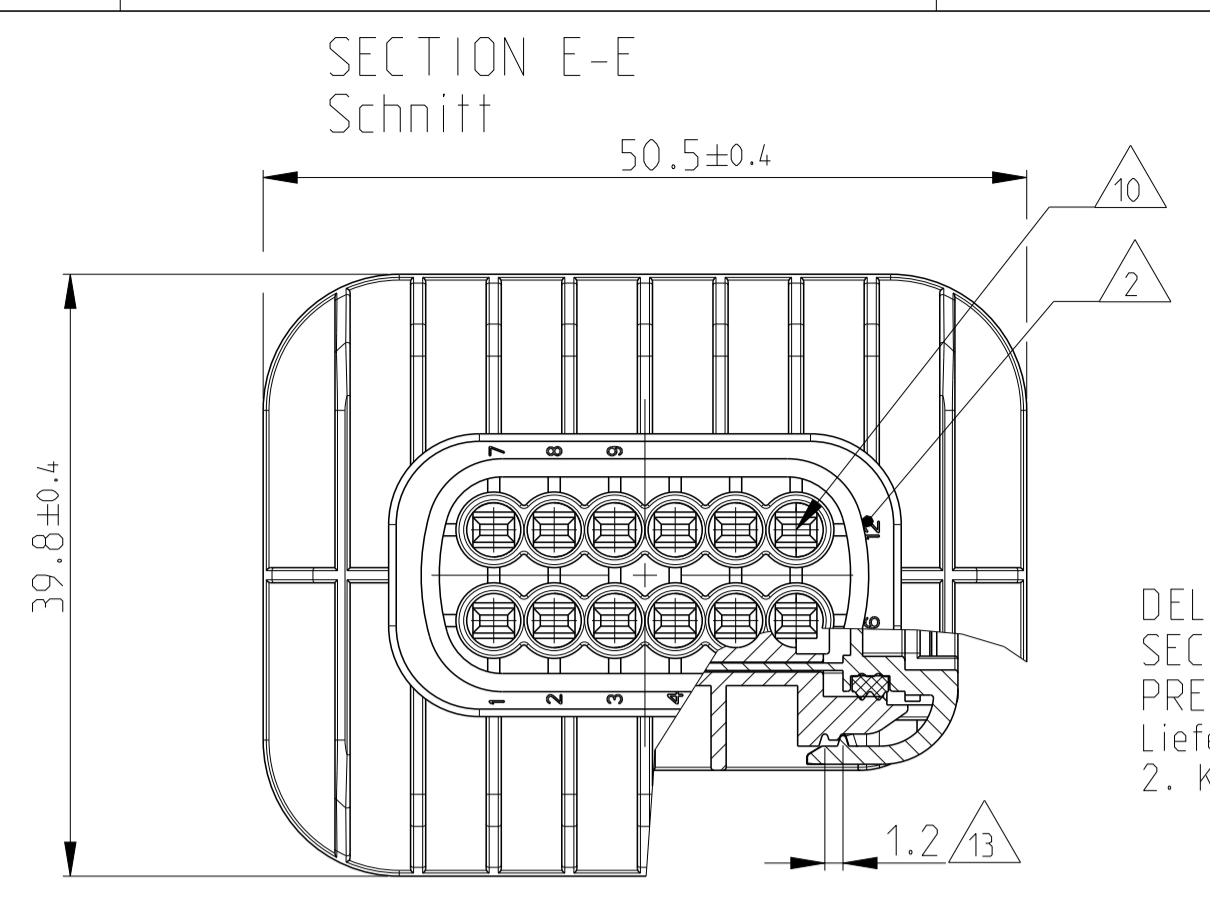
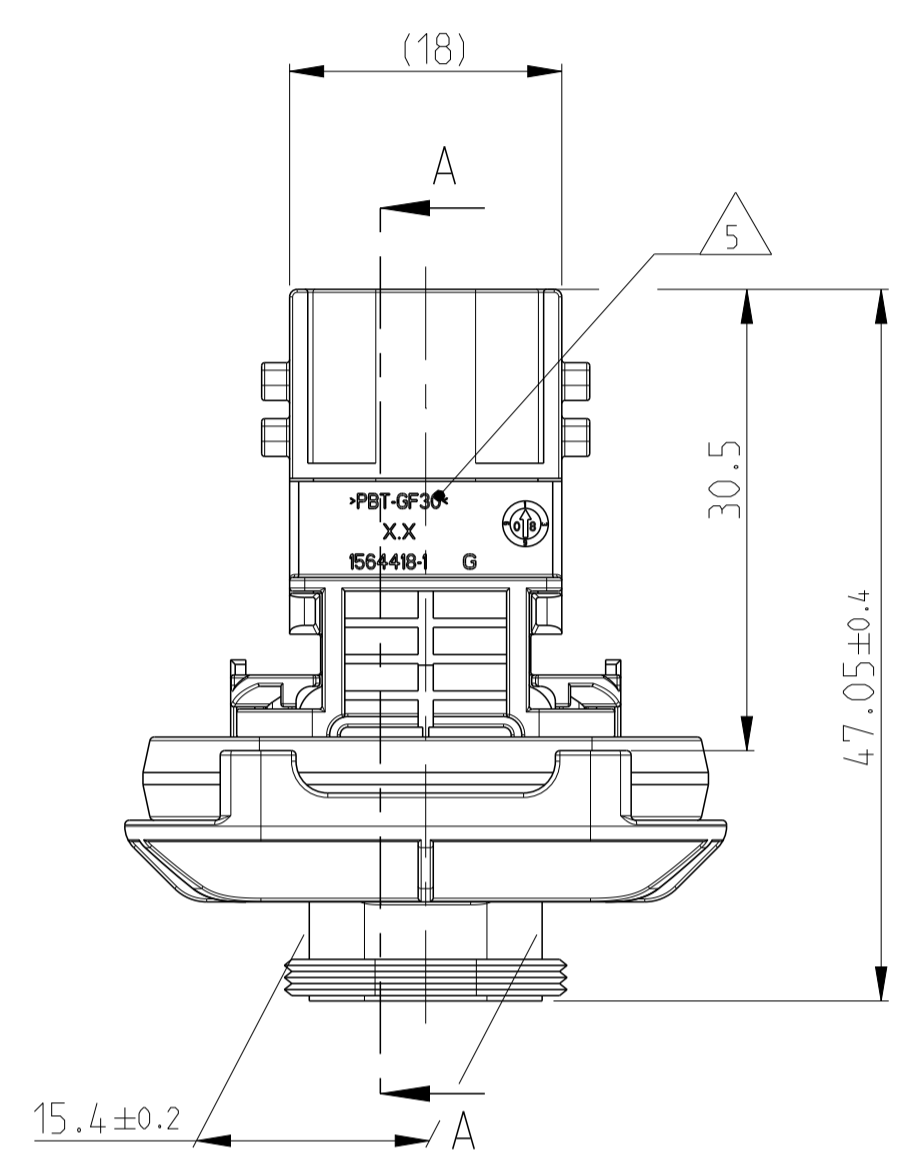

- 14 MALFUNCTION CAUSED BY LAQUER IS NOT COVERED BY TE WARRANTY
Funktionsbeeintraechtigung durch Lackieren. Liegt nicht im Einfluss und Gewährleistungsumfang von TE
- SEALING SURFACE CUTOFF
Dichtflaeche Blechausschnitt
- SURFACE ROUGHNESS Ra MAX. 1.8µm OR LESS FOR METAL PARTS.
Werkzeugoberflaeche Ra Max. 1.8µm oder weniger fuer Metallteile
- SURFACE ROUGHNESS MIN. VDI 3400 - CLASS 24 FOR PLASTIC PARTS.
Werkzeugoberflaeche Min. VDI 3400 - Class 24 fuer Kunststoffteile.
- THE FLATNESS MUST BE WITHIN THE TOLERANCE OF THE SHEET.
THEREFORE WITHIN ±0.1MM.
Die Ebenheit muss innerhalb der Toleranz des Blechs liegen (±0.1mm)
- NO SINK MARKS. EJECTOR, DRAFT, DENTS. SCRATCHES.
RECESSES ON THE SEALING AREA ALLOWED.
Keine Einfallstellen, Auswerfer, Ausformschraegen, Delle, Kratzer, Absaeetze zulaessig.

1	1	1	1	2	3	4	ITEM NO
PBOS. TAB HOUSING, CODE "A" Zusatz. Flachsteckergehaeuse, Kod. "A"	PBOS. TAB HOUSING, CODE "A" Zusatz. Flachsteckergehaeuse, Kod. "A"	PBOS. TAB HOUSING, CODE "C" Zusatz. Flachsteckergehaeuse, Kod. "C"	PBOS. TAB HOUSING, CODE "D" Zusatz. Flachsteckergehaeuse, Kod. "D"	PBOS. TAB HOUSING, CODE "D" Zusatz. Flachsteckergehaeuse, Kod. "D"	SEAL FOR SECONDARY LOCKING Zweite Kontaktsicherung	SEAL FOR SECONDARY LOCKING Zweite Kontaktsicherung	DESCRIPTION Beschreibung
BLACK GRY	GREEN GRN	BLUE BLU	YELLOW GRN	WHITE WHT	GREEN GRN	GREEN GRN	COLOUR Farbe
PBT-GF30 / V-0	PBT-GF30 / V-0	PBT-GF30 / V-0	PBT-GF30 / V-0	PBT-GF30 / V-0	MV0	MV0	MATERIAL

TE ORDER-NO. TE Bestell-Nr.	REV.	NO. OF POS. Polzahl	CODE Kodierung	QUANTITY Stueck	ITEM NO NO ASSY	MATERIAL siehe Tabelle	FINISH/BEFLAECHENFARBE siehe Tabelle	WEIGHT GEWICHT	CUSTOMER DRAWING
4-1564520-1	H	12	D	- - - 1 1 1 1 1 4	4				
3-1564520-1	H	12	C	- - - 1 - 1 1 1 1 3	3				
2-1564520-1	H	12	B	- 1 - - - 1 1 1 1 2	2				
1-1564520-1	H	12	A	1 - - - - 1 1 1 1 1	1				

THIS DRAWING IS A CONTROLLED DOCUMENT. Dieses Zeichnungsmerkmal ist durch den integrierten Kontrollcode geschützt. Änderungen sind ohne schriftliche Genehmigung nicht zulässig. Die Rechte an dieser Zeichnung sind Eigentum der TE Connectivity Corporation.		OWN S. Jaeger 17FEB2009	CHK J. Grandzwil 18FEB2009	APVD E. Berwein 19FEB2009
DIMENSIONS MASSENMAEßEN mm		TOLERANCES UNLESS OTHERWISE SPECIFIED: ALLE DIMENSIONEN		
P L C D I N 8 0 1 5 D I N 1 6 0 1 1 0		P L C D I N 8 0 1 5 D I N 1 6 0 1 1 0		
APPLICATION SPEC VERARBEITUNGSPEZ. 114-18807-1		APPLICATION SPEC VERARBEITUNGSPEZ. 114-18807-1		
WEIGHT GEWICHT		RESTRICTED TO NUR FÜR		
28.95g		-		
CUSTOMER DRAWING		REV. H2		

DELIVERY CONDITION:
SECONDARY LOCKING DEVICE IN
PRE-LOCKED POSITION
Lieferzustand:
2. Kontaktsicherung in Vorrastellung

LOC	DIST	REV	DATE	OWN	APVD
A1	-	G1	10 JUN 2009	SJ	JG
		H	22 SEP 2010	AK	JG
		H1	25 MAY 2011	CG	JG
		H2	27 APR 2016	MAH	GILC