



Chipsmall Limited consists of a professional team with an average of over 10 year of expertise in the distribution of electronic components. Based in Hongkong, we have already established firm and mutual-benefit business relationships with customers from,Europe,America and south Asia,supplying obsolete and hard-to-find components to meet their specific needs.

With the principle of "Quality Parts,Customers Priority,Honest Operation,and Considerate Service",our business mainly focus on the distribution of electronic components. Line cards we deal with include Microchip,ALPS,ROHM,Xilinx,Pulse,ON,Everlight and Freescale. Main products comprise IC,Modules,Potentiometer,IC Socket,Relay,Connector.Our parts cover such applications as commercial,industrial, and automotives areas.

We are looking forward to setting up business relationship with you and hope to provide you with the best service and solution. Let us make a better world for our industry!



Contact us

Tel: +86-755-8981 8866 Fax: +86-755-8427 6832

Email & Skype: info@chipsmall.com Web: www.chipsmall.com

Address: A1208, Overseas Decoration Building, #122 Zhenhua RD., Futian, Shenzhen, China



THIS DRAWING IS UNPUBLISHED
 VERTRAULICHE UNVERÖFFENTLICHTE ZEICHNUNG
 RELEASED FOR PUBLICATION
 FREI FÜR VERÖFFENTLICHUNG
 20.AUG. 2010
 DATED WITH
 PASSEND ZU: 2120325-1
 ALL RIGHTS RESERVED.
 ALLE INTERNATIONALEN RECHTE VORBEHALTEN.

LOC	DIST	REVISIONS ÄNDERUNGEN					
PROJECT NO.:		P	LTR	DESCRIPTION BESCHREIBUNG	DATE	DWN	APVD
A1	-		F1	WALL ADDED BY POWER CONTACTS; CRIMP SIDE	01DEC2011	KHH	HEIN
			G1	CAVITY ETHERN. CORE REWORKED (PCN E-12-001219)	09FEB2012	ER	HEIN
			H1	CONTACT CAVITY DOMES REWORKED (PCN E-14-002151)	14FEB2014	ER	DO

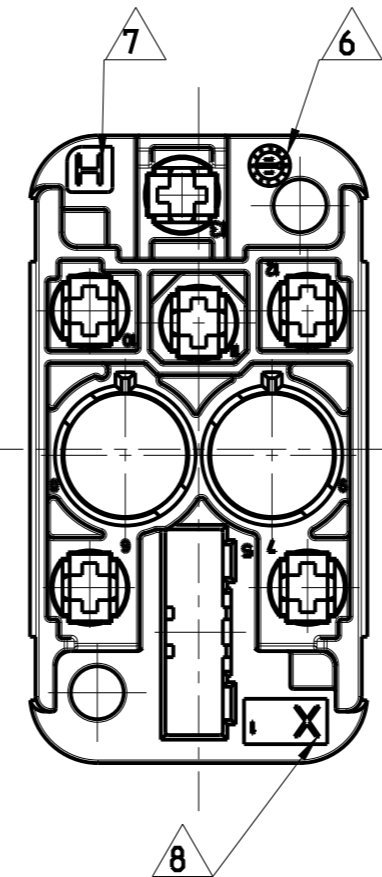
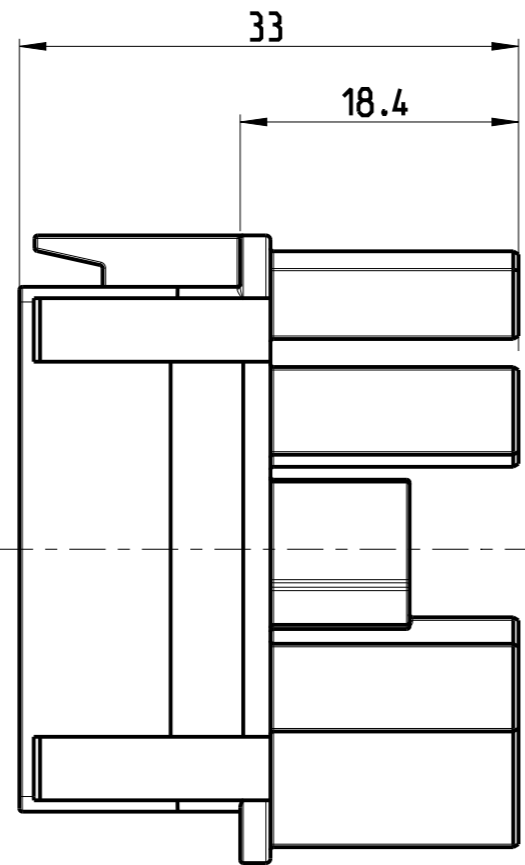
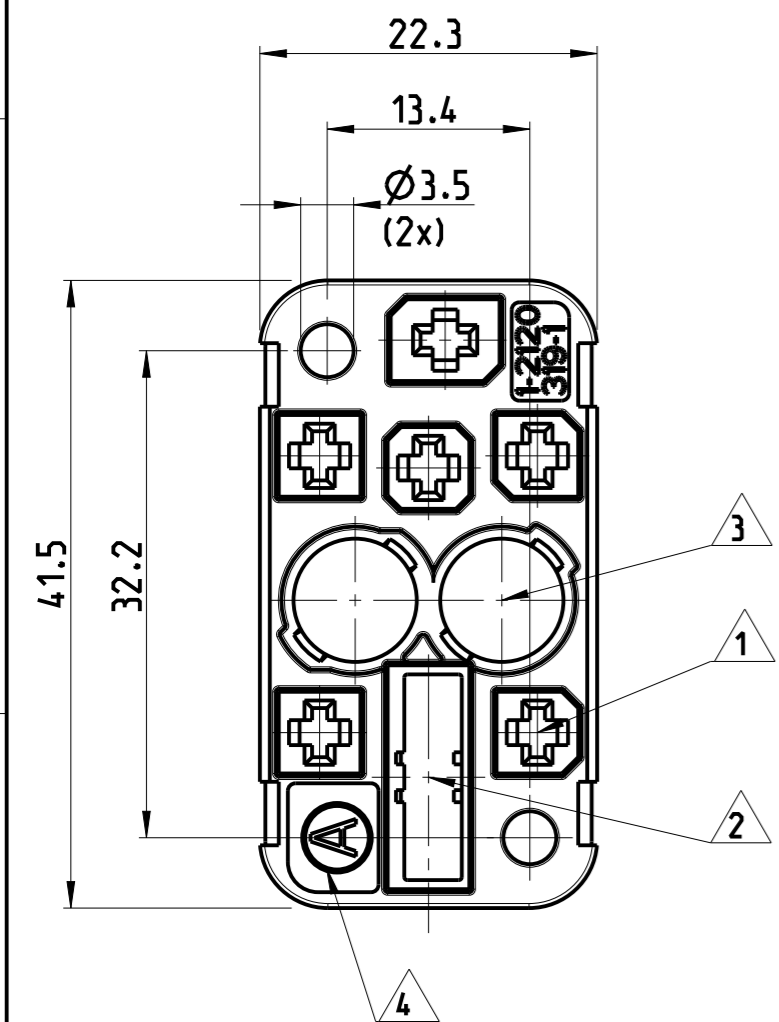

- 1 CAVITY FOR CONTACT MCON 2.8
 - 2 CAVITY FOR SIGNAL HOUSING 2120321-1 FOR CONTACT MCON 1.2
 - 3 CAVITY FOR ETHERNET CORE PN 1103427-2
 - 4 CODING IDENTIFIER CUSTOMER SPECIFIED
 - 5 PARTNUMBER
 - 6 DATE CLOCK
 - 7 REVISION
 - 8 CAVITY IDENTIFIER
 - 9 PACKAGING: PARTS ARE BULK PACKED INTO A CARDBOARD
-
- 1 KAMMER PASSEND FUER KONTAKT MCON 2.8
 - 2 KAMMER PASSEND FUER SIGNAL HOUSING 2120321-1 FUER KONTAKT MCON 1.2
 - 3 KAMMER PASSEND FUER ETHERNET CORE PN 1103427-2
 - 4 KUNDENSPEZIFISCHE KODIERUNGSKENZEICHNUNG
 - 5 SACHNUMMER
 - 6 DATUMSUHR
 - 7 REVISINSSTAND
 - 8 NESTKENNZEICHNUNG
 - 9 VERPACKUNG: TEILE ALS SCHUETTUT IN EINEM KARTON VERPACKT

1-2120319-1	-	-	-	-	-
TE ORDER NO. BESTELL-NR.	ITEM-NO. POS.	QTY. STK.	DESCRIPTION BENENNUNG	SURFACE OBERFLAECHE COLOUR/FARBE	MATERIAL
	1	1	RECEPTACLE HOUSING BUCHSENGEHAEUSE	BLACK SCHWARZ	PBT-GF30

THIS DRAWING IS A CONTROLLED DOCUMENT. <small>DIESSES ZEICHNUNGSDOKUMENT WIRD NUR FÜR DEN BESTIMMTEN ANWENDUNGSBEREICH FREI GEGEBEN. BEI WECHSELN DER BESTIMMTEN PERSONEN ODER ANWENDUNGEN SIND VERÄNDERUNGEN AN DER ZEICHNUNG ZU MACHEN. BEI WECHSELN DER ZEICHNUNGSDOKUMENTE SIND VERÄNDERUNGEN AN DER ZEICHNUNG ZU MACHEN.</small>		DWN S. HASS 20AUG2010	TE Connectivity	
DIMENSIONS: MASSEINHEITEN: MM	TOLERANCES UNLESS OTHERWISE SPECIFIED: ALLGEMEINTOLERANZEN	CHK K.-H. HESS 20AUG2010		
		APVD S. HEIN 20AUG2010		
MATERIAL - FINISH/OBERFLAECHE/FARBE -		PRODUCT SPEC 108-94252 APPLICATION SPEC 114-94067 WEIGHT GEWICHT 12g		
		SIZE A3 CAGE CODE 00779 DRAWING NO. ZEICHNUNGS-NR. C-2120319	RESTRICTED TO NUR FUER -	
		Customer Drawing	/KUNDENZEICHNUNG	SCALE MASSSTAB 2:1 SHEET BLATT 1 OF 1 REV H1