



Chipsmall Limited consists of a professional team with an average of over 10 year of expertise in the distribution of electronic components. Based in Hongkong, we have already established firm and mutual-benefit business relationships with customers from,Europe,America and south Asia,supplying obsolete and hard-to-find components to meet their specific needs.

With the principle of "Quality Parts,Customers Priority,Honest Operation,and Considerate Service",our business mainly focus on the distribution of electronic components. Line cards we deal with include Microchip,ALPS,ROHM,Xilinx,Pulse,ON,Everlight and Freescale. Main products comprise IC,Modules,Potentiometer,IC Socket,Relay,Connector.Our parts cover such applications as commercial,industrial, and automotives areas.

We are looking forward to setting up business relationship with you and hope to provide you with the best service and solution. Let us make a better world for our industry!



Contact us

Tel: +86-755-8981 8866 Fax: +86-755-8427 6832

Email & Skype: info@chipsmall.com Web: www.chipsmall.com

Address: A1208, Overseas Decoration Building, #122 Zhenhua RD., Futian, Shenzhen, China



THIS DRAWING IS UNPUBLISHED. RELEASED FOR PUBLICATION, 19 .
 © COPYRIGHT 19 BY AMP INCORPORATED. ALL INTERNATIONAL RIGHTS RESERVED.

LOC	DIST	P	F	ZONE	LTR	REVISIONS	DATE	APPD
AG	1				V	REACT-9; PER 0650-0052-98	5-6-98	LM

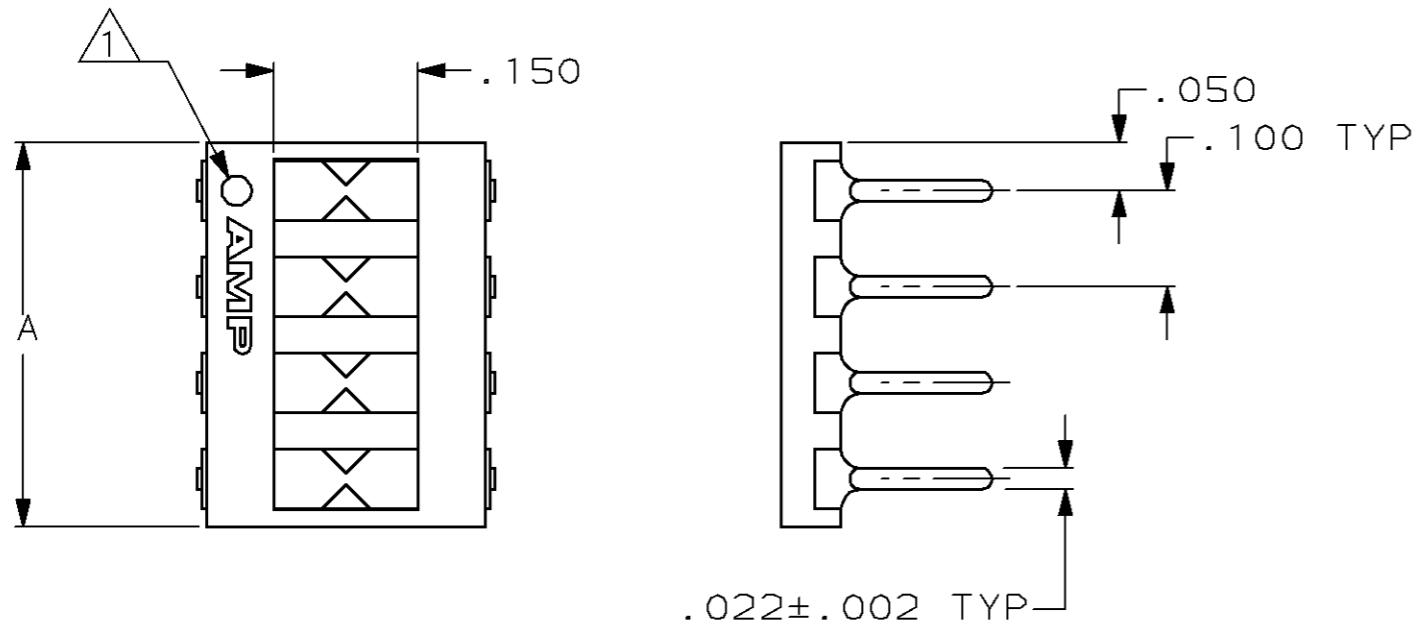

① PIN NUMBER ONE IDENTIFICATION.
 ② MOUNTING SURFACE WHEN INSERTED IN .040 DIA MOUNTING HOLES.

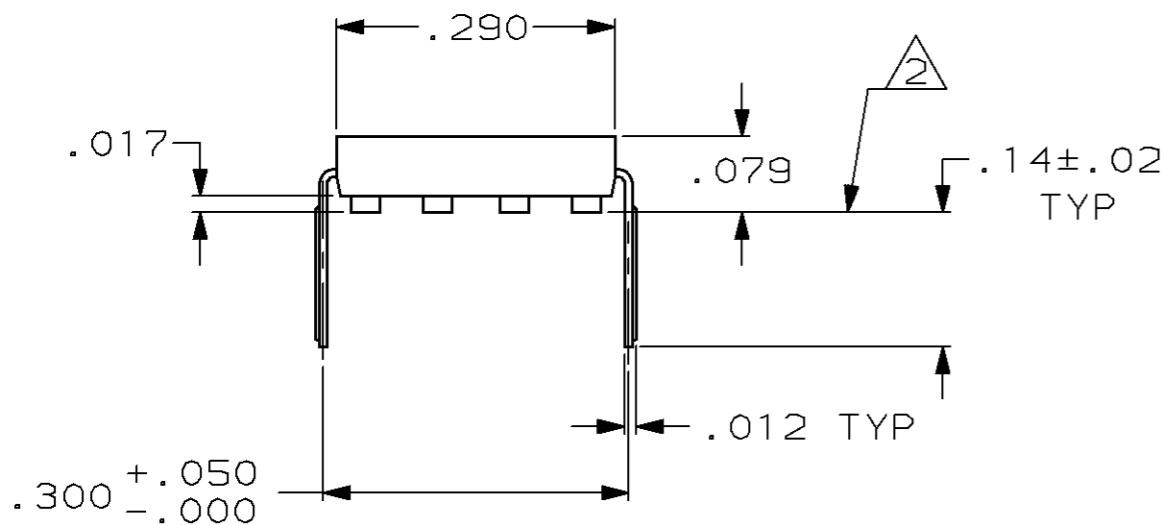

	PLATING	A	NO. OF POSN	PART NO
OBSOLETE	.000015 MIN GOLD ON CONTACT LEADS,	.400	4	1-435704-6
OBSOLETE	OVER NICKEL.	.800	8	1-435704-4
	.000100 MIN. TIN OVER NICKEL	1.200	12	1-435704-2
		1.000	10	1-435704-0
		.900	9	435704-9
		.800	8	435704-8
		.700	7	435704-7
		.600	6	435704-6
OBSOLETE		.500	5	435704-5
		.400	4	435704-4
OBSOLETE		.300	3	435704-3
OBSOLETE		.200	2	435704-2

DO NOT SCALE PRINT. UNLESS SPECIFIED DIMENSIONS TOLERANCES ON: 2 PLC DEC ± - 3 PLC DEC ± .005 ANGLES ± -	DR 12 OCT 1989 M.CYRUS	AMP INCORPORATED Harrisburg, Pa. 17105	
MATERIAL HOUSING: BLACK POLYESTER CONTACT: COPPER ALLOY	CHK -		
FINISH SEE TABLE	APPD -	SIZE B	CAGE CODE 00779
	APPD -	SCALE 5:1	DRAWING NO 435704
	PRODUCT SPEC -		SHEET 1 OF 1
	APPLICATION SPEC -		
	WEIGHT -		