



Chipsmall Limited consists of a professional team with an average of over 10 year of expertise in the distribution of electronic components. Based in Hongkong, we have already established firm and mutual-benefit business relationships with customers from,Europe,America and south Asia,supplying obsolete and hard-to-find components to meet their specific needs.

With the principle of “Quality Parts,Customers Priority,Honest Operation,and Considerate Service”,our business mainly focus on the distribution of electronic components. Line cards we deal with include Microchip,ALPS,ROHM,Xilinx,Pulse,ON,Everlight and Freescale. Main products comprise IC,Modules,Potentiometer,IC Socket,Relay,Connector.Our parts cover such applications as commercial,industrial, and automotives areas.

We are looking forward to setting up business relationship with you and hope to provide you with the best service and solution. Let us make a better world for our industry!



## Contact us

Tel: +86-755-8981 8866 Fax: +86-755-8427 6832

Email & Skype: info@chipsmall.com Web: www.chipsmall.com

Address: A1208, Overseas Decoration Building, #122 Zhenhua RD., Futian, Shenzhen, China



THIS DRAWING IS UNPUBLISHED. RELEASED FOR PUBLICATION  
 © COPYRIGHT - BY TYCO ELECTRONICS CORPORATION. ALL RIGHTS RESERVED.

LOC	DIST	REVISIONS					
H	-	P	LTR	DESCRIPTION	DATE	DWN	APVD
			A	ECN EH10 0344 05	09 MAR 05	MG	MG

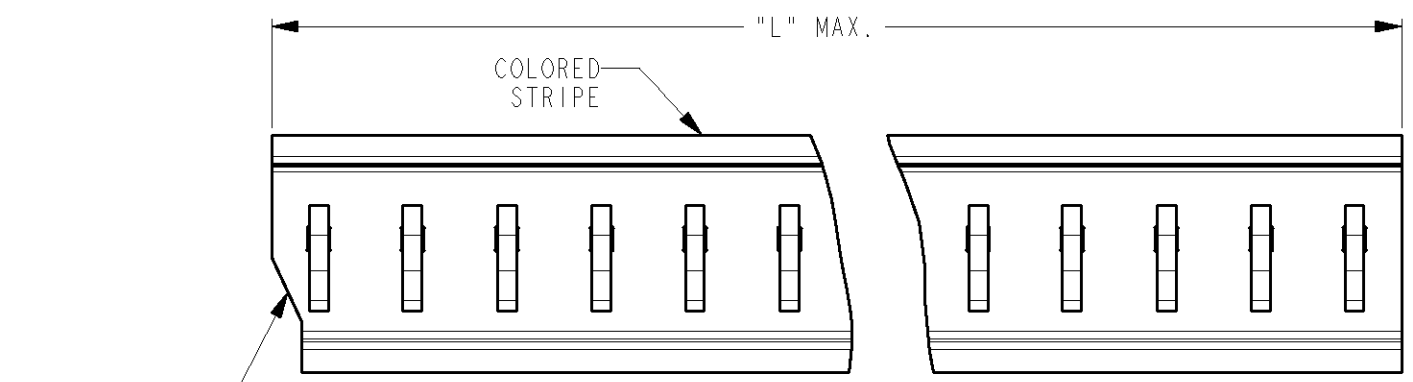

OPTIONAL

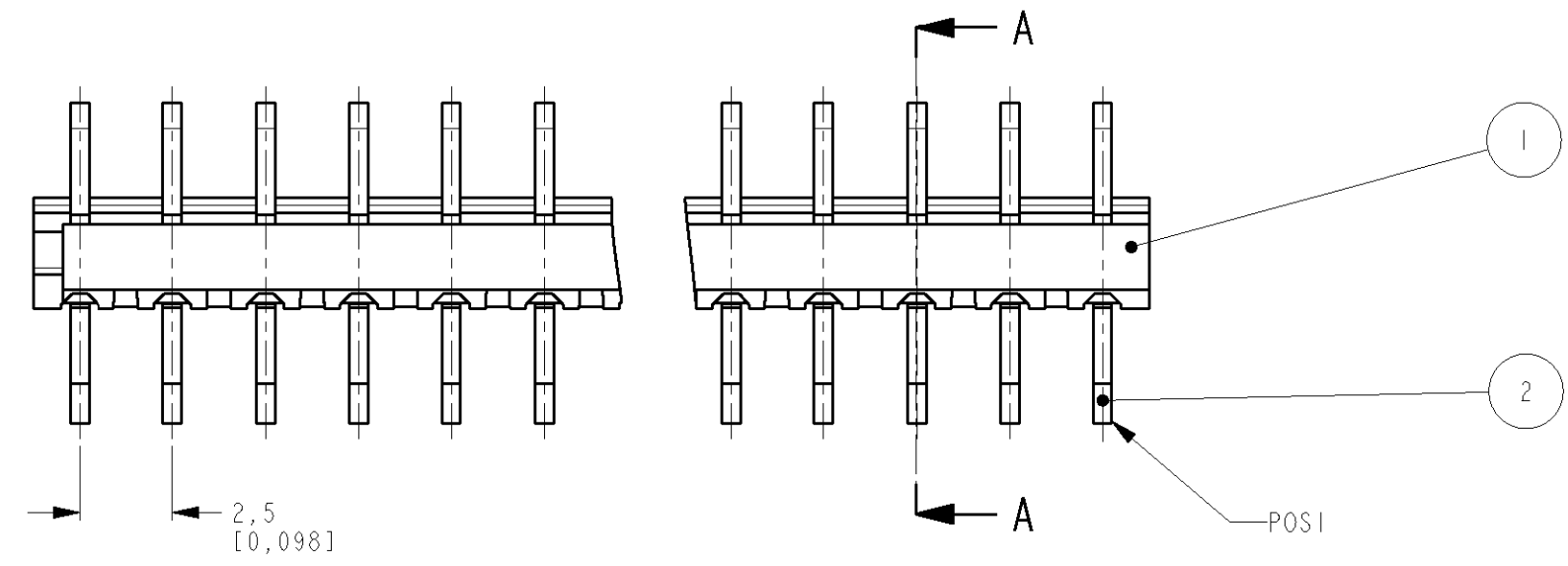

PARTNUMBER	POS	"L" MAX	
		MM	INCH
0-5161500-3	3	7.5	.295
0-5161500-4	4	10.0	.394
0-5161500-5	5	12.5	.492
0-5161500-6	6	15.0	.591
0-5161500-7	7	17.5	.689
0-5161500-8	8	20.0	.787
0-5161500-9	9	22.5	.886
1-5161500-0	10	25.0	.984
1-5161500-1	11	27.5	1.083
1-5161500-2	12	30.0	1.181
1-5161500-3	13	32.5	1.280
1-5161500-4	14	35.0	1.378
1-5161500-5	15	37.5	1.476
1-5161500-6	16	40.0	1.575
1-5161500-7	17	42.5	1.673
1-5161500-8	18	45.0	1.772
1-5161500-9	19	47.5	1.870
2-5161500-0	20	50.0	1.969

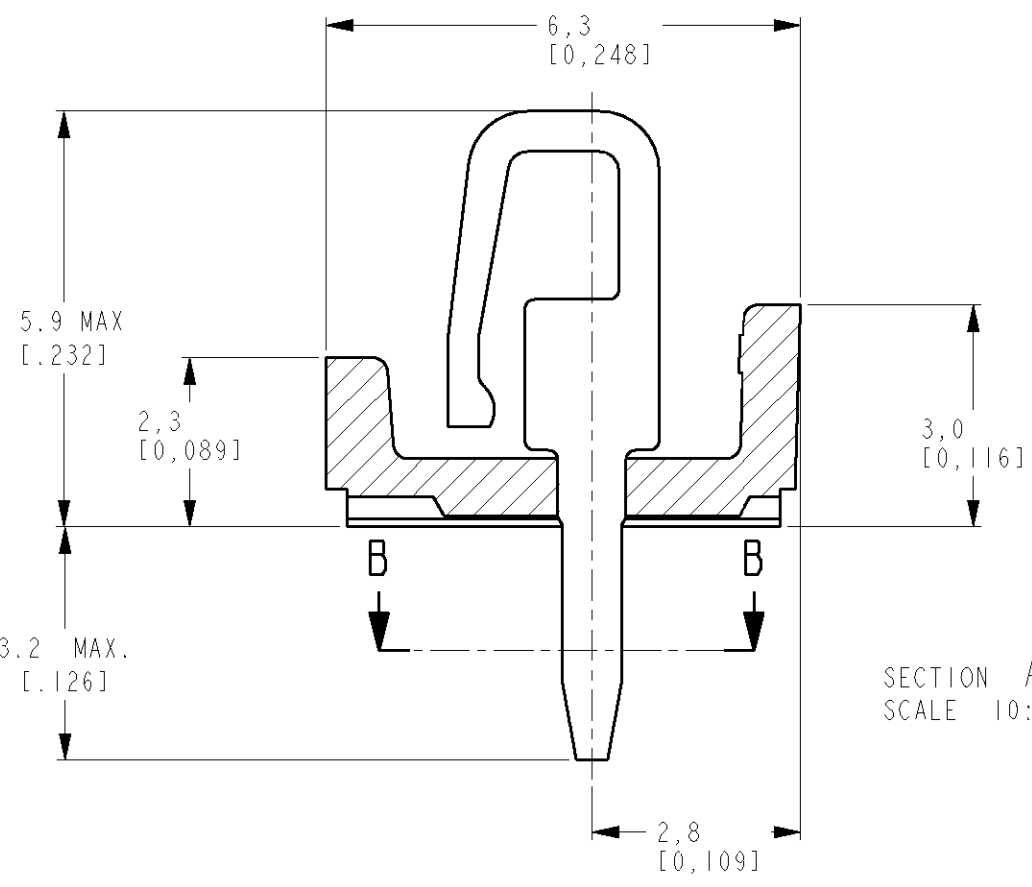

THIS DRAWING IS A CONTROLLED DOCUMENT FOR TYCO ELECTRONICS CORPORATION  
 IT IS SUBJECT TO CHANGE AND THE CONTROLLING ENGINEERING ORGANIZATION  
 SHOULD BE CONTACTED FOR THE LATEST REVISION.

DIMENSIONS: mm (inch)	TOLERANCES UNLESS OTHERWISE SPECIFIED:
	0 PLC ±
	1 PLC ±
	2 PLC ±
	3 PLC ±
	4 PLC ±
	ANGLES ±
MATERIAL	FINISH

2	CONTACT	PHOSPHORBRONZE	TIN OVER NICKEL
1	HOUSING	PBT 20% GF, COLOR GREEN	
ITEM NO.	DESCRIPTION	MATERIAL	FINISH
DWN	09 MAR 05	<b>tyco</b> TYCO ELECTRONICS NEDERLAND B.V.	
CHK	M. GOSSELINK	<b>Electronics</b> 's-HERTOGENBOSCH, THE NETHERLANDS	
APVD	F. IJLJENS	NAME	
PRODUCT SPEC	108-19027	MINI-MATCH CONNECTOR ASS'Y	
APPLICATION SPEC		3-20 POS 2.5 MM PITCH	
WEIGHT		SIZE	RESTRICTED TO
		A3	
CUSTOMER DRAWING		CAGE CODE	REV
		00779	A
		DRAWING NO	SCALE
		©-5161500	5:1
		SHEET	OF
		1	1