



Chipsmall Limited consists of a professional team with an average of over 10 year of expertise in the distribution of electronic components. Based in Hongkong, we have already established firm and mutual-benefit business relationships with customers from,Europe,America and south Asia,supplying obsolete and hard-to-find components to meet their specific needs.

With the principle of “Quality Parts,Customers Priority,Honest Operation,and Considerate Service”,our business mainly focus on the distribution of electronic components. Line cards we deal with include Microchip,ALPS,ROHM,Xilinx,Pulse,ON,Everlight and Freescale. Main products comprise IC,Modules,Potentiometer,IC Socket,Relay,Connector.Our parts cover such applications as commercial,industrial, and automotives areas.

We are looking forward to setting up business relationship with you and hope to provide you with the best service and solution. Let us make a better world for our industry!



## Contact us

Tel: +86-755-8981 8866 Fax: +86-755-8427 6832

Email & Skype: info@chipsmall.com Web: www.chipsmall.com

Address: A1208, Overseas Decoration Building, #122 Zhenhua RD., Futian, Shenzhen, China



REV. NO.		DATE		ZONE		LTY		REVISIONS		DATE	APP'D
00	00										
REVISED PER EC 0513-0486-03											

- △ HOUSING & TINE PLATE - LIQUID CRYSTAL POLYMER (LCP), UL 94V-0, BLACK.
- 2. CONNECTOR SOLDER TAILS WILL ACCOMMODATE PRINTED CIRCUIT BOARD THICKNESS OF 0.8 TO 1.6 [0.031 TO .063].
- △ G, J, H INDICATE NUMBER OF POSITION MARKED ON ASSEMBLY. ALSO SEE TABLE.
- △ THIS PART IS TUBF PACKAGED.
- △ CONTACTS - PHOSPHOR BRONZE PLATED WITH MINIMUM GOLD THICKNESS (SEE TABLE) IN CONTACT AREA AND 0.0038 [0.000150] MINIMUM THICK TIN LEAD ON SOLDER TINES OVER 0.00127 [0.000050] MINIMUM THICK NICKEL UNDERPLATE.
- △ RETENTION LEGS - BRASS PLATED WITH 0.0038 [0.000150] MINIMUM TIN OVER 0.00127 [0.000050] MINIMUM NICKEL UNDERPLATE.
- △ RETENTION LEGS - BRASS PLATED WITH 0.0038 [0.000150] MINIMUM TIN OVER 0.00127 [0.000050] MINIMUM NICKEL UNDERPLATE.

PRELIMINARY  
 -NOT RELEASED FOR PRODUCTION-

	△ △ △	86.13 [3.391]	82.33 [3.241]	83.27 [3.278]	60	120	61	0.00076 [0.000030]	5-575100-7
	△ △ △	41.68 [1.541]	37.88 [1.491]	38.82 [1.528]	25	50	26	0.00076 [0.000030]	5-557100-6
	△ △ △	35.33 [1.391]	31.53 [1.241]	32.47 [1.278]	20	40	21	0.00076 [0.000030]	5-557100-5
	△ △ △	86.13 [3.391]	82.33 [3.241]	83.27 [3.278]	60	120	61	0.00076 [0.000030]	5-557100-4 △
OB50LETE	△ △ △	124.23 [4.891]	120.43 [4.741]	121.37 [4.778]	90	180	91	0.00076 [0.000030]	5-557100-3
	△ △ △	98.83 [3.891]	95.03 [3.741]	95.97 [3.778]	70	140	71	0.00076 [0.000030]	4-557100-9
	△ △ △	135.93 [5.391]	133.13 [5.241]	134.07 [5.278]	100	200	101	0.00076 [0.000030]	4-557100-1
	△ △ △	111.53 [4.391]	107.73 [4.241]	108.67 [4.278]	80	160	81	0.00076 [0.000030]	3-557100-7
OB50LETE	△ △ △	92.48 [3.641]	88.68 [3.491]	89.62 [3.528]	65	130	66	0.00076 [0.000030]	3-557100-3
	△ △ △	86.13 [3.391]	82.33 [3.241]	83.27 [3.278]	60	120	61	0.00076 [0.000030]	2-557100-9
	△ △ △	73.43 [2.891]	69.63 [2.741]	70.57 [2.778]	50	100	51	0.00076 [0.000030]	2-557100-5
	△ △ △	60.73 [2.391]	56.93 [2.241]	57.87 [2.278]	40	80	41	0.00076 [0.000030]	2-557100-1
	△ △ △	53.11 [2.091]	49.31 [1.941]	50.25 [1.978]	34	68	35	0.00076 [0.000030]	1-557100-7
	△ △ △	48.03 [1.891]	44.23 [1.741]	45.17 [1.778]	30	60	31	0.00076 [0.000030]	1-557100-3
	△ △ △	41.68 [1.541]	37.88 [1.491]	38.82 [1.528]	25	50	26	0.00076 [0.000030]	557100-6
	△ △ △	35.33 [1.391]	31.53 [1.241]	32.47 [1.278]	20	40	21	0.00076 [0.000030]	557100-5
OB50LETE	△ △ △	28.98 [1.141]	25.18 [0.991]	26.12 [1.028]	15	30	16	0.00076 [0.000030]	557100-1
NOTES		C	B	A	6	J	H	GOLD	PART NO

DO NOT SCALE PRINT. UNLESS SPECIFIED DIMENSIONS IN mm (INCHES): TOLERANCES ON: 2 P.L. DEC ± - 3 P.L. DEC ± - ANGLES ± -	DR R-91-P9 A-10-1 CHC 10-3-89 N. JONES APP'D 12-4-88 T.P.PIZZOLO	AMP APP. INCORPORATED Newbury, Pa. 1765
MATERIAL SFF NOTES	APP'D 12-4-88 J.B. WILKINSON PRODUCT SPEC 108-136/7	NAME PLUG ASSEMBLY, RIGHT ANGLE, BOARD-TO-BOARD CHAMP™ .050, SERIES 1
FINISH SEE NOTES	APPLICATION SPEC 114-5045 WEIGHT -	SIZE D 00779 SCALE 4:1
		DRAWING NO 557100 SHEET 1 OF 3

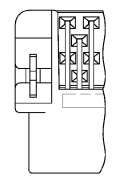

FOR 50, 130 POSITIONS ONLY

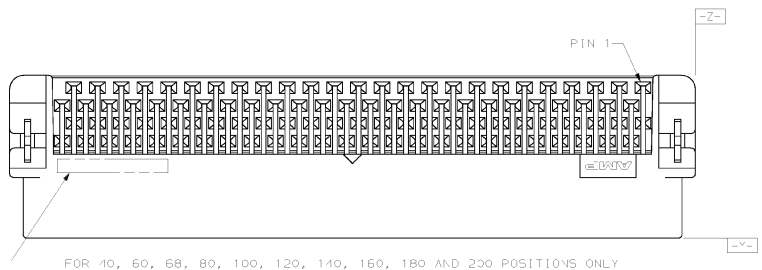

DATE CODE FOR 40, 60, 68, 80, 100, 120, 140, 160, 180 AND 200 POSITIONS ONLY

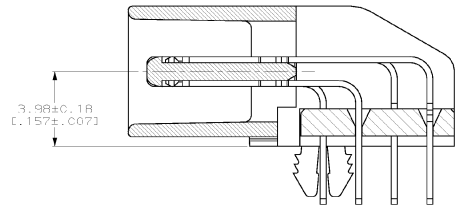
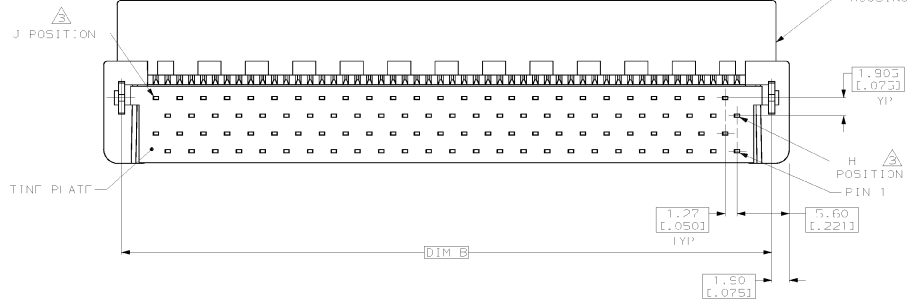
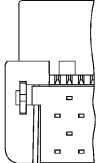
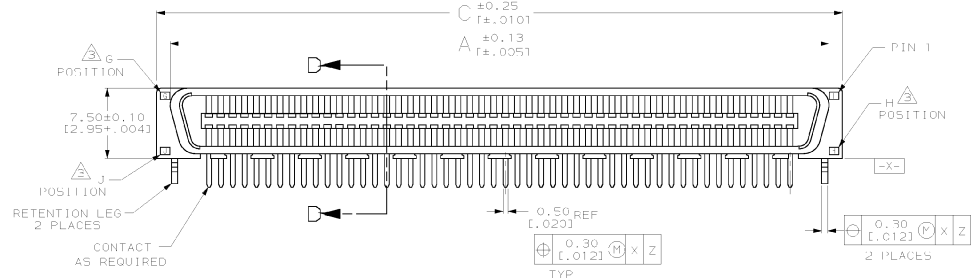

SECTION D-D  
SCALE 8:1

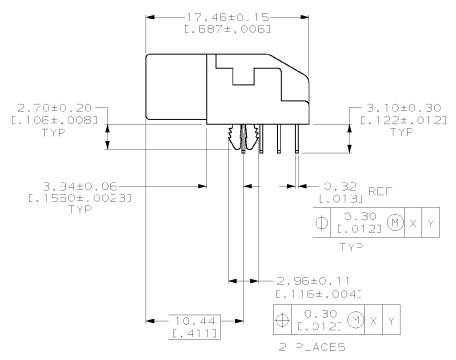

DESCRIPTION		PART NO	
DO NOT SCALE PRINT.	DR R-21-89 R. MARTIN	AMP INCORPORATED 1000 W. 10th St., MILWAUKEE, WI 53233	
DIMENSIONS IN mm (INCHES):	CHC 10-3-89 N. JONES		
TOLERANCES ON:	APP'D 12-4-88 T.P.PIZZOLO	NAME	PLUG ASSEMBLY, RIGHT ANGLE, BOARD-TO-BOARD CHAMP™ .050, SERIES 1
2 P.L.C. DEC ±			
3 P.L.C. DEC ±			
ANGLES ±			
MATERIAL	APP'D 12-4-88 J.B. WILKINSON	SIZE	CAGE CODE 00779
	PRODUCT SPEC		DRAWING NO 557100
FINISH	APPLICATION SPEC	SCALE	4:1
	WEIGHT		SHEET 2 OF 3

REV. NO.		REV. DATE		REVISIONS		DATE	APP'D
EW	00						
P	F	ZONE	LT	DESCRIPTION			
				(J) SEE SHEET 1			

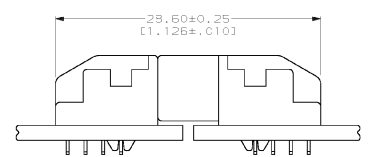
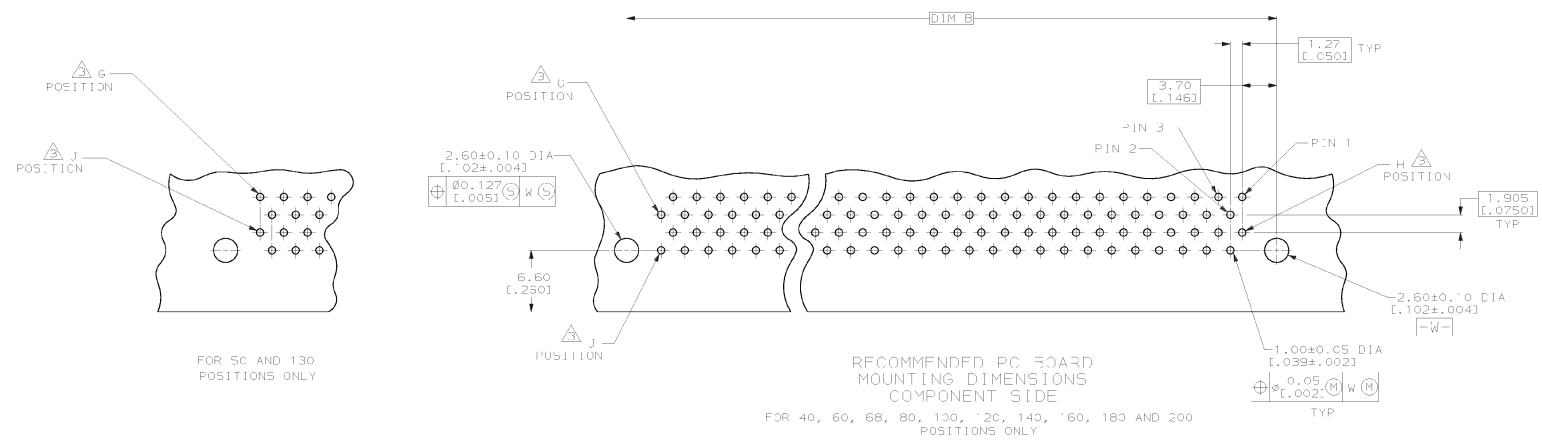

RIGHT ANGLE PLUG ASSEMBLY MATED TO RIGHT ANGLE RECEPTACLE ASSEMBLY

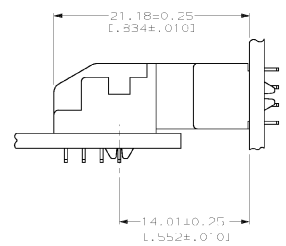

RIGHT ANGLE PLUG ASSEMBLY MATED TO VERTICAL RECEPTACLE ASSEMBLY

DO NOT SCALE PRINT. UNLESS SPECIFIED DIMENSIONS IN mm (INCHES): 2 P.L.C. DEC ± - 3 P.L.C. DEC ± - ANGLES ± -	DR R-21-PS R. MARTIN CHC 10-3-89 N. JONES APP'D 12-4-89 T. PIZZULO	AMP AMP INCORPORATED Merrillville, Pa. 15116	
MATERIAL -	AP'D 12-4-89 J. B. WILKINSON PRODUCT SPEC -	NAME PLUG ASSEMBLY, RIGHT ANGLE, BOARD-TO-BOARD CHAMP™ .050, SERIES 1	
FINISH -	APPLICATION SPEC -	SIZE D 00779	DRAWING NO 557100
WEIGHT -		SCALE 4:1	SHEET 3 OF 3