



Chipsmall Limited consists of a professional team with an average of over 10 year of expertise in the distribution of electronic components. Based in Hongkong, we have already established firm and mutual-benefit business relationships with customers from,Europe,America and south Asia,supplying obsolete and hard-to-find components to meet their specific needs.

With the principle of “Quality Parts,Customers Priority,Honest Operation,and Considerate Service”,our business mainly focus on the distribution of electronic components. Line cards we deal with include Microchip,ALPS,ROHM,Xilinx,Pulse,ON,Everlight and Freescale. Main products comprise IC,Modules,Potentiometer,IC Socket,Relay,Connector.Our parts cover such applications as commercial,industrial, and automotives areas.

We are looking forward to setting up business relationship with you and hope to provide you with the best service and solution. Let us make a better world for our industry!



Contact us

Tel: +86-755-8981 8866 Fax: +86-755-8427 6832

Email & Skype: info@chipsmall.com Web: www.chipsmall.com

Address: A1208, Overseas Decoration Building, #122 Zhenhua RD., Futian, Shenzhen, China



ELECTRICAL PROPERTIES	
CURRENT RATING	1 AMP
INSULATION RESISTANCE	>1 x 10 ⁹ OHMS @ 500 VDC
DWV	>500 VRMS AT SEA LEVEL
ENVIRONMENTAL PROPERTIES	
TEMPERATURE RATING	-55°C TO 125°C

- 1 20 POSITION ASSEMBLY SHOWN.
- 2 HOUSING AND COVER: GLASS REINFORCED POLYESTER, UL94V-0 RATED, COLOR BLUE. CONTACTS: BERYLLIUM COPPER.
- 3 CONTACTS: 0.00254[.000100] MIN TIN OVER 0.00127[.000050] MIN NICKEL.
- 4 COMPANY LOGO IN APPROXIMATE AREA SHOWN.

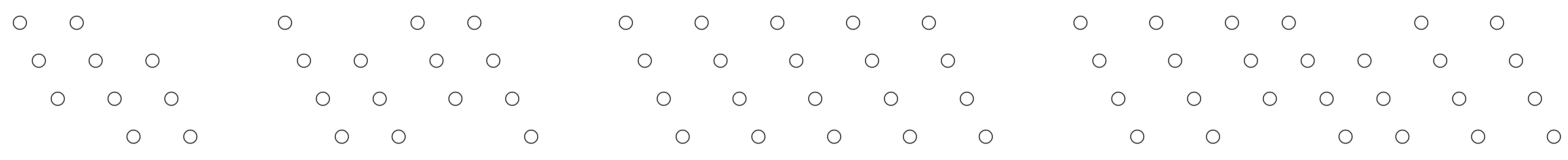
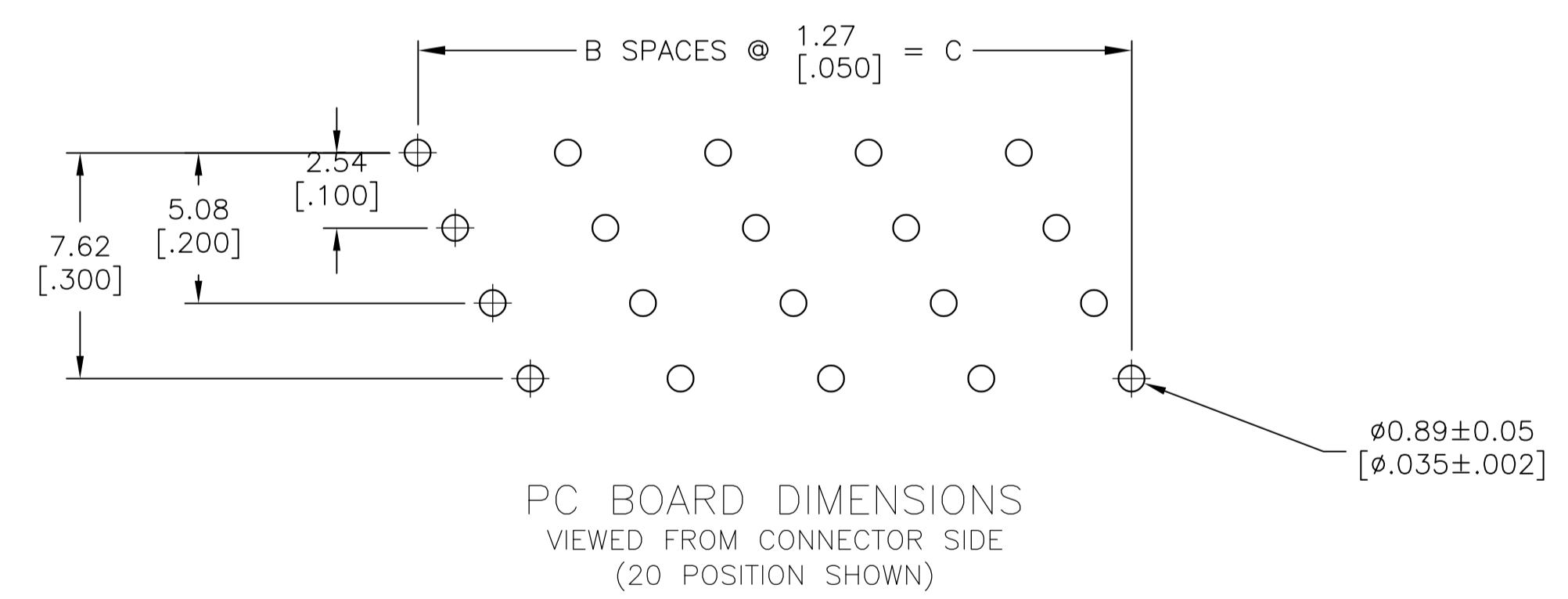
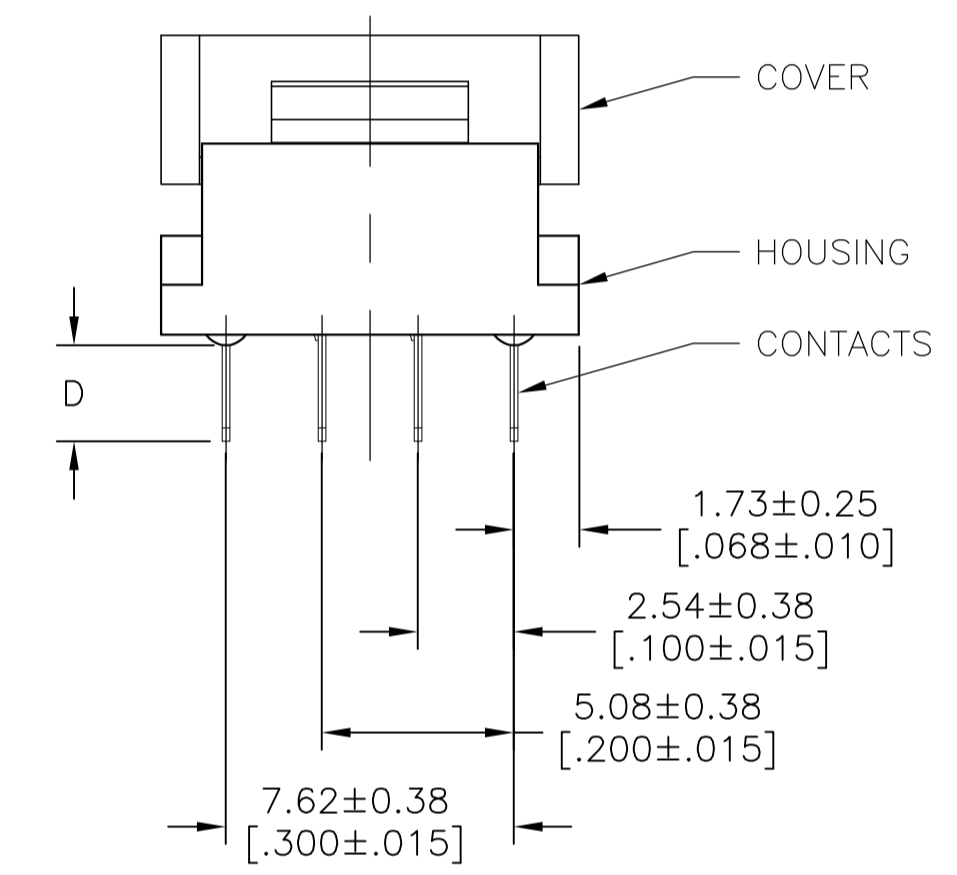
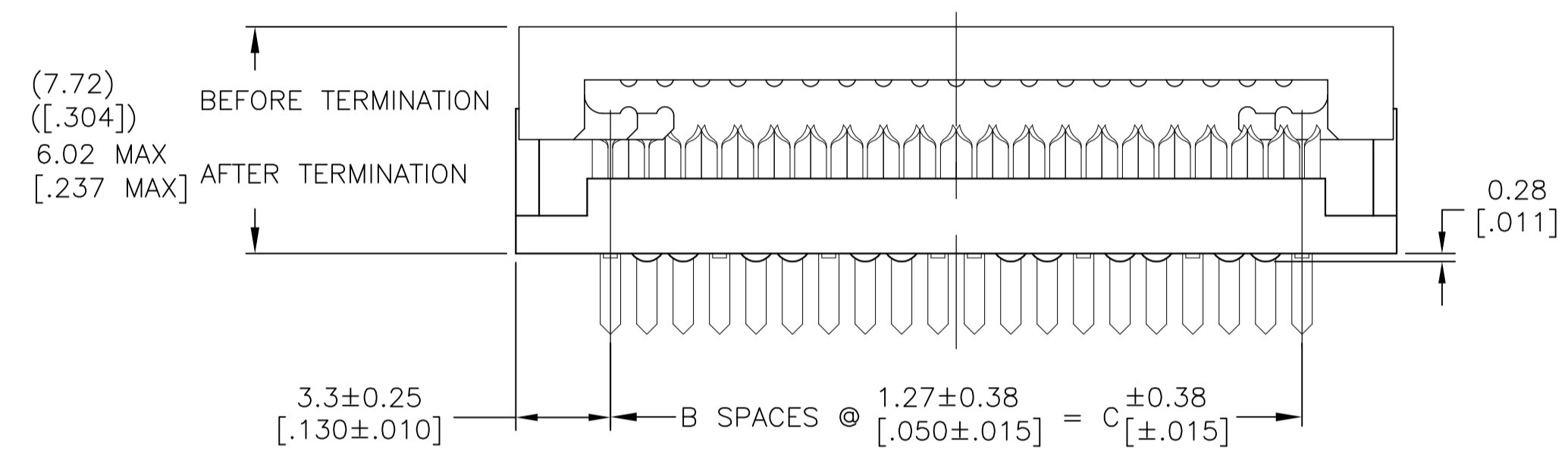
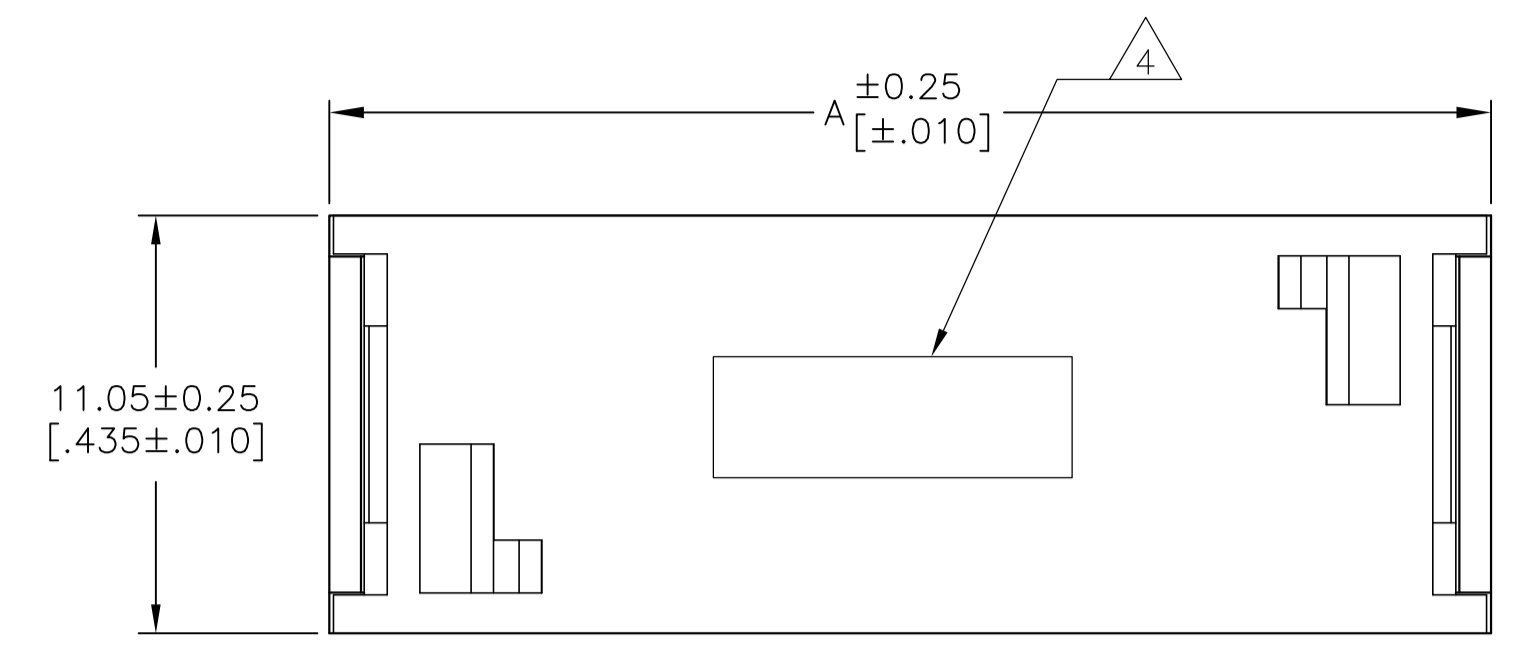

HOLE PATTERN FOR 10 POSITION CONNECTOR

HOLE PATTERN FOR 14 POSITION CONNECTOR

HOLE PATTERN FOR 16, 20, 40, 44, 56 & 60 POSITION CONNECTORS (20 POS CONNECTOR SHOWN)

HOLE PATTERN FOR 26, 34 & 50 POSITION CONNECTORS (26 POS CONNECTOR SHOWN)

OBSOLETE	2.54 .100	74.93 [2.950]	59	81.53 [3.210]	60	609-6003LF	3-6437006-6
	3.96 [.156]	62.23 [2.450]	49	68.83 [2.710]	50	609-5043LF	3-6437006-2
OBSOLETE	2.54 .100	62.23 [2.450]	49	68.83 [2.710]	50	609-5003LF	3-6437006-1
	2.54 .100	54.61 [2.150]	43	61.21 [2.410]	44	609-4403LF	2-6437006-9
	3.96 [.156]	49.53 [1.950]	39	56.13 [2.210]	40	609-4043LF	2-6437006-7
OBSOLETE	2.54 [.100]	49.53 [1.950]	39	56.13 [2.210]	40	609-4003LF	2-6437006-6
	3.96 [.156]	41.91 [1.650]	33	48.51 [1.910]	34	609-3443LF	2-6437006-3
	2.54 [.100]	41.91 [1.650]	33	48.51 [1.910]	34	609-3403LF	2-6437006-2
	3.96 [.156]	31.75 [1.250]	25	38.35 [1.510]	26	609-2643LF	2-6437006-0
	2.54 [.100]	31.75 [1.250]	25	38.35 [1.510]	26	609-2603LF	1-6437006-8
	3.96 [.156]	24.13 [.950]	19	30.73 [1.210]	20	609-2043LF	1-6437006-5
OBSOLETE	2.54 [.100]	24.13 [.950]	19	30.73 [1.210]	20	609-2003LF	1-6437006-4
OBSOLETE	3.96 [.156]	19.05 [.750]	15	25.65 [1.010]	16	609-1643LF	1-6437006-2
	2.54 [.100]	19.05 [.750]	15	25.65 [1.010]	16	609-1603LF	1-6437006-1
	3.96 [.156]	16.51 [.650]	13	23.11 [.910]	14	609-1443LF	6437006-9
	2.54 [.100]	16.51 [.650]	13	23.11 [.910]	14	609-1403LF	6437006-8
OBSOLETE	3.96 [.156]	11.43 [.450]	9	18.03 [.710]	10	609-1043LF	6437006-6
	2.54 [.100]	11.43 [.450]	9	18.03 [.710]	10	609-1003LF	6437006-5
	D	C	B	A	NUMBER OF POSITIONS	T&B PART NO (REF)	PART NUMBER

THIS DRAWING IS A CONTROLLED DOCUMENT.

DIMENSIONS: mm [INCHES]	TOLERANCES UNLESS OTHERWISE SPECIFIED:	DIN J. GERACE 07FEB06	STE TE Connectivity
0 PLC ± -	1 PLC ± -	CIK C. ROHDE 07FEB06	
2 PLC ± ± 0.13[.005]	3 PLC ± ± -	APPD M. WALMSLEY 07FEB06	
4 PLC ± ± -	ANGLES ± ± -	NAME	
MATERIAL	FINISH	APPLICATION SPEC	PCB TRANSITION CONNECTOR ASSY
		SIZE	SIZE CASE CODE DRAWING NO
		WEIGHT	A1 00779C=6437006-5
		CUSTOMER DRAWING	SCALE 5:1 SHEET 1 OF 1 REV B1