



Chipsmall Limited consists of a professional team with an average of over 10 year of expertise in the distribution of electronic components. Based in Hongkong, we have already established firm and mutual-benefit business relationships with customers from,Europe,America and south Asia,supplying obsolete and hard-to-find components to meet their specific needs.

With the principle of “Quality Parts,Customers Priority,Honest Operation,and Considerate Service”,our business mainly focus on the distribution of electronic components. Line cards we deal with include Microchip,ALPS,ROHM,Xilinx,Pulse,ON,Everlight and Freescale. Main products comprise IC,Modules,Potentiometer,IC Socket,Relay,Connector.Our parts cover such applications as commercial,industrial, and automotives areas.

We are looking forward to setting up business relationship with you and hope to provide you with the best service and solution. Let us make a better world for our industry!



## Contact us

Tel: +86-755-8981 8866 Fax: +86-755-8427 6832

Email & Skype: info@chipsmall.com Web: www.chipsmall.com

Address: A1208, Overseas Decoration Building, #122 Zhenhua RD., Futian, Shenzhen, China



OPTION CODE -1\*

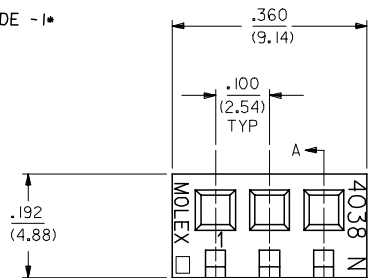

CKT NO 1

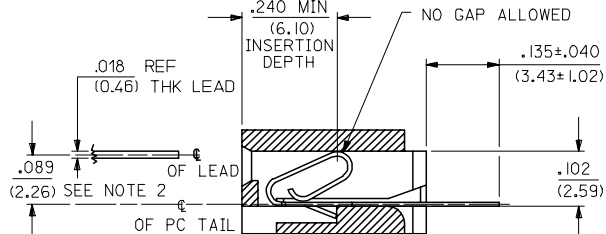
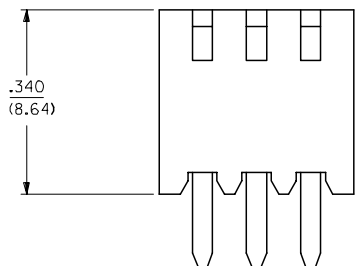

SECTION A-A

NOTES:

1. MATERIAL: GLASS FILLED POLYESTER 94V-0 COLER WHITE.
2. PLATINGS:  
P909 - HOT TIN DIP: .000100/(0.00254) MIN.  
\* THE PRIMARY SHIPPING CARTON WILL BE LABELED "COMPLIANT TO RoHS DIRECTIVE 2002/95/EC AND ELV ANNEX II OF DIRECTIVE 2000/53/EC". CARTONS WITHOUT THIS LABEL MAY CONTAIN PRODUCT WITH TIN/LEAD PLATING.
3. PRODUCT SPECIFICATION: NONE
4. PACKAGING: BULK
5. TERMINAL TO HOUSING RETENTION FORCE: 3 LBS. MIN.
6. CONNECTORS ARE NOT STACKABLE ON .100/(2.54) CENTERS.
7. TERMINALS CONFORM TO SOLDERABILITY SPECIFICATION SMES-152.
8. .085/(2.16) DIM. WILL VARY DEPENDING ON LEAD THICKNESS.

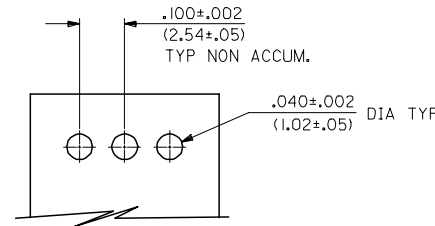

RECOMMENDED PC BOARD LAYOUT

OPTION CODE -2\*

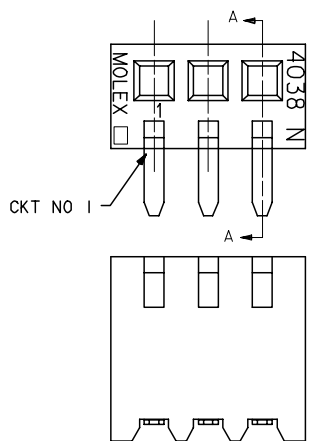

CKT NO 1

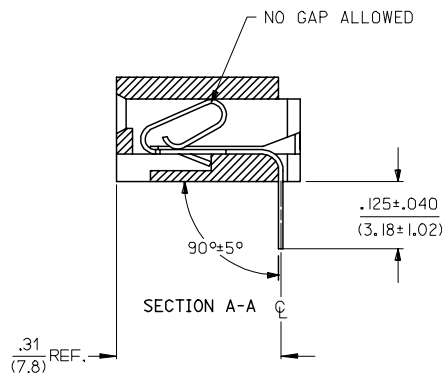

SECTION A-A

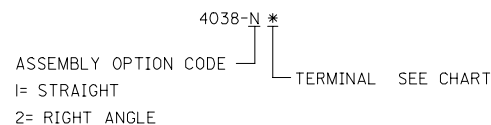

2	D
1	D1
SHT. REV.	

ADD DIMENSION EC NO: UCP2007-0731 DRAWN/PR/DER 2006/09/29 CHKD:ADERR 2006/10/03 APPR:FSM TH 2006/10/17 D1	QUALITY SYMBOLS ▽=0 ▽=0	GENERAL TOLERANCES (UNLESS SPECIFIED)		DIMENSION STYLE IN/MM		SCALE 1:1	DESIGN UNITS INCH	THIRD ANGLE PROJECTION		
		4 PLACES ± --- ± ---	mm	INCH	DRAWN BY SAMIEC	DATE 1992/01/10	TITLE TRANSISTOR SOCKET ASSY 4038 SERIES DWG.			
		3 PLACES ± --- ± .010			CHECKED BY PATEL	DATE 1992/01/10	MOLEX INCORPORATED			
		2 PLACES ± 0.25 ± .014			APPROVED BY LENZ	DATE 1992/01/10	MATERIAL NO. SDA-4038			
DRAFT WHERE APPLICABLE MUST REMAIN WITHIN DIMENSIONS		ANGULAR ±1/2°		SEE CHART		DOCUMENT NO.		SHEET NO. 1 OF 2		
THIS DRAWING CONTAINS INFORMATION THAT IS PROPRIETARY TO MOLEX INCORPORATED AND SHOULD NOT BE USED WITHOUT WRITTEN PERMISSION										

