



Chipsmall Limited consists of a professional team with an average of over 10 year of expertise in the distribution of electronic components. Based in Hongkong, we have already established firm and mutual-benefit business relationships with customers from,Europe,America and south Asia,supplying obsolete and hard-to-find components to meet their specific needs.

With the principle of “Quality Parts,Customers Priority,Honest Operation,and Considerate Service”,our business mainly focus on the distribution of electronic components. Line cards we deal with include Microchip,ALPS,ROHM,Xilinx,Pulse,ON,Everlight and Freescale. Main products comprise IC,Modules,Potentiometer,IC Socket,Relay,Connector.Our parts cover such applications as commercial,industrial, and automotives areas.

We are looking forward to setting up business relationship with you and hope to provide you with the best service and solution. Let us make a better world for our industry!



Contact us

Tel: +86-755-8981 8866 Fax: +86-755-8427 6832

Email & Skype: info@chipsmall.com Web: www.chipsmall.com

Address: A1208, Overseas Decoration Building, #122 Zhenhua RD., Futian, Shenzhen, China



REV. PA5	SHEET 1 OF 6	DOCUMENT NO. 10-643579
REVISIONS		
LTR	DESCRIPTION	DATE
PA3	CHANGES TO TABLE/PART OPTIONS	03-17-11
PA4	UPDATES TO SCREW OPTIONS	07/01/11
PA5	UPDATES TO SCREW OPTIONS	10/24/11

DOCUMENT NO. 10-643579
SHEET 1 OF 6
REV. PA5

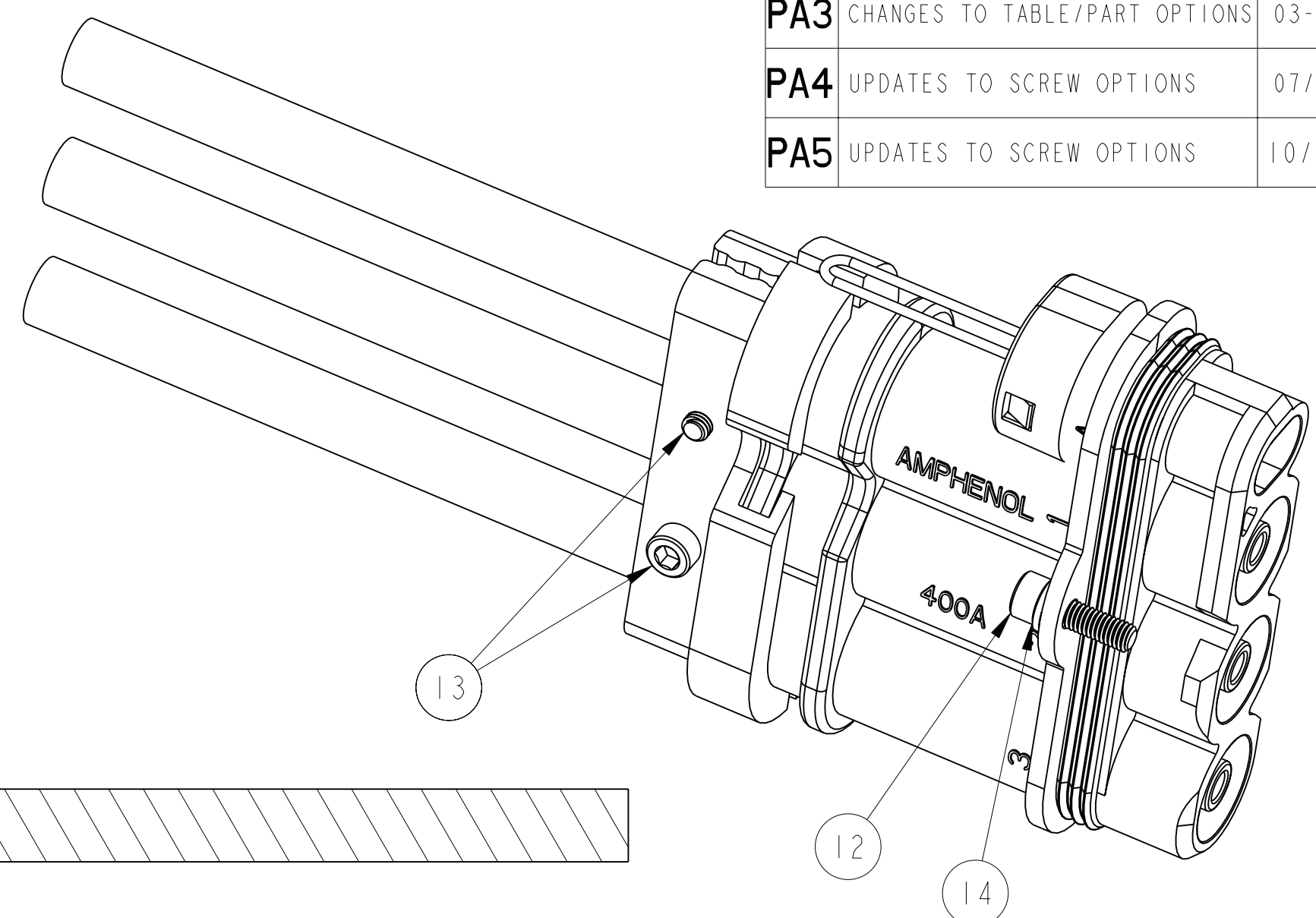
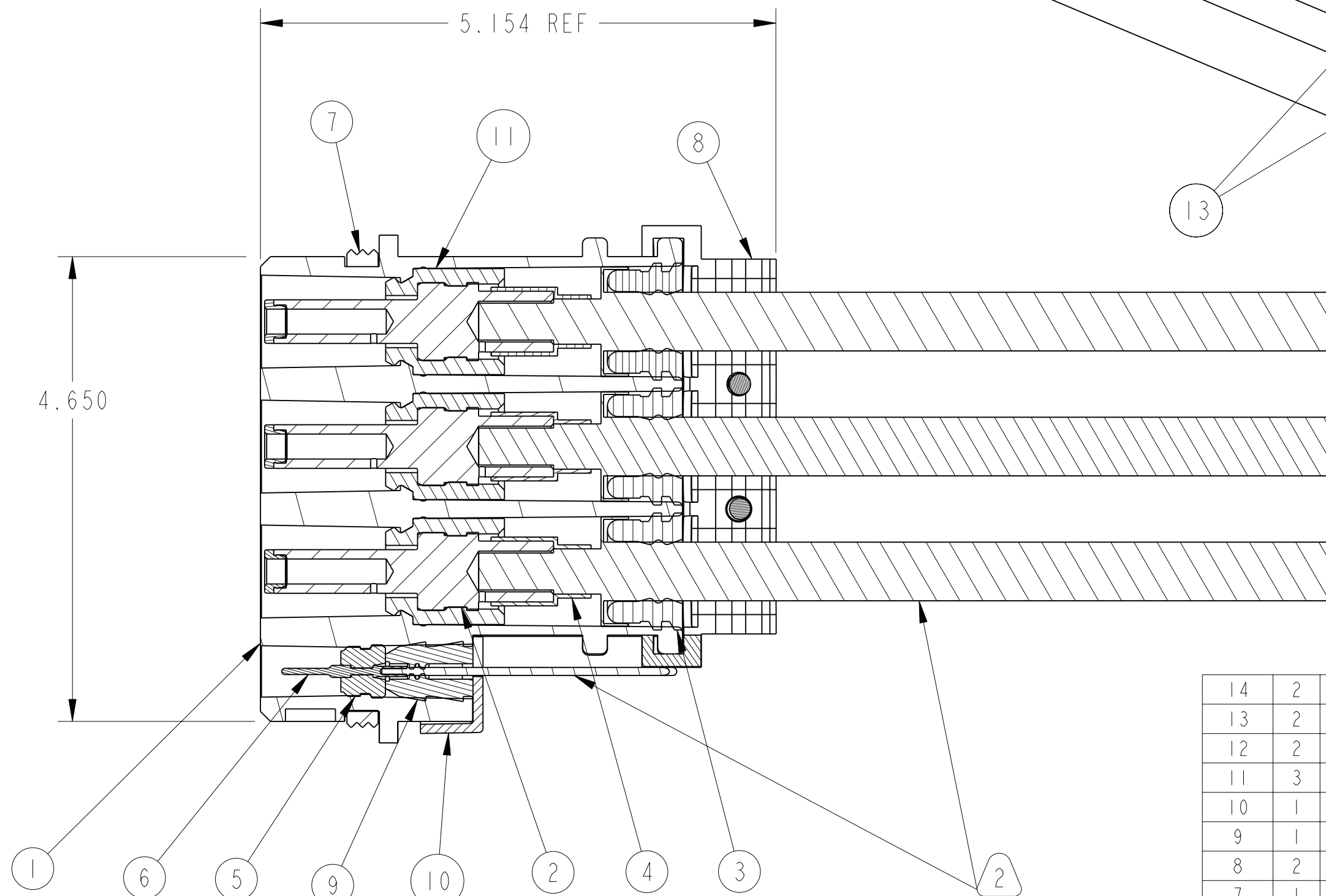
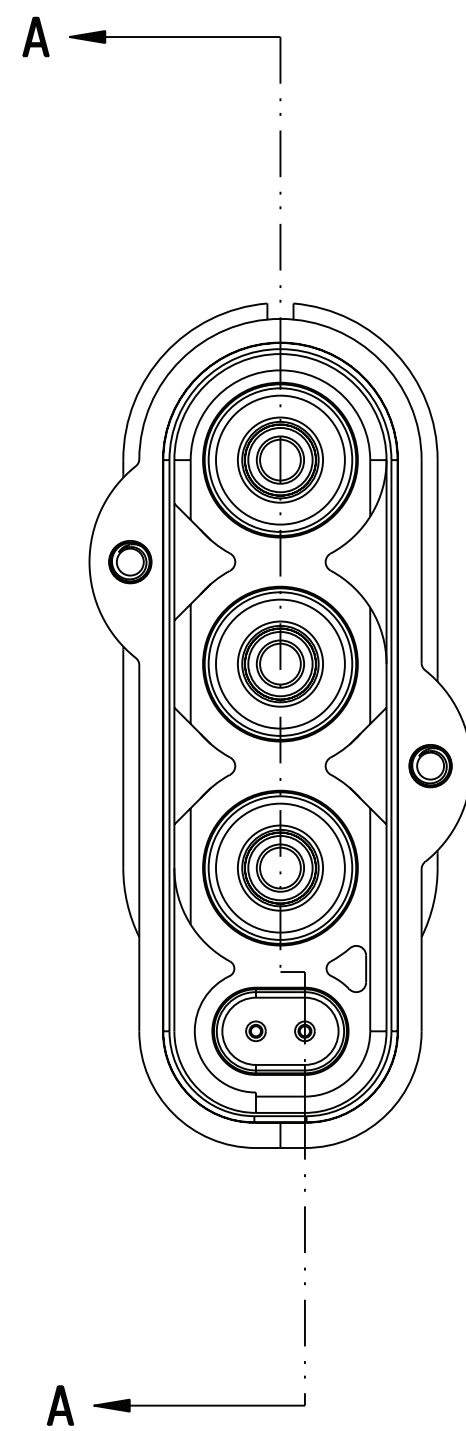

POS	QTY	PART NUMBER	DESCRIPTION	NOTE
14	2	10-643751-000	LOCK WASHER - M6	
13	2	10-643752-002	SCREW M6x1 - 30mm LONG	
12	2	10-643758-002	SCREW M6x1 - 20mm LONG	
11	3	10-643730-000	11.1mm PIN INSULATION	
10	1	10-643757-000	SIGNAL GROMMET COVER	
9	1	10-643754-000	SIGNAL GROMMET	
8	2	SEE TABLE	CABLE CLAMP	1
7	1	10-643742-000	BARREL SEAL	
6	2	10-040557-000	SIGNAL CONTACT, SIZE 16	
5	1	10-643738-000	SIGNAL CONTACT INSERT	
4	SEE NOTE 3	SEE TABLE	HEAT SHRINK TUBING	1/3
3	3	SEE TABLE	POWER CABLE GROMMET	1
2	3	SEE TABLE	11.1mm PIN CONTACT ASSM	1
1	1	SEE TABLE	PLUG SHELL	1

- NOTES:
- SHRINK TUBE (ITEM #4) TO BE CUT TO (3) 1.00" LENGTHS. TOTAL LENGTH USED PER ASSEMBLY IS 3.00" OR .25FT
 - WIRE TO BE PROVIDED BY CUSTOMER.
 - SEE PAGE 3 FOR PLUG ASSEMBLY OPTIONS AND PART NUMBER VARIATIONS.

THE USE OF THIS DOCUMENT IS UNLIMITED. HOWEVER, DOCUMENTS REFERENCED HEREON MAY CONTAIN LIMITED RIGHTS DATA.

UNLESS OTHERWISE SPECIFIED
 LINEAR DIMENSIONS ARE IN INCHES
 TOLERANCES:
 .XXXX = ±.0005 ANGLES= ±2°
 .XXX = ±.010
 .XX = ±.03
 .X = ±.1
 DIM. & TOL. PER ASME Y14.5M;
 DRM PER MIL-DTL-31000;
 OTHER Amphenol Sds. PER 9-3800
 LEGENDS:
 = FLAG NOTE CALL OUT REFERENCE ONLY

SPECIFICATIONS	APPROVALS	DATE
MATERIAL SPEC. N/A	PREPARED BY R. BALDWIN ENGINEER IN CHARGE A. POLISHAK DESIGN MANAGER S. FITZGERALD DESIGN ACTIVITY GROUP C & I	03-17-11
PROCESS SPEC. N/A	THIRD ANGLE PROJECTION	

PARTS LIST

AMPHENOL CORPORATION
 40-60 DELAWARE AVENUE
 SIDNEY, N.Y. 13838

PLUG ASSEMBLY
 400A - ePower
 3-PIN

SIZE C	CAGE CODE 77820	DOCUMENT NO. 10-643579	REV. PA5
SCALE: 0.9 REF:			SHEET 1 OF 6

N/A	PRO/ENGINEER INFORMATION
N/A	Pro/e Model Used: 10-643579.ASSEM
NEXT ASSEMBLY	Drawing Name: 10-643579

FORMAT: C-U-L-E-REV-B

DOCUMENT NO. 10-643579
SHEET 1 OF 6
REV. PA5

4

3

2

DOCUMENT NO. 10-643579
 SHEET 2 OF 6
 REV. PA5

D

C

B

A

DOCUMENT NO. 10-643579
 SHEET 2 OF 6
 REV. PA5

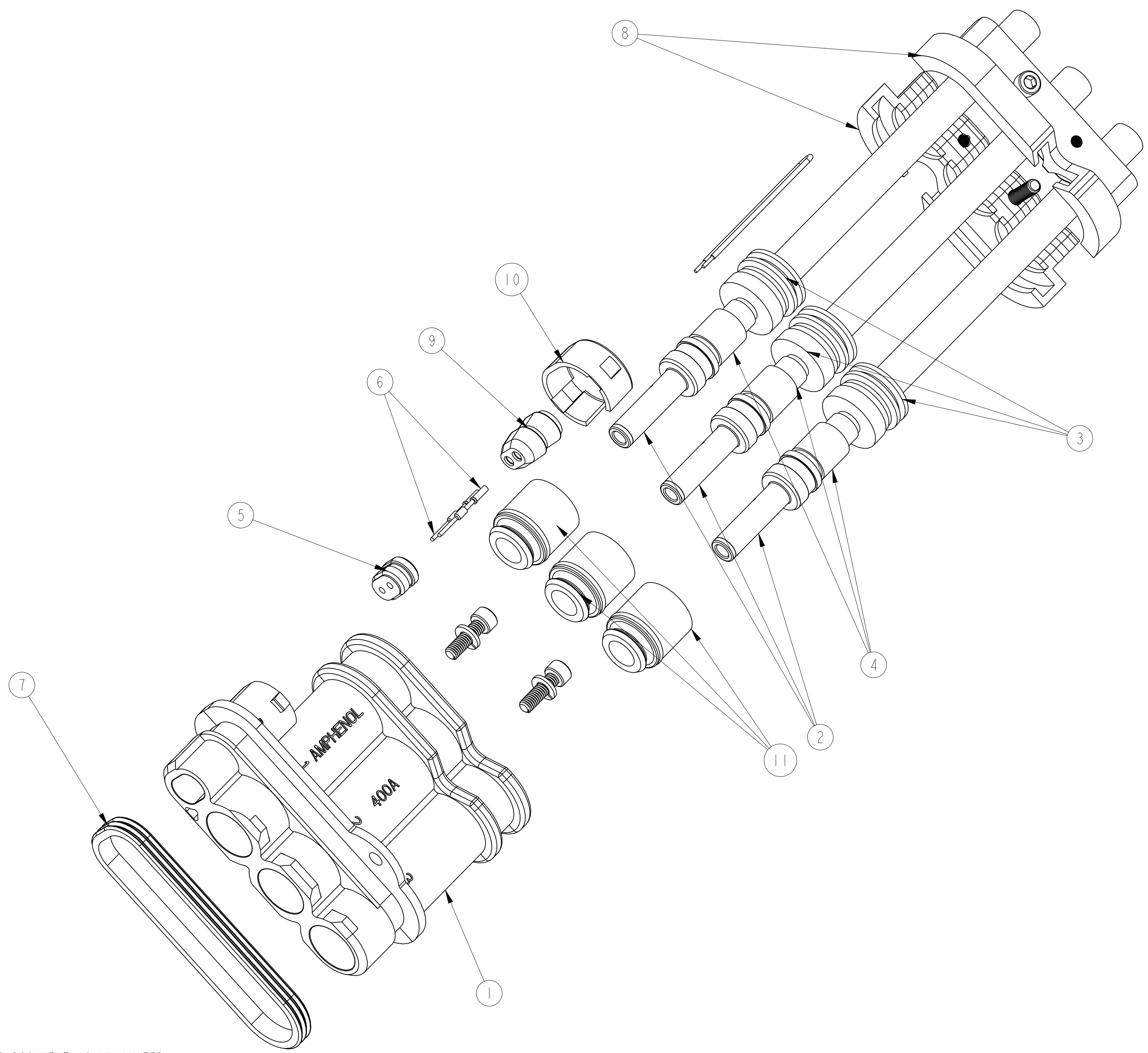

THE USE OF THIS DOCUMENT IS UNLIMITED.
 HOWEVER, DOCUMENTS REFERENCED HEREON
 MAY CONTAIN LIMITED RIGHTS DATA.

SIZE C	CAGE CODE 77820	DOCUMENT NO. 10-643579	REV. PA5
SCALE: 0.8		REF:	SHEET 2 OF 6

3

2

1

KEY CODING TABLE

WIRE SIZE CODING TABLE

KEY CODING	KEY POSITION			ITEM #1 * See Finish Coding
	1	2	3	
1	NO KEY WAY	NO KEY WAY	NO KEY WAY	10-643823-01(*)
2	KEY WAY	NO KEY WAY	NO KEY WAY	10-643823-02(*)
3	KEY WAY	KEY WAY	NO KEY WAY	10-643823-03(*)
4	KEY WAY	KEY WAY	KEY WAY	10-643823-04(*)
5	NO KEY WAY	KEY WAY	NO KEY WAY	10-643823-05(*)
6	NO KEY WAY	KEY WAY	KEY WAY	10-643823-06(*)
7	NO KEY WAY	NO KEY WAY	KEY WAY	10-643823-07(*)
8	KEY WAY	NO KEY WAY	KEY WAY	10-643823-08(*)

WIRE CODING	WIRE SIZE	ITEM #2	ITEM #3	ITEM #4	ITEM #8 * See Finish Coding
2	70mm ²	10-643728-002	10-643729-002	10-643675-007	10-643753-20(*)
3	95mm ²	10-643728-003	10-643729-003	10-643675-008	10-643753-30(*)

CODE LOGIC

10-643579-() () ()

BASE NUMBER

FINISH CODING:
 (I) Electroless Nickel Plate
 (FG) Bright Tin Over Electroless Nickel
 (B) No Plating

KEY CODING:
See Table

WIRE SIZE CODING:
See Table

THE USE OF THIS DOCUMENT IS UNLIMITED. HOWEVER, DOCUMENTS REFERENCED HEREON MAY CONTAIN LIMITED RIGHTS DATA.

SIZE C	CAGE CODE 77820	DOCUMENT NO. 10-643579	REV. PA5
SCALE: 0.9		REF:	SHEET 3 OF 6

DOCUMENT NO. 10-643579

SHEET 3 OF 6

REV. PA5

C

B

A

FORMAT: C-U-L-E-REV-B

D

C

REV. PA5

SHEET 3 OF 6

DOCUMENT NO. 10-643579

A

10-643579

SHEET 4 OF 6

REV PA5

C

B

A

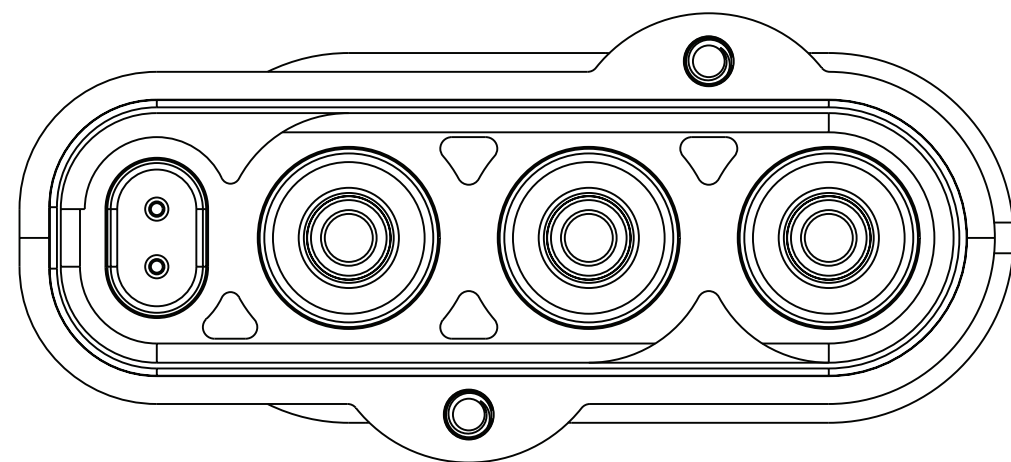

KEY OPTION 1
NO KEYWAYS OPEN

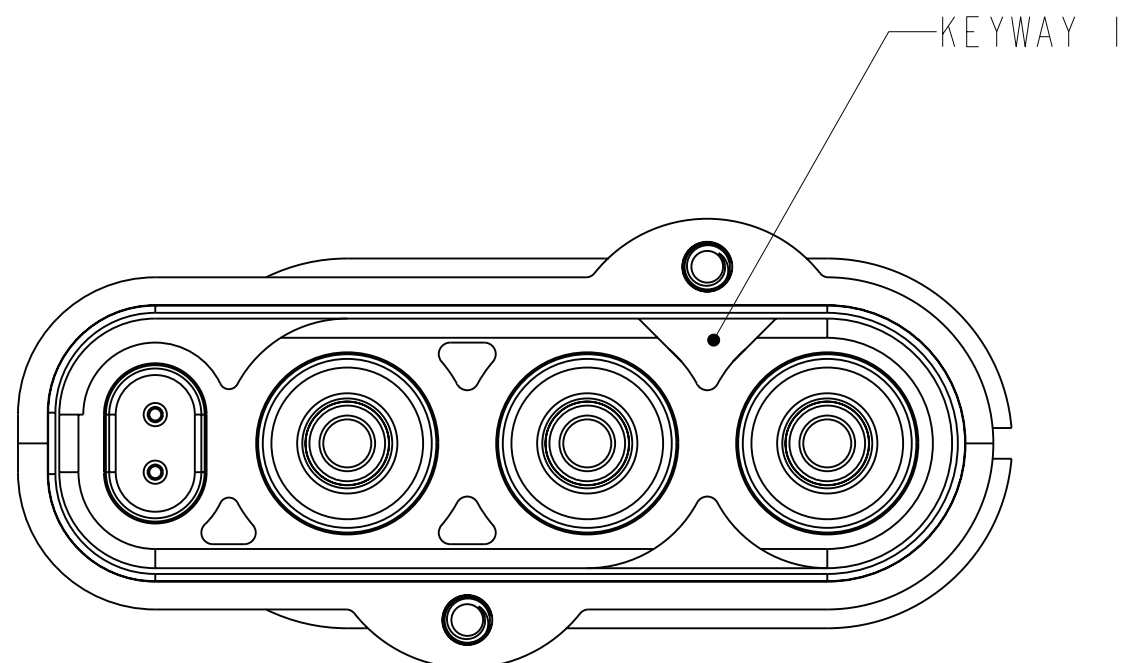

KEY OPTION 2
KEYWAY 1 OPEN

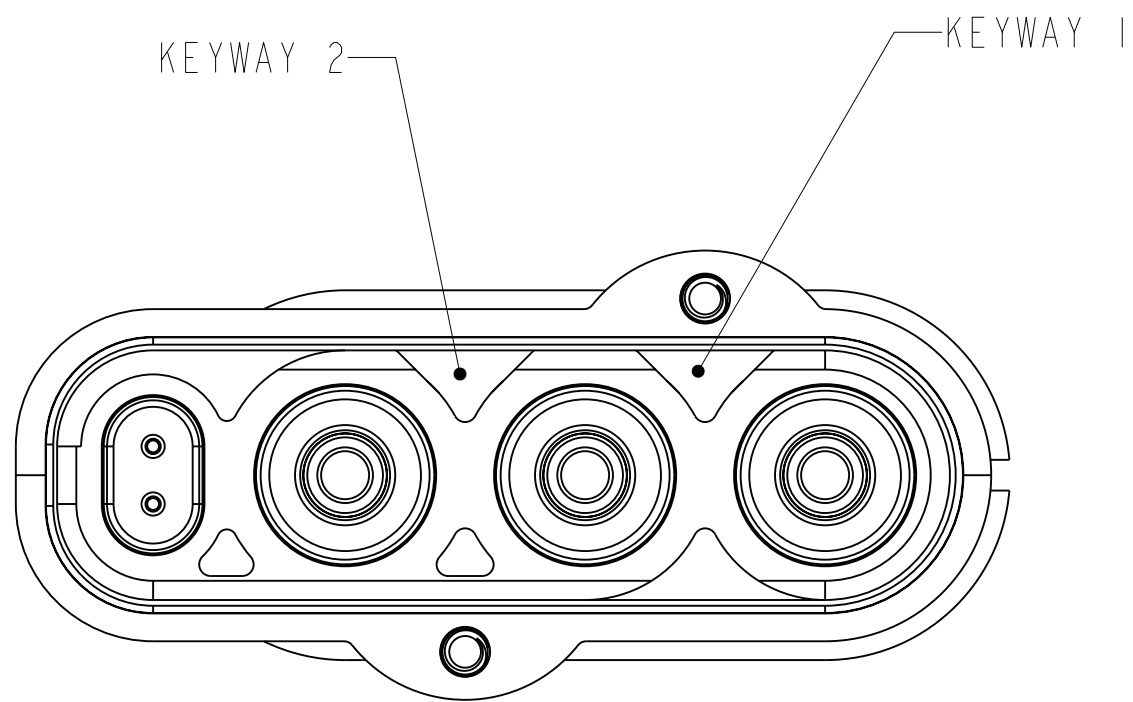

KEY OPTION 3
KEYWAYS 1 AND 2 OPEN

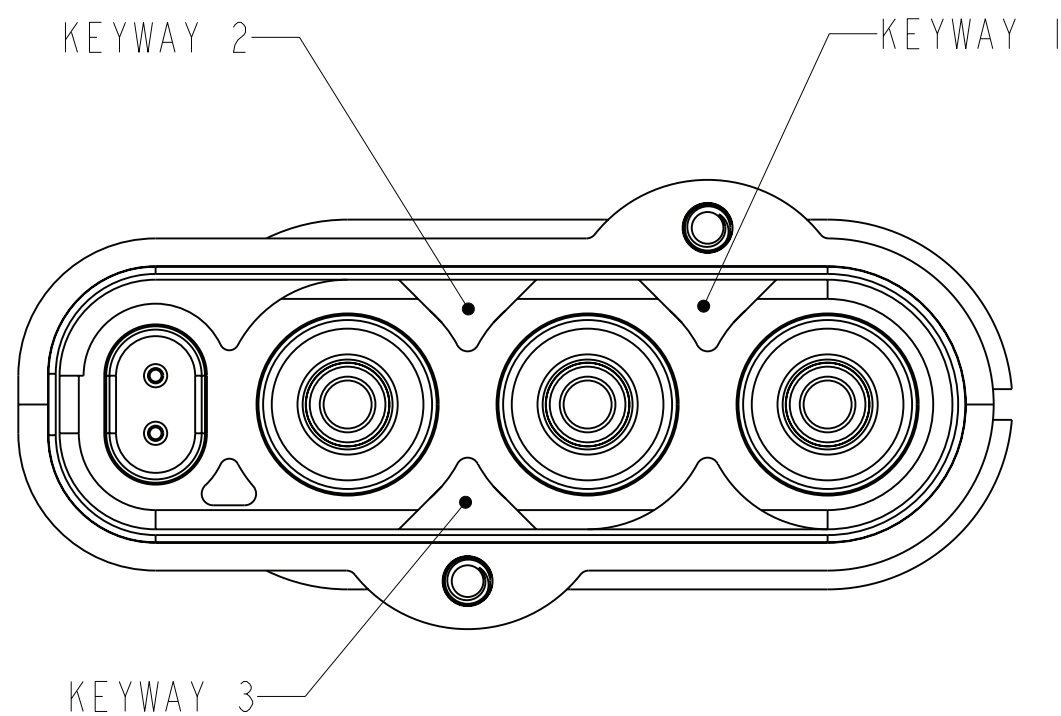

KEY OPTION 4
KEYWAYS 1, 2, AND 3 OPEN

D

C

B

A

REV PA5

SHEET 4 OF 6

10-643579

THE USE OF THIS DOCUMENT IS UNLIMITED.
HOWEVER, DOCUMENTS REFERENCED HEREON
MAY CONTAIN LIMITED RIGHTS DATA.

SIZE C	CAGE CODE 77820	DOCUMENT NO. 10-643579	REV. PA5
SCALE: 0.9	REF:	SHEET 4 OF 6	

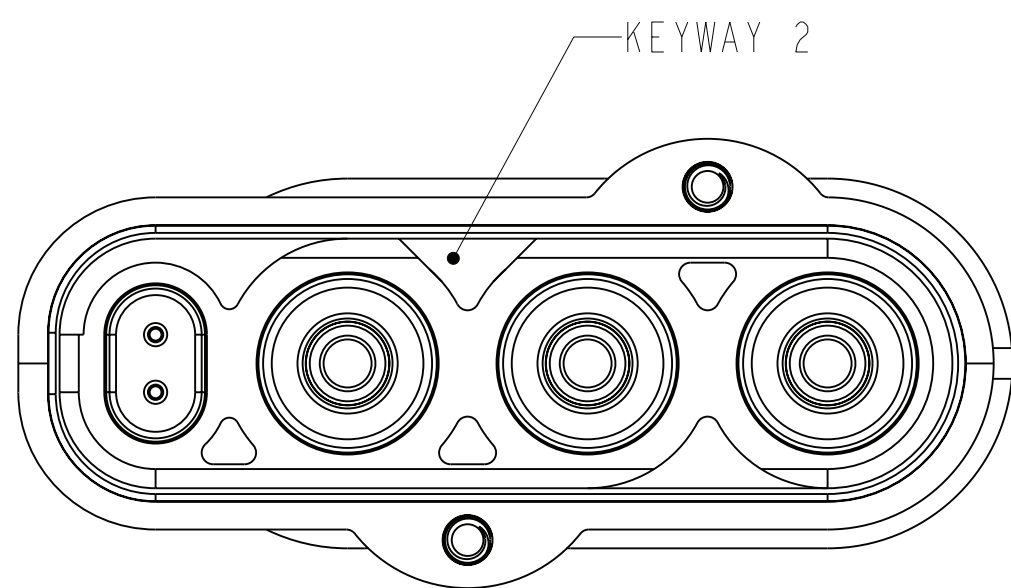

KEY OPTION 5
KEYWAY 2 OPEN

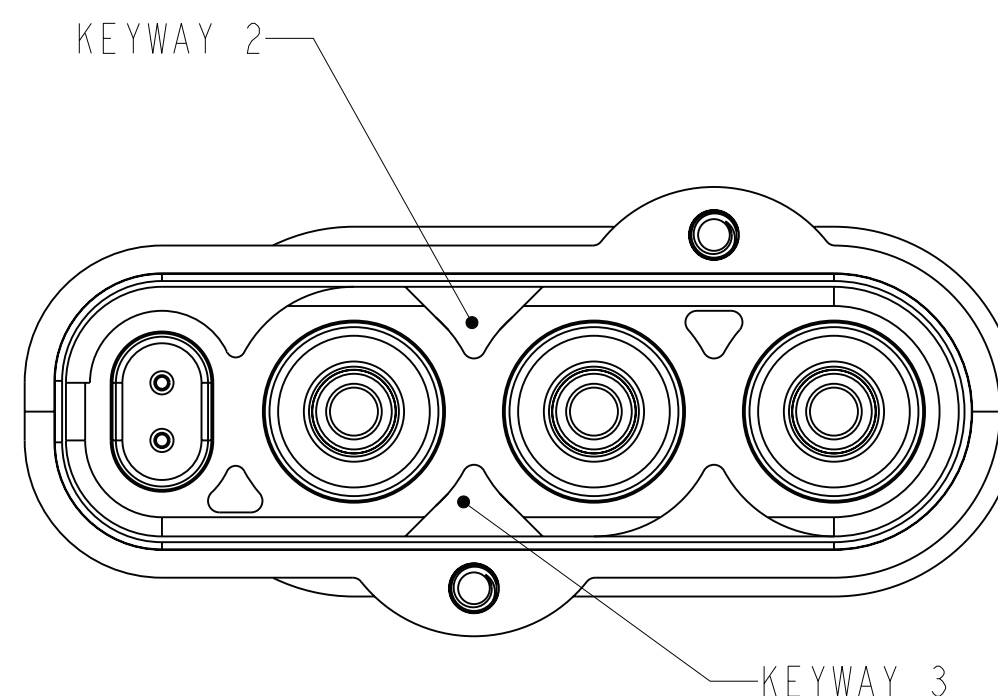

KEY OPTION 6
KEYWAYS 2 AND 3 OPEN

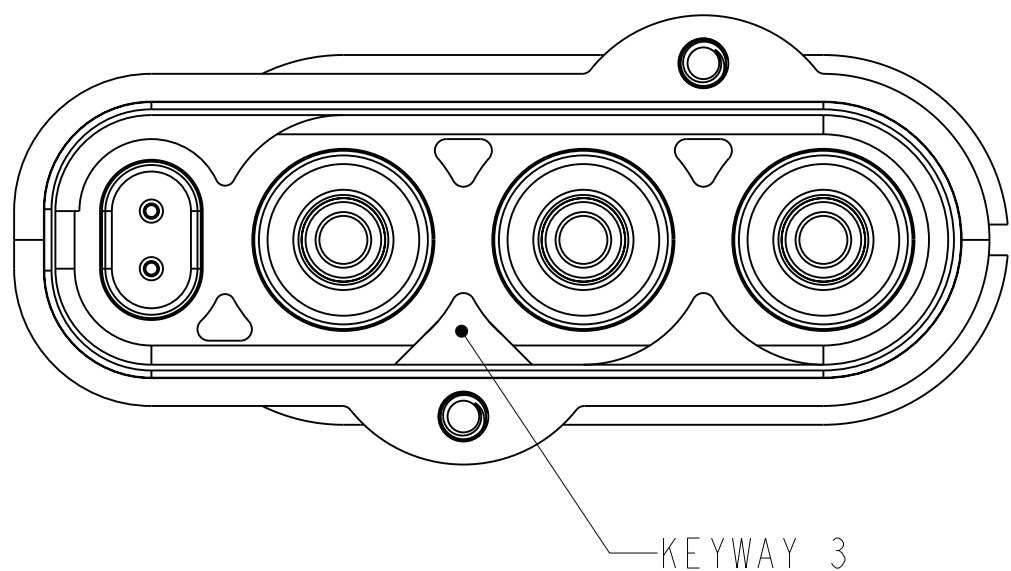

KEY OPTION 7
KEYWAY 3 OPEN

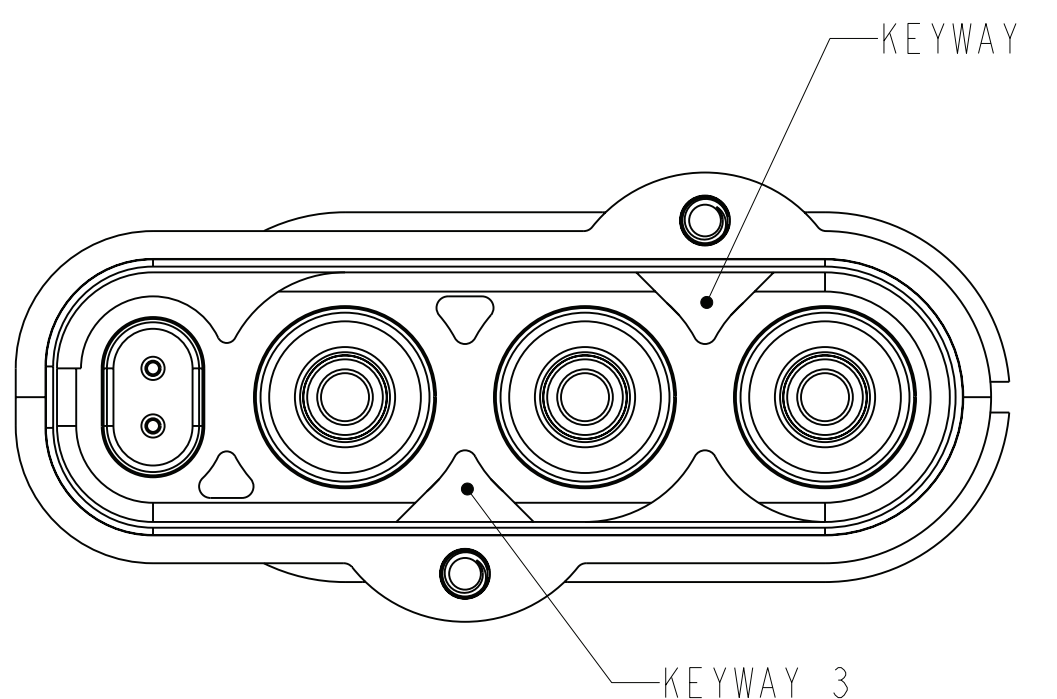

KEY OPTION 8
KEYWAYS 1 AND 3 OPEN

THE USE OF THIS DOCUMENT IS UNLIMITED.
HOWEVER, DOCUMENTS REFERENCED HEREON
MAY CONTAIN LIMITED RIGHTS DATA.

SIZE	CAGE CODE	DOCUMENT NO.	REV.
C	77820	10-643579	PA5
SCALE: 0.9	REF:	SHEET 5 OF 6	

WIRE/CONTACT ASSEMBLY FOR CUSTOMER REFERENCE

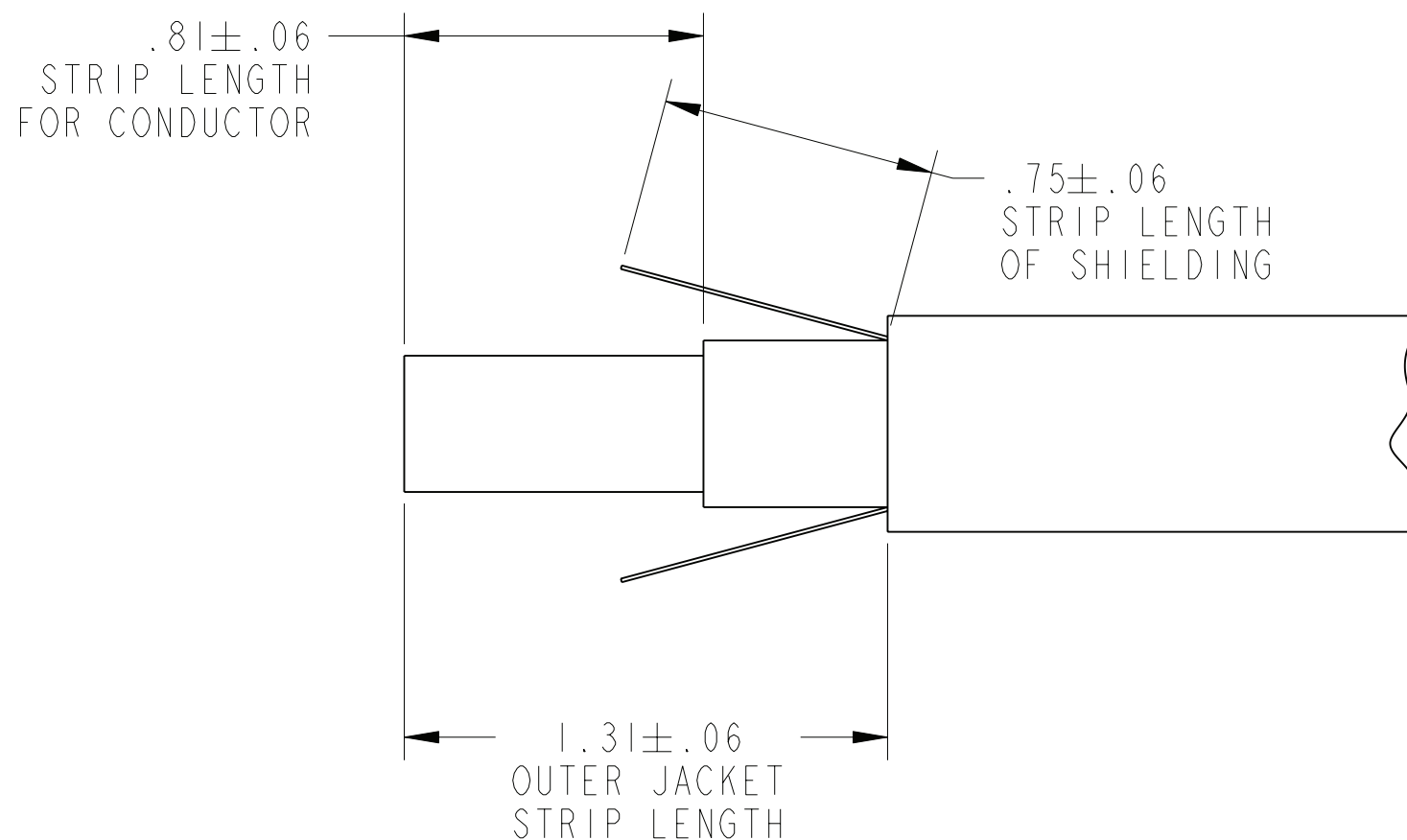
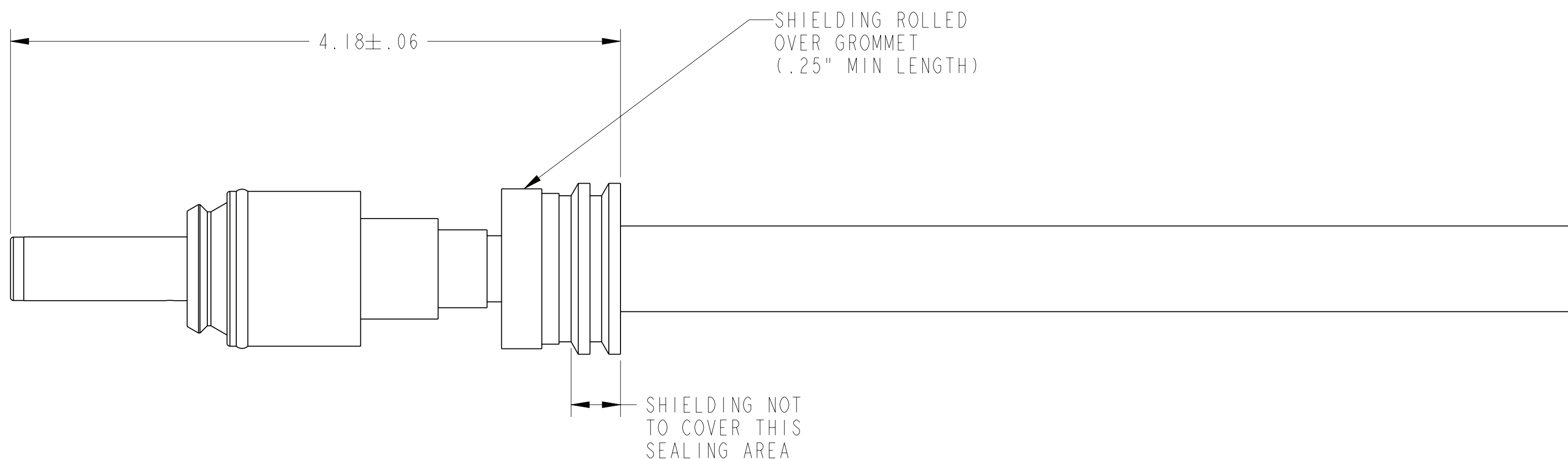

THE USE OF THIS DOCUMENT IS UNLIMITED. HOWEVER, DOCUMENTS REFERENCED HEREON MAY CONTAIN LIMITED RIGHTS DATA.

SIZE C	CAGE CODE 77820	DOCUMENT NO. 10-643579	REV. PA5
SCALE: 1.5		REF:	SHEET 6 OF 6

10-643579

SHEET 6 OF 6

REV. PA5

C

B

A

D

C

REV. PA5

SHEET 6 OF 6

10-643579

A