



Chipsmall Limited consists of a professional team with an average of over 10 year of expertise in the distribution of electronic components. Based in Hongkong, we have already established firm and mutual-benefit business relationships with customers from,Europe,America and south Asia,supplying obsolete and hard-to-find components to meet their specific needs.

With the principle of “Quality Parts,Customers Priority,Honest Operation,and Considerate Service”,our business mainly focus on the distribution of electronic components. Line cards we deal with include Microchip,ALPS,ROHM,Xilinx,Pulse,ON,Everlight and Freescale. Main products comprise IC,Modules,Potentiometer,IC Socket,Relay,Connector.Our parts cover such applications as commercial,industrial, and automotives areas.

We are looking forward to setting up business relationship with you and hope to provide you with the best service and solution. Let us make a better world for our industry!



## Contact us

Tel: +86-755-8981 8866 Fax: +86-755-8427 6832

Email & Skype: info@chipsmall.com Web: www.chipsmall.com

Address: A1208, Overseas Decoration Building, #122 Zhenhua RD., Futian, Shenzhen, China



PRODUCT NO.  
10025026

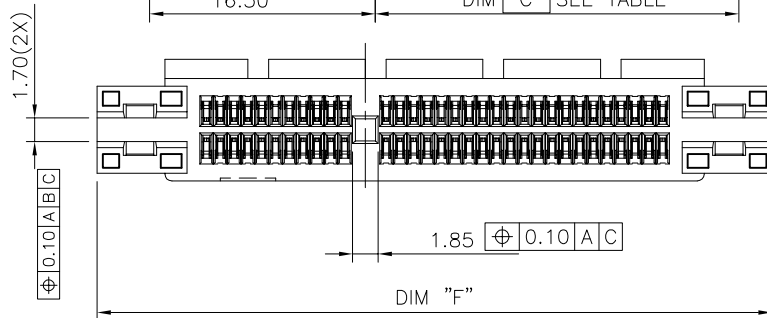
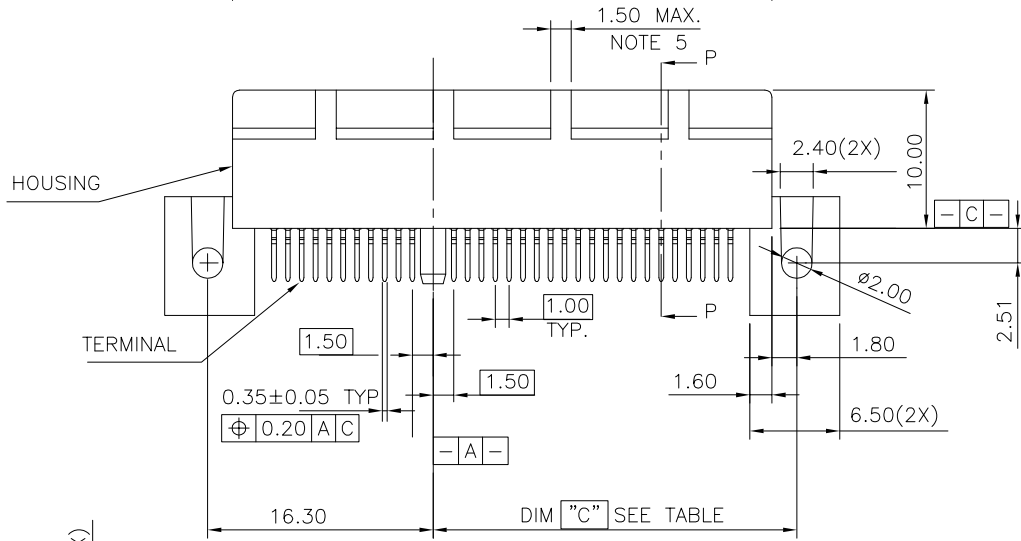
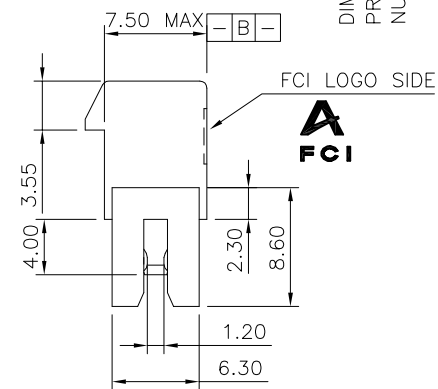
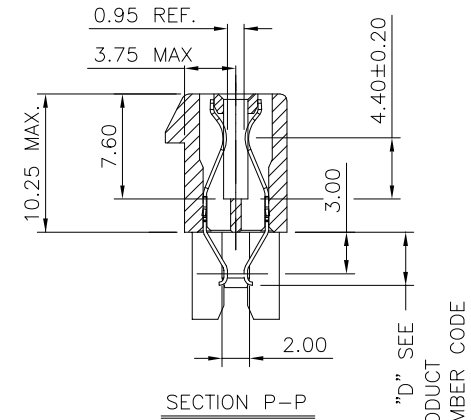
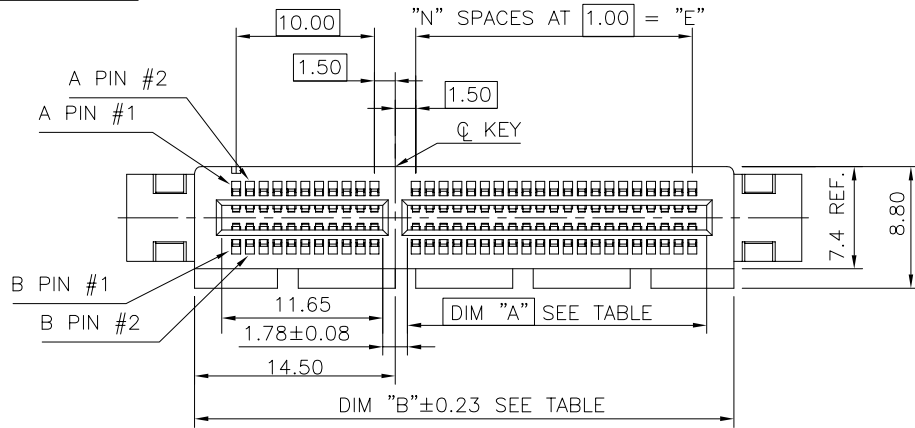

mat'l. code	-	surface	-	tolerance	ASME_Y14.5	projection	product family	PCI_EXPRESS
lfr	ecn no	dr	date	tolerances unless otherwise specified		MM	title	PCI_EXPRESS_CARD_EDGE_GEN3
F	T06-0179	M	W	10/24/06	angles		0.2±0.30	STRADDLE_MOUNT_ASS'Y
G	T06-0209	M	W	12/08/06	line out	.00±0.20	dwg no	sheet 1 of 7
H	T10-0068	J	H	5/26/10	±2'	.000±0.10	scale	N/A
J	DG-008880	H	T	12/12/11	dr	ZHENHUA_LIU	2016-03-25	size
K	DG-23735	LZH		04/05/16	enfr	ZHENHUA_LIU	2016-03-25	10025026
L	DG-24598	LZH		07/28/16	chr	STONE_LI	2016-03-25	A4
					appd	PM_ZHENG	2016-03-25	type
sheet	revision	L						CUSTOMER Drawing
index	sheet	7						

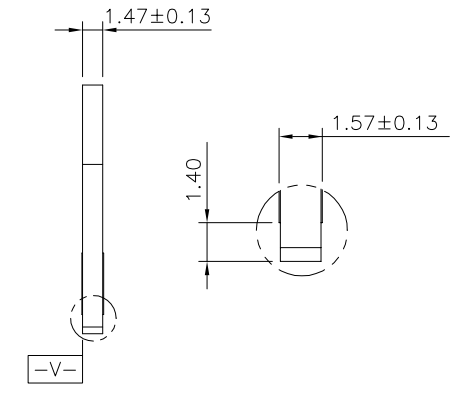
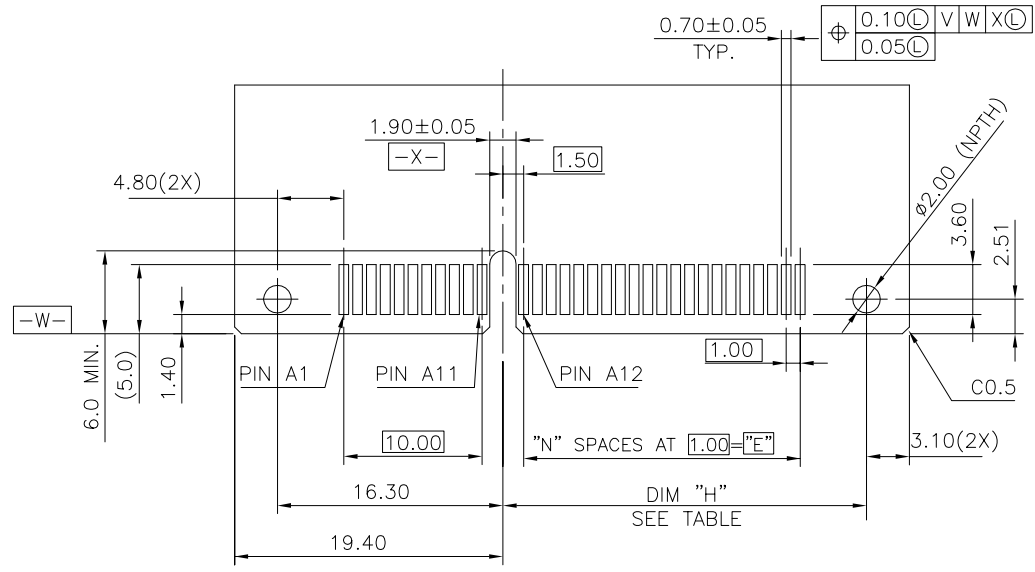

SCALE 2:1

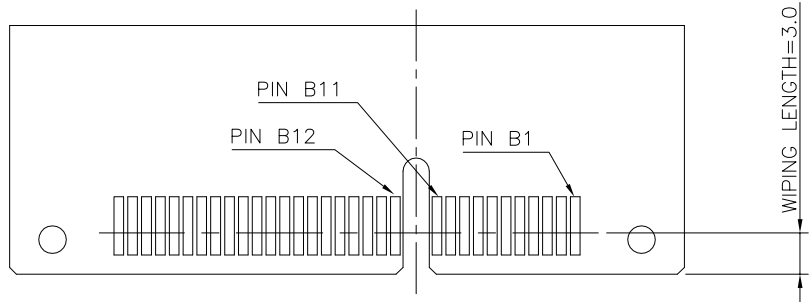

RECOMMEND OF PCB DIMENSIONS

#	POS REF.	N	DIM "H"	DIM "E"
36		6	12.30	6.00
64		20	26.30	20.00
98		37	43.30	37.00
164		70	76.30	70.00

mat'l. code		-		surface		- ✓		tolerance		ASME_Y14.5		projection		product family		PCI_EXPRESS	
lfr		ecn no		dr		date		tolerances unless otherwise specified		MM		title		PCI_EXPRESS_CARD_EDGE_GEN3		5	
								angles		.0±.020		scale N/A		STRADDLE_MOUNT_ASS'Y			
								±2'		.00±.013				dwg no		sheet 2 of 7 size	
				dr		ZHENHUA_LIU		2016-03-25		.000±.005		Amphenol FCI		10025026		A4	
				enfr		ZHENHUA_LIU		2016-03-25						type		CUSTOMER Drawing	
				chr		STONE_LI		2016-03-25									
				appd		PM_ZHENG		2016-03-25									
sheet index		revision sheet		L		7											



NOTES:

- 1.MATERIAL: RATED.  
HOUSING: HIGH TEMPERATURE NYLON, GLASS FILLED UL94V-0  
TERMINAL: COPPER ALLOY  
PLATING: SEE PRODUCT NUMBER CODE  
METAL BOARD LOCKS: COPPER ALLOY  
FINISH: 100u" TIN OVER 50u" NICKEL UNDERPLATE

2.PRODUCT SPECIFICATION: GS-12-233

- ③NO TIE BAR PERMITTED FROM CARD EDGE TO LEADING EDGE OF PAD FOR PINS A1 AND PIN NUMBERS "F".
- ④CHAMFER EDGES MUST BE FREE OF CUTTING BURRS.
- ⑤FREQUENCY & LOCATION AT SUPPLIER DISCRETION. RIDGE MAY BE CONTINUOUS WITH NO BREAKS.

6.RoHS COMPATIBLE PRODUCT SPECIFICATIONS

- a - PLATING:
  - "LF" MEANS THE PRODUCT IS LEAD-FREE
- b - MANUFACTURING PROCESS COMPATIBILITY
  - THE HOUSING WILL WITHSTAND EXPOSURE TO 260°C±5°C SOLDER BATH TEMPERATURE FOR 5 SECONDS IN A REFLOW SOLDER APPLICATION.

CONNECTOR	# POS	REF.	N	DIM "A"	DIM "B"	DIM "C"	"E"	"F"
1 PORT	36		6	7.65	25.00	12.30	6.00	34.8
4 PORT	64		20	21.65	39.00	26.30	20.00	48.8
8 PORT	98		37	38.65	56.00	43.30	37.00	65.8
16 PORT	164		70	71.65	89.00	76.30	70.00	98.8

PRODUCT NUMBER CODE

10025026 -x 0 x 0 x T □ □

- HOUSING COLOR OPTIONS
  - 0-NATURAL, HALOGEN
  - 1-BLACK, HALOGEN
  - △ 2-NATURAL, HALOGEN FREE
  - 3-BLACK, HALOGEN FREE
- RESERVE
- TERMINAL PLATING OPTIONS
  - 0-50u" Ni UNDERPLATE  
30u" Au CONTACT AREA  
100u" TIN TAIL AREA ----- COMPATIBLE RoHS
  - 1-50u" Ni UNDERPLATE  
15u" Au CONTACT AREA  
100u" TIN TAIL AREA ----- COMPATIBLE RoHS
  - 2-50u" Ni UNDERPLATE  
GOLD FLASH CONTACT AREA  
100u" TIN TAIL AREA ----- COMPATIBLE RoHS
  - 3-50u" Ni UNDERPLATE  
30u" Au CONTACT AREA  
100u" TIN/LEAD TAIL AREA ----- INCOMPLIANT RoHS
  - 4-50u" Ni UNDERPLATE  
15u" Au CONTACT AREA  
100u" TIN/LEAD TAIL AREA ----- INCOMPLIANT RoHS
  - 5-50u" Ni UNDERPLATE  
GOLD FLASH CONTACT AREA  
100u" TIN/LEAD TAIL AREA ----- INCOMPLIANT RoHS

PACKAGING OPTIONS

- T: TRAY PACKAGING(IN GENERAL VERTICAL DIRECTION)
- C: TAPE & REEL WITH INSERT CAP (FOR 98P ONLY)
- H: TRAY PACKAGING(IN SPECIAL HORIZONTAL DIRECTION FOR 164P ONLY)
- P: TRAY PACKAGING WITH INSERT CAP
- △ S: TRAY PACKAGING WITH INSERT CAP(IN SPECIAL HORIZONTAL DIRECTION)

TAIL LENGTH OPTIONS

DIM "D"	PCB THICKNESS
3.85 +0.25 -0.13	1.56

LEAD FREE OPTIEON

"LF" FOR TERMINAL PLATING OPTION 0,1,2

mat'l. code		surface		tolerance		projection		product family	
-		-		ASME_Y14.5				PCI_EXPRESS	
lfr		ecn no		dr		date		title	
								PCI_EXPRESS_CARD_EDGE_GEN3 STRADDLE_MOUNT_ASS'Y	
				angles		MM		dwg no	
				±2'		scale N/A		sheet 4 of 7	
				dr		ZHENHUA_LIU		2016-03-25	
				enfr		ZHENHUA_LIU		2016-03-25	
				chr		STONE_LI		2016-03-25	
				appd		PM_ZHENG		2016-03-25	
sheet index		revision sheet		L		7		Amphenol FCI	
								10025026	
								CUSTOMER Drawing	
								A4	

NOTES:

1. MATERIAL:  
INSERT CAP: THERMOPLASTIC UL94V-0; BLACK COLOR.

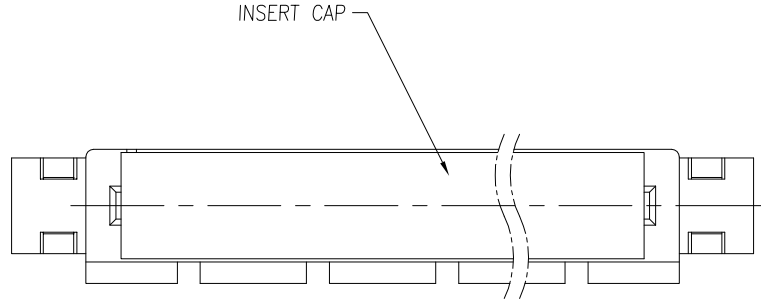

DIMENSIONS		
POSITION	F	G
36	20.4	7.1
64	34.4	21.1
98	51.4	38.1
164	84.4	71.1

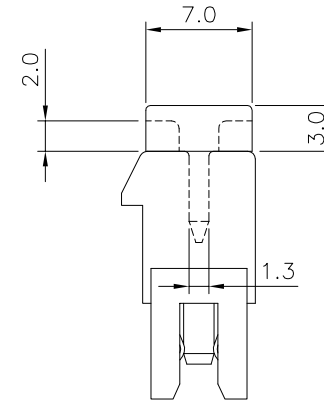
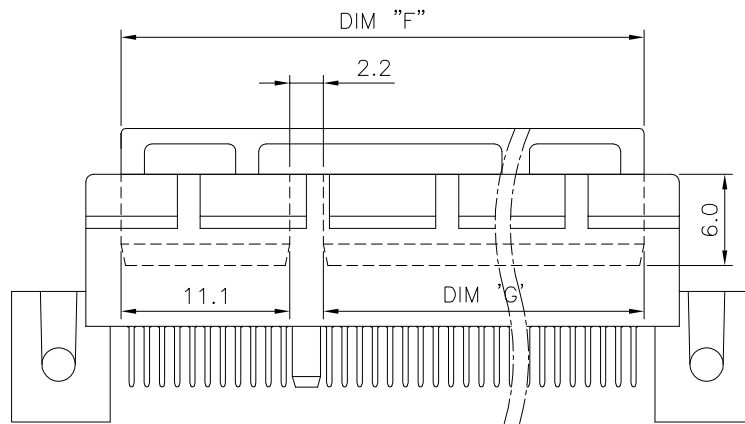

mat'l. code		surface		tolerance		projection		product family	
-		-		ASME_Y14.5				PCI_EXPRESS	
lfr		ecn no		dr		date		title	
								PCI_EXPRESS_CARD_EDGE_GEN3 STRADDLE_MOUNT_ASS'Y	
				angles				dwg no	
				±2'		scale N/A		sheet 5 of 7	
				dr		ZHENHUA_LIU		2016-03-25	
				enfr		ZHENHUA_LIU		2016-03-25	
				chr		STONE_LI		2016-03-25	
				appd		PM_ZHENG		2016-03-25	
sheet index		revision sheet		L				type	
		7						CUSTOMER Drawing	

**NOTE:**

1. REEL MATERIAL : PS, BLACK
2. CARRIER MATERIAL : PS
3. COVER TAPE MATERIAL : PS
4. COVER TAPE REEL STRENGTH : 13"
5. QUANTITY : 150 PCS/REEL
6. Carton : 380(L) \* 380(W) \* 300(H) mm

Part No	
10025026-XXXXC(LF)	

NO. OF CONTACTS	98
REEL/CARTON	3
PCS/REEL	150
QUANTITY(PCS)	450

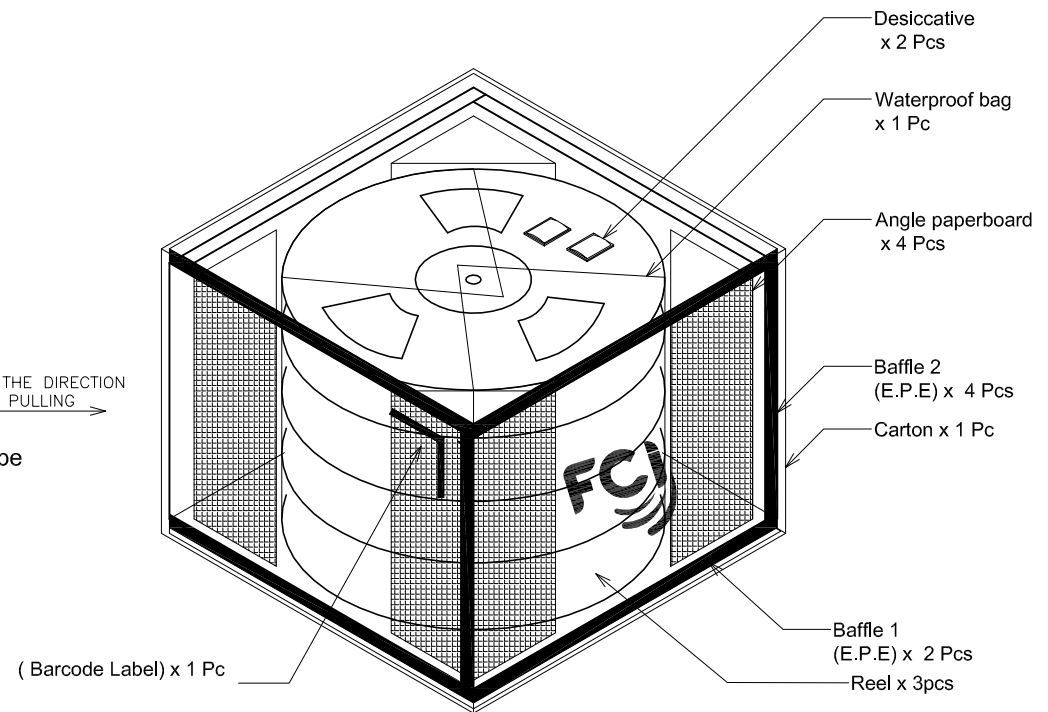
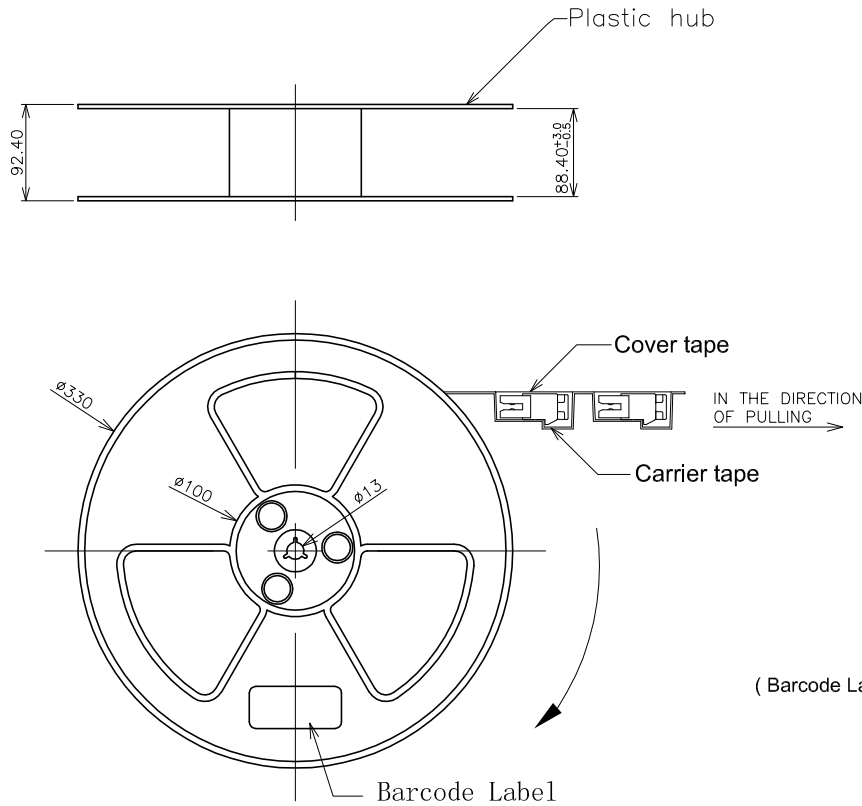

mat'l. code	-	surface	-	tolerance	ASME_Y14.5	projection	product family	PCI_EXPRESS
lfr	ecn no	dr	date	tolerances unless otherwise specified		MM	title	
				angles	.02±0.30		PCI_EXPRESS_CARD_EDGE_GEN3 STRADDLE_MOUNT_ASS'Y	
				±2'	.00±0.20	scale N/A	dwg no sheet 6 of 7 size	
				dr	ZHENHUA_LIU	2016-03-25	Amphenol FCI	10025026
				enfr	ZHENHUA_LIU	2016-03-25		A4
				chr	STONE_LI	2016-03-25		type
				appd	PM_ZHENG	2016-03-25		CUSTOMER Drawing
sheet index	revision sheet	L	7					

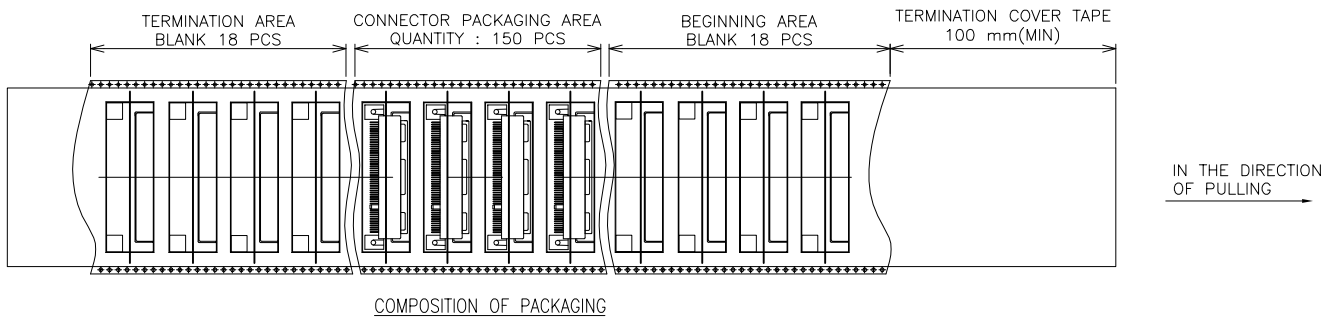
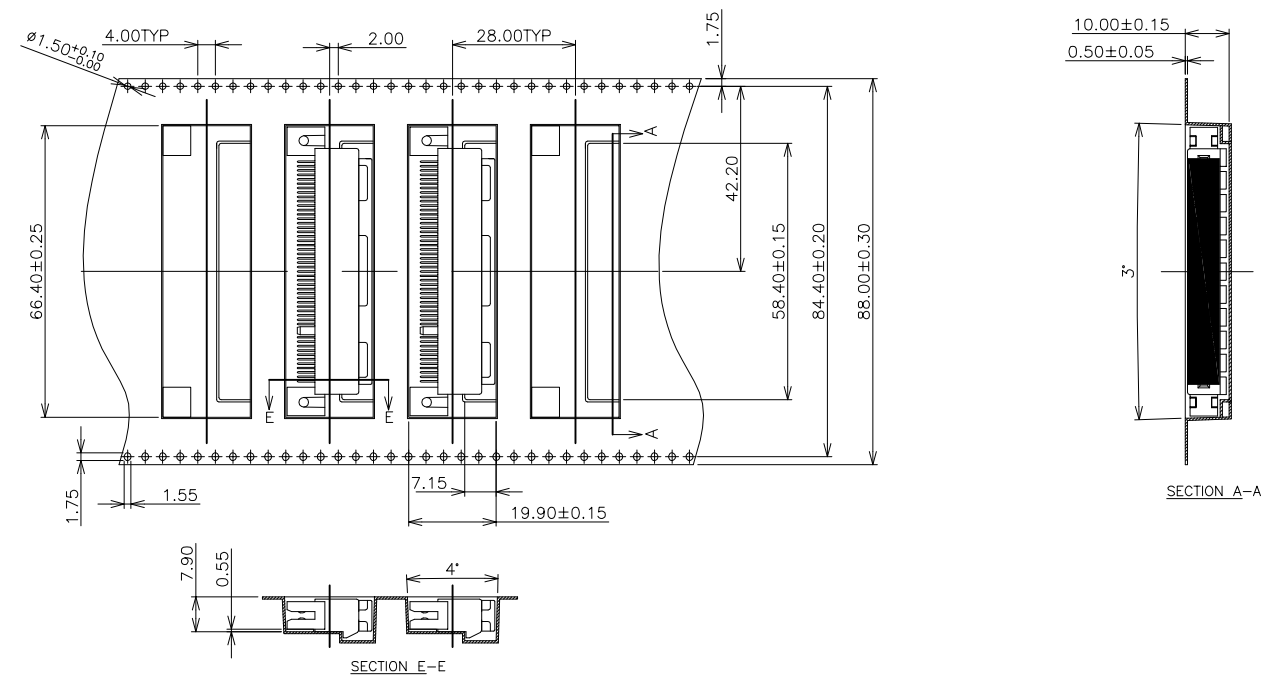

mat'l. code		-		surface	-	tolerance	ASME_Y14.5	projection	ASME	product family	PCI_EXPRESS
lfr	ecn no	dr	date	tolerances unless otherwise specified				MM	scale N/A	title	
				angles	±2'	linear	.02±0.30			PCI_EXPRESS_CARD_EDGE_GEN3 STRADDLE_MOUNT_ASS'Y	
							.00±0.20	Amphenol FCI		dwg no	10025026
				dr	ZHENHUA_LIU	2016-03-25	.000±0.10			sheet 7 of 7	size
				enfr	ZHENHUA_LIU	2016-03-25					A4
				chr	STONE_LI	2016-03-25					
				appd	PM_ZHENG	2016-03-25				type	CUSTOMER Drawing
sheet index	revision	L	7								