



Chipsmall Limited consists of a professional team with an average of over 10 year of expertise in the distribution of electronic components. Based in Hongkong, we have already established firm and mutual-benefit business relationships with customers from,Europe,America and south Asia,supplying obsolete and hard-to-find components to meet their specific needs.

With the principle of "Quality Parts,Customers Priority,Honest Operation,and Considerate Service",our business mainly focus on the distribution of electronic components. Line cards we deal with include Microchip,ALPS,ROHM,Xilinx,Pulse,ON,Everlight and Freescale. Main products comprise IC,Modules,Potentiometer,IC Socket,Relay,Connector.Our parts cover such applications as commercial,industrial, and automotives areas.

We are looking forward to setting up business relationship with you and hope to provide you with the best service and solution. Let us make a better world for our industry!



Contact us

Tel: +86-755-8981 8866 Fax: +86-755-8427 6832

Email & Skype: info@chipsmall.com Web: www.chipsmall.com

Address: A1208, Overseas Decoration Building, #122 Zhenhua RD., Futian, Shenzhen, China





Copyright FCI.

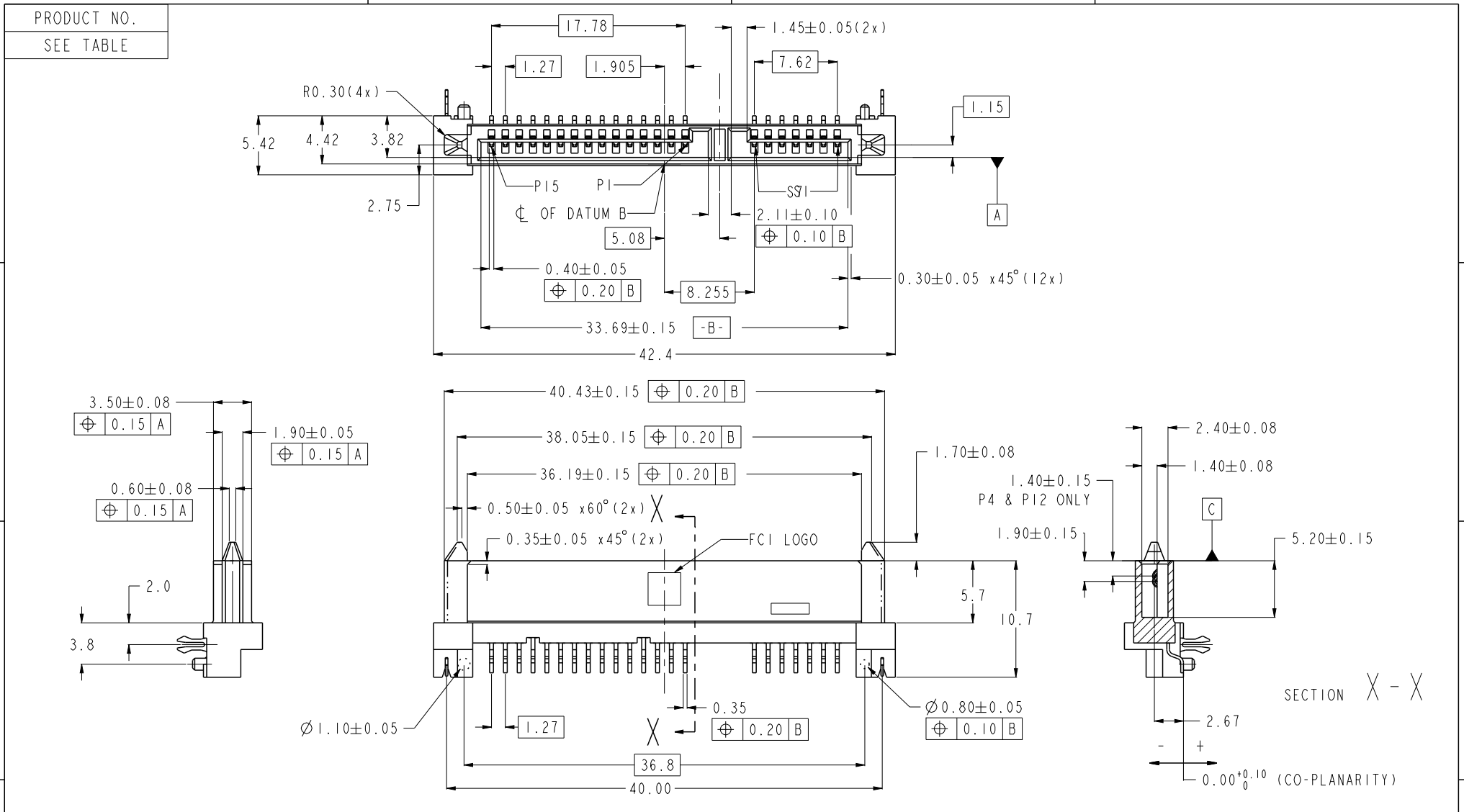

spec ref		dr w wcadmin		2006/02/20		projection		size A4		scale 1:1							
tolerance std		eng Koon-Poh Tay		2013/04/10				MM		ecn no ELX-J-14320-1							
ASME Y14.5		chr -		-						rel level Released							
TOLERANCES UNLESS OTHERWISE SPECIFIED		appr Chen-Hong Tan		2013/04/15		product family -		dwg no 10029364		rev S							
surface ✓		linear		0.X ±----				S-ATA COMB RECEPTACLE		www.fci.com							
				0.XX ±0.20								cat. no. -		Product - Customer Drw		sheet 1 of 3	
				0.XXX ±----													
		angular		0° ±°													

Prod File - REV C - 2009-06-09

10029364-00XLF/TRLF

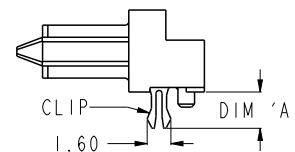
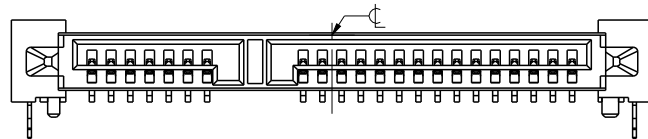

10029364-01XLF/TRLF

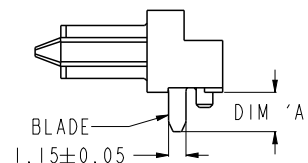
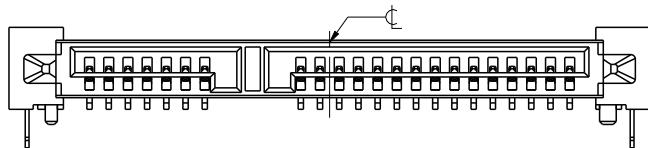

10029364-10XLF/TRLF

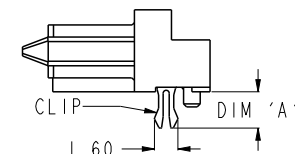
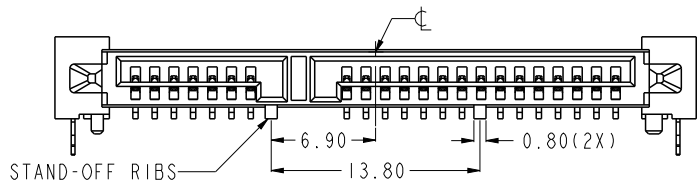

10029364-11XLF/TRLF

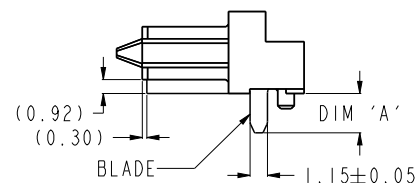
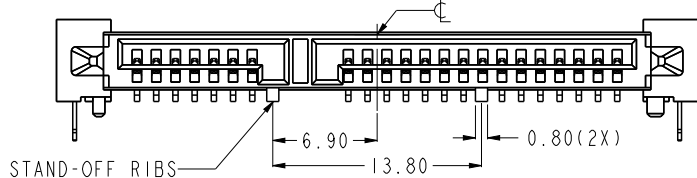

10029364-11XC/LF/C-TRLF

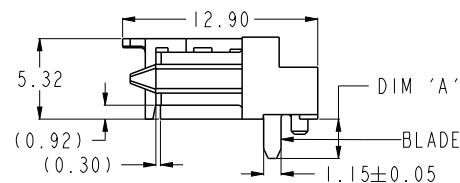
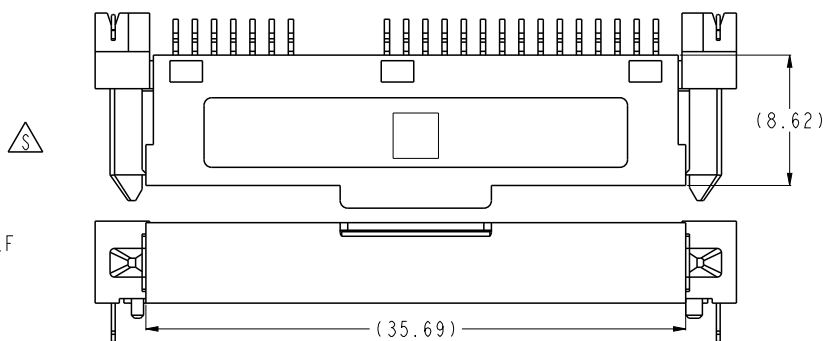

spec ref		dr w wcadmin		2006/02/20		projection		size		scale							
tolerance std		eng Koon-Poh Tay		2013/04/10				MM		A4							
ASME Y14.5		chr -		-				ecn no		ELX-J-14320-1							
TOLERANCES UNLESS OTHERWISE SPECIFIED		appr Chen-Hong Tan		2013/04/15		product family		-		rel level							
surface ✓		linear		0.X ±----				title S-ATA COMB RECEPTACLE R/A SMT TYPE ASSY		dwg no 10029364		rev					
				0.XX ±0.20								-		Product - Customer Drw		sheet 2 of 3	
		angular		0° ±°								www.fci.com		cat. no.		-	

PRODUCT NO.	RECOMMENDED P.C.B. THICKNESS	HOLD DOWN	DIM 'A'	HOUSING WITH STAND-OFF RIBS	PACKAGING	
10029364-001LF	1.60	METAL CLIP	2.40	NO	TRAY	
10029364-001TRLF					TAPE & REEL	
10029364-002LF	1.00		NO	1.80	TRAY	
10029364-002TRLF					TAPE & REEL	
10029364-102LF			TRAY			
10029364-102TRLF			TAPE & REEL			
10029364-011LF	--	BLADE	2.60	NO	TRAY	
10029364-011TRLF					TAPE & REEL	
10029364-111LF			YES	YES	2.60	TRAY
10029364-111TRLF						TAPE & REEL
10029364-111CLF						TRAY
10029364-111C-TRLF						TAPE & REEL

NOTES:-

1. MATERIAL:

1) HOUSING : HIGH TEMP. THERMOPLASTIC, UL 94V-0
COLOR : BLACK

2) TERMINAL : COPPER ALLOY
3) HOLD DOWN : COPPER ALLOY

2. FINISH:

1) TERMINAL : 30u" GOLD PLATING (CONTACT POINT)
OVER 50u" MIN NICKEL

2) SOLDER TAIL : 100u" MIN TIN OVER 50u" NICKEL
3) HOLD DOWN : 100u" MIN TIN OVER 50u" NICKEL

3. TRUE POSITION APPLY AT TERMINAL TIP

4. THE STANDARD PACKAGING IS IN TRAY.

5. THE HOUSING WILL WITHSTAND EXPOSURE TO 260°C PEAK TEMPERATURE FOR 10 SECONDS IN A CONVECTION, INFRA-RED OR VAPOR PHASE REFLOW OVEN

6 THIS PRODUCT MEETS EUROPEAN UNION DIRECTIVES AND OTHER COUNTRY REGULATIONS AS DESCRIBED IN GS-22-008

7 PART NUMBERS ENDING IN "LF" ARE MEANT FOR LEAD-FREE IDENTIFICATION. P/N XXXXXXXX-XXXLF IS EQUIVALENT TO PREVIOUS P/N XXXXXXXX-XXX

8. A Δ SYMBOL WILL BE NEXT TO ANY DIMENSION, VIEW, OR NOTE WHICH HAS BEEN MODIFIED WITH THE CURRENT DRAWING REVISION.

RECOMMENDED P.C.B. LAYOUT
TOLERANCE UNLESS OTHERWISE ± 0.10

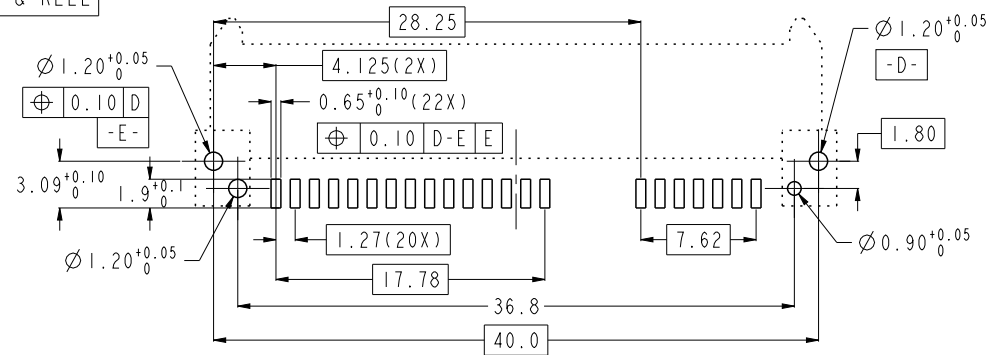

ALTERNATIVE P.C.B. LAYOUT
REFER TO RECOMMENDED PCB LAYOUT FOR UNSPECIFIED DIMENSIONS
TOLERANCE UNLESS OTHERWISE ± 0.10

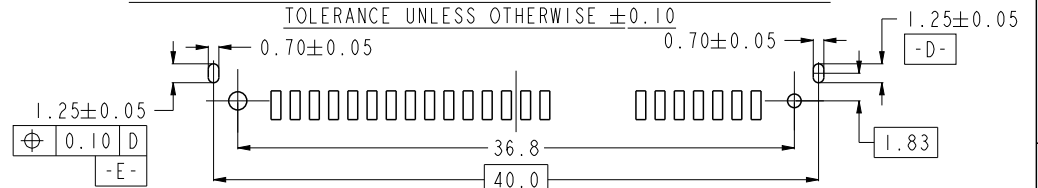

spec ref		dr	w wcadmin	2006/02/20	projection 	MM 	size	A4	scale	1:1
tolerance std		eng	Koon-Poh Tay	2013/04/10			ecn no	ELX-J-14320-1		
ASME Y14.5		chr	-	-			rel level	Released		
surface \checkmark	linear	0.X	\pm ----		product family	-	dwg no	10029364	rev	S
		0.XX	± 0.20							
		0.XXX	\pm ----							
	angular	0°	\pm °		product family	-	Product - Customer Drw	sheet 3 of 3		