



Chipsmall Limited consists of a professional team with an average of over 10 year of expertise in the distribution of electronic components. Based in Hongkong, we have already established firm and mutual-benefit business relationships with customers from,Europe,America and south Asia,supplying obsolete and hard-to-find components to meet their specific needs.

With the principle of “Quality Parts,Customers Priority,Honest Operation,and Considerate Service”,our business mainly focus on the distribution of electronic components. Line cards we deal with include Microchip,ALPS,ROHM,Xilinx,Pulse,ON,Everlight and Freescale. Main products comprise IC,Modules,Potentiometer,IC Socket,Relay,Connector.Our parts cover such applications as commercial,industrial, and automotives areas.

We are looking forward to setting up business relationship with you and hope to provide you with the best service and solution. Let us make a better world for our industry!



Contact us

Tel: +86-755-8981 8866 Fax: +86-755-8427 6832

Email & Skype: info@chipsmall.com Web: www.chipsmall.com

Address: A1208, Overseas Decoration Building, #122 Zhenhua RD., Futian, Shenzhen, China



1

2

3

4

PRODUCT NO.	FRONT CAP	END CAP	INSULATOR	REMARK
10030582-2100LF	10030583-210	10030592-210	NO	
10030582-2101LF	10030583-210	10030592-210	YES	
10030582-0000LF	10030583-210	NO	NO	SEE NOTE 5
10030582-0001LF	10030583-210	NO	YES	SEE NOTE 5
10030582-0010LF	10030583-210	NO	NO	
10030582-0011LF	10030583-210	NO	YES (STANDARD)	
10030582-0012LF	10030583-210	NO	YES (SPECIAL)	
10030582-0020LF	10030583-210	NO	NO	
10030582-0021LF	10030583-210	NO	YES	

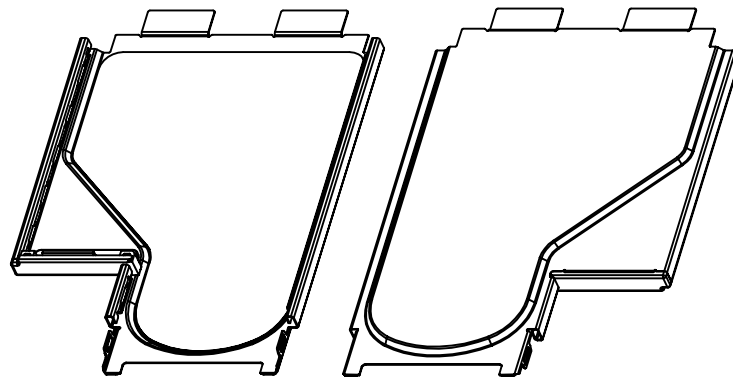

10030582-001XLF

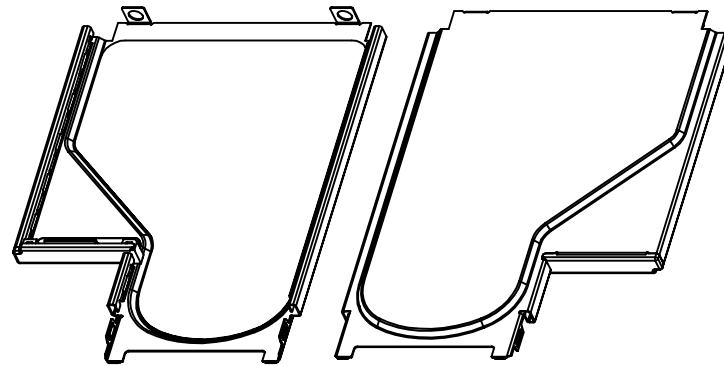

10030582-002XLF

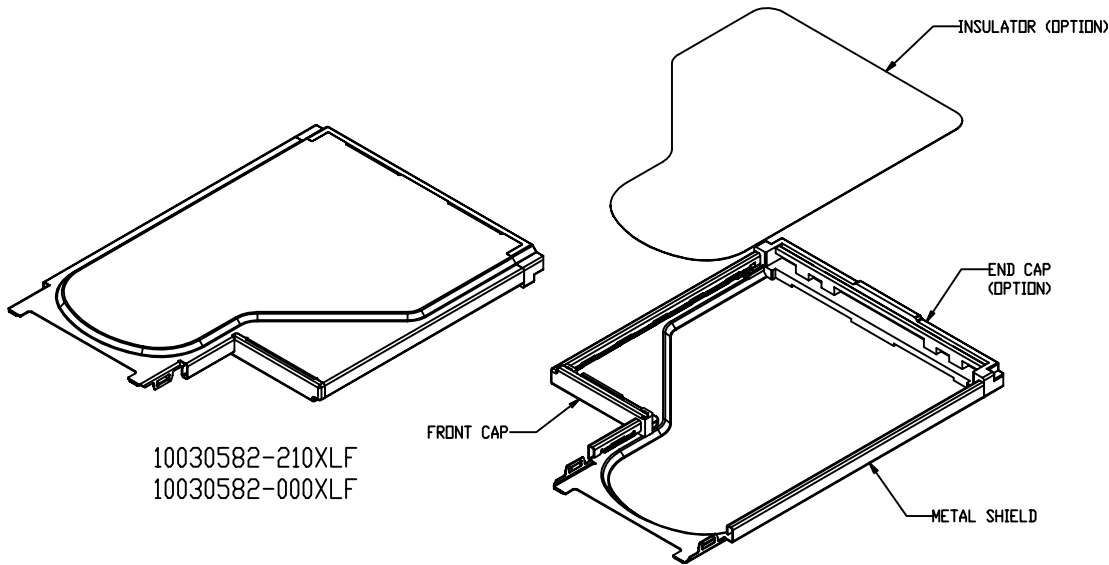

10030582-210XLF
10030582-000XLF

NOTES:

- THIS PRODUCT CONTAINS ONE METAL SHIELD, PLASTIC FRONT CAP, INSULATOR AND ONE PLASTIC END CAP.
- PRODUCT PERFORMANCE PER SPEC. GS-12-292.
- PART NUMBER SCHEME:

10030582- X X X X L F

INSULATOR:
 0: NO
 1: STANDARD
 2: SPECIAL

0: STANDARD SHIELD
 1: EXTENDED SHIELD
 2: CUSTOMIZED

PLASTIC COLOR
 0: W/D END CAP
 1: BLACK

OFFSET (END CAP)
 0: W/D END CAP
 1: +0.00 (NOT TOOLED)
 2: +0.30
 3: +0.60 (NOT TOOLED)

rev	ecn no	dr	date
A	T04-0382	D T	2004-11-04
B	T05-0083	D T	2005-04-18
E	T06-0015	D T	2006-01-16
F	T06-0057	D T	2006-04-17
G	N07-0094	HB	2007-04-10

www.fciconnect.com			surface	tolerance std	projection	MM
			ANGULAR	LINEAR	size	Scale
Dr	DAVID TENG	2004-10-04	0.X	±0.30	A4	1.000
Eng	DAVID TENG	2004-10-04	0.XX	±0.15	ECN	
Chr	PAUL WANG	2004-10-04	0.XXX	±0.08	Spec ref	
Appr	JOSEPH HSIA	2004-10-04	Product family			
FCI			title		cat no	Rev.
			BOTTOM SHIELD SUB-ASSEMBLY		10030582	J
			EXPRESSCARD/54 MODULE CARD KIT		CUSTOMER	sheet 1 of 5
			catalog no	10030582		

- PACKAGING SPEC. PER GS-14-927.
- THE P/N IS TEMPORARY FOR CUSTOMER SPECIAL REQUEST. STANDARD SHIELD MATING WITH END CAP IS THE RECOMMENDED PARTS.
- THIS PRODUCT IS RoHS COMPLIANT, AND MEETS EUROPEAN UNION DIRECTIVES AND OTHER COUNTRY REGULATIONS AS PER GS-22-008.

2

3 PDM: Rev:J

STATUS Released

4 Printed: Oct 12, 2010



Copyright FCI.

PRODUCT NO.
10030582-210XLF



Copyright FCI.

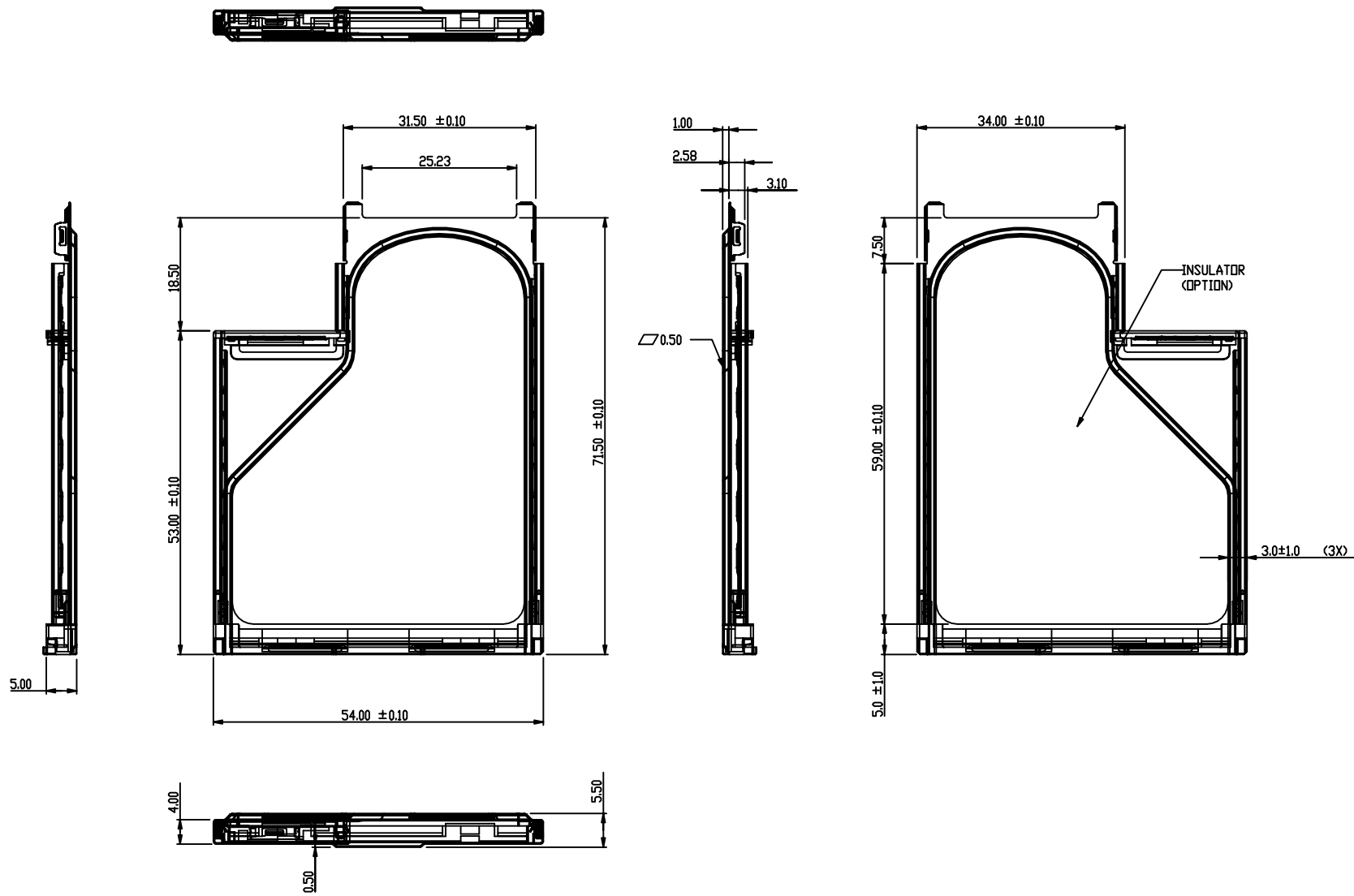

TOLERANCES UNLESS OTHERWISE SPECIFIED		
LINEAR	0.X	±0.30
	0.XX	±0.15
	0.XXX	±0.08
ANGULAR	0°	±2°

	title BOTTOM SHIELD SUB-ASSEMBLY EXPRESSCARD/54 MODULE CARD KIT	dwg no 10030582	Rev. J
	catalog no 10030582	CUSTOMER	sheet 2 of 5

REV F - 2006-04-17

PRODUCT NO.
10030582-001XLF

A

B

C

D

1

2

3

4

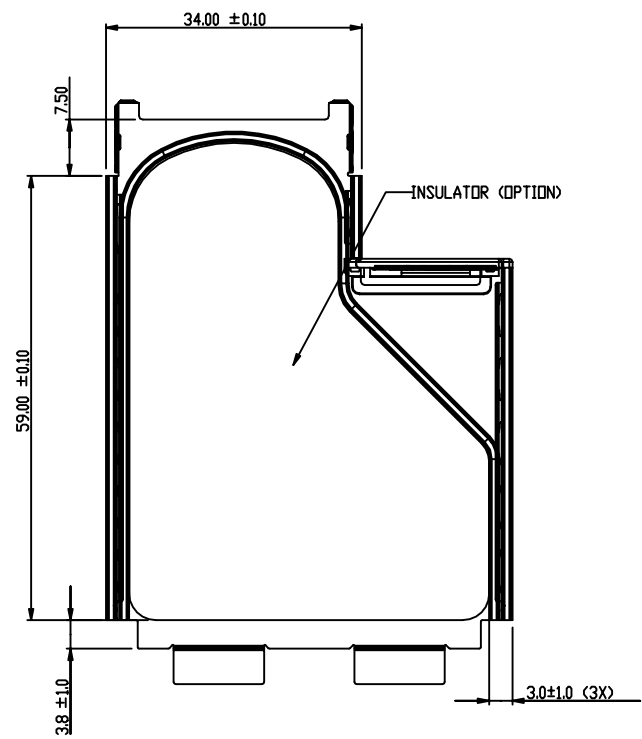
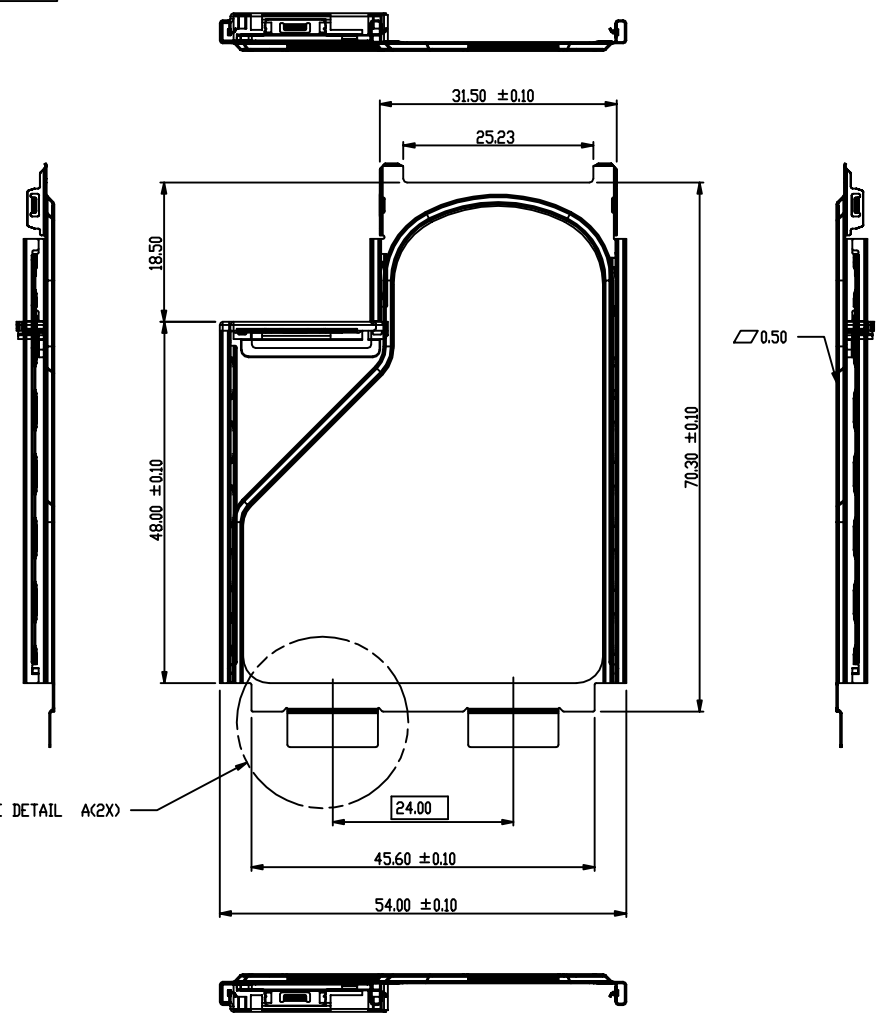

Copyright FCI.

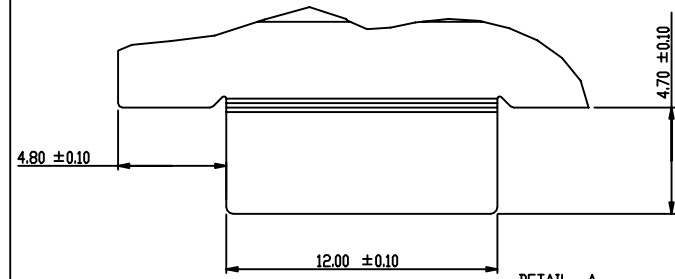

DETAIL A
SCALE 3.000

TOLERANCES UNLESS OTHERWISE SPECIFIED		
LINEAR	0.X	±0.30
	0.XX	±0.15
	0.XXX	±0.08
ANGULAR	0°	±2°

	title BOTTOM SHIELD SUB-ASSEMBLY EXPRESSCARD/54 MODULE CARD KIT	dwg no 10030582	Rev. J
	catalog no 10030582	CUSTOMER	sheet 3 of 5

REV F - 2006-04-17

1

2

3 PDM: Rev:J

STATUS Released

4 Printed: Oct 12, 2010

1

2

3

4

PRODUCT NO.
10030582-0012LF

A

B

C

D

A

B

C

D



Copyright FCI.

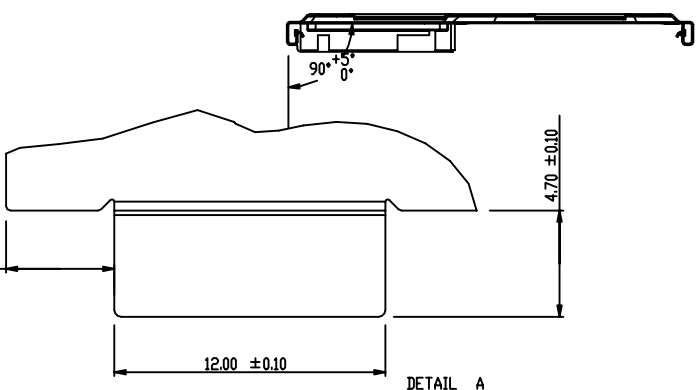
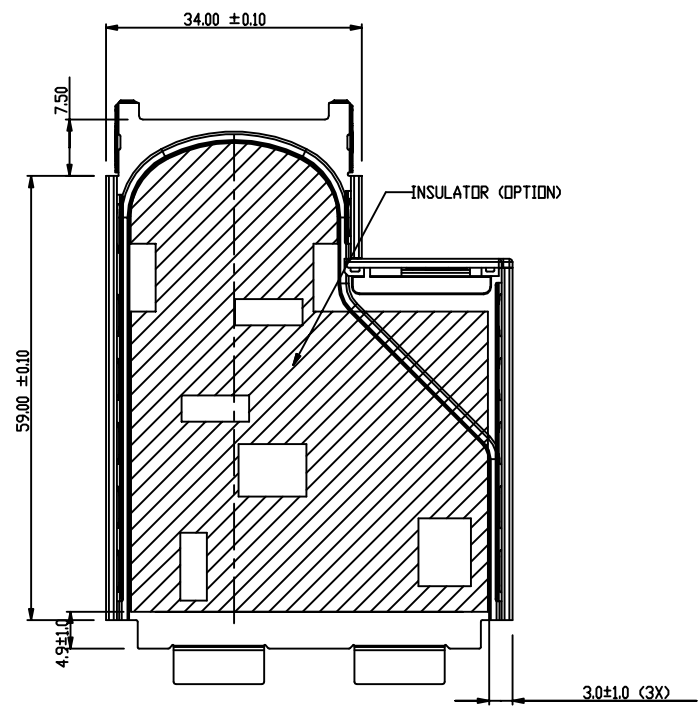
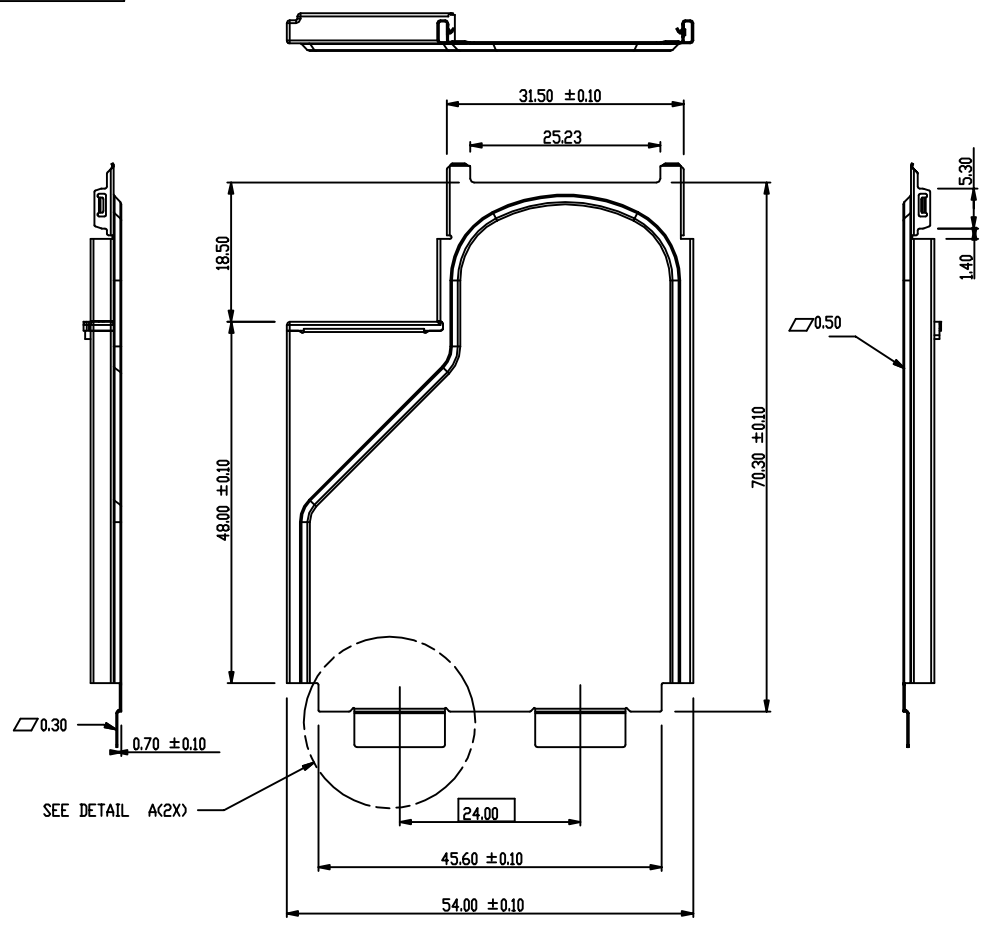

TOLERANCES UNLESS OTHERWISE SPECIFIED		
LINEAR	0.X	±0.30
	0.XX	±0.15
	0.XXX	±0.08
ANGULAR	0°	±2°

	title BOTTOM SHIELD SUB-ASSEMBLY		dwg no 10030582	Rev. H
	EXPRESSCARD/54 MODULE CARD KIT			
	catalog no 10030582	CUSTOMER	sheet 4 of 5	

REV F - 2006-04-17

1

2

3 PDM: Rev:J

STATUS Released

4 Printed: Oct 12, 2010

1

2

3

4

PRODUCT NO.
10030582-002XLF

A

B

C

D

A

B

C

D



Copyright FCI.

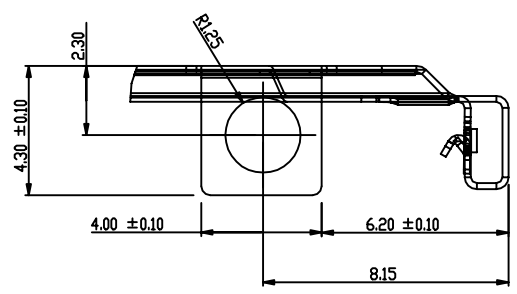
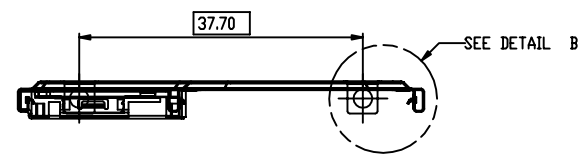
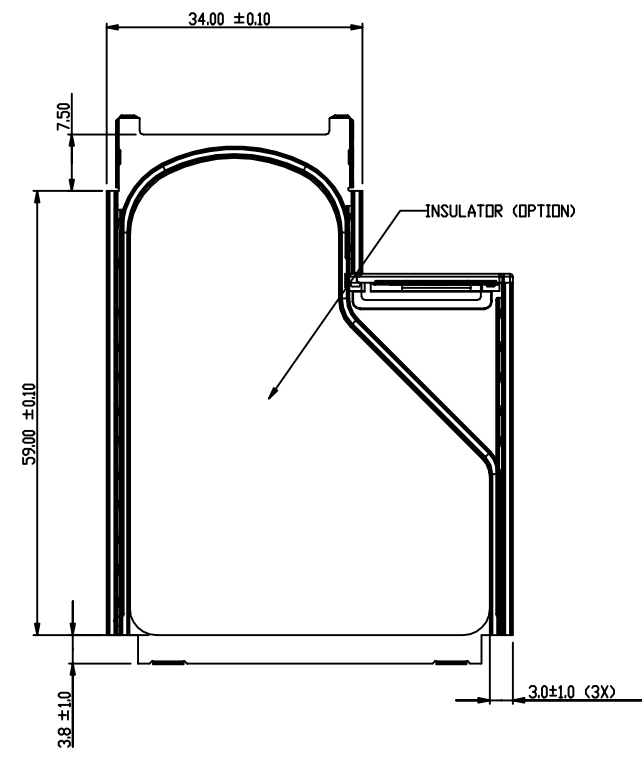
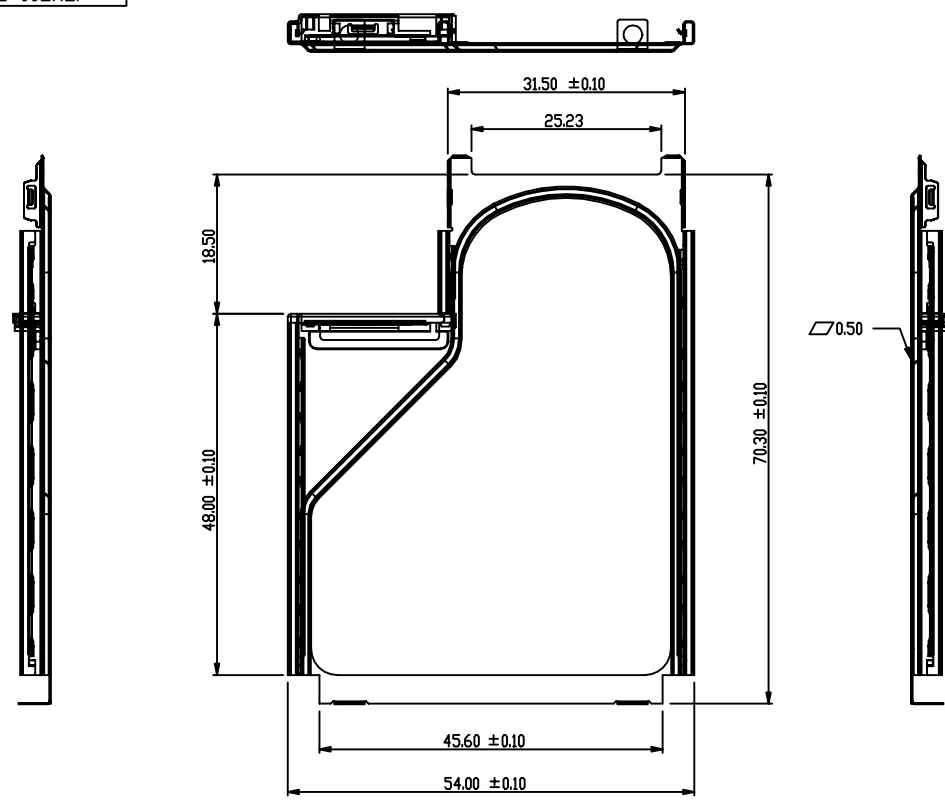

DETAIL B
SCALE 4.000

TOLERANCES UNLESS OTHERWISE SPECIFIED		
LINEAR	0.X	±0.30
	0.XX	±0.15
	0.XXX	±0.08
ANGULAR	0°	±2°

	title	BOTTOM SHIELD SUB-ASSEMBLY		dwg no	10030582	Rev.	H
		EXPRESSCARD/54 MODULE CARD KIT					
	catalog no	10030582	CUSTOMER	sheet 5 of 5			

REV F - 2006-04-17

1

2

3 PDM: Rev:J

STATUS Released

4

Printed: Oct 12, 2010