



Chipsmall Limited consists of a professional team with an average of over 10 year of expertise in the distribution of electronic components. Based in Hongkong, we have already established firm and mutual-benefit business relationships with customers from,Europe,America and south Asia,supplying obsolete and hard-to-find components to meet their specific needs.

With the principle of “Quality Parts,Customers Priority,Honest Operation,and Considerate Service”,our business mainly focus on the distribution of electronic components. Line cards we deal with include Microchip,ALPS,ROHM,Xilinx,Pulse,ON,Everlight and Freescale. Main products comprise IC,Modules,Potentiometer,IC Socket,Relay,Connector.Our parts cover such applications as commercial,industrial, and automotives areas.

We are looking forward to setting up business relationship with you and hope to provide you with the best service and solution. Let us make a better world for our industry!



Contact us

Tel: +86-755-8981 8866 Fax: +86-755-8427 6832

Email & Skype: info@chipsmall.com Web: www.chipsmall.com

Address: A1208, Overseas Decoration Building, #122 Zhenhua RD., Futian, Shenzhen, China



1003GX2 Industrial Ethernet Switch

N-Tron Networking Series



▶▶▶ Unmanaged Gigabit Industrial Ethernet Switch

The N-TRON® 1003GX2 is an unmanaged three port Gigabit Industrial Ethernet Switch.

It is housed in a hardened, metal DIN-Rail enclosure, and is designed for use in industrial data acquisition, control, and Ethernet I/O applications. The 1003GX2 Gigabit Industrial Ethernet Switch is designed to solve the most demanding industrial communications requirements while providing high throughput and minimum downtime.



APPLICATIONS

- > Factory Automation
- > Utilities
- > SCADA
- > Security Surveillance
- > Transportation
- > Alternative Energy

PRODUCT HIGHLIGHTS

- > Compact, Industrial Design
- > Up to 3 port connections
- > High Environmental Specifications
- > N-Ring Advanced Ring Technology
- > Increased Networking Performance
- > Plug-and-Play Operation

FEATURES & BENEFITS

- > Compact Size, Small Footprint
- > Unmanaged Operation
- > Full IEEE 802.3, 802.3u, 802.3z, and 802.3ab Compliance
- > One 10/100/1000BaseT RJ-45 Port
- > Two 1000BaseSX/LX SFP (Mini-GBIC) Ports
- > Mix-and-Match Multimode and Singlemode
- > LC Style SFP Gigabit Fiber Transceivers
- > > 2m Hours MTBF
- > RJ-45 Port Supports Full/Half Duplex Operation
- > Up to 6.0 Gb/s Maximum Throughput
- > Supports up to 1,024 MAC Addresses
- > Store-and-forward Technology
- > RJ-45 Port Auto Senses Speed and Flow Control
- > Full Wire Speed Communications
- > MDIX Auto Cable Sensing (RJ-45)
- > Hardened Metal DIN-Rail Enclosure
- > LED Link/Activity Status Indication
- > Redundant Power Inputs (10-30 VDC)

Managed Gigabit Ethernet Industrial Switch Specifications

SWITCH PROPERTIES

- Compact Size, Small Footprint
- Unmanaged Operation
- Full IEEE 802.3, 802.3u, 802.3z, and 802.3ab Compliance
- One 10/100/1000BaseT RJ-45 Port
- Two 1000BaseSX/LX SFP (Mini-GBIC) Ports
- Mix-and-Match Multimode and Singlemode
- LC Style SFP Gigabit Fiber Transceivers
- > 2m Hours MTBF
- RJ-45 Port Supports Full/Half Duplex Operation
- Up to 6.0 Gb/s Maximum Throughput
- Supports up to 1,024 MAC Addresses
- Store-and-forward Technology
- RJ-45 Port Auto Senses Speed and Flow Control
- Full Wire Speed Communications
- MDIX Auto Cable Sensing (RJ-45)
- Hardened Metal DIN-Rail Enclosure
- LED Link/Activity Status Indication
- Redundant Power Inputs (10-30 VDC)

POWER INPUT

- Input Voltage: 10-30 VDC
- Steady Input Current: 200mA@24V
- BTU/hr: 16.4@24V
- Inrush: 13Amp/0.8ms@24V

CONNECTORS

- 10/100/1000BaseT: One (1) RJ45 TX Port
- 1000BaseSX/LX SFP: Two (2) SFP LC Duplex Gigaabit Fiber Ports

NETWORK MEDIA

- 10BaseT: >Cat3 cable
- 100BaseT: >Cat5 cable
- 1000BaseT: >Cat5e cable
- 1000BaseSX Multimode: 50-62.5/125µm
- 1000BaseLX Singlemode: 7-10/125µm

RECOMMENDED WIRING CLEARANCE

- Front: 4" (10.16 cm)
- Top: 1" (2.54 cm)

SFP Gigabit Fiber Transceiver Characteristics

Fiber Length	550m for 50/125µm 275m @62.5/125µm	10km**	40km**	80km**
TX Power Min	-9.5dBm	-9.5dBm	-2dBm	0dBm
RX Sensitivity Max	-17dBm	-20dBm	-22dBm	-24dBm
Wavelength	850nm	1310nm	1310nm	1550nm
Assumed Fiber Loss	3.5 to 3.75 dB/km	.45dB/km	.35dB/km	.25dB/km

* SX Fiber Optic Cable, ** LX Fiber Optic Cable

CERTIFICATION & COMPLIANCE

- Product Safety: UL/cUL: Class I, Division 2, Groups A, B, C and D; T4 UL 508, ICE and ANSI/ISA-12.12.01-2007
- Emissions: EN 55011, ICES-003, FCC/CE (CFR 47, Part 15, Subpart B, Class A)
- Immunity: EN 61000-6-2/4, IEC 61000-4-2/3/4/5/6
- Other: ABS type approval for shipboard applications
- DNV Type Approval Certification
- RoHS Compliant
- IEEE 1613 for Electric Utility Substations
- NEMA TS1/TS2 for Traffic Control

DIMENSIONS

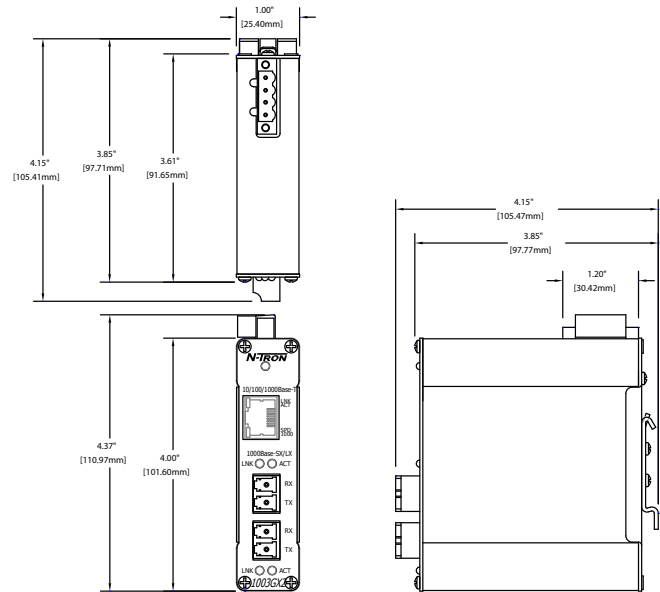

ENVIRONMENTAL

- Operating Temperature: -40°C to 85°C
- Storage Temperature: -40°C to 85°C
- Operating Humidity: 10% to 95%(Non Condensing)
- Operating Altitude: 0 to 10,000 ft.
- > 2m Hours MTBF

MECHANICAL

- Case Dimensions
- Height: 4.0" (10.2 cm)
- Width: 1.0" (2.6 cm)
- Depth: 3.7 (9.4 cm)
- Weight: 0.76 lbs. (0.27 kg)
- Mount: DIN Rail 35mm

All specifications are subject to change. Consult the company website for more information.

ORDERING GUIDE

PART NUMBER	DESCRIPTION
1003GX2-B	One 10/100/1000BaseT Port; Two 1000BaseSX/LX Ports with mix-and-match SFP Transceivers*
1003GX2-SX	One 10/100/1000BaseT Port; Two 1000BaseSX SFP Transceivers
1003GX2-LX-10	One 10/100/1000BaseT Port; Two 1000BaseLX-10 SFP Transceivers
1003GX2-LX-40	One 10/100/1000BaseT Port; Two 1000BaseLX-40 SFP Transceivers
1003GX2-LX-80	One 10/100/1000BaseT Port; Two 1000BaseLX-80 SFP Transceivers
1000-PM	Panel Mount Kit
NTPS-24-1.3	DIN-Rail Power Supply 24V@1.3 Amp
NTSFP-SX	One 1000BaseSX Multimode SFP Gigabit Transceiver (two required per unit)
NTSFP-LX-ZZ	One 1000BaseLX Singlemode SFP Gigabit Transceiver (two required per unit)

ZZ = 10, 40, or 80 for GB Singlemode SFP Transceiver

*Unit must be fully populated with **two** SFP transceivers upon shipment.



www.redlion.net

Connect. Monitor. Control.

Americas
sales@redlion.net

Asia-Pacific
asia@redlion.net

**Europe
Middle East
Africa**
europe@redlion.net

+1 (717) 767-6511

As the global experts in communication, monitoring and control for industrial automation and networking, Red Lion has been delivering innovative solutions for over forty years. Our automation, Ethernet and cellular M2M technology enables companies worldwide to gain real-time data visibility that drives productivity. Product brands include Red Lion, N-Tron and Sixnet. With headquarters in York, Pennsylvania, the company has offices across the Americas, Asia-Pacific and Europe. Red Lion is part of Spectris plc, the productivity-enhancing instrumentation and controls company. For more information, please visit www.redlion.net.