



Chipsmall Limited consists of a professional team with an average of over 10 year of expertise in the distribution of electronic components. Based in Hongkong, we have already established firm and mutual-benefit business relationships with customers from,Europe,America and south Asia,supplying obsolete and hard-to-find components to meet their specific needs.

With the principle of "Quality Parts,Customers Priority,Honest Operation,and Considerate Service",our business mainly focus on the distribution of electronic components. Line cards we deal with include Microchip,ALPS,ROHM,Xilinx,Pulse,ON,Everlight and Freescale. Main products comprise IC,Modules,Potentiometer,IC Socket,Relay,Connector.Our parts cover such applications as commercial,industrial, and automotives areas.

We are looking forward to setting up business relationship with you and hope to provide you with the best service and solution. Let us make a better world for our industry!



## Contact us

Tel: +86-755-8981 8866 Fax: +86-755-8427 6832

Email & Skype: info@chipsmall.com Web: www.chipsmall.com

Address: A1208, Overseas Decoration Building, #122 Zhenhua RD., Futian, Shenzhen, China



PRODUCT NO  
10046972-001LF

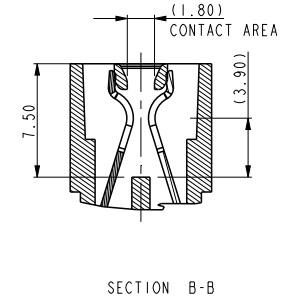
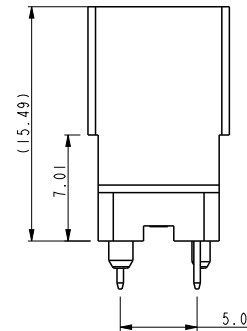
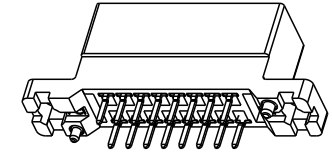
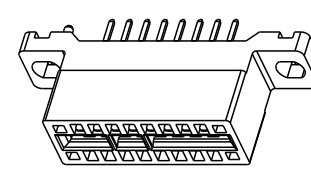
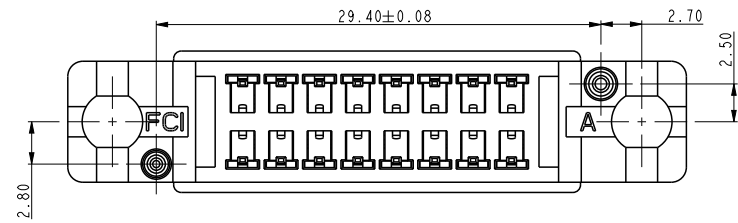
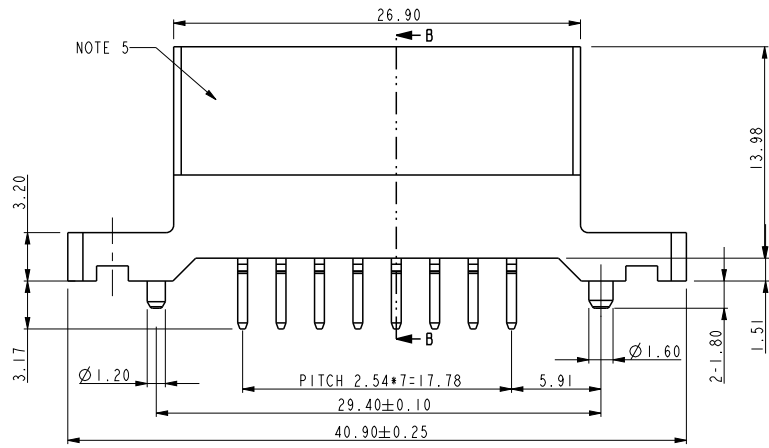
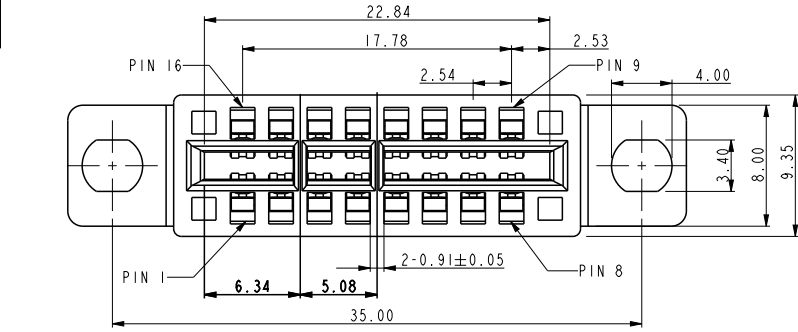

- NOTE:
- Material:  
HOUSING: HIGH TEMPERATURE THERMOPLASTIC,  
UL 94 V-0 FLAME RETARDANT.  
TERMINAL: HIGH CONDUCTIVITY COPPER ALLOY.  
PLATING SPEC AS BELOW:  
Ni 50u" UNDER PLATED.  
Au 30u" OVER CONTACT AREA. (ONE SIDE)  
Matte Tin 120u" OVER SOLDERING AREA.
  - PACKING SPEC. GS-14-937.
  - PRODUCT SPEC. GS-12-338.
  - PART NUMBER 10046972-001LF MEETS EUROPEAN UNION DIRECTIVE AND OTHER COUNTRY REGULATIONS AS DESCRIBED IN GS-22-008.  
THE HOUSING WILL WITHSTAND EXPOSURE TO 260°C PEAK TEMPERATURE FOR 10 SECONDS IN A WAVE SOLDER APPLICATION WITH A CIRCUIT BOARD.
  - PRODUCT MARKING ON HOUSING IN AREA SHOWN MEETS AFCI SPECIFICATION: GS-24-007.
  - A SYMBOL  $\triangle$  WILL BE NEXT TO ANY DIMENSION, VIEW, OR NOTE WHICH HAS BEEN MODIFIED WITH THE CURRENT DRAWING REVISION.

spec ref	*	dr	w wcdmin	2006/08/26	projection	MM	size	A4	scale	1.000
tolerance std	TOLERANCES UNLESS OTHERWISE SPECIFIED	eng	Sunny2 Liu	2016/05/05			←→	ecn no	ELX-DG-22934-1	
		chr	Terris Liu	2016/05/20					rel level	Released
		appr	Pei-Ming Zheng	2016/05/24	product family					
surface	linear	0.X	±0.5	Amphenol FCI	title	PEC VT WITH MOUNTING EARS	dwg no	10046972	rev	G
		0.XX	±0.25							
		0.XXX	±0.13							
	angular	0°	±°	cat. no.	*	Product - Customer Drw	sheet 1 of 4			

PRODUCT NO  
10046972-001LF

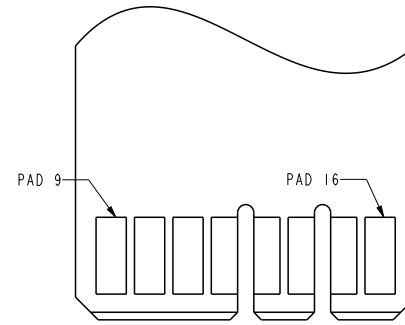
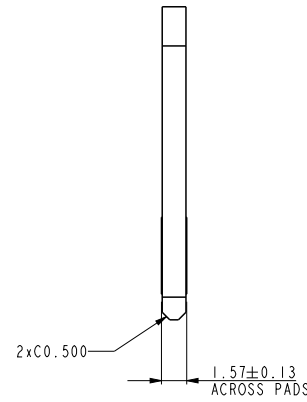
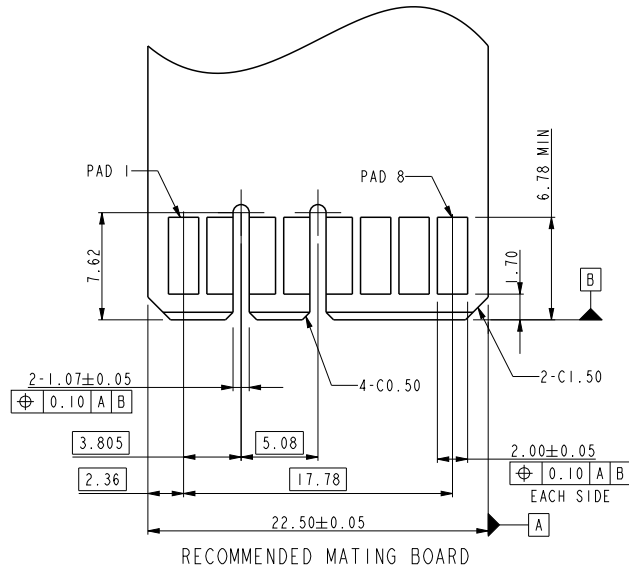

spec ref	*	dr	w wcadmin	2006/08/26	projection	MM ←→	size	A4	scale	1.000			
tolerance std	TOLERANCES UNLESS OTHERWISE SPECIFIED	eng	Sunny2 Liu	2016/05/05			ecn no	ELX-DG-22934-1					
		chr	Terris Liu	2016/05/20			product family	rel level	Released				
surface	linear	0.X	±0.5	<b>Amphenol FCI</b>	title		PEC VT WITH MOUNTING EARS		dwg no	10046972		rev	G
		0.XX	±0.25		2X8P								
		0.XXX	±0.13		cat. no.		*	Product - Customer Drw		sheet 2 of 4			
	angular	0°	±°										

A

B

C

D

PRODUCT NO  
10046972-002LF

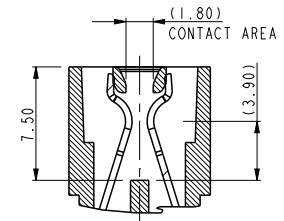
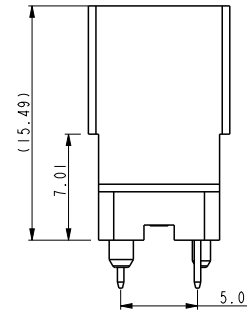
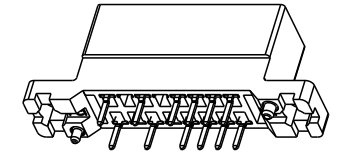
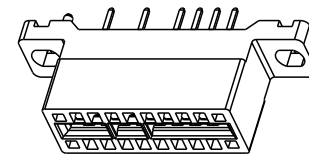
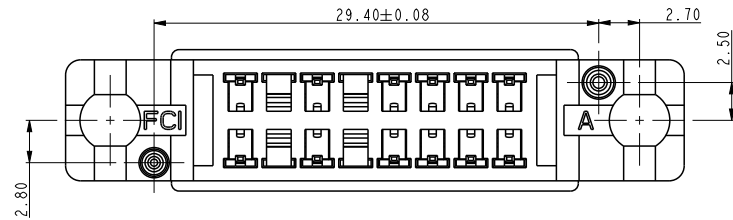
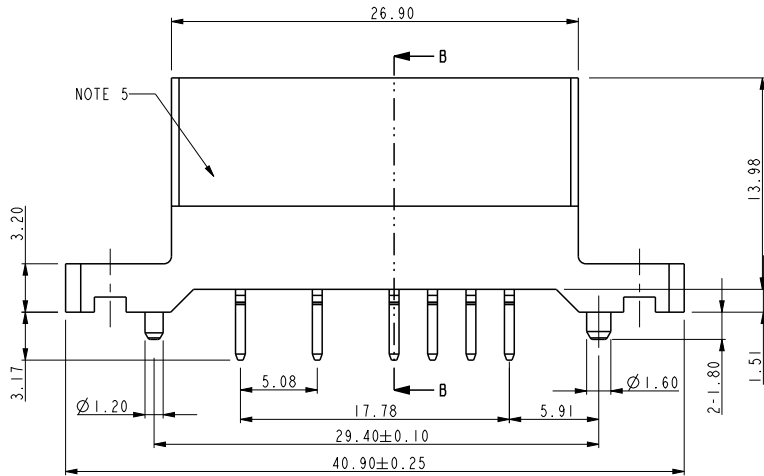
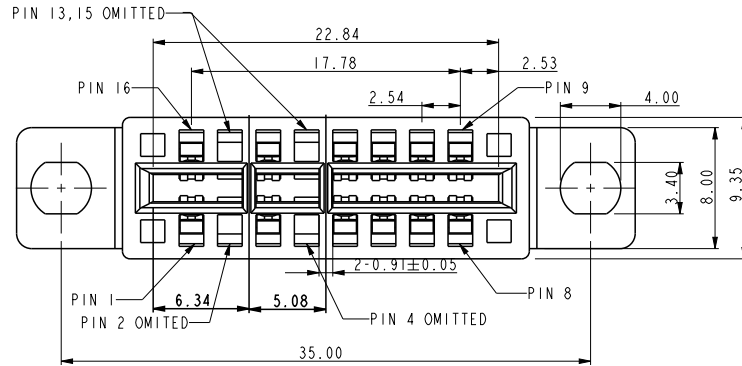

SECTION B-B

NOTE:

- Material:  
HOUSING: HIGH TEMPERATURE THERMOPLASTIC,  
UL 94 V-0 FLAME RETARDANT.  
TERMINAL: HIGH CONDUCTIVITY COPPER ALLOY.  
PLATING SPEC AS BELOW:  
Ni 50u" UNDER PLATED.  
Au 30u" OVER CONTACT AREA.(ONE SIDE)  
Matte Tin 120u" OVER SOLDERING AREA.
- PACKING SPEC. GS-14-937.
- PRODUCT SPEC. GS-12-338.
- PART NUMBER 10046972-001LF MEETS EUROPEAN UNION DIRECTIVE AND OTHER COUNTRY REGULATIONS AS DESCRIBED IN GS-22-008.  
THE HOUSING WILL WITHSTAND EXPOSURE TO 260°C PEAK TEMPERATURE FOR 10 SECONDS IN A WAVE SOLDER APPLICATION WITH A CIRCUIT BOARD.  
PRODUCT MARKING ON HOUSING IN AREA SHOWN MEETS AFCI SPECIFICATION: GS-24-007.
- A SYMBOL WILL BE NEXT TO ANY DIMENSION, VIEW, OR NOTE WHICH HAS BEEN MODIFIED WITH THE CURRENT DRAWING REVISION.

spec ref	*	dr	w wcdadmin	2006/08/26	projection	MM ←→	size	A4	scale	1.000
tolerance std	TOLERANCES UNLESS OTHERWISE SPECIFIED	eng	Sunny2 Liu	2016/05/05			ecn no	ELX-DG-22934-1		
		chr	Terris Liu	2016/05/20			rel level	Released		
surface	linear	appr	Pei-Ming Zheng	2016/05/24	product family					
	0.X	±0.5	<b>Amphenol FCI</b>	title	PEC VT WITH MOUNTING EARS	dwg no	10046972	rev	G	cat. no.
	0.XX	±0.25								
	0.XXX	±0.13								
	angular	0°	±°							
						*	Product - Customer Drw		sheet 3 of 4	

