



Chipsmall Limited consists of a professional team with an average of over 10 year of expertise in the distribution of electronic components. Based in Hongkong, we have already established firm and mutual-benefit business relationships with customers from,Europe,America and south Asia,supplying obsolete and hard-to-find components to meet their specific needs.

With the principle of “Quality Parts,Customers Priority,Honest Operation,and Considerate Service”,our business mainly focus on the distribution of electronic components. Line cards we deal with include Microchip,ALPS,ROHM,Xilinx,Pulse,ON,Everlight and Freescale. Main products comprise IC,Modules,Potentiometer,IC Socket,Relay,Connector.Our parts cover such applications as commercial,industrial, and automotives areas.

We are looking forward to setting up business relationship with you and hope to provide you with the best service and solution. Let us make a better world for our industry!



## Contact us

Tel: +86-755-8981 8866 Fax: +86-755-8427 6832

Email & Skype: info@chipsmall.com Web: www.chipsmall.com

Address: A1208, Overseas Decoration Building, #122 Zhenhua RD., Futian, Shenzhen, China



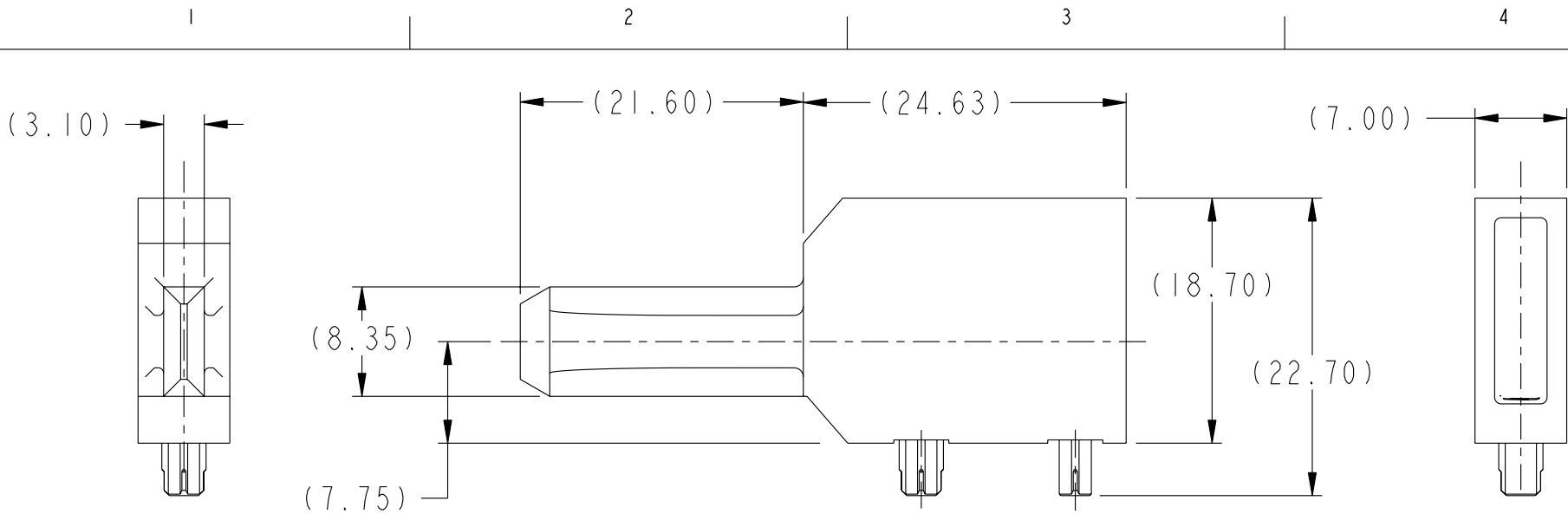

M3 x 0.5-6H  
x 3.0 DP.



Copyright FCI.

rev	ecn no	dr	date
A	S06-0398	CH	2006-12-01
-	-	-	-
-	-	-	-
-	-	-	-
-	-	-	-
-	-	-	-

www.fciconnect.com		surface 3.2 ASME Y14.5	tolerance std ASME Y14.5	projection mm
TOLERANCES UNLESS OTHERWISE SPECIFIED		0.X ±0.3	0.XX ±0.10	0.XXX ±0.050
Dr	C. H. TAN	2006-03-11	ANGULAR	LINEAR
Eng	C. H. TAN	2006-03-11	0°	±2°
Chr	C. H. TAN	2006-12-01	Product family AirMax ACCESSORIES	
Appr	JOEY NG	2006-12-01	Spec ref	
FCI			7.2mm R/A GUIDE PIN	10063141
4/5 Pr. INVERSE CO-PLANAR			CUSTOMER	Rev. A
catalog no			sheet 1 of 2	

PART NUMBER

10063141-101LF

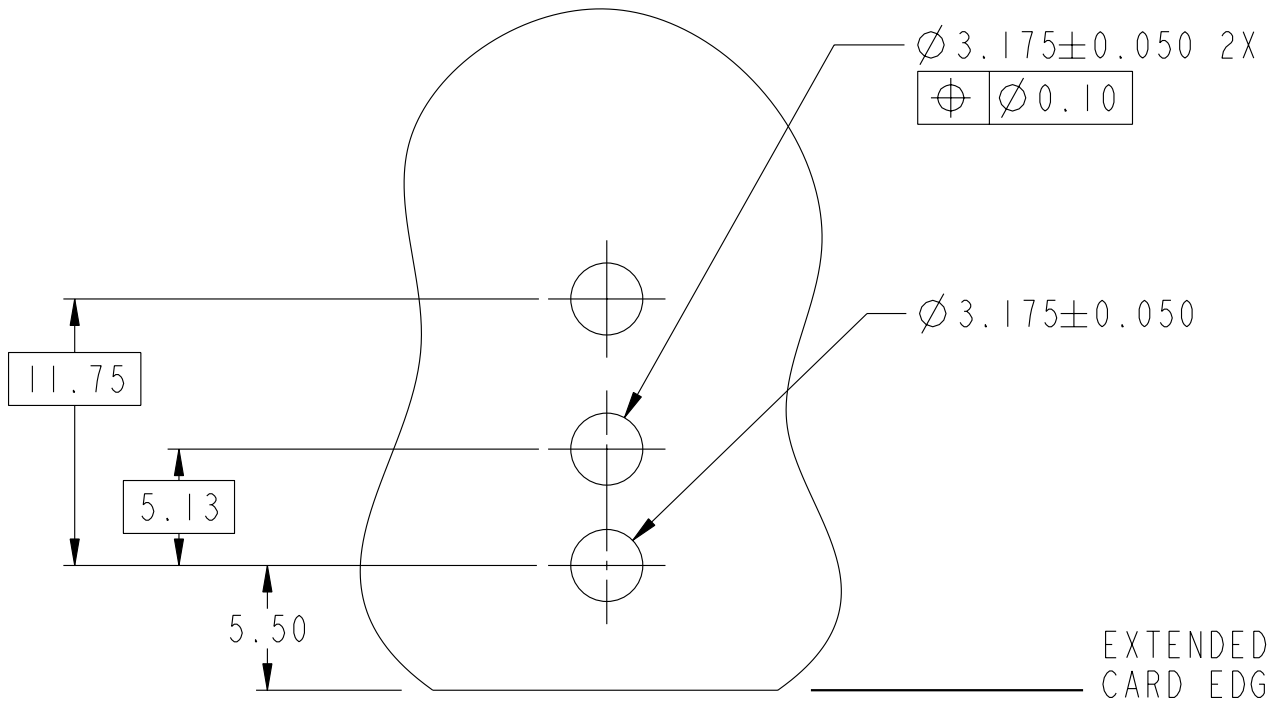

RECOMMENDED PCB LAYOUT

SCALE 3:1

SEE NOTE 3, 4, & 5

NOTES:

- ① MATERIAL: ZINC ALLOY.
- ② FINISH: ZINC YELLOW CHROMATE.
- ③ APPLICATION SPECIFICATION: GS-20-045.
- ④ REFER TO CUSTOMER DRAWING 10035911 FOR INFORMATION REGARDING PCB LAYOUT OF POWER AND GUIDE MODULES RELATIVE TO SIGNAL MODULES.
- ⑤ RIGHT ANGLE PIN MODULE HAS THE SAME PCB FOOTPRINT AS THE RIGHT ANGLE GUIDE SOCKET.
- 6 THIS PRODUCT MEETS EUROPEAN UNION DIRECTIVES AND OTHER COUNTRY REGULATIONS AS DESCRIBED IN GS-22-008.
- 7 PACKAGING MEETS GS-14-920 LEAD FREE LABELING SPECIFICATION.



Copyright FCI.



title	7.2mm R/A GUIDE PIN
	4/5 Pr. INVERSE CO-PLANAR
catalog no	-

dwg no	10063141
--------	----------

Rev.	A
------	---

CUSTOMER	sheet 2 of 2
----------	--------------