



Chipsmall Limited consists of a professional team with an average of over 10 year of expertise in the distribution of electronic components. Based in Hongkong, we have already established firm and mutual-benefit business relationships with customers from,Europe,America and south Asia,supplying obsolete and hard-to-find components to meet their specific needs.

With the principle of “Quality Parts,Customers Priority,Honest Operation,and Considerate Service”,our business mainly focus on the distribution of electronic components. Line cards we deal with include Microchip,ALPS,ROHM,Xilinx,Pulse,ON,Everlight and Freescale. Main products comprise IC,Modules,Potentiometer,IC Socket,Relay,Connector.Our parts cover such applications as commercial,industrial, and automotives areas.

We are looking forward to setting up business relationship with you and hope to provide you with the best service and solution. Let us make a better world for our industry!



Contact us

Tel: +86-755-8981 8866 Fax: +86-755-8427 6832

Email & Skype: info@chipsmall.com Web: www.chipsmall.com

Address: A1208, Overseas Decoration Building, #122 Zhenhua RD., Futian, Shenzhen, China



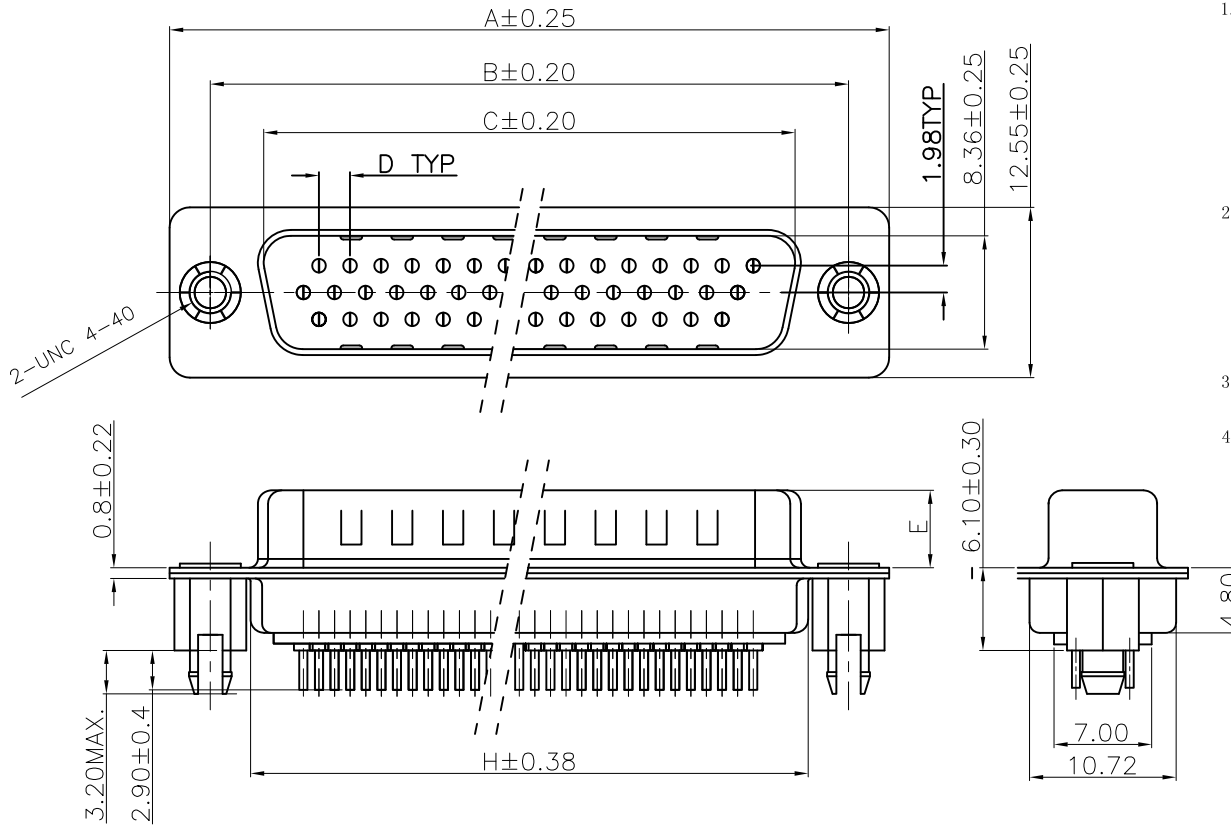

REMARK:

1. CHARACTERISTICS:

RATED VOLTAGE: 250V
 RATED CURRENT: 2.5AMP
 CONTACT RESISTANCE: 25mohms MAX. INITIAL,
 40mohms MAX. AFTER.
 INSULATION RESISTANCE: 5000mohms MIN. at 500V DC
 DIELECTRIC STRENGTH: 750VRMS
 OPERATING TEMPERATURE RANGE: -55° C~105° C
 INSERTION/EXTRACTION FORCE PER CONTACT: 5N Max./0.2N Min..
 MATING/UNMATING CYCLES: 200MATINGS MIN FOR GOLD-FLASH
 500MATINGS MIN FOR 30u" GOLD.

2. MATERIAL:

INSULATORS: THERMOPLASTIC G.F(UL94V-0) BLACK
 CONTACTS: COPPER ALLOY, GOLD(G/F or 30u") TOP OVER CONTACT
 AREA, 100u" Min MATTE TIN TOP OVER SOLDER AREA,
 50u" Min NICKEL UNDER PLATE.
 SHELL: CARBON STEEL, 100u" Min NICKEL TOP OVER,
 50u" Min COPPER UNDER PLATE.
 HARPOON: COPPER ALLOY, 100u" Min MATTE TIN PLATED

3. Type H Insulator will withstand exposure to 260° C peak temperature for 10 seconds maximum in a wave soldering application

4. PART NUMBER DESCRIPTION:

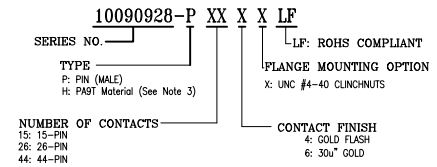

POS.	PART NO.	THREAD TYPE
15	10090928-P15*XLF	UNC #4-40
26	10090928-P26*XLF	UNC #4-40
44	10090928-P44*XLF	UNC #4-40

POS.	A	B	C	D	E	H
15	30.81	24.99	16.92	2.29	5.90 ^{+0.25} ₀	19.10
26	39.24	33.32	25.25	2.29	5.90 ^{+0.25} ₀	27.75
44	53.04	47.04	38.96	2.29	5.70 ^{+0.25} ₀	41.30

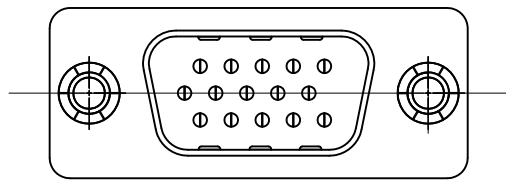

FOR 15P

mat'l. code		surface ISO 1302 ✓		tolerance ISO 406 ISO 1101		projection mm		product family D-SUB	
ltr		ecn no		dr		date		title	
E		ELX-1-20972		AB		2015/05/30		HD D-SUB MALE STRAIGHT	
F		ELX-1-25813		GREGAR		2016/10/31			
G		ELX-1-27111		MP		2017/05/27			
sheet		revision		G		G		G	
index		sheet		1		2		3	

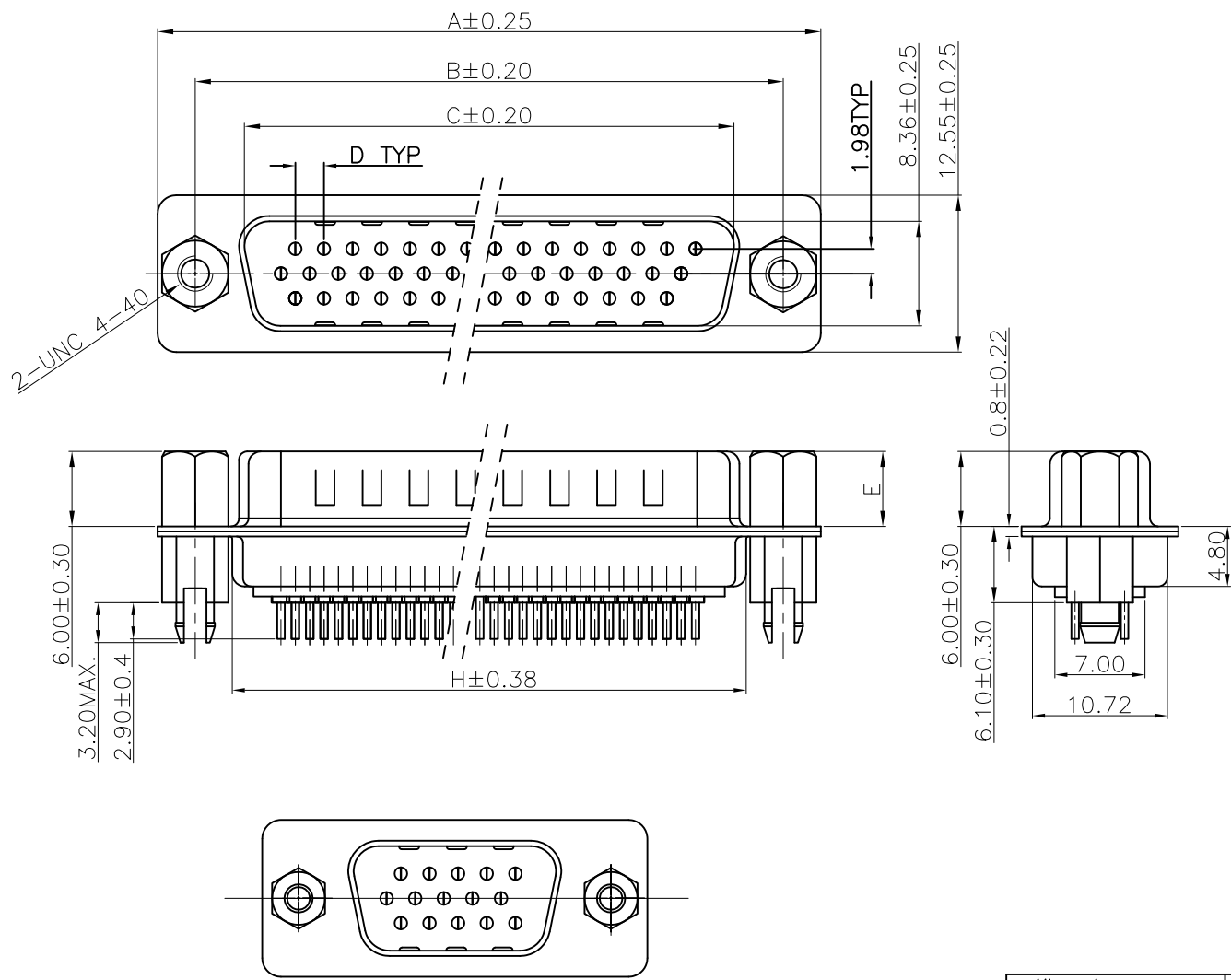

REMARK:
 1. CHARACTERISTICS:
 RATED VOLTAGE: 250V
 RATED CURRENT: 2.5AMP
 CONTACT RESISTANCE: 25mohms MAX. INITIAL,
 40mohms MAX. AFTER.
 INSULATION RESISTANCE: 5000Mohms MIN. at 500V DC
 DIELECTRIC STRENGTH: 750VRMS
 OPERATING TEMPERATURE RANGE: -55° C~105° C
 INSERTION/EXTRACTION FORCE PER CONTACT: 5N Max./0.2N Min.
 MATING/UNMATING CYCLES: 200MATINGS MIN FOR GOLD-FLASH
 500MATINGS MIN FOR 30u" GOLD.
 2. MATERIAL:
 INSULATORS: THERMOPLASTIC G.F(UL94V-0) BLACK
 CONTACTS: COPPER ALLOY, GOLD(G/F or 30u") TOP OVER CONTACT
 AREA, 100u" Min MATTE TIN TOP OVER SOLDER AREA,
 50u" Min NICKEL UNDER PLATE.
 SHELL: CARBON STEEL, 100u" Min NICKEL TOP OVER,
 50u" Min COPPER UNDER PLATE.
 HARPOON: COPPER ALLOY, 100u" Min MATTE TIN PLATED.
 NUT: COPPER ALLOY, 50u" Min NICKEL PLATED.
 3. Type H Insulator will withstand exposure to 260° C peak temperature
 for 10 seconds maximum in a wave soldering application
 4. PART NUMBER DESCRIPTION:

10090928-P XX X V LF
 SERIES NO. LF: ROHS COMPLIANT
 TYPE PLANGE MOUNTING OPTION
 P: PIN (MALE) V: UNC #4-40 SCREWLOCKS
 H: PART Material (See Note 3)
 NUMBER OF CONTACTS CONTACT FINISH
 15: 15-PIN 4: GOLD FLASH
 26: 26-PIN 6: 30u" GOLD
 44: 44-PIN

POS.	PART NO.
15	10090928-P15*VLF
26	10090928-P26*VLF
44	10090928-P44*VLF

POS.	A	B	C	D	E	H
15	30.81	24.99	16.92	2.29	5.90 ^{+0.25}	19.10
26	39.24	33.32	25.25	2.29	5.90 ^{+0.25}	27.75
44	53.04	47.04	38.96	2.29	5.70 ^{+0.25}	41.30

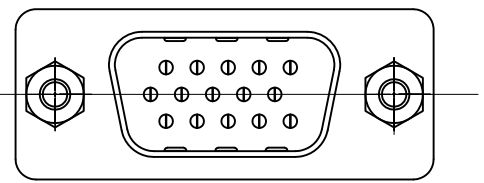

mat'l. code	surface ISO 1302	tolerance ISO 406 ISO 1101	projection mm	product family D-SUB
ltr	ecn no	dr	date	title
g				HD D-SUB MALE STRAIGHT
		angles	0°±2'	scale N.T.S.
		dr	JASON HSU 2009/10/12	dwg no
		enr	MITHUN PAUL 2016/10/31	sheet 2 of 3
		chr	GREGAR MATHEW 2016/10/31	10090928
		app	BIJU K PAUL 2016/10/31	type Product Customer Drawing
sheet index	revision sheet			

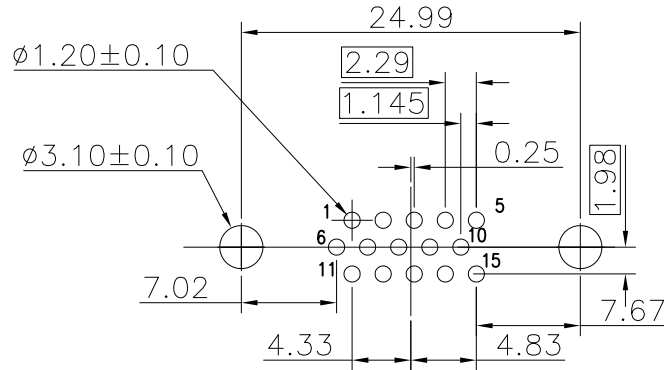

P.C.B LAYOUT (FOR 15P)

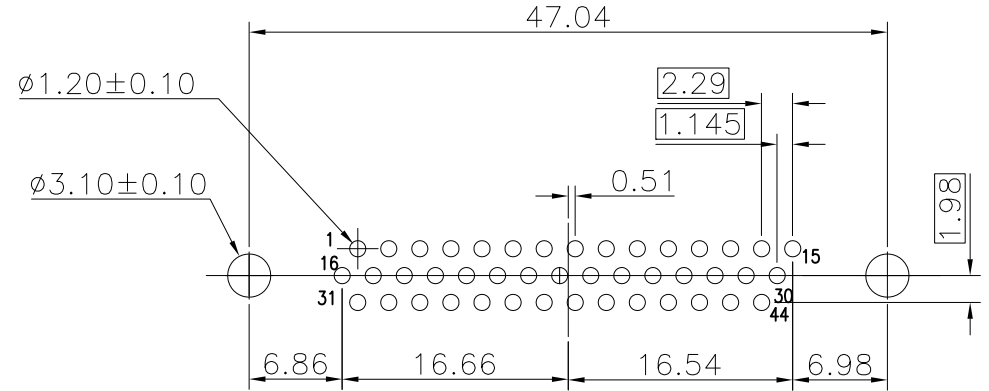

P.C.B LAYOUT (FOR 44P)

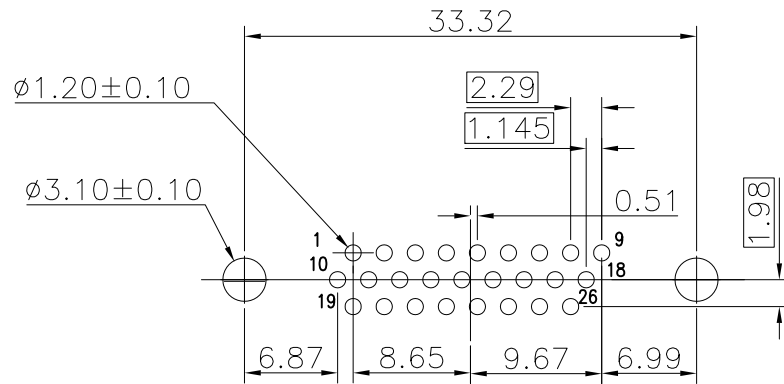

P.C.B LAYOUT (FOR 26P)

mat'l. code		surface ISO 1302 <input checked="" type="checkbox"/> ISO 406 ISO 1101		tolerance ISO 406 ISO 1101		projection 		product family D-SUB	
ltr		ecn no		dr		date		title	
g								HD D-SUB MALE STRAIGHT	
		angles		tolerances unless otherwise specified		mm		dwg no	
		0°±2'		.00±0.25		scale N.T.S.		sheet 3 of 3 size	
		dr		2009/10/12		Amphenol FCi		10090928	
		enr		2016/10/31				A4	
		chr		2016/10/31				type	
		app		2016/10/31				Product Customer Drawing	
sheet index		revision sheet							