



Chipsmall Limited consists of a professional team with an average of over 10 year of expertise in the distribution of electronic components. Based in Hongkong, we have already established firm and mutual-benefit business relationships with customers from,Europe,America and south Asia,supplying obsolete and hard-to-find components to meet their specific needs.

With the principle of “Quality Parts,Customers Priority,Honest Operation,and Considerate Service”,our business mainly focus on the distribution of electronic components. Line cards we deal with include Microchip,ALPS,ROHM,Xilinx,Pulse,ON,Everlight and Freescale. Main products comprise IC,Modules,Potentiometer,IC Socket,Relay,Connector.Our parts cover such applications as commercial,industrial, and automotives areas.

We are looking forward to setting up business relationship with you and hope to provide you with the best service and solution. Let us make a better world for our industry!



Contact us

Tel: +86-755-8981 8866 Fax: +86-755-8427 6832

Email & Skype: info@chipsmall.com Web: www.chipsmall.com

Address: A1208, Overseas Decoration Building, #122 Zhenhua RD., Futian, Shenzhen, China





All rights strictly reserved. Reproduction or issue to third parties in any form whatever is not permitted without written authority from the proprietor. Property of FCI. Copyright FCI.

Tous droits strictement réservés. Reproduction ou communication a des tiers interdite sous quelque forme que ce soit sans autorisation écrite du propriétaire. Propriété de c FCI. Droits de reproduction FCI.

1 | 2

3 |

4

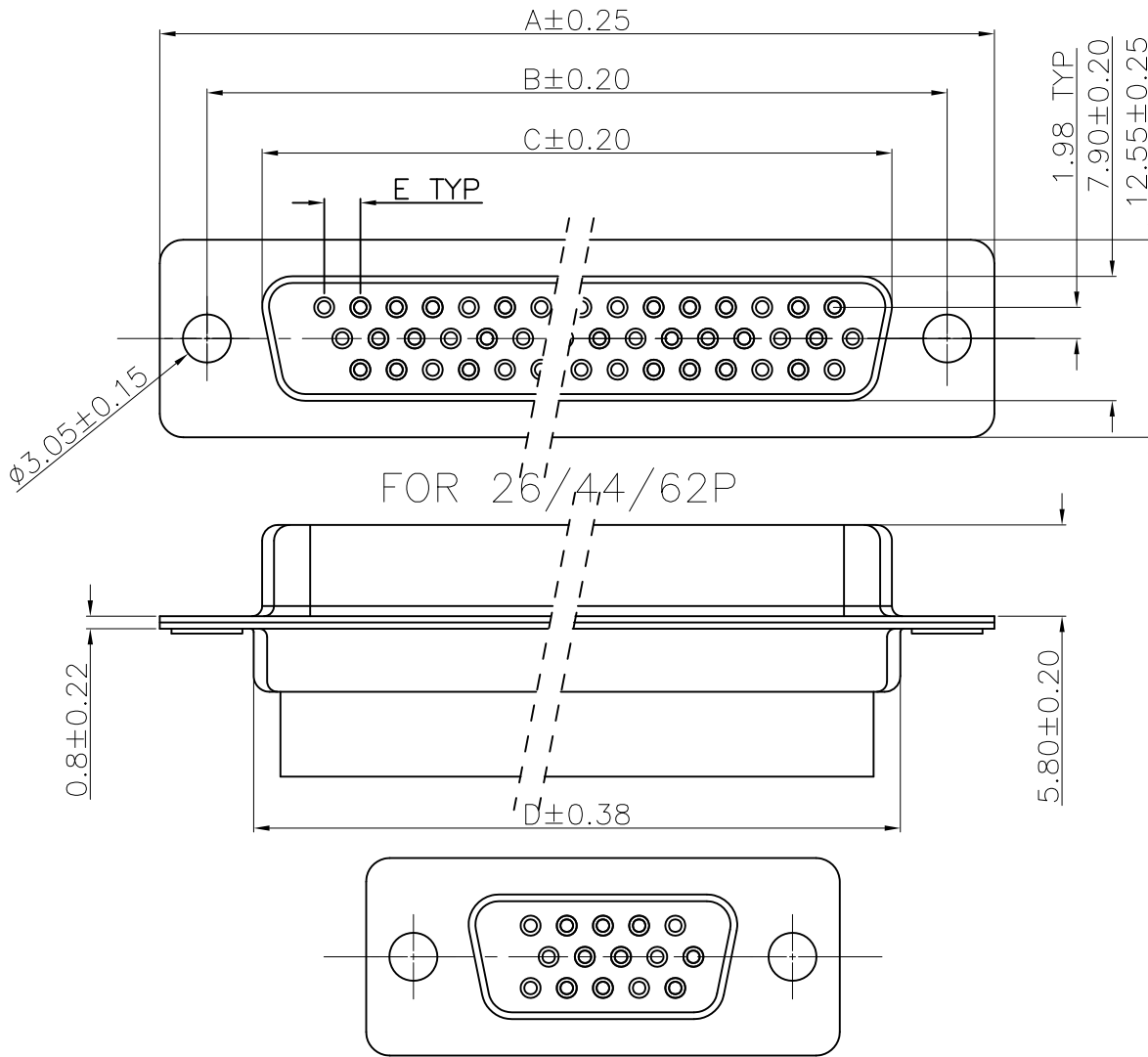

REMARK:

- CHARACTERISTICS:
OPERATING TEMPERATURE RANGE: -55° C~105° C
- MATERIAL:
INSULATORS: THERMOPLASTIC G.F(UL94V-0) BLACK
SHELL: CARBON STEEL, 100u" Min NICKEL TIN TOP OVER,
50u" Min COPPER UNDER PLATE.
STOPPER: CARBON STEEL.

3. PART NUMBER DESCRIPTION: 10090931-S XX X X LF

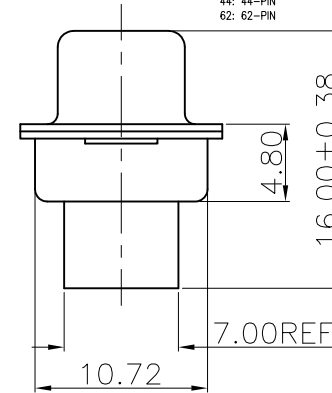
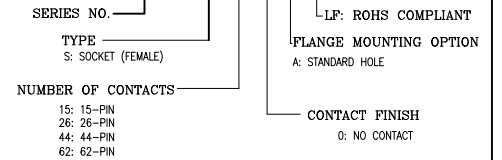

POS.	PART NO.	A	B	C	D	E
15	10090931-S150ALF	30.81	24.99	16.33	19.10	2.29
26	10090931-S260ALF	39.24	33.32	24.66	27.75	2.29
44	10090931-S440ALF	53.04	47.04	38.38	41.30	2.29
62	10090931-S620ALF	69.32	63.50	54.84	57.40	2.41

mat'l. code				tolerances unless otherwise specified				CUSTOMER COPY		FCI www.fciconnect.com	
ltr	ecn no	dr	date	linear	.X ± 0.38		projection	title			
A	T09-1157	J.H	12/10/09		.XX ± 0.25			HDEC FEMALE CRIMPING			
					.XXX ± 0.10						
				angles	0° ± 2°		MM		product family D-SUB		code TWN
				dr	JASON HSU	12/10/09	scale		size		sheet
				enr	JASON HSU	12/10/09	1:1		10090931		1 of 2
				chr	GARY HSIEH	12/10/09					
				appd	JOSEPH HSIA	12/10/09					
sheet index	revision sheet	A	A								
		1	2								

1 | 2

3 |

4

Tous droits strictement réservés. Reproduction ou communication a des tiers interdite sous quelque forme que ce soit sans autorisation écrite du propriétaire. Propriete de c FCI. Droits de reproduction FCI.



All rights strictly reserved. Reproduction or issue to third parties in any form whatever is not permitted without written authority from the proprietor. Property of FCI. Copyright FCI.

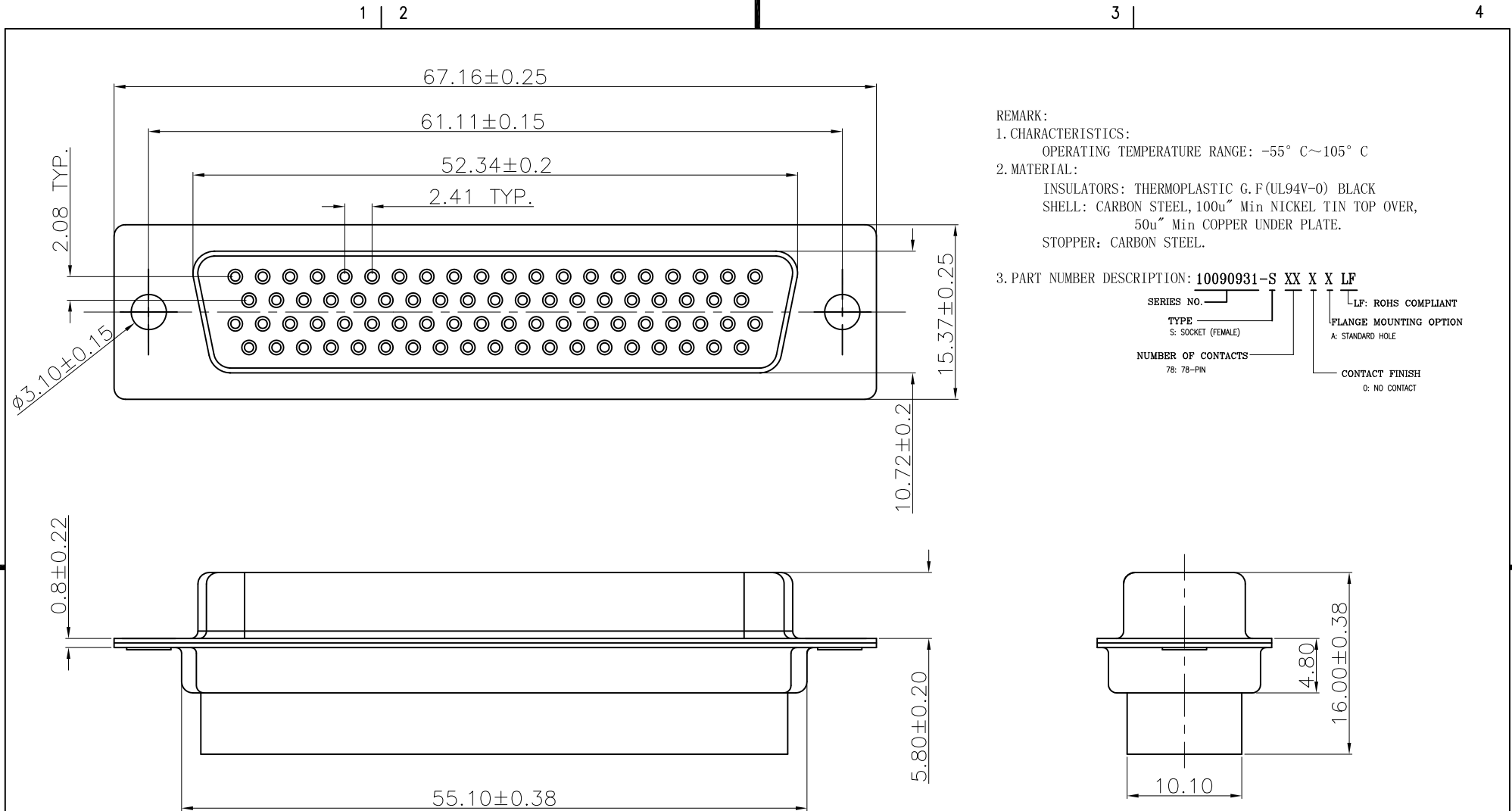

REMARK:

- CHARACTERISTICS:
OPERATING TEMPERATURE RANGE: $-55^{\circ}C \sim 105^{\circ}C$
- MATERIAL:
INSULATORS: THERMOPLASTIC G.F(UL94V-0) BLACK
SHELL: CARBON STEEL, 100u" Min NICKEL TIN TOP OVER,
50u" Min COPPER UNDER PLATE.
STOPPER: CARBON STEEL.

3. PART NUMBER DESCRIPTION: **10090931-S XX X X LF**

SERIES NO. [] LF: ROHS COMPLIANT
 TYPE: [] FLANGE MOUNTING OPTION
 S: SOCKET (FEMALE) A: STANDARD HOLE
 NUMBER OF CONTACTS: [] CONTACT FINISH
 78: 78-PIN 0: NO CONTACT

PART NO.: 10090770-S780ALF

mat'l. code				tolerances unless otherwise specified			CUSTOMER COPY		FCI www.fciconnect.com		
ltr	ecn no	dr	date	linear	.X ± 0.38	projection	title				
A					.XX ± 0.25			HDEC 78P FEMALE CRIMPING			
					.XXX ± 0.10			product family D-SUB code TWN			
				angles	0' $\pm 2'$	MM	size dwg no		sheet 2 of 2		
				dr	JASON HSU 12/10/09	scale	A4	10090931			
				enr	JASON HSU 12/10/09						
				chr	GARY HSIEH 12/10/09						
				appd	JOSEPH HSIA 12/10/09						
sheet index	revision sheet										