



Chipsmall Limited consists of a professional team with an average of over 10 year of expertise in the distribution of electronic components. Based in Hongkong, we have already established firm and mutual-benefit business relationships with customers from,Europe,America and south Asia,supplying obsolete and hard-to-find components to meet their specific needs.

With the principle of “Quality Parts,Customers Priority,Honest Operation,and Considerate Service”,our business mainly focus on the distribution of electronic components. Line cards we deal with include Microchip,ALPS,ROHM,Xilinx,Pulse,ON,Everlight and Freescale. Main products comprise IC,Modules,Potentiometer,IC Socket,Relay,Connector.Our parts cover such applications as commercial,industrial, and automotives areas.

We are looking forward to setting up business relationship with you and hope to provide you with the best service and solution. Let us make a better world for our industry!



## Contact us

Tel: +86-755-8981 8866 Fax: +86-755-8427 6832

Email & Skype: info@chipsmall.com Web: www.chipsmall.com

Address: A1208, Overseas Decoration Building, #122 Zhenhua RD., Futian, Shenzhen, China



REV.	EQV. NO.	MODIFY. CONTENT	DATE
X1		新增規格	3/16/06
X2		更改磁盤電線規格	7/27/06
A	ES.D0003.003	暫行版轉正式版	3/17/07

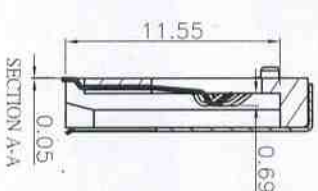
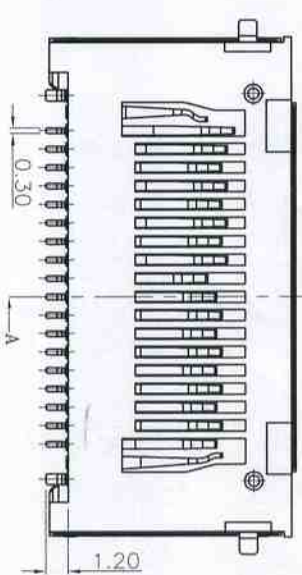
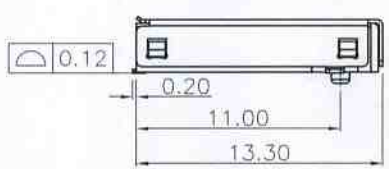
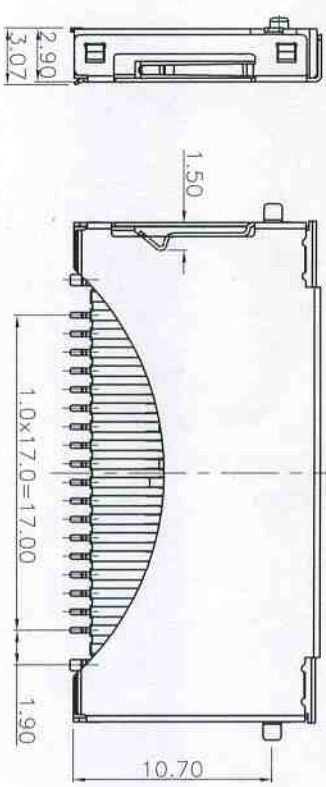
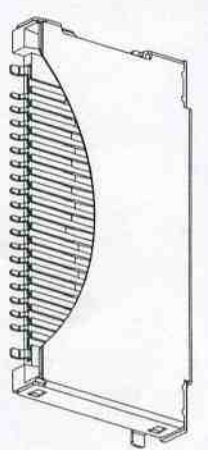
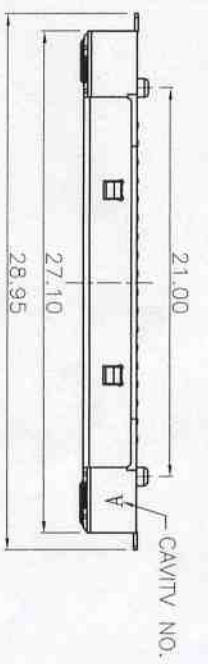

XD DEFINITION

PN NO.	FUNCTION
1/9	CMO/CARD DETECT
2	REMOV/RETRY
3	READ ENABLE
4	CARD ENABLE
5	COMMAND LATCH ENABLE
6	ADDRESS LATCH ENABLE
7	WRITE ENABLE
8	WRITE PROTECT
9	CMO
10	DATA0
11	DATA1
12	DATA2
13	DATA3
14	DATA4
15	DATA5
16	DATA6
17	DATA7
18/20	VCC



THE PART NUMBER:  
101-00158-\*\*\*

- 29 功能區鍍金1u", 錫腳鍍亮地鍍至少160u"
- 30 功能區鍍金3u", 錫腳鍍亮地鍍至少160u"
- 31 功能區鍍金5u", 錫腳鍍亮地鍍至少160u"
- 32 功能區鍍金10u", 錫腳鍍亮地鍍至少160u"
- 33 功能區鍍金15u", 錫腳鍍亮地鍍至少160u"
- 34 功能區鍍金30u", 錫腳鍍亮地鍍至少160u"
- 64 功能區鍍金1u", 錫腳鍍亮地鍍至少160u"
- 65 功能區鍍金1u", 錫腳鍍亮地鍍至少160u"
- 66 功能區鍍金5u", 錫腳鍍亮地鍍至少160u"
- 67 功能區鍍金10u", 錫腳鍍亮地鍍至少160u"
- 68 功能區鍍金15u", 錫腳鍍亮地鍍至少160u"
- 69 功能區鍍金30u", 錫腳鍍亮地鍍至少160u"

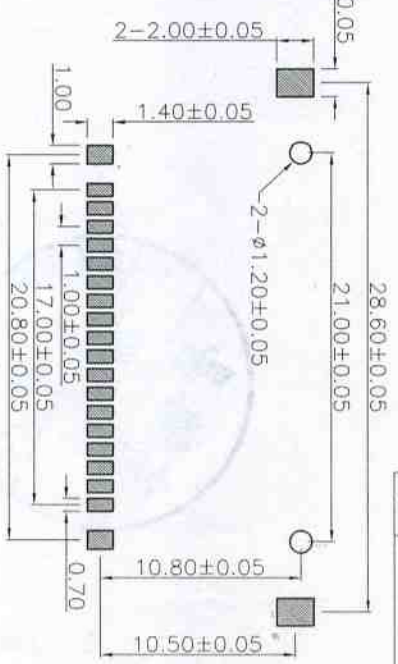

MATERIALS & PLATINGS TABLE

ITEM	DESCRIPTION	QTY	MATERIAL	FINISH
③	SHELL	1	STAINLESS STEEL	301-00857-10
②	TER	1	PHOSPHER	301-00858-***
①	HOUSING	1	LOP	201-00194-02

- NOTE:
- 1.0 MECHANICAL CHARACTERISTICS
- 2.1 Insertion Force: 9.8 N (MAX)
  - 2.2 Extroction Force: 1.47 N (MIN)
  - 2.3 Mating cycle: 10000 cycles
- 2.0 ELECTRICAL CHARACTERISTICS
- 3.1 Current rating : 0.5 A
  - 3.2 Operating voltage : 3.3V
  - 3.3 Contact resistance: 40m ohms max.
  - 3.4 Insulation resistance: 1000M ohms min. at 500 VDC
  - 3.5 Dielectric withstanding voltage: 250 VAC/1minute
  - 3.6 Operating Temperature: -0°C~+55°C
  - 3.7 Storage Temperature: -20°C~+65°C
  - 3.8 Operation/Storage humidity: 95% or less

GENERAL	TOLERANCE	FILE NO.	PART NO.	DRAWN	LZH	MATERIAL	SCALE	NO SCALE
x.±0.50	x.±1.5*	101-00158	101-00158-***					
x.±0.38	x.±2*	REV. A	TITLE XD NO PUSH CONN.-I	CHECKED	楊奎奎 3/16/07	DATE 3/17/07	UNIT	mm
xx±0.25	xx±1*	SIZE A4	SHEET 1/1	APPROVED	Jeffrey SM	Shouh Min Industry (ShenZhen)CO.,LTD		