



Chipsmall Limited consists of a professional team with an average of over 10 year of expertise in the distribution of electronic components. Based in Hongkong, we have already established firm and mutual-benefit business relationships with customers from,Europe,America and south Asia,supplying obsolete and hard-to-find components to meet their specific needs.

With the principle of “Quality Parts,Customers Priority,Honest Operation,and Considerate Service”,our business mainly focus on the distribution of electronic components. Line cards we deal with include Microchip,ALPS,ROHM,Xilinx,Pulse,ON,Everlight and Freescale. Main products comprise IC,Modules,Potentiometer,IC Socket,Relay,Connector.Our parts cover such applications as commercial,industrial, and automotives areas.

We are looking forward to setting up business relationship with you and hope to provide you with the best service and solution. Let us make a better world for our industry!



Contact us

Tel: +86-755-8981 8866 Fax: +86-755-8427 6832

Email & Skype: info@chipsmall.com Web: www.chipsmall.com

Address: A1208, Overseas Decoration Building, #122 Zhenhua RD., Futian, Shenzhen, China



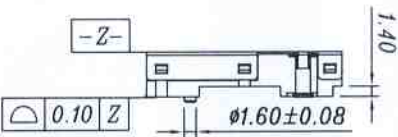
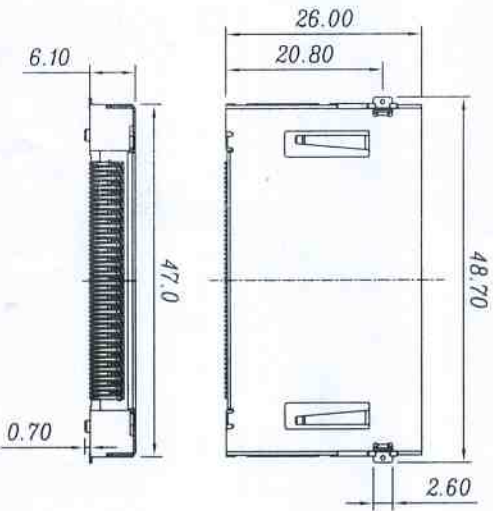
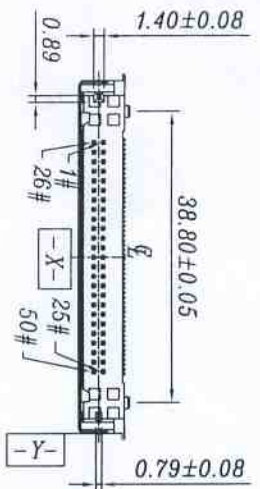

Pin Type	interface Dim L	Pin No.
detect	3.50MM	25, 26
General	4.25MM	all other pins
power	5.00MM	1,13,38,50

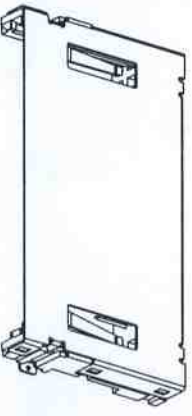
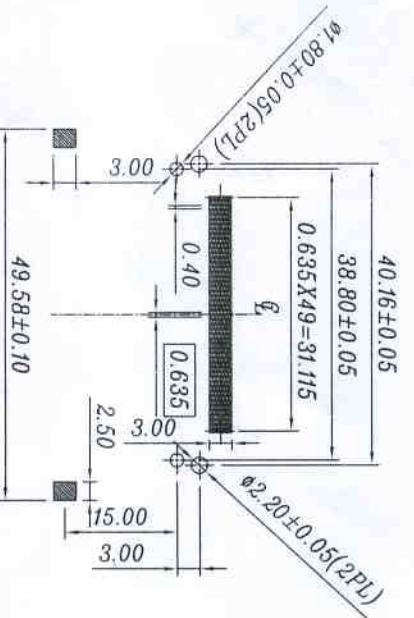
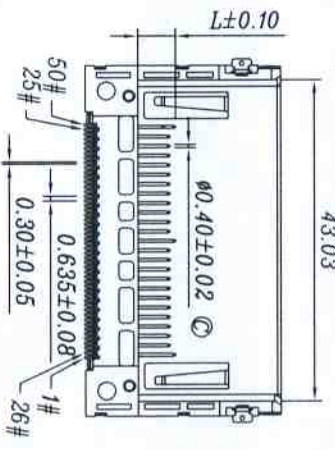

- Notes:
1. All Dimensions are in Millimeters.
 2. Material and Finish:
 - Housing: ICP Black UL94-0
 - Contact: Copper alloy
 - Pinish: Selective Gold 1-30μ" on contact area, Tin 160μ" on solder tail, underplated Nickel 50μ" Min.
 - Ground: Copper alloy
 - Pinish: All plated Tin 160μ", underplated Nickel 50μ" Min.
 - Shell: Stainless steel
 3. Operation voltage: 100 VAC max.
 4. Current rating : 1 Amps max.
 5. Contact resistance: 40m ohms max.
 6. Insulation resistance: 1000M ohms min. 500 VDC
 7. Dielectric withstanding voltage: 500 VAC / minute
 8. Operating Temperature: -20°C to +60°C
 9. Storage Temperature: -40°C to +70°C
 10. Total Mating Force : 28.8N (MAX) at 25 mm/minute
 11. Total Unmating Force: 4.9N (MIN) and 24.5N(MAX) at 25 mm/minute
 12. Single Pin Retention Force: 9.8N(MIN) at 25 mm/minute

PART NO.
10100265 **

- | Contact | Material | Finish |
|-----------------|----------|-----------------------|
| 64: Contact: 1 | gold | solder tail: 160μ Tin |
| 65: Contact: 3 | gold | solder tail: 160μ Tin |
| 66: Contact: 5 | gold | solder tail: 160μ Tin |
| 67: Contact: 10 | gold | solder tail: 160μ Tin |
| 68: Contact: 15 | gold | solder tail: 160μ Tin |
| 69: Contact: 30 | gold | solder tail: 160μ Tin |

RECOMMENDED P.C.B LAYOUT (TOP VIEW)

GENERAL	TOLERANCE	FILE NO.	PART NO.	DRAWN	MATERIAL
X ± 0.50	X ± 5°	10100265	10100265**	Iris. He	DATE: 2009/9/7
X ± 0.38	X ± 2°	C	CP Conn - 47/26.00 (40 Pin)	Checked: Henry Wu	SCALE: 1:1
.XX ± 0.25	.XX ± 1°	A4	38.80 (Housing) 40 (Shell)	Approved: Ming Shao	UNIT: mm
			1/1		Amphenol Shouhmin Industry

REV.	ECN NO.	MODIFY CONTENT	DATE
A	ES.D0609.114	ADD SPEC	9/28/2006
B	ES.D0712.010	copper shell changed	12/3/2007
C	ES.D0909.011	add Material and Finished Note	9/7/2009