



Chipsmall Limited consists of a professional team with an average of over 10 year of expertise in the distribution of electronic components. Based in Hongkong, we have already established firm and mutual-benefit business relationships with customers from,Europe,America and south Asia,supplying obsolete and hard-to-find components to meet their specific needs.

With the principle of "Quality Parts,Customers Priority,Honest Operation,and Considerate Service",our business mainly focus on the distribution of electronic components. Line cards we deal with include Microchip,ALPS,ROHM,Xilinx,Pulse,ON,Everlight and Freescale. Main products comprise IC,Modules,Potentiometer,IC Socket,Relay,Connector.Our parts cover such applications as commercial,industrial, and automotives areas.

We are looking forward to setting up business relationship with you and hope to provide you with the best service and solution. Let us make a better world for our industry!



Contact us

Tel: +86-755-8981 8866 Fax: +86-755-8427 6832

Email & Skype: info@chipsmall.com Web: www.chipsmall.com

Address: A1208, Overseas Decoration Building, #122 Zhenhua RD., Futian, Shenzhen, China



A

B

C

D

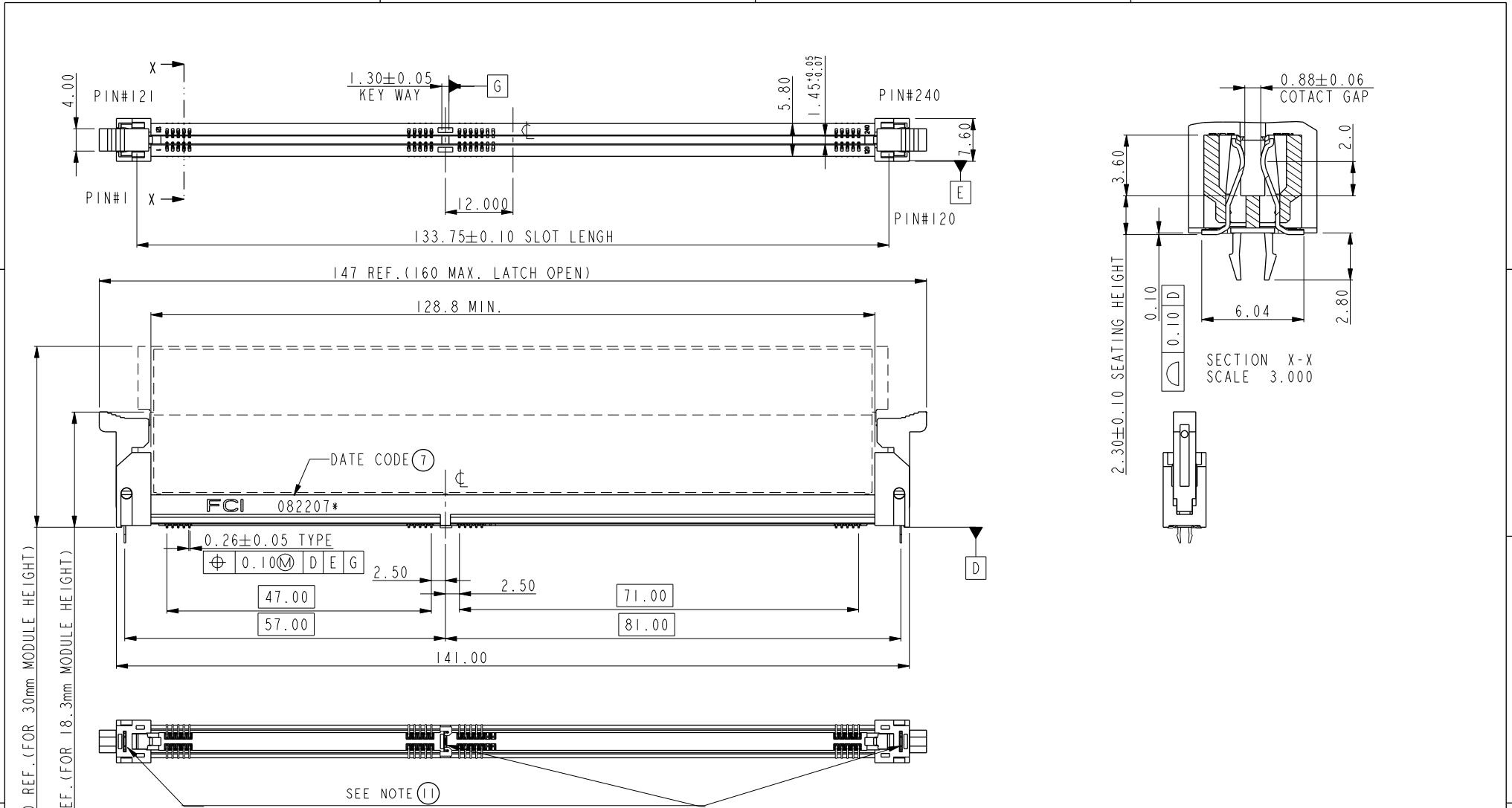

32.20 REF. (FOR 30mm MODULE HEIGHT)

20.50 REF. (FOR 18.3mm MODULE HEIGHT)

spec ref *		dr	Rick Bian	2010/07/04	projection 	MM 	size	A4	scale	1.000
tolerance std	ASME Y14.5	eng	Jeny Ren	2016/12/01			ecn no	ELX-DG-25425-1		
		chr	-	-				rel level	Released	
TOLERANCES UNLESS OTHERWISE SPECIFIED		appr	Nickor Zuo	2016/12/02	product family		rev		D	
surface		linear	0.X	± 0.50	Amphenol FCI	title	SMT DDRIII SOCKET ASS'Y		dwg no	10109498
			0.XX	± 0.30			DDRIII 240P RDIMM SOCKET(FOR CISCO)			
			0.XXX	± 0.15			www.fci.com			
ASME Y14.5	angular	0°	$\pm 2^\circ$	cat. no.	*	Product - Customer Drw		sheet 1 of 4		

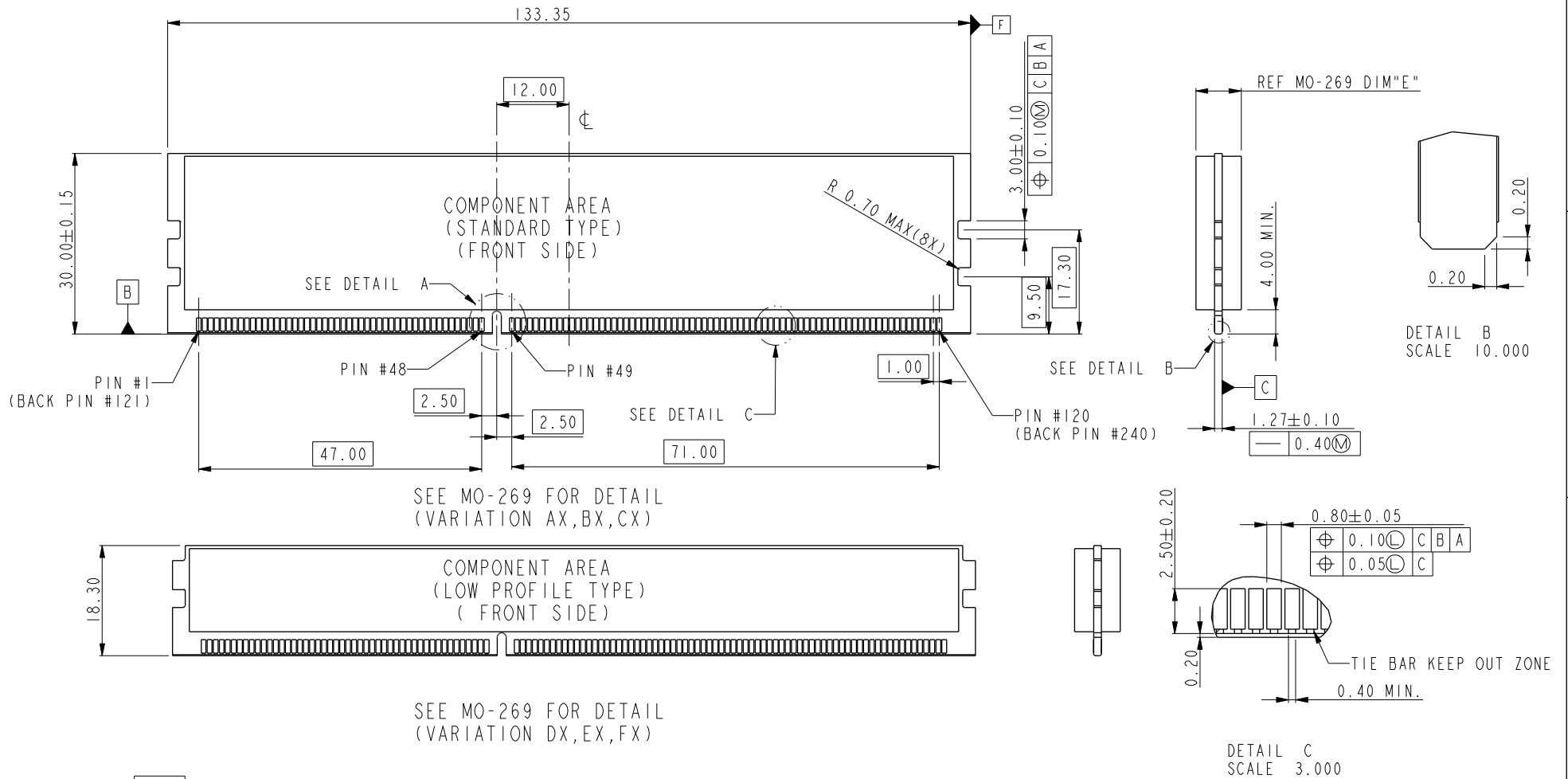

dr	Rick Bian	2010/07/04	projection	MM	size	A4	scale	1.000
eng	Jeny Ren	2016/12/01			ecn no	ELX-DG-25425-1		
chr	-	-			rel level	Released		
appr	Nickor Zuo	2016/12/02	product family	Amphenol FCI		title	SMT DDRIII SOCKET ASS'Y	
www.fci.com			cat. no.	*	Product - Customer Drw	dwg no	10109498	rev
							sheet 2 of 4	D

A

B

C

D

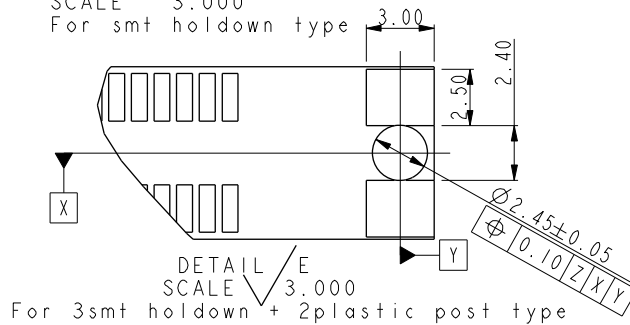
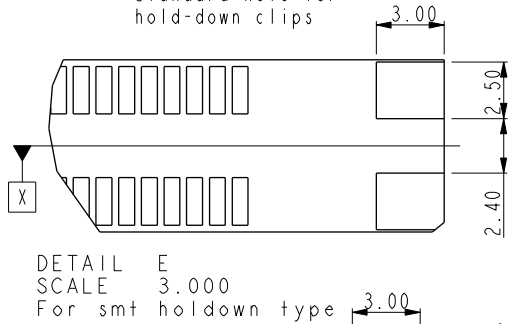
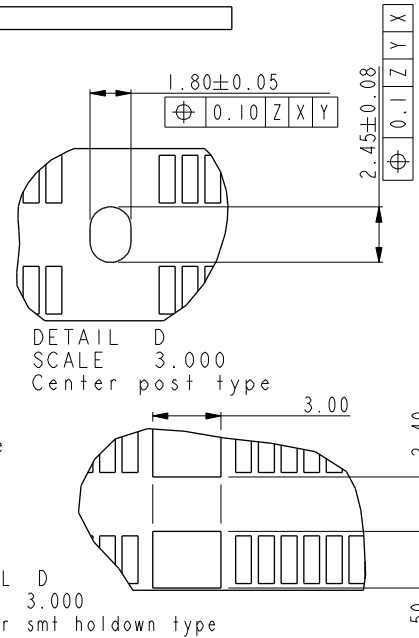
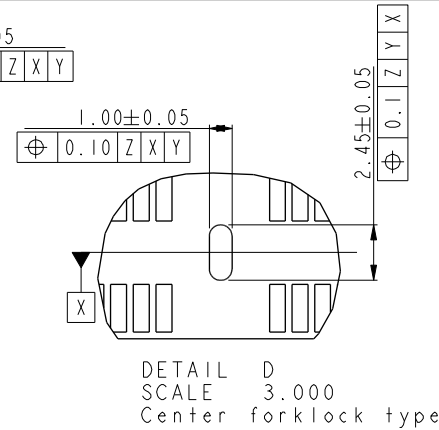
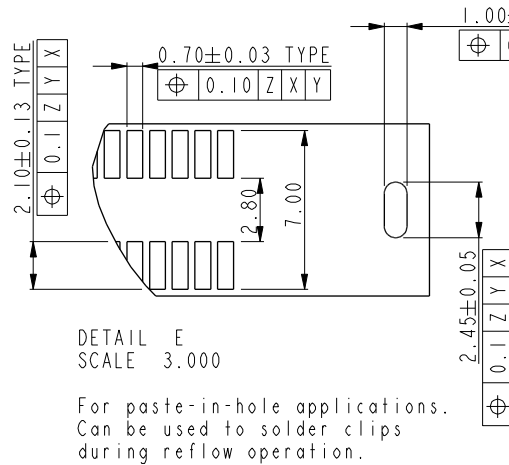
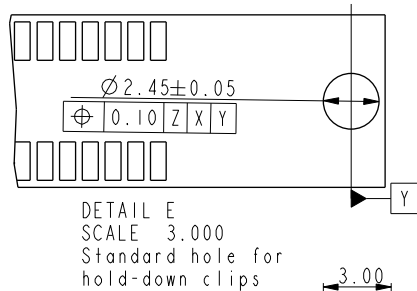
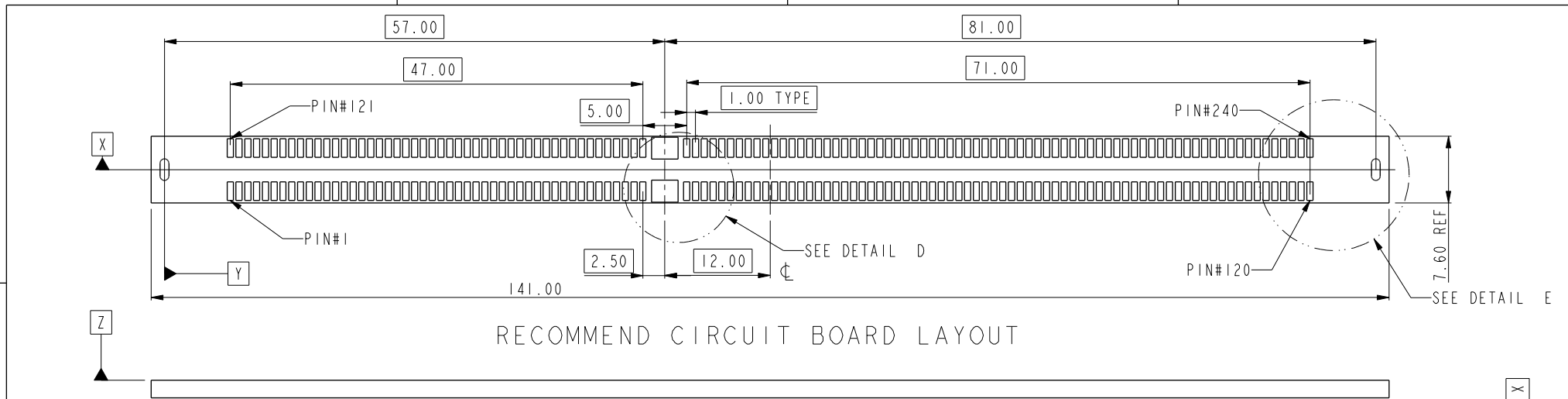

dr	Rick Bian	2010/07/04	projection	MM	size	A4	scale	1.000
eng	Jeny Ren	2016/12/01			ecn no	ELX-DG-25425-1		
chr	-	-			rel level	Released		
appr	Nickor Zuo	2016/12/02	product family					
Amphenol FCI	title			SMT DDRIII SOCKET ASS'Y		dwg no		10109498
www.fci.com	cat. no.			* Product - Customer Drw		sheet 3 of 4		rev D

A

B

C

D

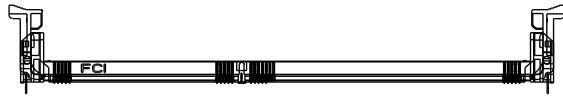

SCALE 0.500
10109498-10***
CENTER SMT HOLDOWN TYPE



SCALE 0.500
10109498-11***
3 FORK LOCK TYPE



SCALE 0.500
10109498-12***
3 SMT HOLDOWN TYPE



SCALE 0.500 SEE DETAIL N
10109498-13***
3 SMT HOLDOWN AND 2 PLASTIC POST TYPE

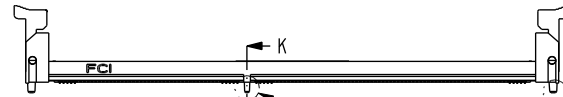

SCALE 0.500 SEE DETAIL J
10109498-15***
3 PLASTIC POST TYPE SEE DETAIL M

NOTES:

- MATERIAL:
HOUSING: HIGH PERFORMANCE RESINS, GLASS FILLED UL94V-0 RATED.
EJECTOR: HIGH PERFORMANCE RESINS, GLASS FILLED UL94V-0 RATED.
TERMINAL: HIGH PERFORMANCE COPPER ALLOY
METAL CLIP: COPPER ALLOY.
- FCI LOGO TO BE APPROXIMATELY LOCATED AS SHOWN ON PRINT.
- PRODUCT SPECIFICATION: GS-12-486.
- PACKAGING SPECIFICATION: GS-14-899.
- RECOMMENDED STENCIL THICKNESS NO LESS THAN 0.15 mm.
- FOR OPTIMUM PERFORMANCE, THE TIE BAR IS TO BE ON AN INTERNAL LAYER SO THAT THE REMNANT CANNOT CAUSE CONTACT DAMAGE.
- THE DATE CODE IS SHOWN "MDDYY*"
"*" MEANS PRODUCTION LINE.
- THIS PRODUCT MEETS EUROPEAN UNION DIRECTIVES AND OTHER COUNTRY REGULATIONS AS DESCRIBED IN GS-22-008.
- THE HOUSING WILL WITH STAND EXPOSURE TO 260°C PEAK TEMPERATURE FOR 10 SECONDS IN AN IR REFLOW SOLDERING APPLICATION.
- PRODUCT APPLICATION SPEC GS-20-089.
- THE HOLDOWN TYPES ARE OPTION FOR HOLDOWN OR FORKLOCK.



2

STYLE : MECHANICAL KEYING

1 : 1.5 VOLT. W/ CENTER KEY

HOLD DOWN TYPE

- 0 : CENTER HOLD DOWN, FORKLOCK AT BOTH END
1 : 3 FORKLOCK TYPE
2 : 3 SMT HOLDOWN TYPE
3 : 3 SMT HOLDOWN AND 2 PLASTIC POST
5 : 3 PLASTIC POST TYPE

PACKAGE AND MYLAR OPTION

- 0: SOFT TRAY WITHOUT MYLAR (OBSOLETE)
1: HARD TRAY WITH MYLAR
2: HARD TRAY WITHOUT MYLAR
3: SOFT TRAY WITH MYLAR (OBSOLETE)
4: CUSTOMIZED HARD TRAY WITH MYLAR
5: CUSTOMIZED HARD TRAY WITHOUT MYLAR

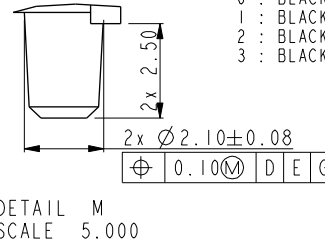
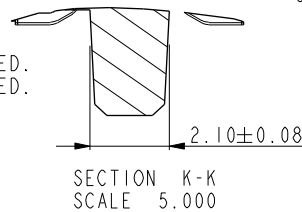
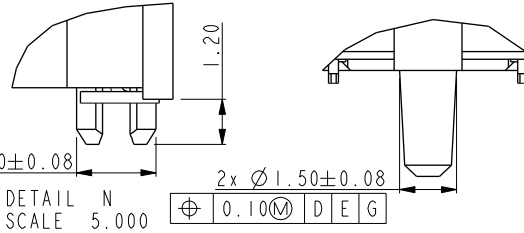

3

PLATING

CODE	CONTACT	SOLDERTAIL	UNDERPLATE	NOTE
1	10u" (0.25um) MIN. GOLD	100u" (2.54um) MIN. TIN-LEAD	50u" (1.27um) MIN. NICKEL OVERALL	CONTACT NON-LUBRICANT
2	15u" (0.38um) MIN. GOLD			
3	30u" (0.76um) MIN. GOLD			
4	GOLD FLASH			
5	10u" (0.25um) MIN. GOLD			CONTACT LUBRICATED
6	15u" (0.38um) MIN. GOLD			
7	30u" (0.76um) MIN. GOLD			
8	GOLD FLASH			
1LF	10u" (0.25um) MIN. GOLD	100u" (2.54um) MIN. 100% MATT TIN	50u" (1.27um) MIN. NICKEL OVERALL	CONTACT NON-LUBRICANT
2LF	15u" (0.38um) MIN. GOLD			
3LF	30u" (0.76um) MIN. GOLD			
4LF	GOLD FLASH			
5LF	10u" (0.25um) MIN. GOLD			CONTACT LUBRICATED
6LF	15u" (0.38um) MIN. GOLD			
7LF	30u" (0.76um) MIN. GOLD			
8LF	GOLD FLASH			

COLOR OF HOUSING AND EJECTOR

- 0 : BLACK HOUSING + IVORY EJECTOR
1 : BLACK HOUSING + BLACK EJECTOR
2 : BLACK HOUSING + BLUE(653C) EJECTOR
3 : BLACK HOUSING + YELLOW(1235C) EJECTOR

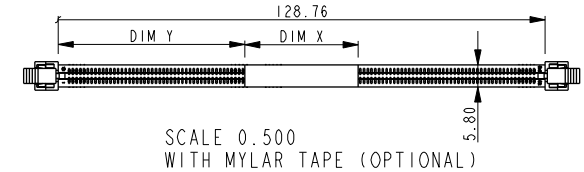

dr	Rick Bian	2010/07/04	projection	MM	size	A4	scale	1.000	
eng	Jeny Ren	2016/12/01			ecn no	ELX-DG-25425-1			
chr	-	-				rel level	Released		
appr	Nickor Zuo	2016/12/02	product family	dwg no		10109498		rev	D
www.fci.com	cat. no.	*	Product - Customer Drw			sheet 4 of 4			

2

3