



Chipsmall Limited consists of a professional team with an average of over 10 year of expertise in the distribution of electronic components. Based in Hongkong, we have already established firm and mutual-benefit business relationships with customers from,Europe,America and south Asia,supplying obsolete and hard-to-find components to meet their specific needs.

With the principle of “Quality Parts,Customers Priority,Honest Operation,and Considerate Service”,our business mainly focus on the distribution of electronic components. Line cards we deal with include Microchip,ALPS,ROHM,Xilinx,Pulse,ON,Everlight and Freescale. Main products comprise IC,Modules,Potentiometer,IC Socket,Relay,Connector.Our parts cover such applications as commercial,industrial, and automotives areas.

We are looking forward to setting up business relationship with you and hope to provide you with the best service and solution. Let us make a better world for our industry!



## Contact us

Tel: +86-755-8981 8866 Fax: +86-755-8427 6832

Email & Skype: info@chipsmall.com Web: www.chipsmall.com

Address: A1208, Overseas Decoration Building, #122 Zhenhua RD., Futian, Shenzhen, China





PART NO.

10116040-001LF

NOTES:

- MATERIAL:  
HOUSING: HIGH PERFORMANCE RESIN, GLASS FILLED, UL94 V-0, COLOR: NATURAL.  
TERMINAL: TI-CU ALLOY.  
CAP: STAINLESS SLEEL.  
HOLDDOWN: STAINLESS SLEEL.
- FINISH:  
TERMINAL:  
CONTACT AREA: GOLD PLATED 30u" MIN.  
ALL AREA: GOLD PLATED 1u" MIN.  
UNDER NICKEL PLATED 50u" MIN.  
HOLDDOWN:  
ALL AREA: GOLD PLATED 1u" MIN.  
UNDER NICKEL PLATED 50u" MIN.
- NORMAL FORCE: 1.25N Min. FOR 1.6mm COMPRESSION.
- THE PRODUCT SPEC. PLS. REFER TO GS-12-674.
- THE PACKING SPEC. PLS. REFER TO GS-14-1545.
- THE SUFFIX "LF" MEANS FOR LEAD FREE PROCESS.

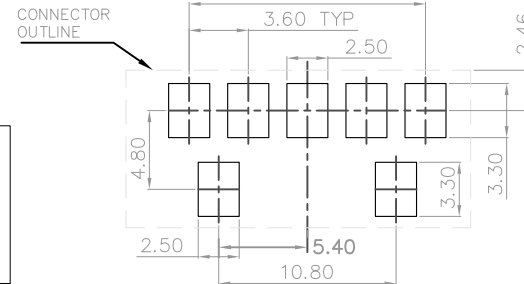
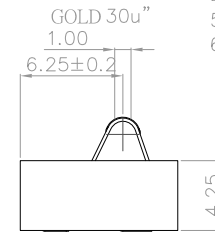
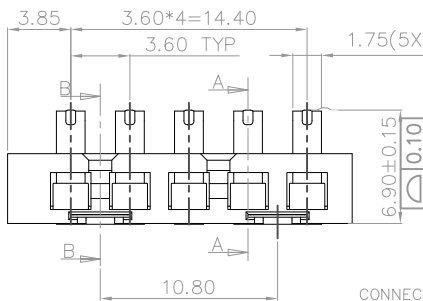
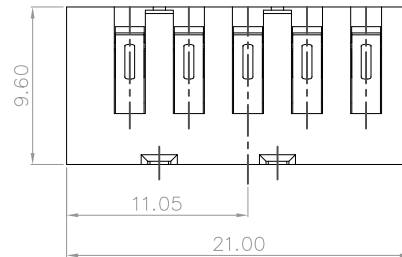
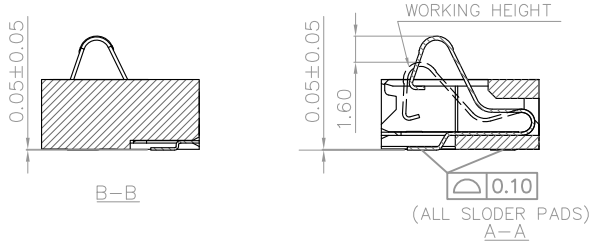

RECOMMENDED P.C.B. LAYOUT  
TOLERANCE: +/-0.05

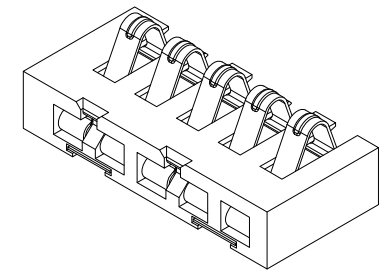

A

A

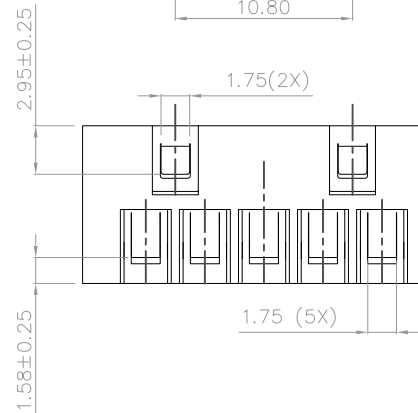
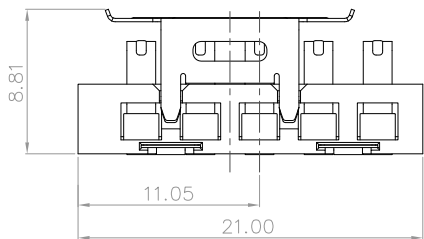
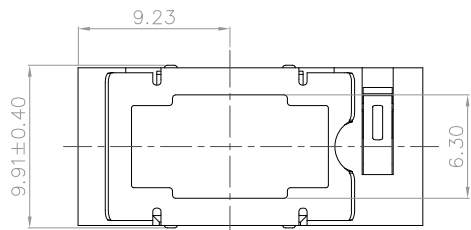
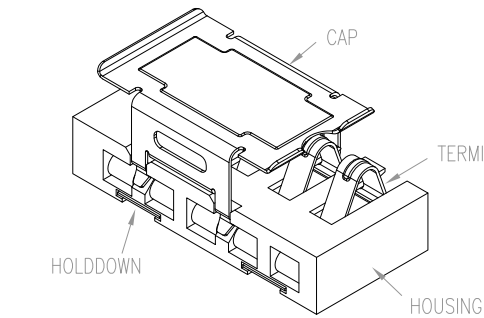

B

5

mat'l. code		surface ASME Y14.5		tolerance ASME Y14.5		projection MM		product family BATTERY	
ltr ecn no dr date		tolerances unless otherwise specified		angles		scale		title 5 PINS 3.60mm PITCH BATTERY CONNECTOR	
A	T10-0130	LS	01-19-11	line	.X±0.25	FCI		dwg no 10116040	
				line	.XX±0.15			sheet 1 of 1 size A4	
				line	.XXX±0.10			type CUSTOMER Drawing	
				dr	LEIF SHEN	01-19-11			
				enr	LEIF SHEN	01-19-11			
				chr	GARY HSIEH	01-19-11			
				appd	JOSEPH HSIA	01-19-11			
sheet index	revision	A	1						

B