



Chipsmall Limited consists of a professional team with an average of over 10 year of expertise in the distribution of electronic components. Based in Hongkong, we have already established firm and mutual-benefit business relationships with customers from,Europe,America and south Asia,supplying obsolete and hard-to-find components to meet their specific needs.

With the principle of “Quality Parts,Customers Priority,Honest Operation,and Considerate Service”,our business mainly focus on the distribution of electronic components. Line cards we deal with include Microchip,ALPS,ROHM,Xilinx,Pulse,ON,Everlight and Freescale. Main products comprise IC,Modules,Potentiometer,IC Socket,Relay,Connector.Our parts cover such applications as commercial,industrial, and automotives areas.

We are looking forward to setting up business relationship with you and hope to provide you with the best service and solution. Let us make a better world for our industry!



## Contact us

Tel: +86-755-8981 8866 Fax: +86-755-8427 6832

Email & Skype: info@chipsmall.com Web: www.chipsmall.com

Address: A1208, Overseas Decoration Building, #122 Zhenhua RD., Futian, Shenzhen, China



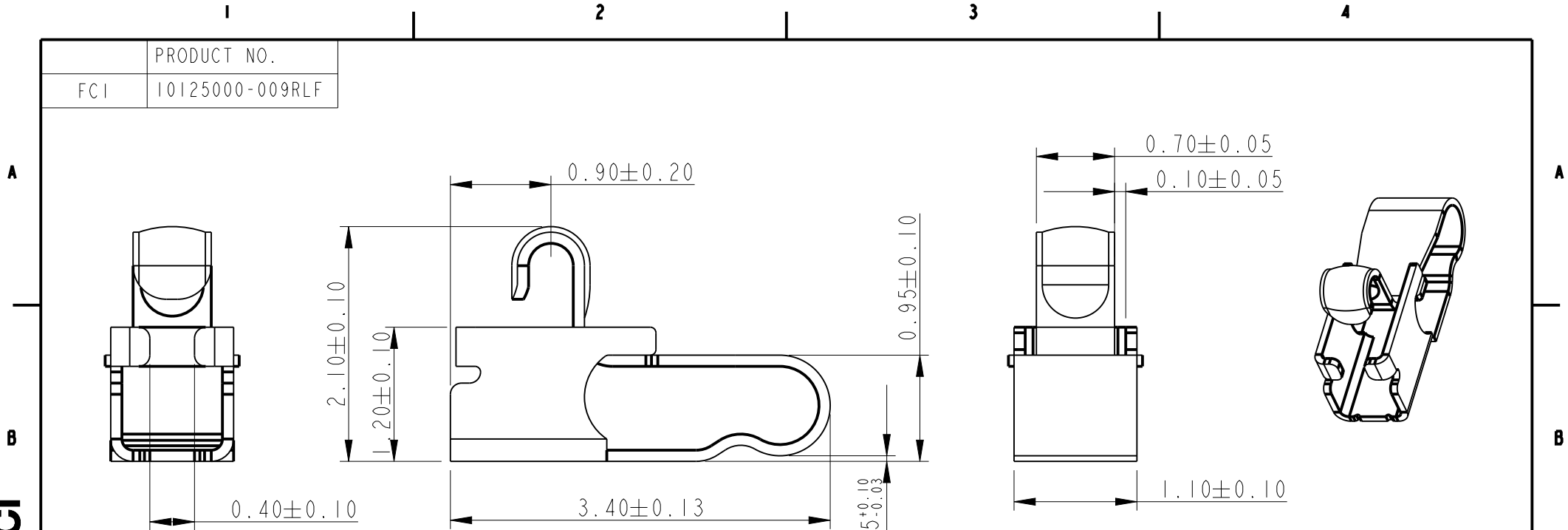

NOTES:

- MATERIAL: BERYLLIUM COPPER ALLOY
- CONTACT PLATING:  
CONTACT AREA: PLATING 1um GXT over 1.0/3.0 um Ni UNDERPLATE.  
SOLDER AREA: PLATING GOLD FLASH OVER 1.0/3.0 um Ni UNDERPLATE.
- PACKAGING: TAPE & REEL
- PART NUMBER DESCRIPTION:  
10125000-0 0 X X X

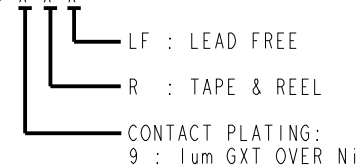

spec ref *		dr	Andy Lu	2013/04/07	projection 	mm ←→	size	A4	scale	20.000				
tolerance std		eng	Li-Qing Lei	2017/05/04			ecn no	ELX-N-26898-1						
ASME Y14.5		chr	-	-				rel level		Released				
ASME Y14.5		appr	Tim Yao	2017/06/09			product family		-					
surface - ✓✓	linear	0.X	±0.3		Amphenol FCI	title	UNIVERSAL CONTACT		dwg no	10125000	rev	C		
		0.XX	±0.13				cat. no.	-					Product - Customer Drw	sheet 1 of 2
		0.XXX	±0.050											
ASME Y14.5	angular	0°	±3°		www.fci.com									

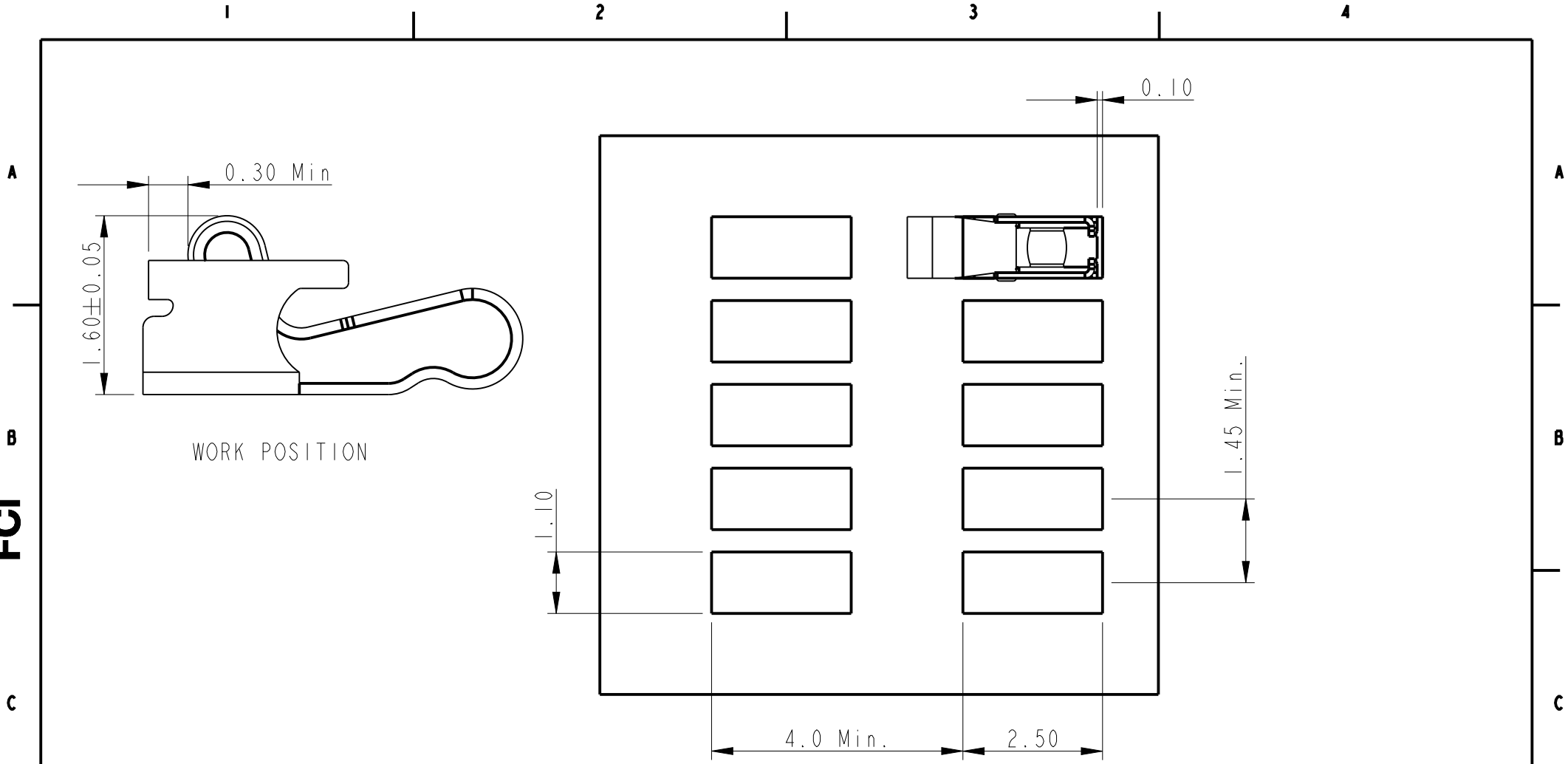

RECOMMENDED PCB DIMENSION & MIN PITCH  
TOLERANCE: +/-0.05mm

spec ref *		dr Andy Lu 2013/04/07		projection 	mm ←→	size A4	scale 10.000
tolerance std ASME Y14.5		eng Li-Qing Lei 2017/05/04				ecn no ELX-N-26898-1	
TOLERANCES UNLESS OTHERWISE SPECIFIED		chr -				rel level Released	
ASME Y14.5		appr Tim Yao 2017/06/09		product family -		rev C	
surface	linear	0.X	±0.3	Amphenol FCi	title UNIVERSAL CONTACT 2.1mm HEIGHT UC	dwg no 10125000	
		0.XX	±0.13				
		0.XXX	±0.050				
ASME Y14.5	angular	0°	±3°	www.fci.com	cat. no. -	Product - Customer Drw	