



Chipsmall Limited consists of a professional team with an average of over 10 year of expertise in the distribution of electronic components. Based in Hongkong, we have already established firm and mutual-benefit business relationships with customers from,Europe,America and south Asia,supplying obsolete and hard-to-find components to meet their specific needs.

With the principle of “Quality Parts,Customers Priority,Honest Operation,and Considerate Service”,our business mainly focus on the distribution of electronic components. Line cards we deal with include Microchip,ALPS,ROHM,Xilinx,Pulse,ON,Everlight and Freescale. Main products comprise IC,Modules,Potentiometer,IC Socket,Relay,Connector.Our parts cover such applications as commercial,industrial, and automotives areas.

We are looking forward to setting up business relationship with you and hope to provide you with the best service and solution. Let us make a better world for our industry!



## Contact us

Tel: +86-755-8981 8866 Fax: +86-755-8427 6832

Email & Skype: info@chipsmall.com Web: www.chipsmall.com

Address: A1208, Overseas Decoration Building, #122 Zhenhua RD., Futian, Shenzhen, China





PRODUCT NUMBER

SEE P/N TABLE

NOTE:

- 1. MATERIAL: NYLON 66, UL 94V-0, BLACK.
- 2. THIS HSG IS USED WITH FCI PLUG TERMINAL 10127719.
- 3. THIS PLUG MATES WITH FCI RECEPTACLE WIRE CONNECTOR 10127716.
- 4. PRODUCT SPECIFICATION: GS-12-1177.
- 5. PACKAGE SPECIFICATION: GS-14-2359.
- 4. PART NUMBER SCHEME:  
10127717- XX LF

POS. CODE:  
04: 4 POS.  
06: 6 POS.  
8: 8 POS.  
24: 24 POS.

5. P/N & DIMENSION TABLE:

Part No.	POS	A	B
10127717-04LF	4	3.0	6.9
10127717-06LF	6	6.0	9.9
10127717-08LF	8	9.0	12.9
10127717-10LF	10	12.0	15.9
10127717-12LF	12	15.0	18.9
10127717-14LF	14	18.0	21.9
10127717-16LF	16	21.0	24.9
10127717-18LF	18	24.0	27.9
10127717-20LF	20	27.0	30.9
10127717-22LF	22	30.0	33.9
10127717-24LF	24	33.0	36.9

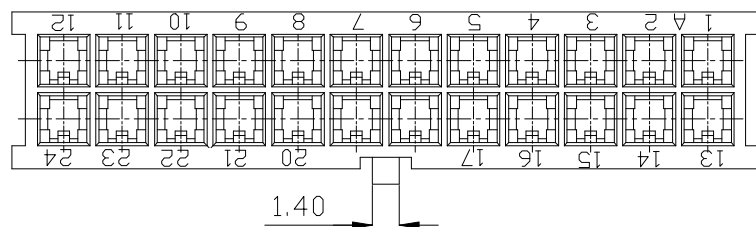
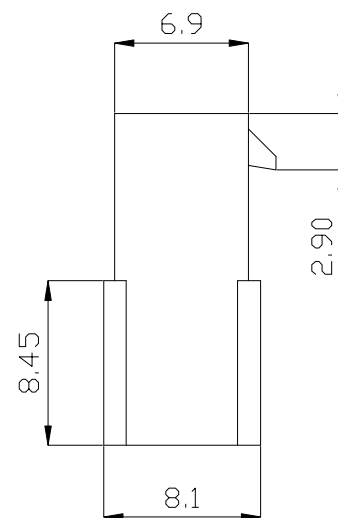
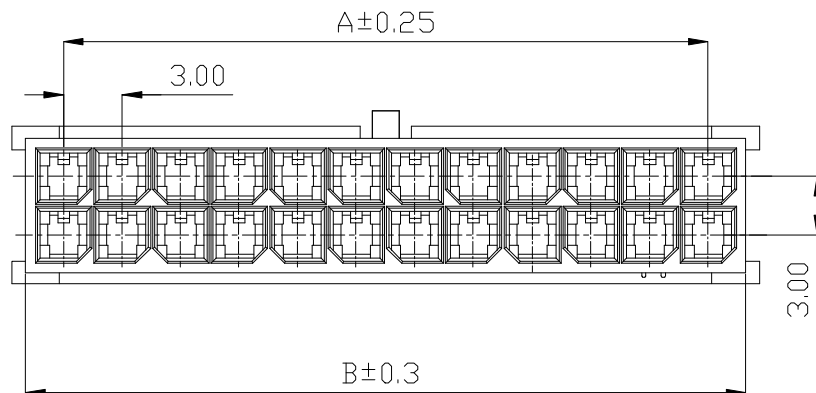

mat'l. code		surface		tolerance		projection		product family	
ltr		ecn no		dr		date		title	
A		TAI		2013-10-21		tolerances unless otherwise specified		PLUG HSG, DUAL ROW, FOR 3mm PITCH WIRE CONNECTOR	
						angles		scale	
						X.X ±0.3		MM	
						X.XX ±0.2			
						X*±2°			
				dr		KENNY TAI		2013-10-21	
				enr		KENNY TAI		2013-10-21	
				chr		KENNY TAI		2013-10-21	
				appd		PM ZHENG		2013-11-06	
sheet index		revision sheet		A		A		size	
				1		2		A4	
								type	
								CUSTOMER Drawing	



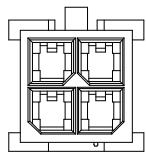

4 POS

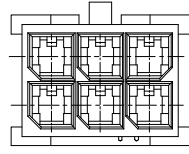

6 POS

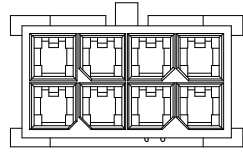

8 POS

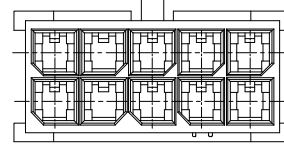

10 POS

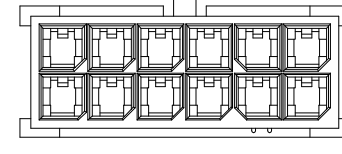

12 POS

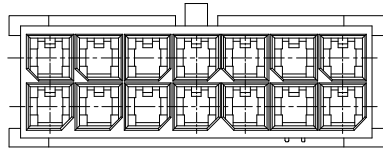

14 POS

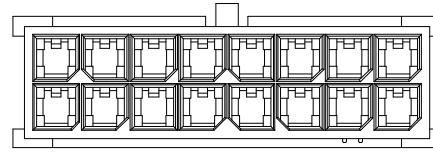

16 POS

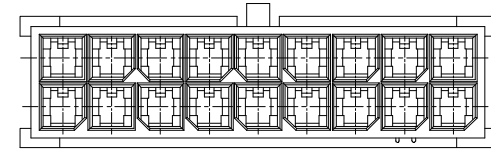

18 POS

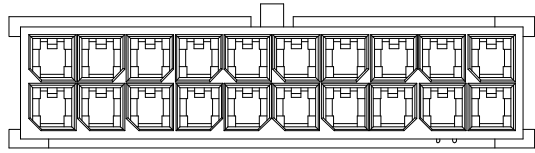

20 POS

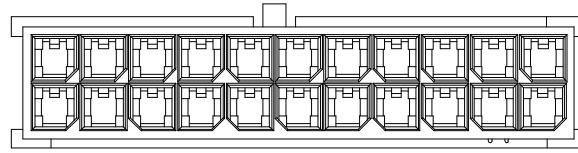

22 POS

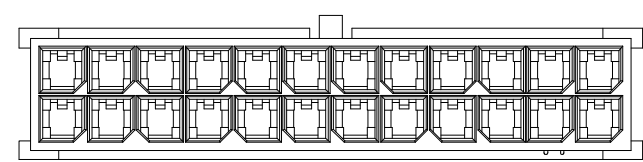

24 POS

mat'l. code		surface <input checked="" type="checkbox"/> tolerance		projection		product family	
ltr		ecn no dr date		tolerances unless otherwise specified		title	
				angles $\begin{matrix} \text{in} \\ \text{mm} \end{matrix}$ $\begin{matrix} X.X \pm 0.3 \\ X.XX \pm 0.2 \end{matrix}$		PLUG HSG, DUAL ROW, FOR 3mm PITCH WIRE CONNECTOR	
				X <sup>±</sup> 2°		scale	
				dr KENNY TAI 2013-10-21		dwg no sheet 2 of 2 size	
				enr KENNY TAI 2013-10-21		10127717 A4	
				chr KENNY TAI 2013-10-21		type CUSTOMER Drawing	
				appd PM ZHENG 2013-11-06			
sheet index		revision sheet		A A			
		1 2					

