



Chipsmall Limited consists of a professional team with an average of over 10 year of expertise in the distribution of electronic components. Based in Hongkong, we have already established firm and mutual-benefit business relationships with customers from,Europe,America and south Asia,supplying obsolete and hard-to-find components to meet their specific needs.

With the principle of “Quality Parts,Customers Priority,Honest Operation,and Considerate Service”,our business mainly focus on the distribution of electronic components. Line cards we deal with include Microchip,ALPS,ROHM,Xilinx,Pulse,ON,Everlight and Freescale. Main products comprise IC,Modules,Potentiometer,IC Socket,Relay,Connector.Our parts cover such applications as commercial,industrial, and automotives areas.

We are looking forward to setting up business relationship with you and hope to provide you with the best service and solution. Let us make a better world for our industry!



## Contact us

Tel: +86-755-8981 8866 Fax: +86-755-8427 6832

Email & Skype: info@chipsmall.com Web: www.chipsmall.com

Address: A1208, Overseas Decoration Building, #122 Zhenhua RD., Futian, Shenzhen, China



PRODUCT NUMBER  
SEE PART NO. TABLE

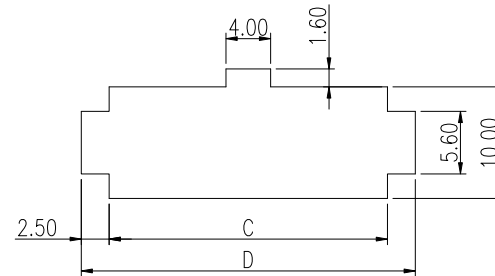
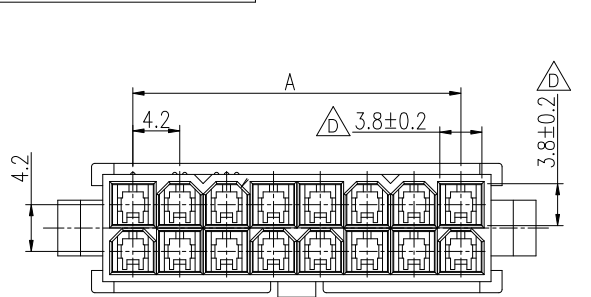

PANEL HOLE DIMENSIONS  
RECOMMENDED THICKNESS: 2.54 MAX.  
TOLERANCE: ±0.1

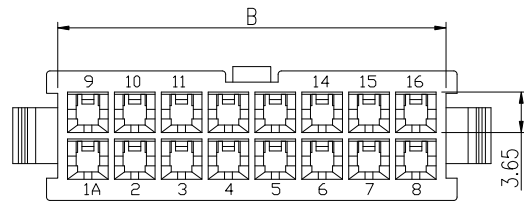
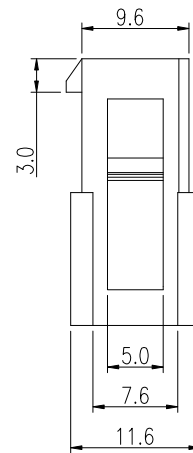
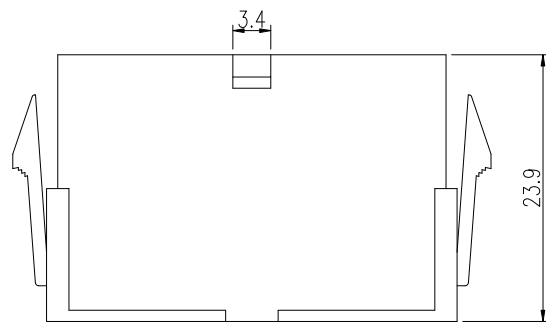

NOTES:

1. MATERIAL: NYLON 66, UL 94V-0. GLOW WIRE COMPATIBLE. COLOR: NATURAL.
2. THIS HSG IS USED WITH FCI PLUG TERMINAL 10127818.
3. THIS PLUG MATES WITH FCI RECEPTACLE WIRE CONNECTOR 10127815.
4. PRODUCT SPECIFICATION: GS-12-1181.
5. PACKAGE SPECIFICATION: GS-14-2362.
6. PART NUMBER SCHEME:  
10127816- XX LF

POS. CODE:   
02: 2 POS.  
04: 4 POS.  
24: 24 POS.

7. DIMENSIONAL & PART NO. TABLE:

PART NUMBER	POS.	A	B	C	D
10127816-02LF	2	/	5.4	5.8	10.8
10127816-04LF	4	4.2	9.6	10.0	15.0
10127816-06LF	6	8.4	13.8	14.2	19.2
10127816-08LF	8	12.6	18.0	18.4	23.4
10127816-10LF	10	16.8	22.2	22.6	27.6
10127816-12LF	12	21.0	26.4	26.8	31.8
10127816-14LF	14	25.2	30.6	31.0	36.0
10127816-16LF	16	29.4	34.8	35.2	40.2
10127816-18LF	18	33.6	39.0	39.4	44.4
10127816-20LF	20	37.8	43.2	43.6	48.6
10127816-22LF	22	42.0	47.4	47.8	52.8
10127816-24LF	24	46.2	51.6	52.0	57.0

mat'l. code		surface		tolerance		projection		product family	
						MM		MINITEK PWR4.2	
ltr		ecn no		dr		date		title	
A		TAI		2013-11-11				PLUG HSG, DUAL ROW	
B		ELX-T-17193		TAI		2014-03-12		MINITEK PWR4.2 WIRE CONNECTOR	
C		ELX-T-19251		TAI		2014-10-31			
D		ELX-T-20468		TAI		2015-03-16			
				dr		KENNY TAI 2013-11-11		dwg no	
				enr		KENNY TAI 2013-11-11		sheet 1 of 2	
				chr		KENNY TAI 2013-11-11		size	
				appd		PM ZHENG 2013-11-22		10127816	
								type	
								CUSTOMER Drawing	
sheet index		revision sheet		D		D			
				1		2			

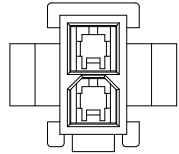

2 POS

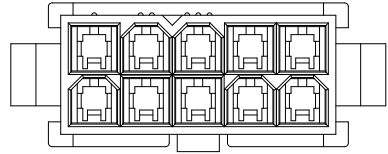

10 POS

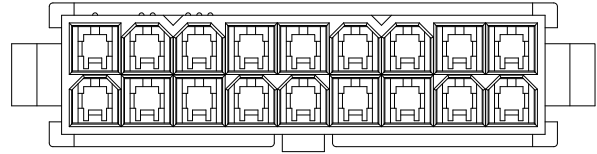

18 POS

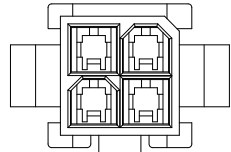

4 POS

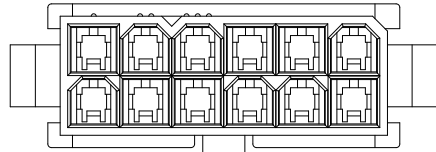

12 POS

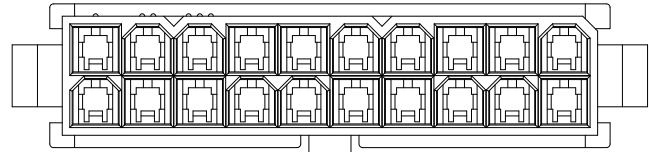

20 POS

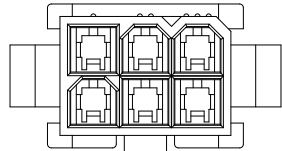

6 POS

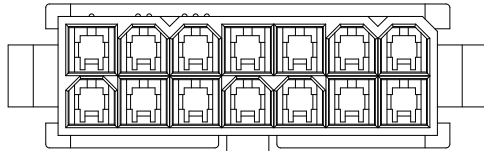

14 POS

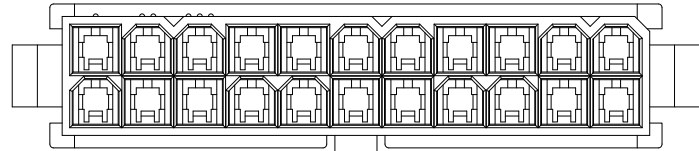

22 POS

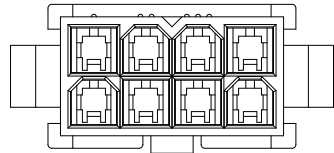

8 POS

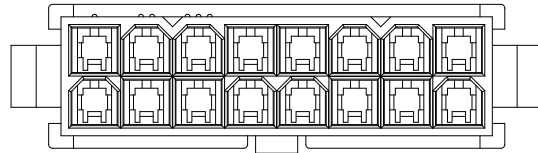

16 POS

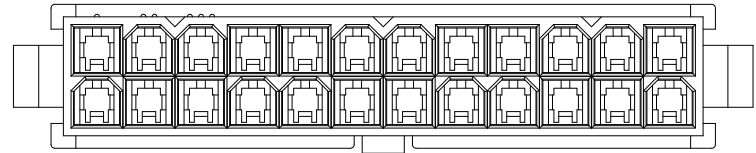

24 POS

mat'l. code		surface <input checked="" type="checkbox"/>		tolerance		projection		product family	
ltr		ecn no		dr		date		MINITEK PWR4.2	
								title	
								PLUG HSG, DUAL ROW	
								MINITEK PWR4.2 WIRE CONNECTOR	
								dwg no	
								sheet 2 of 2	
								size	
								A4	
								type	
								CUSTOMER Drawing	
sheet index		revision sheet		D		D			
				1		2			

