



Chipsmall Limited consists of a professional team with an average of over 10 year of expertise in the distribution of electronic components. Based in Hongkong, we have already established firm and mutual-benefit business relationships with customers from,Europe,America and south Asia,supplying obsolete and hard-to-find components to meet their specific needs.

With the principle of “Quality Parts,Customers Priority,Honest Operation,and Considerate Service”,our business mainly focus on the distribution of electronic components. Line cards we deal with include Microchip,ALPS,ROHM,Xilinx,Pulse,ON,Everlight and Freescale. Main products comprise IC,Modules,Potentiometer,IC Socket,Relay,Connector.Our parts cover such applications as commercial,industrial, and automotives areas.

We are looking forward to setting up business relationship with you and hope to provide you with the best service and solution. Let us make a better world for our industry!



Contact us

Tel: +86-755-8981 8866 Fax: +86-755-8427 6832

Email & Skype: info@chipsmall.com Web: www.chipsmall.com

Address: A1208, Overseas Decoration Building, #122 Zhenhua RD., Futian, Shenzhen, China



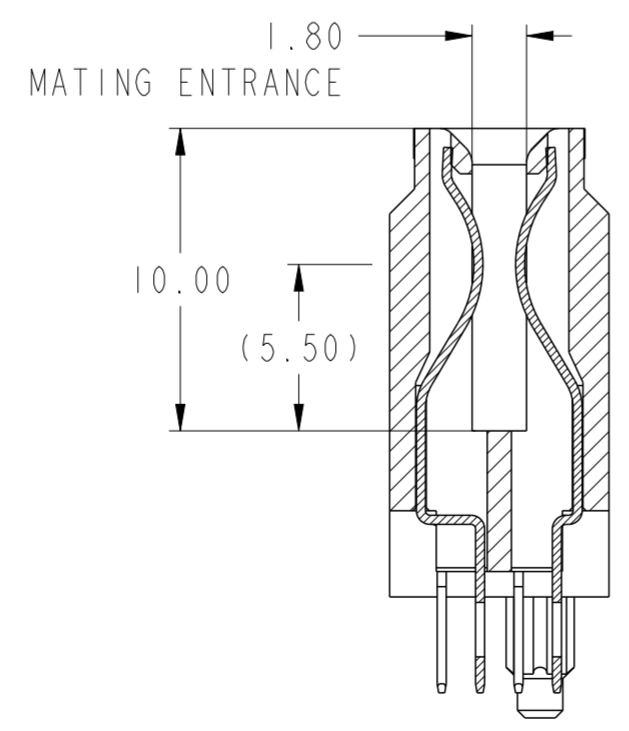
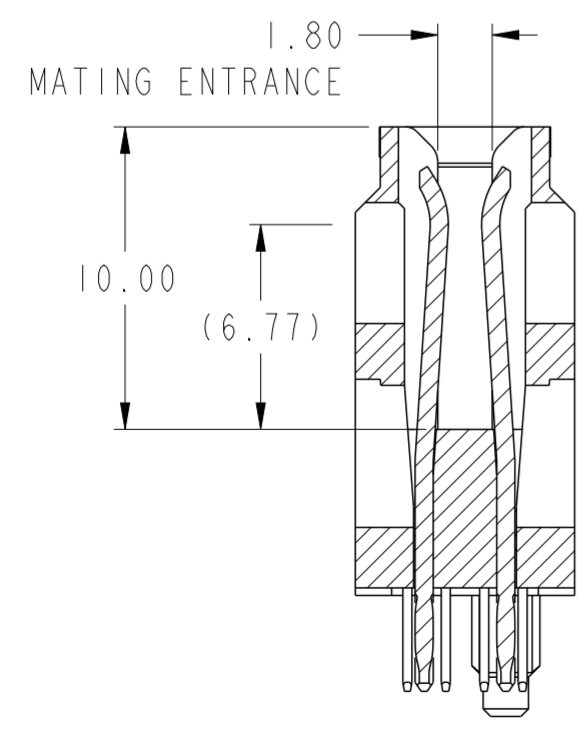
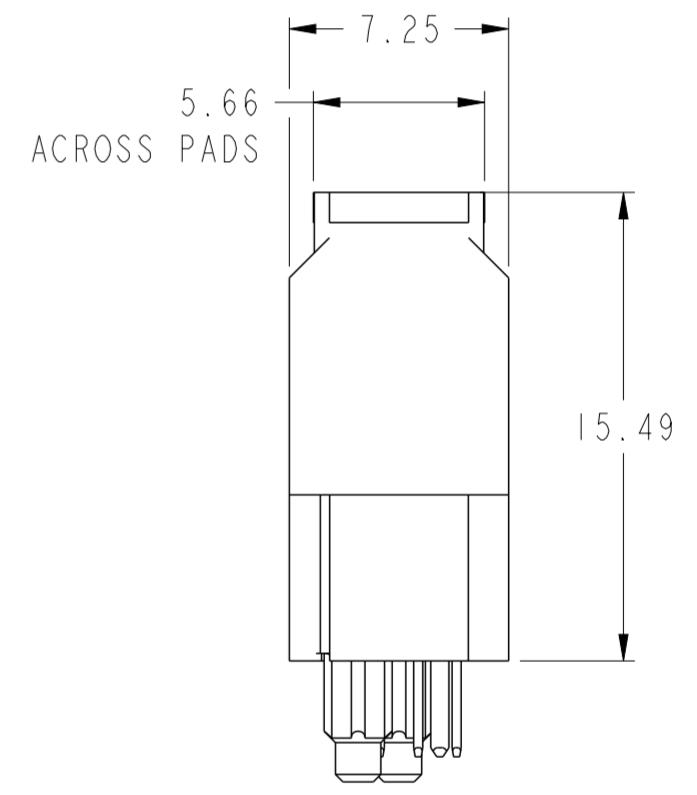
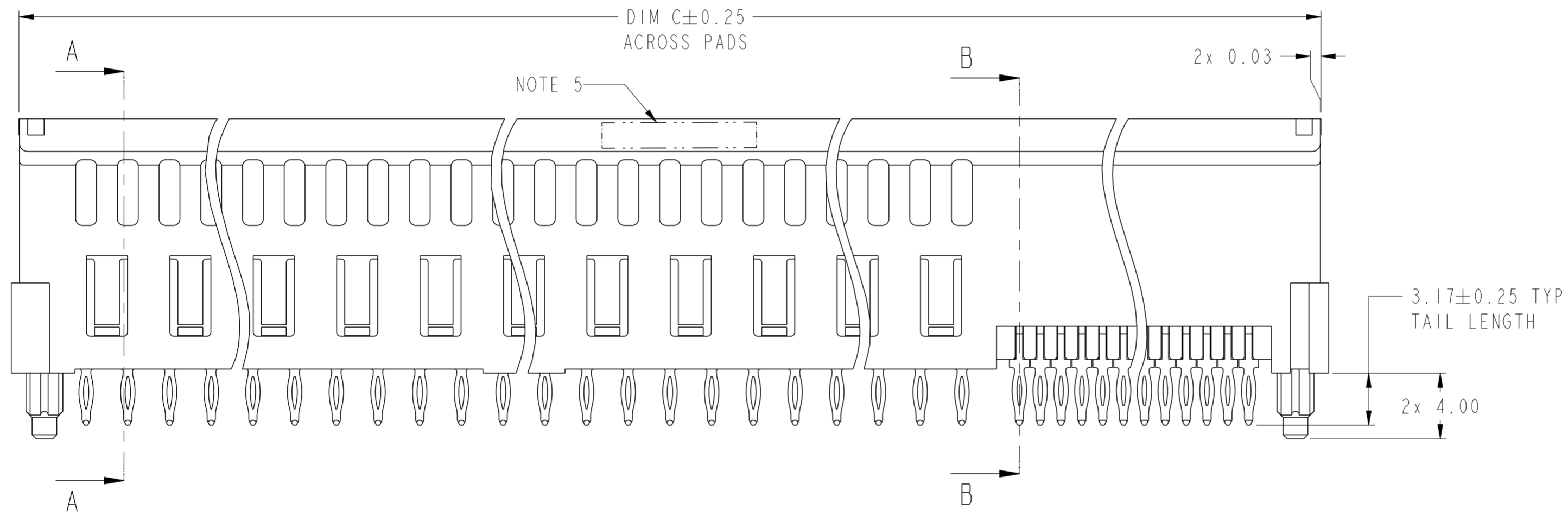
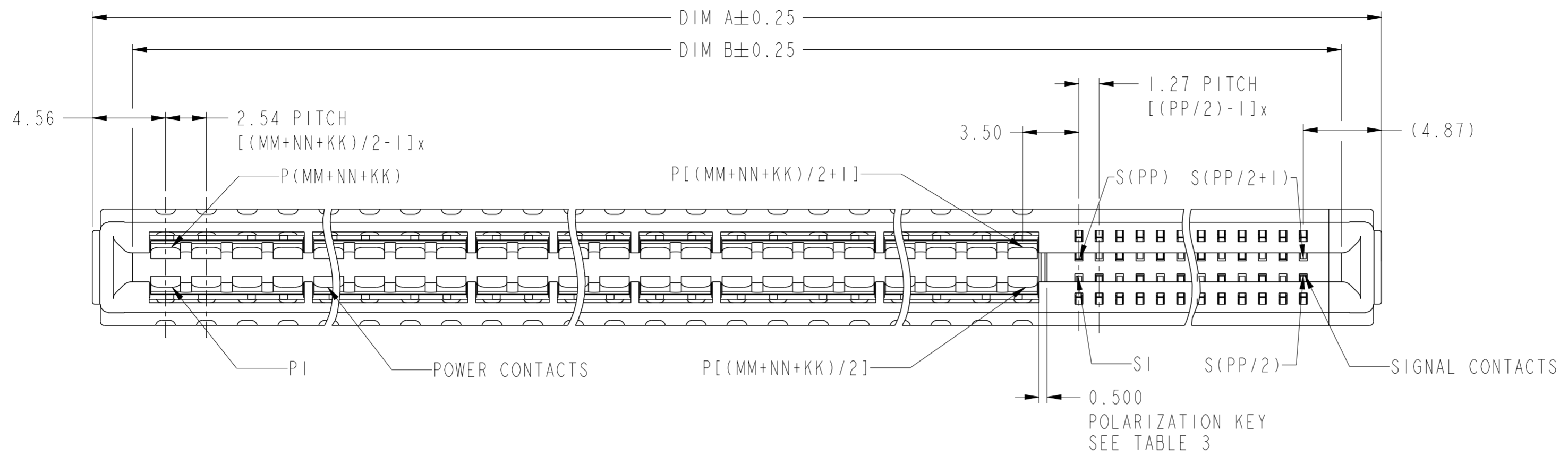

spec ref	-	dr	De-Ming Lu	2013/11/03	projection	MM	size	A2	scale	4:1
tolerance std	ISO 406 ISO 1101	eng	De-Ming Lu	2014/02/19			ecn no	-	rel level	Released
TOLERANCES UNLESS OTHERWISE SPECIFIED		chr	-	appr						
surface	ISO 1302	linear	0.X	±0.5			title	VERT REC WITH ENHANCED WALLS		dwg no 10127905 rev A
		angular	0°	±2°	www.fci.com	cat. no.	Product - Customer Drw		sheet 1 of 4	

CONTACT TYPE	TOP LAYER DESCRIPTION	TABLE 1 (HPCE / SOLDER TAILS) PLATED THROUGH-HOLE REQUIREMENTS				
		DRILLED HOLE DIAMETER	COPPER THICKNESS	TIN-LEAD THICKNESS	TIN THICKNESS	FINISHED HOLE DIAMETER
POWER & SIGNAL	TIN-LEAD	1.10-1.16 (1.15 DRILL)	0.025 - 0.050	0.005 - 0.015	--	0.94 - 1.10
	IMMERSION TIN	1.10-1.16 (1.15 DRILL)	0.025 - 0.050	--	0.9 - 1.5um	0.94 - 1.10
	COPPER (SEE NOTE 8)	1.10-1.16 (1.15 DRILL)	0.025 - 0.050	--	--	0.94 - 1.10

CONTACT TYPE	TOP LAYER DESCRIPTION	TABLE 2 (HPCE / PRESS-FIT TAILS) PLATED THROUGH-HOLE REQUIREMENTS				
		DRILLED HOLE DIAMETER	COPPER THICKNESS	TIN-LEAD THICKNESS	TIN THICKNESS	FINISHED HOLE DIAMETER
POWER & SIGNAL	TIN-LEAD	0.81-0.86 (0.85 DRILL)	0.025 - 0.050	0.005 - 0.015	--	0.65 - 0.80
	IMMERSION TIN	0.81-0.86 (0.85 DRILL)	0.025 - 0.050	--	0.9 - 1.5um	0.70 - 0.80
	COPPER (SEE NOTE 8)	0.81-0.86 (0.85 DRILL)	0.025 - 0.050	--	--	0.70 - 0.80

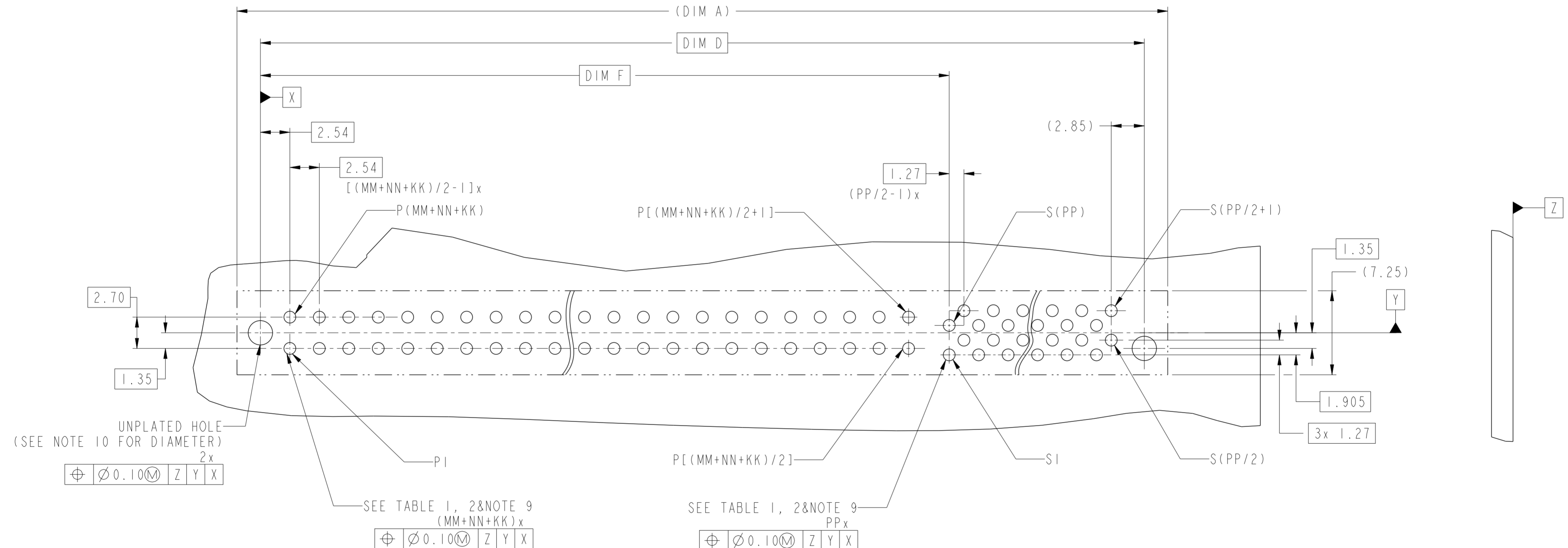

Copyright FCI.

spec ref	-	dr	De-Ming Lu	2013/1103	projection	MM	size	A2	scale	4:1
tolerance std	ISO 406 ISO 1101	eng	De-Ming Lu	2014/02/19	chr	-	ecn no	-	rel level	Released
surface	ISO 1302	appr	Pei-Ming Zheng	2014/02/19	product family	HPCE	cat. no.	10127905	rev	A
							Product - Customer Drw	sheet 2 of 4		

PDS: Rev :A

STATUS:Released

Printed: Feb 19, 2014

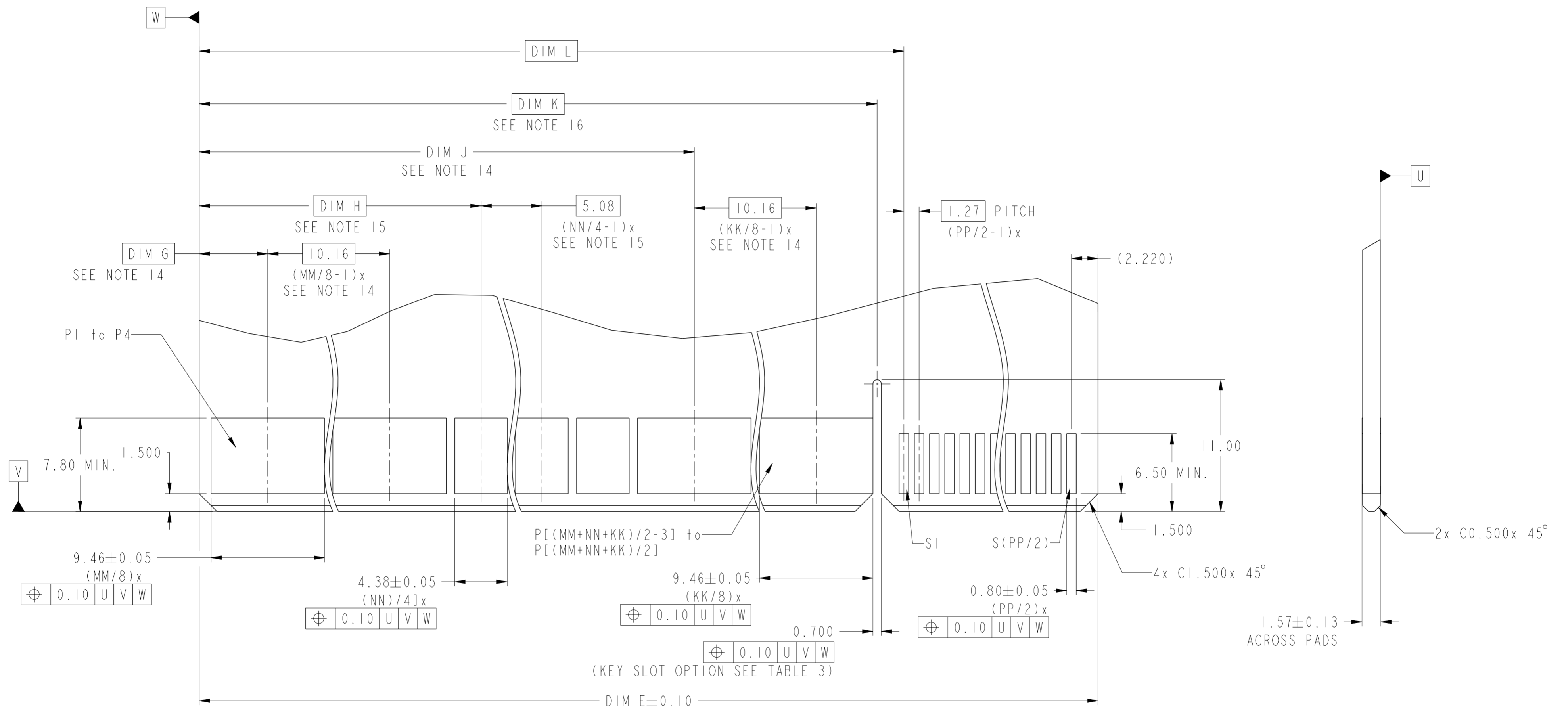

Copyright FCI.

FCI

spec ref	-	dr	De-Ming Lu	2013/1103	projection	MM	size	A2	scale	4:1			
tolerance std	ISO 406 ISO 1101	eng	De-Ming Lu	2014/02/19			ecn no	-	rel level	Released			
TOLERANCES UNLESS OTHERWISE SPECIFIED		chr	-	app			Pei-Ming Zheng	2014/02/19		product family	HPCE		
surface	ISO 1302	linear	0.X	±0.5			title	VERT REC WITH ENHANCED WALLS		div no	10127905	rev	A
		angular	0°	±2°	www.fci.com	cat. no.	Product - Customer Drw		sheet 3 of 4				

PDS: Rev :A

STATUS:Released

Printed: Feb 19, 2014

10127905 - MM NN KK PP LF LEAD FREE

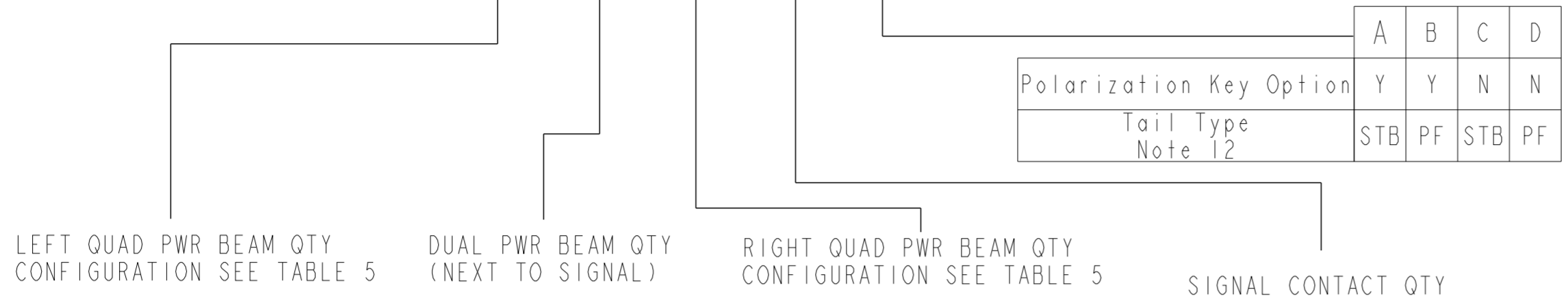

CONFIGURATION:
 I: 4 BEAM (NN = 00 AND KK = 00);
 II: 2 BEAM (MM = 00 AND KK = 00);
 III: 4 BEAM + 2 BEAM (KK = 00);
 IV: 2 BEAM + 4 BEAM (MM = 00);
 V: 4 BEAM + 2 BEAM + 4 BEAM.

TABLE 3. PART NUMBER CODE. HPCE VERT P+S CONFIG (SPECIAL)

NOTES:

- CONNECTOR MATERIALS:
 HOUSING: HIGH TEMPERATURE THERMAL PLASTIC, BLACK
 UL 94V-0 COMPLIANT
 CONTACTS: HIGH PERFORMANCE COPPER ALLOY.
- CONTACT FINISH REF. GS-12-604 SECTION 5.2.
- PRODUCT SPECIFICATION: GS-12-604.
- APPLICATION SPECIFICATION: GS-20-128.
- PRODUCT MARKING (FCI - PART NUMBER & DATE CODE) ON HOUSING IN AREA SHOWN.
- PACKAGING MEETS FCI SPECIFICATION GS-14-937.
- HOUSING COMPONENT WILL WITHSTAND EXPOSURE TO 260°C PEAK TEMPERATURE FOR 60 SECONDS IN A CONVECTION, INFRA-RED, OR VAPOR PHASE REFLOW OVEN.
- COPPER PLATING THICKNESS IN CENTER OF VIA-HOLE CAN BE NO MORE THAN 0.003 LESS THAN OTHER AREAS.
- ALL HOLE SIZES ARE FINISHED HOLE SIZES.
- MOUNTING HOLES ARE UNPLATED
 Ø 2.40 +/- 0.1 FOR PRESS-FIT TAILS
 Ø 2.18 +/- 0.03 FOR SOLDER TAILS
- PRESS FIT APPLICATION TOOL DRAWING : 10119453.
- STB= Solder to board, 1.57-2.38mm PCB thickness.
 PF = Press fit, 1.57mm minimum PCB thickness.
- MAXIMUM OVERALL LENGTH IS 100mm.

- DIM IS NOT APPLICABLE IF NO 4 BEAM CONTACT.
- DIM IS NOT APPLICABLE IF NO 2 BEAM CONTACT.
- DIM IS NOT APPLICABLE IF NO POLARIZATION KEY.
- DUE TO FCI PART NUMBER LENGTH LIMITED, A LETTER WILL REPLACE MM AND KK, DETAIL SEE TABLE 5.

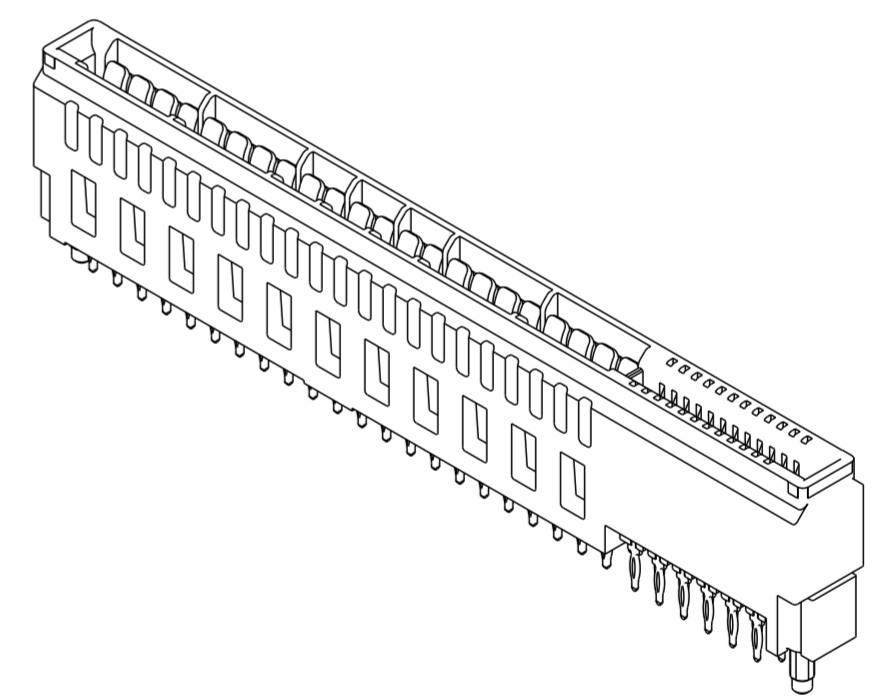

EXAMPLE: 10127905-BI2B24BLF

DIM	TABLE 4: LENGTH FORMULAS	
DIM A (13)	$(MM+KK)/8 \times 10.16 + (NN/4) \times 5.08 + (PP/2) \times 1.27 + 9.12$	
DIM B	DIM A - 5.00	
DIM C	DIM A - 0.94	
DIM D	DIM A - 4.04	
DIM E	DIM A - 5.30	
DIM F	$[(MM+NN+KK)/2] \times 2.54 + 3.50$	
DIM G	CONFIG. I	5.72
	CONFIG. II	-
	CONFIG. III	5.72
	CONFIG. IV	-
	CONFIG. V	5.72
DIM H	CONFIG. I	-
	CONFIG. II	3.18
	CONFIG. III	$(MM / 8 - 1) \times 10.16 + 13.34$
	CONFIG. IV	3.18
	CONFIG. V	$(MM / 8 - 1) \times 10.16 + 13.34$
DIM J	CONFIG. I	-
	CONFIG. II	-
	CONFIG. III	-
	CONFIG. IV	$(NN / 4 - 1) \times 5.08 + 10.80$
	CONFIG. V	$(MM / 8 - 1) \times 10.16 + (NN / 4 - 1) \times 5.08 + 20.96$
DIM K	$(MM+KK)/8 \times 10.16 + (NN/4) \times 5.08 + 0.64$ (WITH KEY)	
	- (NO KEY)	
DIM L	$(MM+KK)/8 \times 10.16 + (NN/4) \times 5.08 + 2.87$	

LETTER	REPRESENT QUAD PWR BEAM QTY
A	08
B	16
C	24
D	32
E	40
F	48
G	56

spec ref	-	dr	De-Ming Lu	2013/1103	projection	MM	size	A2	scale	4:1
tolerance std	ISO 406 ISO 1101	eng	De-Ming Lu	2014/02/19			ecn no	-	rel level	Released
TOLERANCES UNLESS OTHERWISE SPECIFIED		chr	-	apppr						
surface	linear	0.X	±0.5		TITLE VERT REC WITH ENHANCED WALLS P+S CONFIGURATION - UNIVERSAL DRAWING	cat. no. www.fci.com	Part no. 10127905	rev A	Product - Customer Drw	sheet 4 of 4
		0.XX	±0.25							
		0.XXX	±0.10							
	angular	0°	±2°							

Copyright FCI. FCI