



Chipsmall Limited consists of a professional team with an average of over 10 year of expertise in the distribution of electronic components. Based in Hongkong, we have already established firm and mutual-benefit business relationships with customers from,Europe,America and south Asia,supplying obsolete and hard-to-find components to meet their specific needs.

With the principle of “Quality Parts,Customers Priority,Honest Operation,and Considerate Service”,our business mainly focus on the distribution of electronic components. Line cards we deal with include Microchip,ALPS,ROHM,Xilinx,Pulse,ON,Everlight and Freescale. Main products comprise IC,Modules,Potentiometer,IC Socket,Relay,Connector.Our parts cover such applications as commercial,industrial, and automotives areas.

We are looking forward to setting up business relationship with you and hope to provide you with the best service and solution. Let us make a better world for our industry!



## Contact us

Tel: +86-755-8981 8866 Fax: +86-755-8427 6832

Email & Skype: info@chipsmall.com Web: www.chipsmall.com

Address: A1208, Overseas Decoration Building, #122 Zhenhua RD., Futian, Shenzhen, China



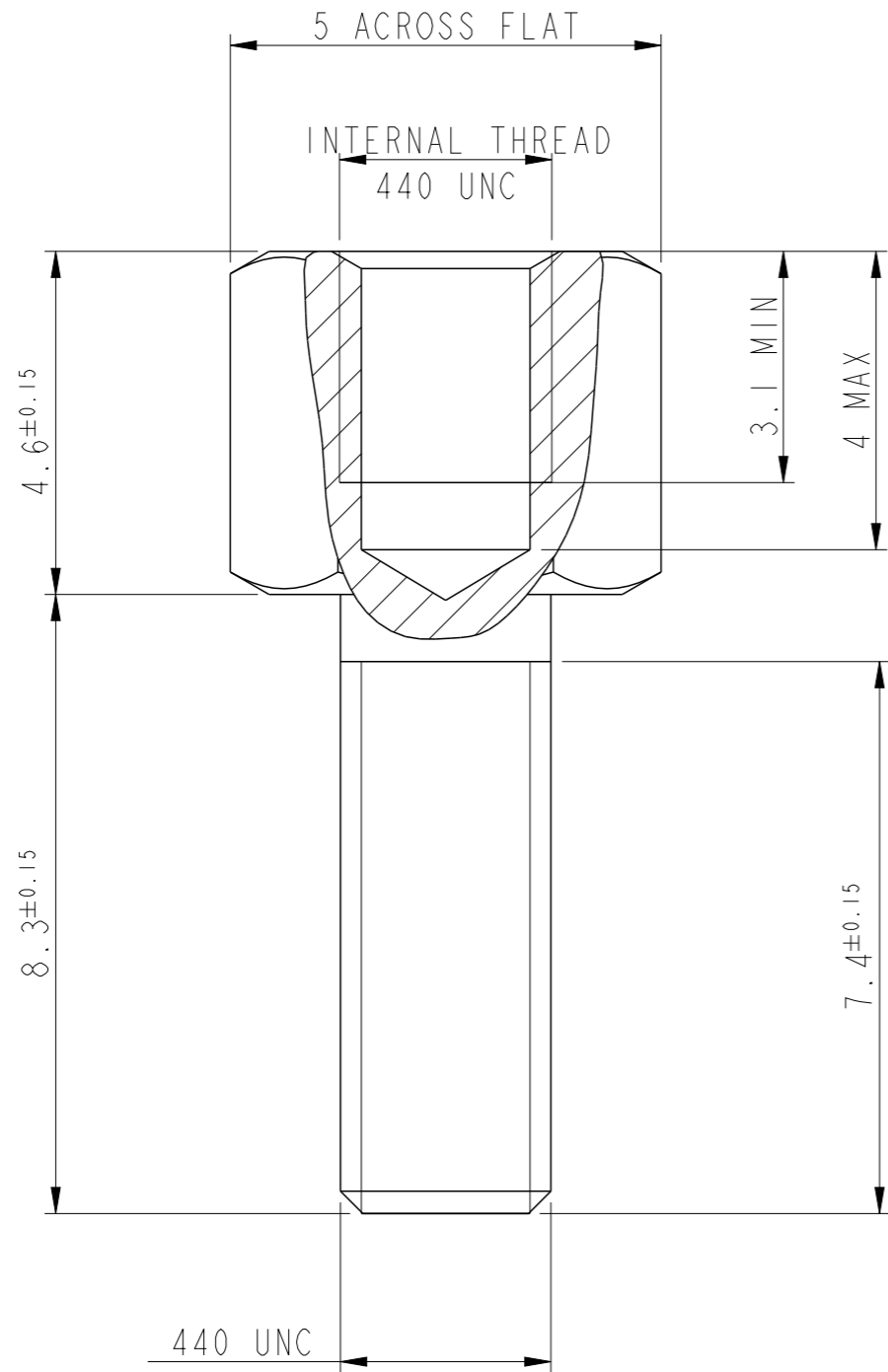

TEHCNICAL CHARACTERISTICS:

FEMALE SCREW LOCKS: BRASS  
PACKAGING: PER 1000 PCS

PART NUMBER 10129129-10ITLF

NOTES:

- The 'LF' product meets European Union Directive and other country regulations as described in GS-47-0004.
- The product is not intended to be exposed to a manufacturing solder process
- Plating: Sn pure over Copper
- Packaging Spec: See GS-14-920

spec ref		dr	Paul Mithun	2015/01/02	projection	MM	size	A3	scale	10:1
tolerance std		eng	Paul Mithun	2015/01/02			ecn no		-	
ISO 406 ISO 1101		chr	-	-			rel level		Released	
TOLERANCES UNLESS OTHERWISE SPECIFIED		appr	K-Paul Biju	2015/01/02	product family		D-SUB		Released	
surface		linear	0.X	±0.1		FEMALE SCREW LOCKS D-SUB ACCESSORIES		dwg no 10129129	rev A	
			0.XX	±0.1						
			0.XXX	±0.1						
ISO 1302	angular	0°	±2°	www.fci.com	cat. no.	-	Product - Customer Drw		sheet 1 of 1	



Copyright FCI.