



Chipsmall Limited consists of a professional team with an average of over 10 year of expertise in the distribution of electronic components. Based in Hongkong, we have already established firm and mutual-benefit business relationships with customers from,Europe,America and south Asia,supplying obsolete and hard-to-find components to meet their specific needs.

With the principle of “Quality Parts,Customers Priority,Honest Operation,and Considerate Service”,our business mainly focus on the distribution of electronic components. Line cards we deal with include Microchip,ALPS,ROHM,Xilinx,Pulse,ON,Everlight and Freescale. Main products comprise IC,Modules,Potentiometer,IC Socket,Relay,Connector.Our parts cover such applications as commercial,industrial, and automotives areas.

We are looking forward to setting up business relationship with you and hope to provide you with the best service and solution. Let us make a better world for our industry!



Contact us

Tel: +86-755-8981 8866 Fax: +86-755-8427 6832

Email & Skype: info@chipsmall.com Web: www.chipsmall.com

Address: A1208, Overseas Decoration Building, #122 Zhenhua RD., Futian, Shenzhen, China



| | | | | | | | |
|----------------|---|---------------------------------|---|---|---|---|---|
| 1 | 2 | 3 | 4 | 5 | 6 | 7 | 8 |
| PART NO | | DESCRIPTION | | | | | |
| 10132640-001LF | | PCB METAL CLIP HOLD DOWN OPTION | | | | | |

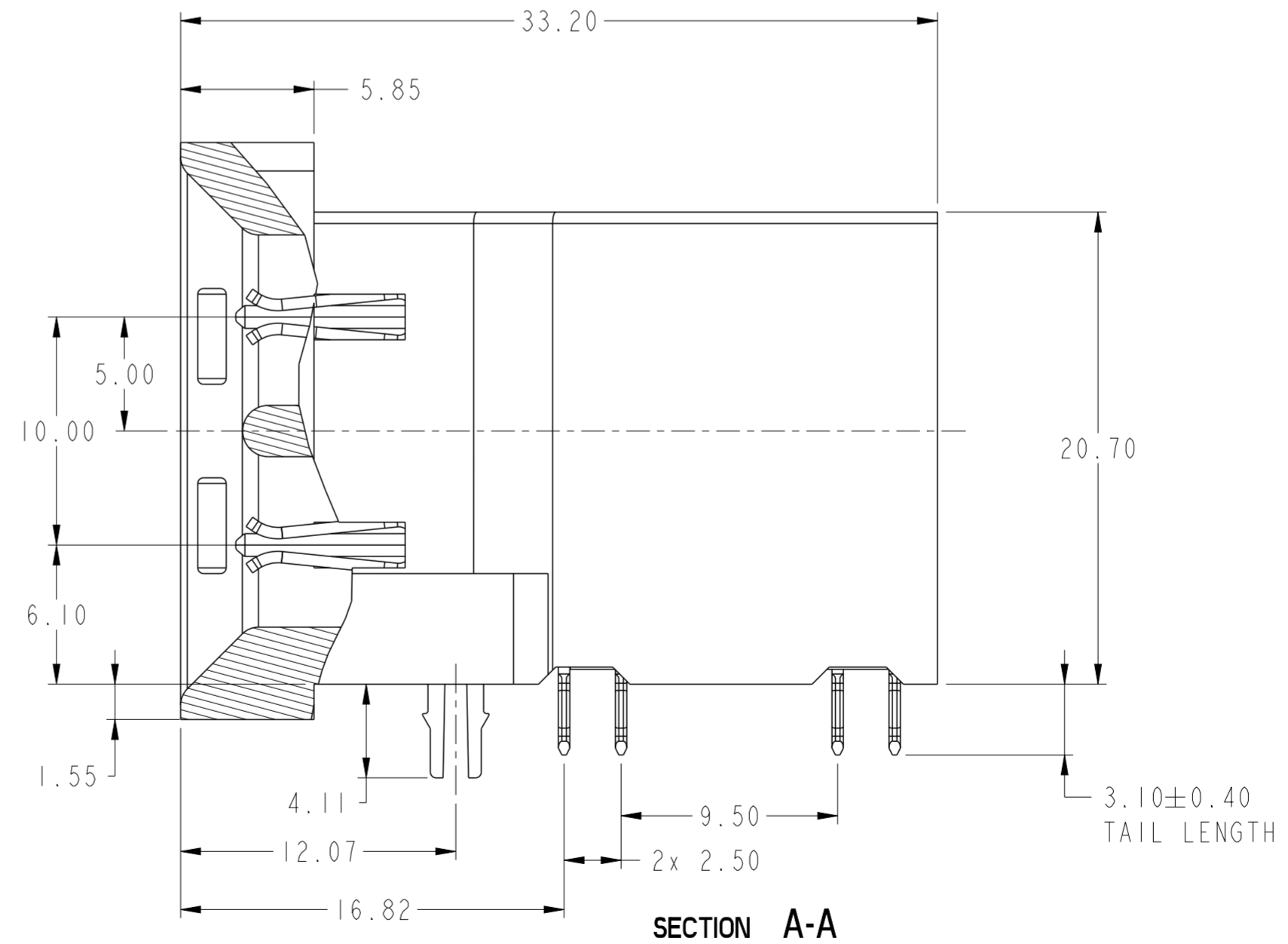
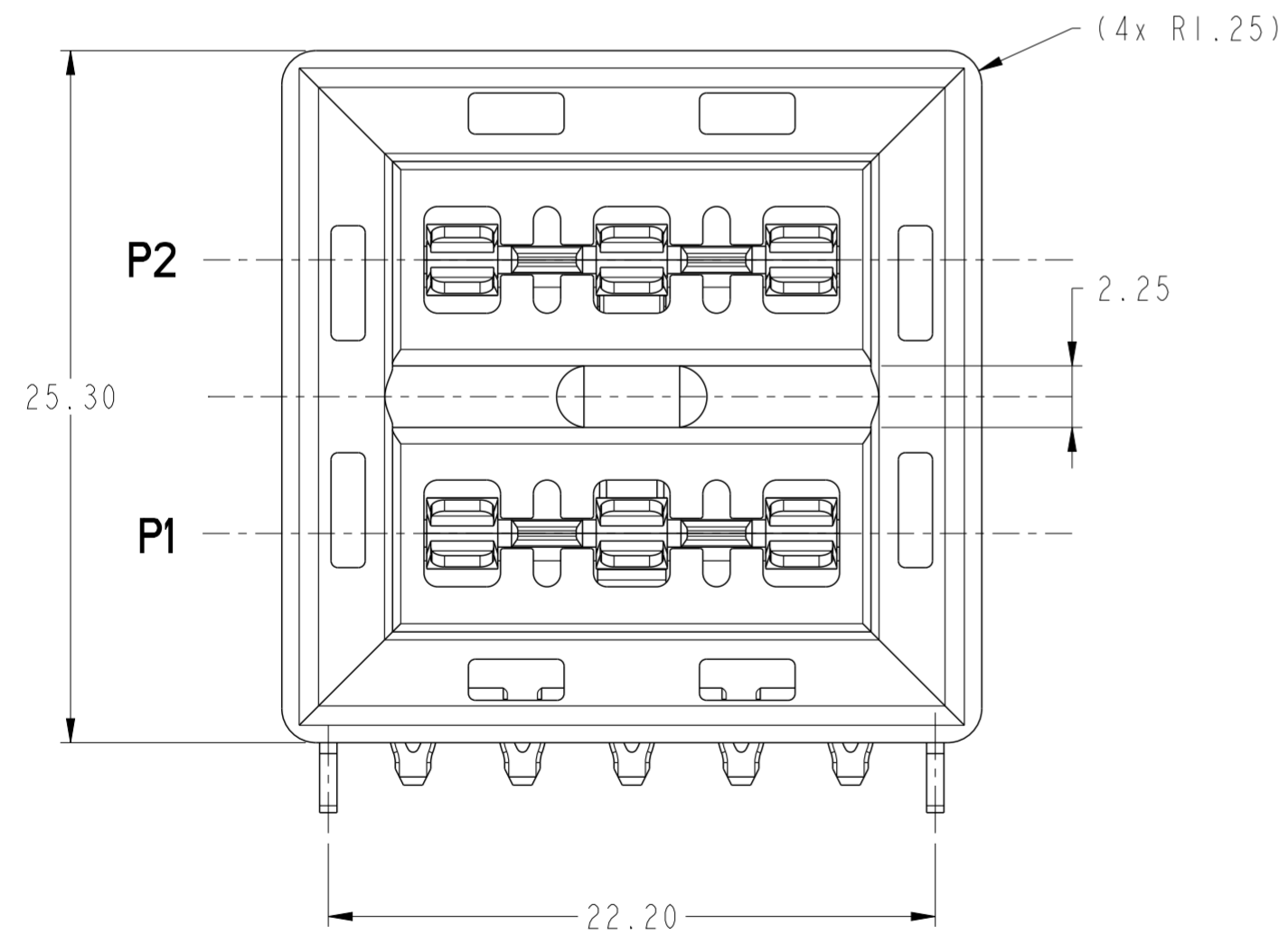
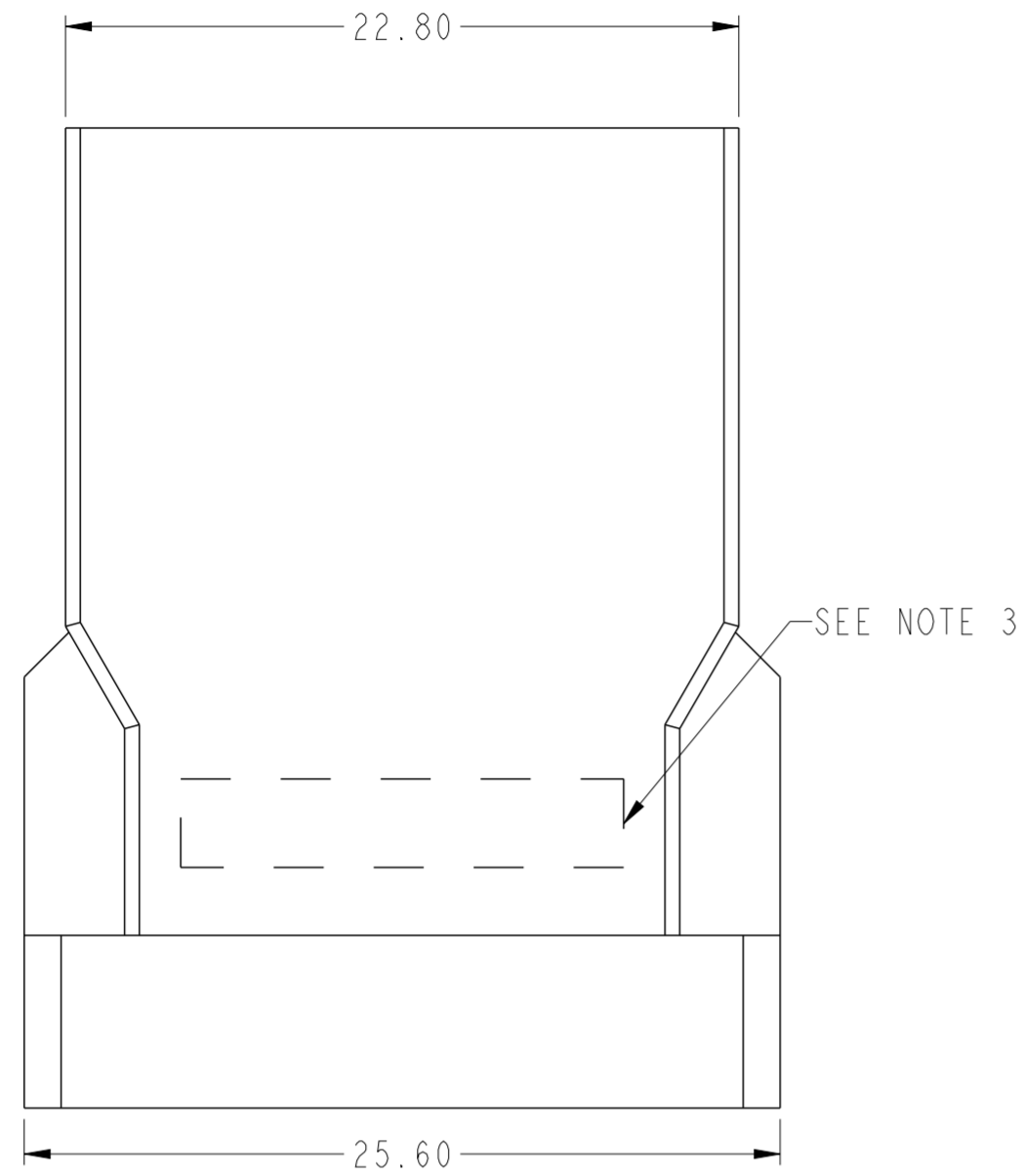

| | | | | | | | | | | | | |
|---------------------------------------|------------|------|----------------|---------------------|----------------|----------|----------------------------------|----|----------------------------------|---------------|------------------------|--------------|
| spec ref | - | dr | Chris Gieski | 2015/02/03 | projection | mm | size | A2 | scale | 4:1 | | |
| tolerance std | ASME Y14.5 | eng | Vicking Liu | 2018/01/23 | | mm | ecn no | - | rel level | Released | | |
| TOLERANCES UNLESS OTHERWISE SPECIFIED | | chr | Feng Zheng | 2018/01/23 | | | | | | | | |
| | | appr | Pei-Ming Zheng | 2018/01/23 | | | | | | | | |
| surface | linear | 0.X | ±0.5 | Amphenol FCI | product family | | R/A ORTHOGONAL PLUG ASSEMBLY 2DC | | title PWRMAX CONNECTOR SYSTEM | cat. no. - | Product - Customer Drw | sheet 1 of 7 |
| | | 0.XX | ±0.25 | | divg no | 10132640 | rev | A | | | | |
| | angular | 0° | ±2° | | | | | | | | | |

PDS: Rev :A

STATUS:Released

Printed: Jan 23, 2018

| | | | | | | | |
|----------------|---|------------------------------|---|---|---|---|---|
| 1 | 2 | 3 | 4 | 5 | 6 | 7 | 8 |
| PART NO | | DESCRIPTION | | | | | |
| 10132640-002LF | | BUSBAR BOLT HOLD DOWN OPTION | | | | | |

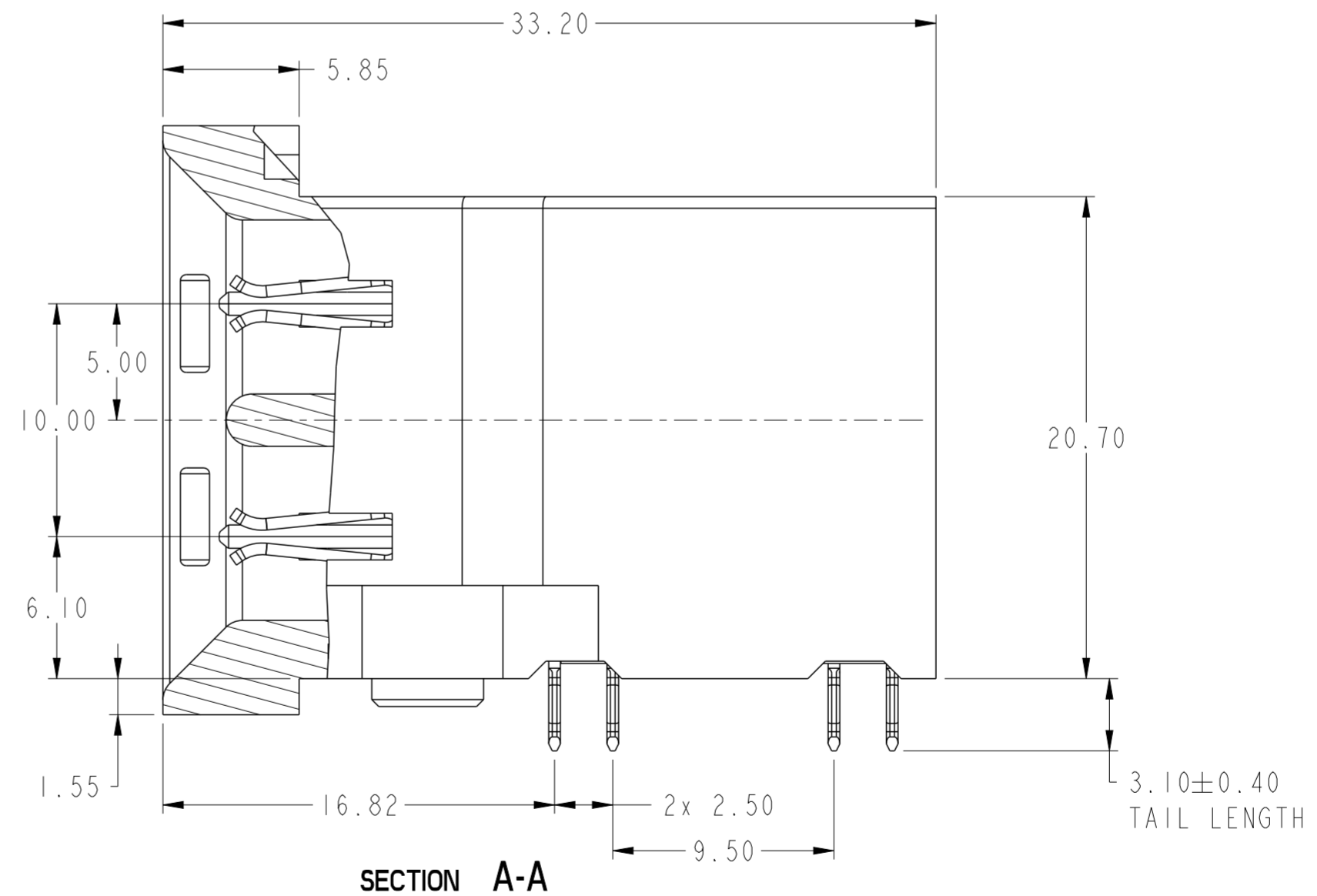
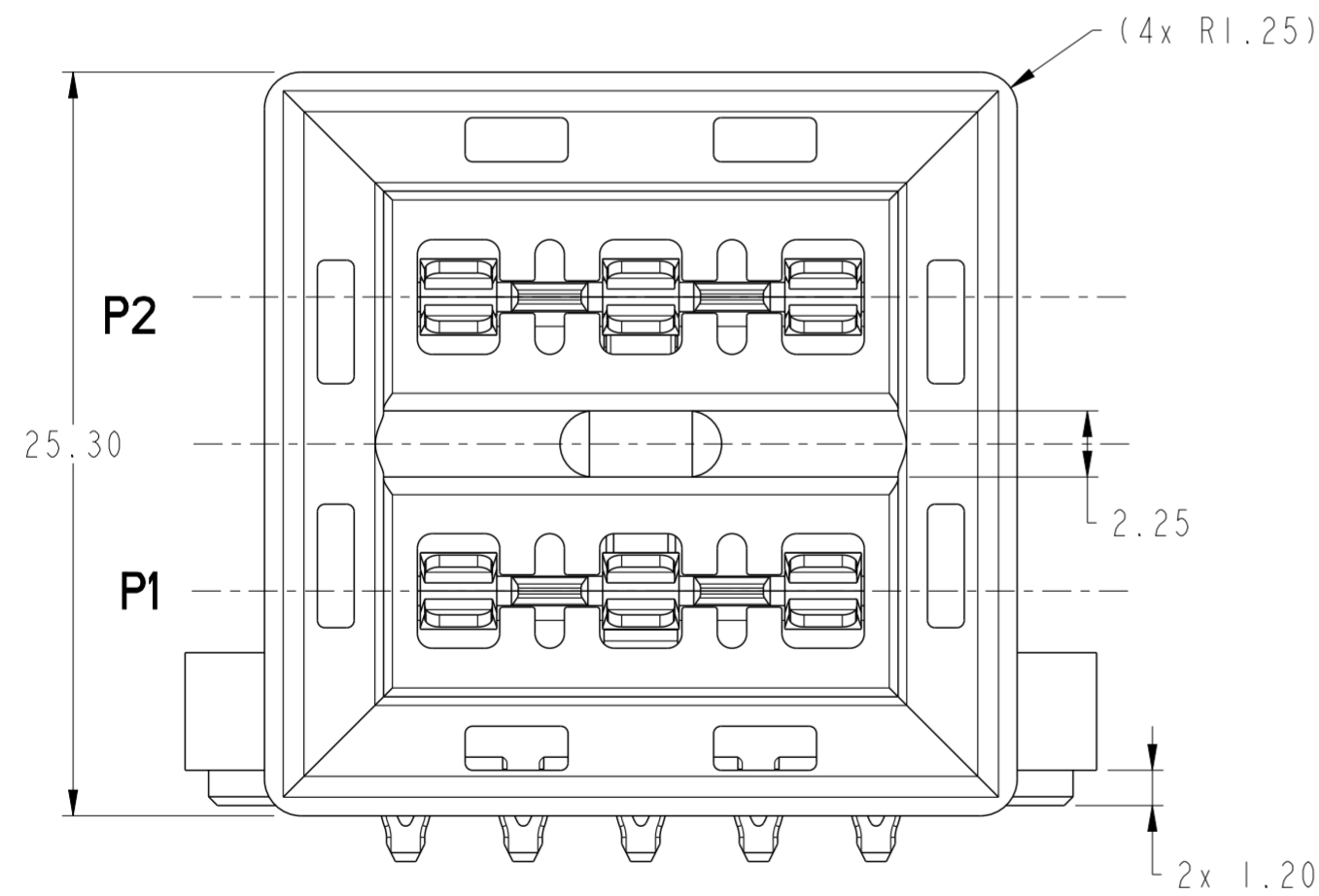
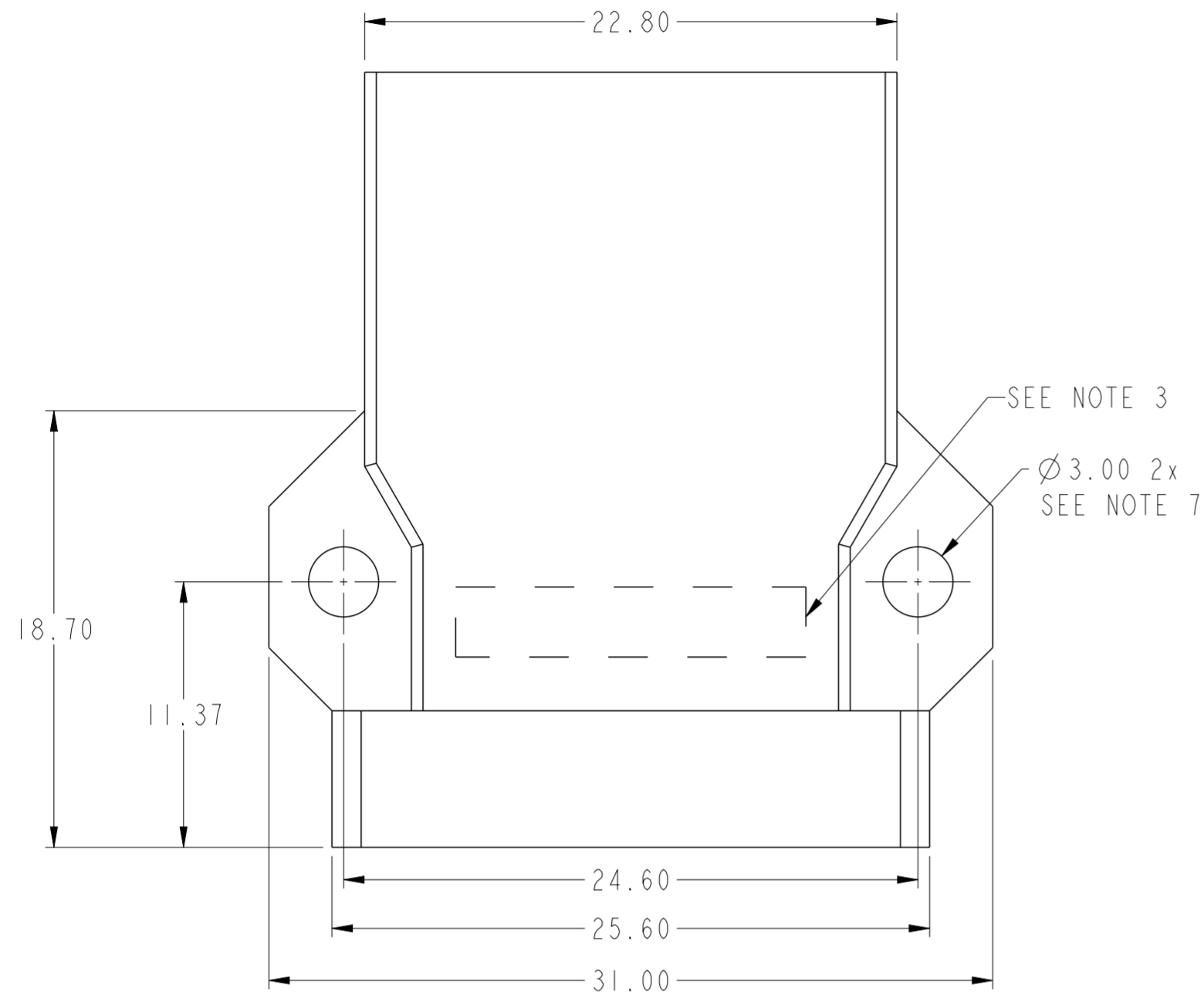

| | | | | | | | | | | | | |
|---------------------------------------|------------|-------|----------------|-------------|----------------------------------|-----------------|--------|-----------------------|-----------|----------------------------------------------------------------------|--------------------|----------|
| spec ref | - | dr | Chris Gieski | 2015/02/03 | projection | mm | size | A2 | scale | 2:1 | | |
| tolerance std | ASME Y14.5 | eng | Vicking Liu | 2018/01/23 | | mm | ecn no | - | rel level | Released | | |
| TOLERANCES UNLESS OTHERWISE SPECIFIED | | chr | Feng Zheng | 2018/01/23 | | | | | | | | |
| | | appr | Pai-Ming Zheng | 2018/01/23 | | | | | | | | |
| surface | linear | 0.X | ±0.5 | | product family | | - | rel level | Released | | | |
| | | 0.XX | ±0.25 | | R/A ORTHOGONAL PLUG ASSEMBLY 2DC | | | | | title R/A ORTHOGONAL PLUG ASSEMBLY 2DC PWRMAX CONNECTOR SYSTEM | dwg no 10132640 | rev A |
| | | 0.XXX | ±0.10 | | cat. no. | | | | | | | |
| | angular | 0° | ±2° | PDS: Rev :A | | STATUS:Released | | Printed: Jan 23, 2018 | | | | |

| | |
|----------------|----------------------------------|
| PART NO | DESCRIPTION |
| 10132640-003LF | PCB PLASTIC PEG HOLD DOWN OPTION |

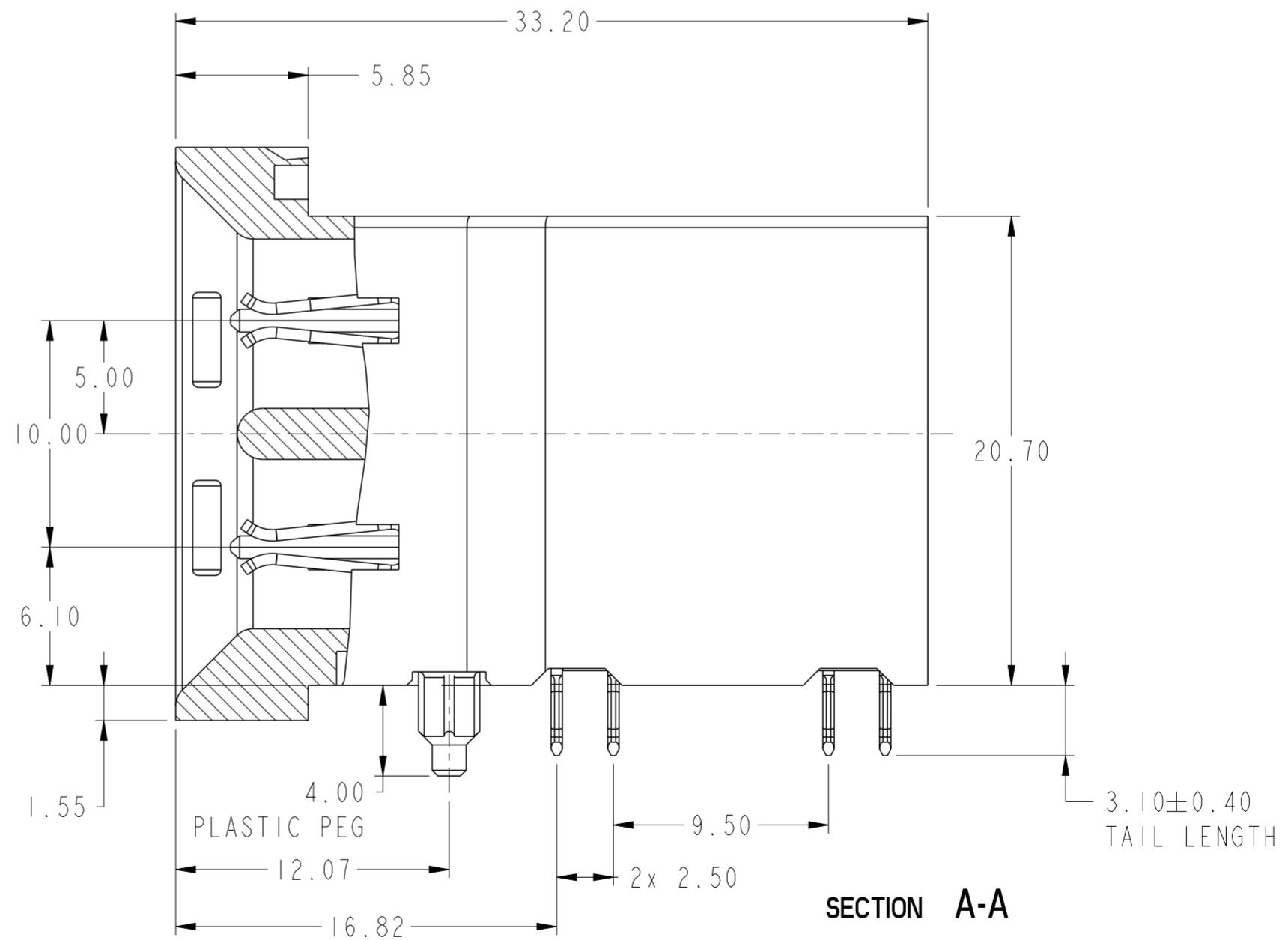
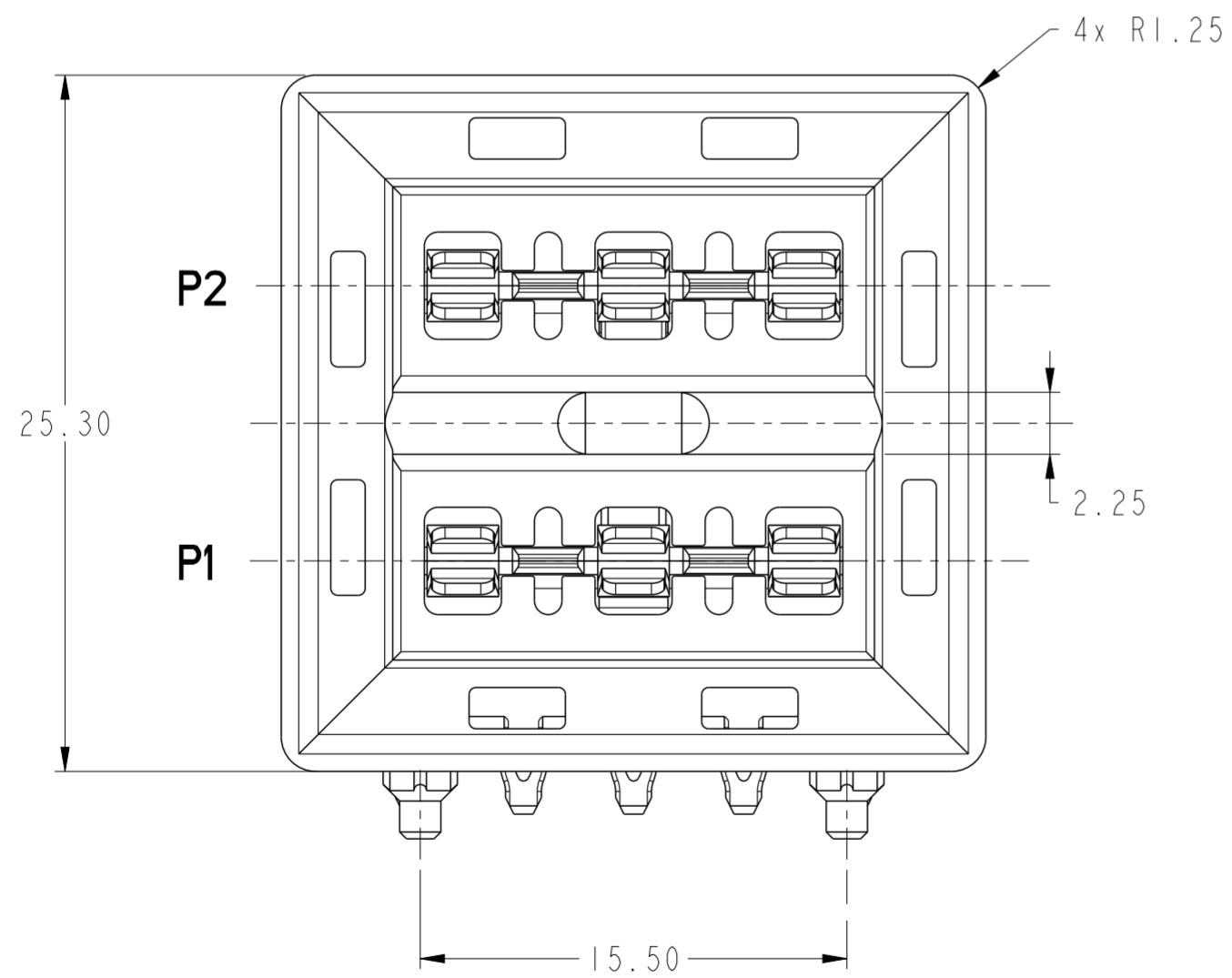
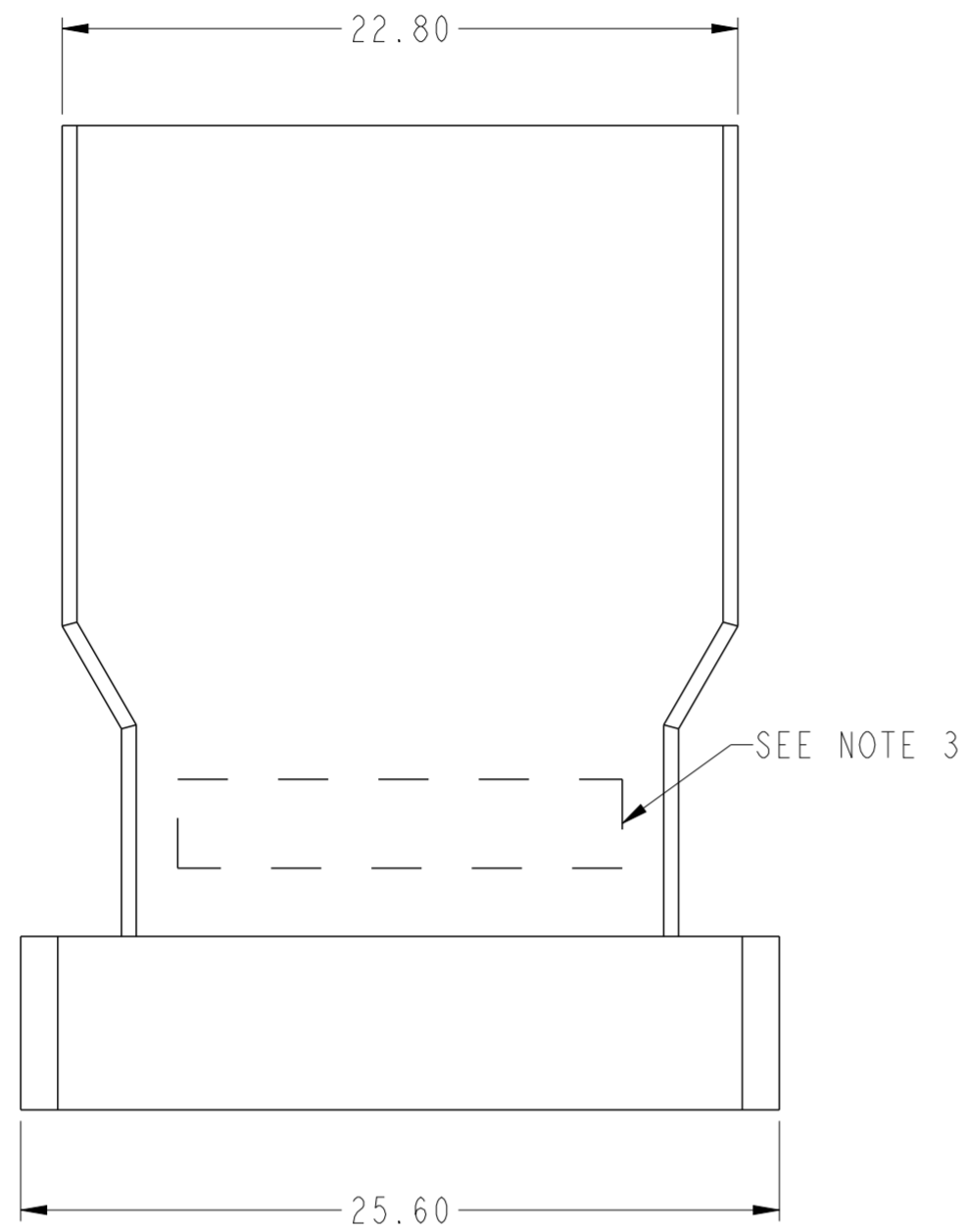

| | | | | | | | | | | |
|---------------------------------------|---------------------------------------|---------|----------------|------------|------------|------------------------|--------------|----------|---------------------|-------------------------------------------------------------|
| spec ref | - | dr | Chris Gieski | 2015/02/03 | projection | mm | size | A2 | scale | 4:1 |
| tolerance std | ASME Y14.5 | eng | Vicking Liu | 2018/01/23 | | | ecn no | - | Amphenol FCI | R/A ORTHOGONAL PLUG ASSEMBLY 2DC PWRMAX CONNECTOR SYSTEM |
| TOLERANCES UNLESS OTHERWISE SPECIFIED | | chr | Feng Zheng | 2018/01/23 | | | rel level | Released | | |
| surface | ASME Y14.5 | appr | Pai-Ming Zheng | 2018/01/23 | | | divg no | 10132640 | | |
| linear | 0.X ±0.5 0.XX ±0.25 0.XXX ±0.10 | angular | 0° ±2° | cat. no. | - | Product - Customer Drw | sheet 3 of 7 | | | |

PDS: Rev :A

STATUS:Released

Printed: Jan 23, 2018

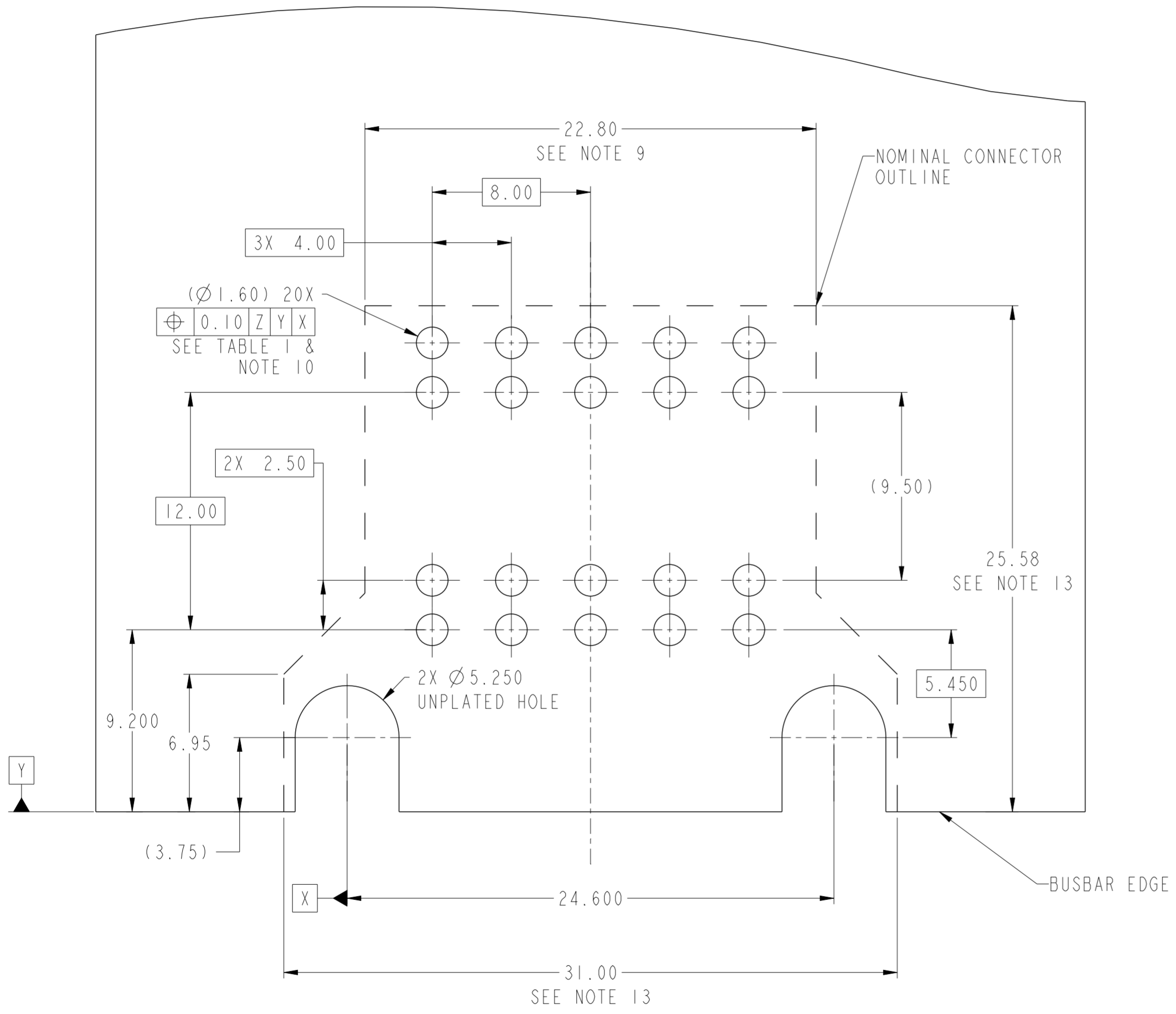

**RECOMMENDED BUSBAR LAYOUT
WITH BOLT HOLD DOWNS
SCALE 5:1**

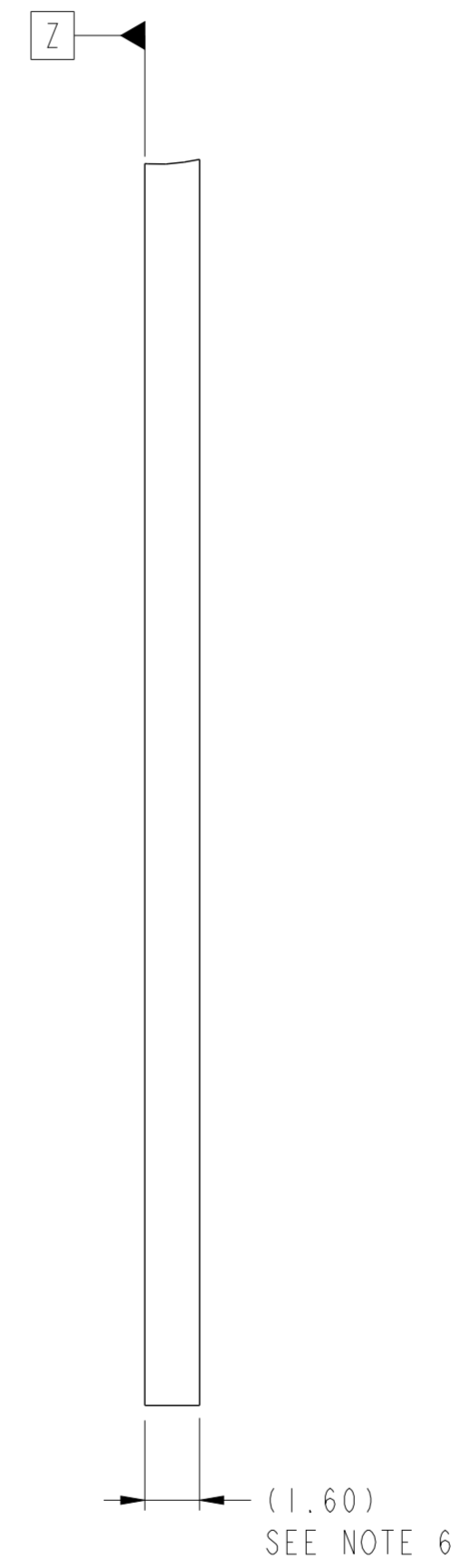

| | | | | | | | | | | |
|---------------------------------------|---------------------------------------|----------|----------------|-------------------------------------------------------------|------------|--------------------|----------------|----------|------------------------|--------------|
| spec ref | - | dr | Chris Gieski | 2015/02/03 | projection | mm | size | A2 | scale | 2:1 |
| tolerance std | ASME Y14.5 | eng | Vicking Liu | 2018/01/23 | | | ecn no | - | Product - Customer Drw | sheet 5 of 7 |
| TOLERANCES UNLESS OTHERWISE SPECIFIED | | chr | Feng Zheng | 2018/01/23 | | | rel level | Released | | |
| surface | ASME Y14.5 | appr | Pai-Ming Zheng | 2018/01/23 | | | product family | - | | |
| linear | 0.X ±0.5 0.XX ±0.25 0.XXX ±0.10 | | | R/A ORTHOGONAL PLUG ASSEMBLY 2DC PWRMAX CONNECTOR SYSTEM | | dwg no 10132640 | rev A | | | |
| angular | 0° ±2° | cat. no. | - | | - | | - | | | |

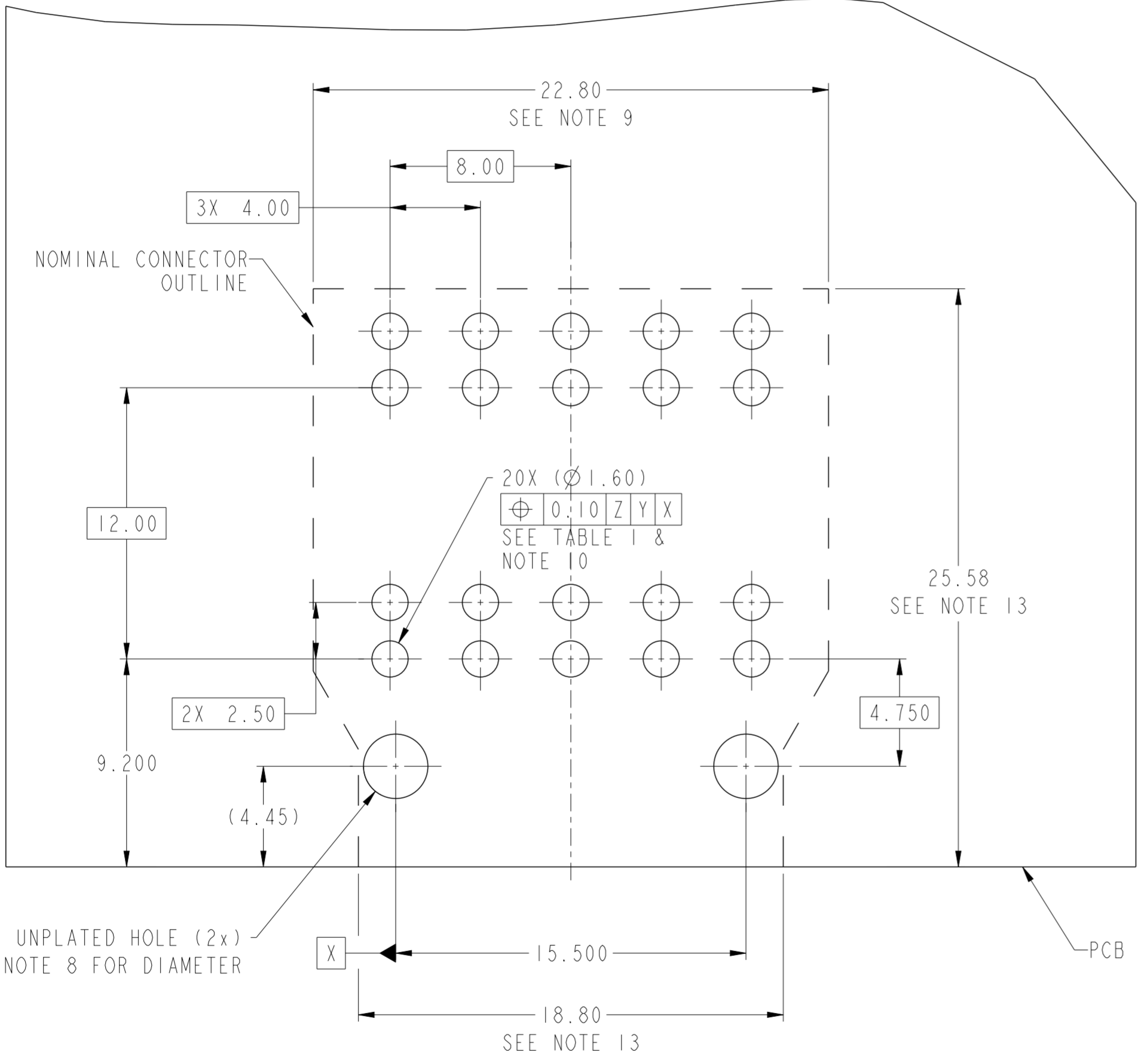

Z

(1.60)
SEE NOTE 6

**RECOMENDED LAYOUT
WITH PLASTIC PEG HOLD DOWNS
SCALE 5:1**

**Amphenol
FCi**

© 2016 AFci

| | | | | | | | | | | |
|---------------------------------------|---------------------------------------|-----------------|-------------------------------------------------------------|-----------------|------------|-----------------------|------------------------|--------------|-----------|-----|
| spec ref | - | dr | Chris Gieski | 2015/02/03 | projection | mm | size | A2 | scale | 4:1 |
| tolerance std | ASME Y14.5 | eng | Vicking Liu | 2018/01/23 | | | ecn no | - | rel level | |
| TOLERANCES UNLESS OTHERWISE SPECIFIED | | chr | Feng Zheng | 2018/01/23 | | | Released | | | |
| surface | ASME Y14.5 | appr | Pai-Ming Zheng | 2018/01/23 | | | Product - Customer Drw | | | |
| linear | 0.X ±0.5 0.XX ±0.25 0.XXX ±0.10 | Amphenol FCi | R/A ORTHOGONAL PLUG ASSEMBLY 2DC PWRMAX CONNECTOR SYSTEM | | cat. no. | - | Product - Customer Drw | sheet 6 of 7 | rev | A |
| angular | 0° ±2° | PDS: Rev :A | | STATUS:Released | | Printed: Jan 23, 2018 | | | | |

R/A ORTHOGONAL PLUG ASSEMBLY 2DC

| PRODUCT NUMBER | PLATING TYPE | DESCRIPTION |
|----------------|--------------|----------------------------------|
| 10132640-001LF | GCS | PCB METAL CLIP HOLD DOWN OPTION |
| 10132640-002LF | GCS | BUSBAR BOLT HOLD DOWN OPTION |
| 10132640-003LF | GCS | PCB PLASTIC PEG HOLD DOWN OPTION |

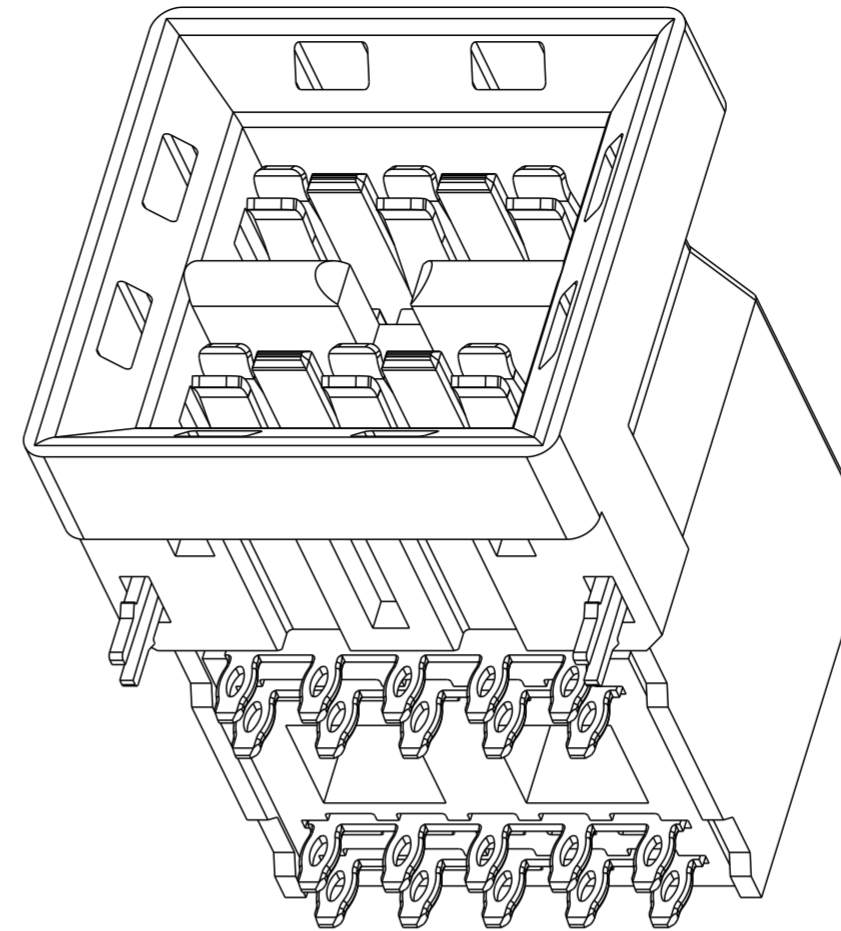

10132640-001LF
SCALE 3:1

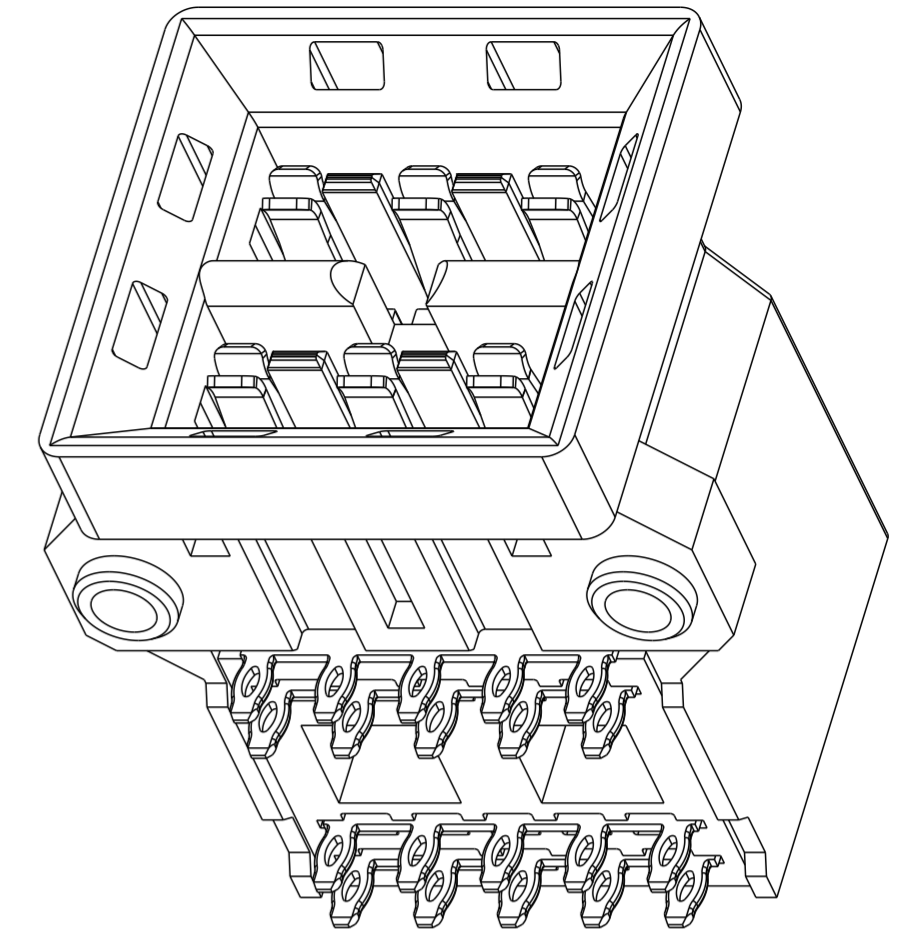

10132640-002LF
SCALE 3:1

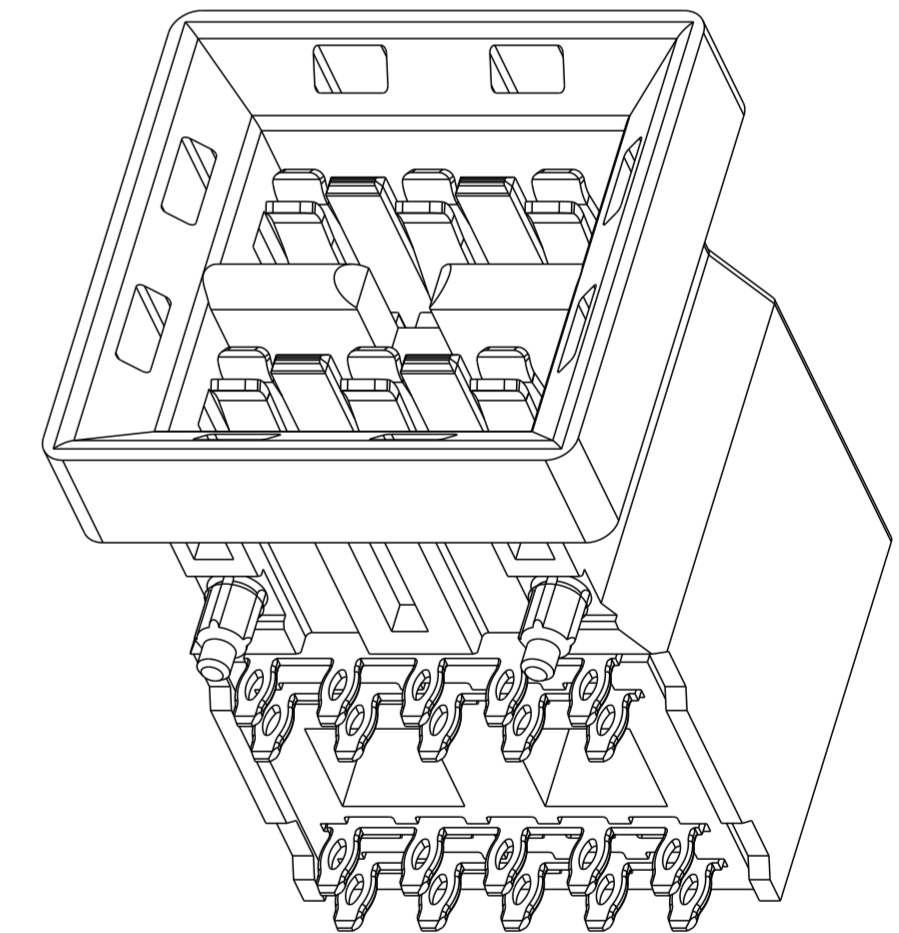

10132640-003LF
SCALE 3:1

NOTES:

- CONNECTOR MATERIALS:
HOUSING: HIGH TEMP THERMOPLASTIC, BLACK
UL94 V-0 COMPLIANT
CONTACTS: COPPER ALLOY
- PRODUCT SPECIFICATION: GS-12-1342.
APPLICATION SPECIFICATION: GS-20-0452.
PACKAGE IN TRAYS, PER SPECIFICATION: GS-14-2479.
- PRODUCT MARK:
PART NUMBER AND DATE CODE TO BE MARKED ON THIS SURFACE.
THE MARK CAN BE OMITTED IF THERE IS NOT ENOUGH SPACE ON THIS SURFACE.
- MINIMAL NOMINAL BUSBAR & PCB THICKNESS: 1.60 mm
- COPPER PLATING THICKNESS IN CENTER OF VIA-HOLE CAN BE NO MORE THAN 0.003 LESS THAN OTHER AREAS.
- ALL HOLE SIZES ARE FINISHED HOLE SIZES UNLESS OTHERWISE NOTED.
- USE STANDARD #4 X 40 UNC SCREW FOR MOUNTING HOLES IF APPLICABLE.
- PLASTIC PEG MOUNTING HOLES ARE UNPLATED.
Ø 2.85 ± 0.10 FOR PRESS-FIT TAILS
- CONNECTOR KEEP OUT ZONE.
- THIS PRODUCT MEETS EUROPEAN UNION DIRECTIVES AND OTHER COUNTRY REGULATIONS AS DESCRIBED IN GS-47-0004.

Amphenol
FCi

© 2016 AFCI

| | | | | | | | | | | |
|---------------------------------------|----------------------------------------------------------------------|-------------------------|----------------|----------------------------------------------------------------------|------------|--------------------|----------------|----|-------------------------|-----------------|
| spec ref | - | dr | Chris Gieski | 2015/02/03 | projection | mm | size | A2 | scale | 4:1 |
| tolerance std | ASME Y14.5 | eng | Vicking Liu | 2018/01/23 | | | ecn no | - | Released | rev A |
| TOLERANCES UNLESS OTHERWISE SPECIFIED | | chr | Feng Zheng | 2018/01/23 | | | rel level | - | | |
| surface | linear 0.X ±0.5 0.XX ±0.25 0.XXX ±0.10 angular 0° ±2° | appr | Pei-Ming Zheng | 2018/01/23 | | | product family | - | | |
| ASME Y14.5 | | Amphenol FCi | | title R/A ORTHOGONAL PLUG ASSEMBLY 2DC PWRMAX CONNECTOR SYSTEM | | dwg no 10132640 | cat. no. - | | Product - Customer Draw | sheet 7 of 7 |

PDS: Rev :A

STATUS:Released

Printed: Jan 23, 2018