



Chipsmall Limited consists of a professional team with an average of over 10 year of expertise in the distribution of electronic components. Based in Hongkong, we have already established firm and mutual-benefit business relationships with customers from,Europe,America and south Asia,supplying obsolete and hard-to-find components to meet their specific needs.

With the principle of “Quality Parts,Customers Priority,Honest Operation,and Considerate Service”,our business mainly focus on the distribution of electronic components. Line cards we deal with include Microchip,ALPS,ROHM,Xilinx,Pulse,ON,Everlight and Freescale. Main products comprise IC,Modules,Potentiometer,IC Socket,Relay,Connector.Our parts cover such applications as commercial,industrial, and automotives areas.

We are looking forward to setting up business relationship with you and hope to provide you with the best service and solution. Let us make a better world for our industry!



Contact us

Tel: +86-755-8981 8866 Fax: +86-755-8427 6832

Email & Skype: info@chipsmall.com Web: www.chipsmall.com

Address: A1208, Overseas Decoration Building, #122 Zhenhua RD., Futian, Shenzhen, China



Part number description :

10134259-XXXLF

- ▶ LF: Lead Free, RoHs compliant, see note
- ▶ XXX : Color ref or/and version

PN	Colour	Version
10134259-001LF	grey	

TECHNICAL DATA / DIMENSIONS

Dimensions	
Width mm	1.5
Length mm	44.0
Height mm	35.0

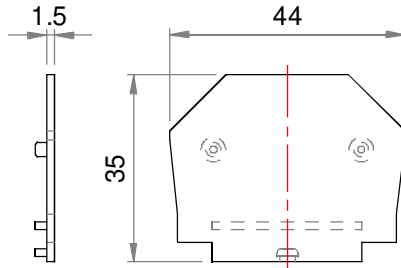

Note : THIS PRODUCT MEETS EUROPEAN UNION DIRECTIVES AND OTHER COUNTRY REGULATIONS AS PER GS-47-0004

ACCESSORIES

Item	Description
Additional items	
10134250-001LF	SCREW Terminal Block 2,5 – All colours
10134251-001LF	SCREW Terminal Block 4 – All colours
10134252-001LF	SCREW Terminal Block 5 – All colours

spec ref		dir	Aymeric Soudy	11-06-2015	projection	MM	size	A3	scale	1:1
tolerance std		eng	Aymeric Soudy	11-06-2015			ecn no		rel level	
ISO 406 ISO 1101		TOLERANCES UNLESS OTHERWISE SPECIFIED		appr			Aymeric Soudy	11-06-2015	product family	
surface		<input checked="" type="checkbox"/> linear <input type="checkbox"/> angular	0.X	± 0.3		title End Plate for SCREW Terminal Blocks 2,5-4	dwg no 10134259	rev A		
ISO 1302			0.XX	± 0.1						
		0.XXX	± 0.05							
			0°	± 2°	www.fcicon	cat. no.	-	Product customer drawing		sheet 1 of 1

