



Chipsmall Limited consists of a professional team with an average of over 10 year of expertise in the distribution of electronic components. Based in Hongkong, we have already established firm and mutual-benefit business relationships with customers from,Europe,America and south Asia,supplying obsolete and hard-to-find components to meet their specific needs.

With the principle of "Quality Parts,Customers Priority,Honest Operation,and Considerate Service",our business mainly focus on the distribution of electronic components. Line cards we deal with include Microchip,ALPS,ROHM,Xilinx,Pulse,ON,Everlight and Freescale. Main products comprise IC,Modules,Potentiometer,IC Socket,Relay,Connector.Our parts cover such applications as commercial,industrial, and automotives areas.

We are looking forward to setting up business relationship with you and hope to provide you with the best service and solution. Let us make a better world for our industry!



## Contact us

Tel: +86-755-8981 8866 Fax: +86-755-8427 6832

Email & Skype: [info@chipsmall.com](mailto:info@chipsmall.com) Web: [www.chipsmall.com](http://www.chipsmall.com)

Address: A1208, Overseas Decoration Building, #122 Zhenhua RD., Futian, Shenzhen, China



A	B	C
ISS.	DATE	E.C.N.
2	15-Jan-07	1/07/1198
2A	20-09-12	09/12/1348
		TOLERANCE CHANGE

© 2011 CTP-COIL  
ALL DIMENSIONS IN mm

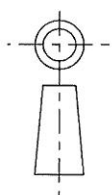

## CUSTOMER DRAWING

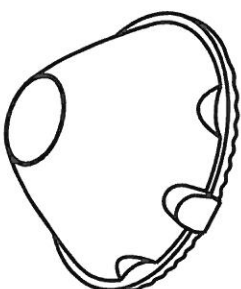
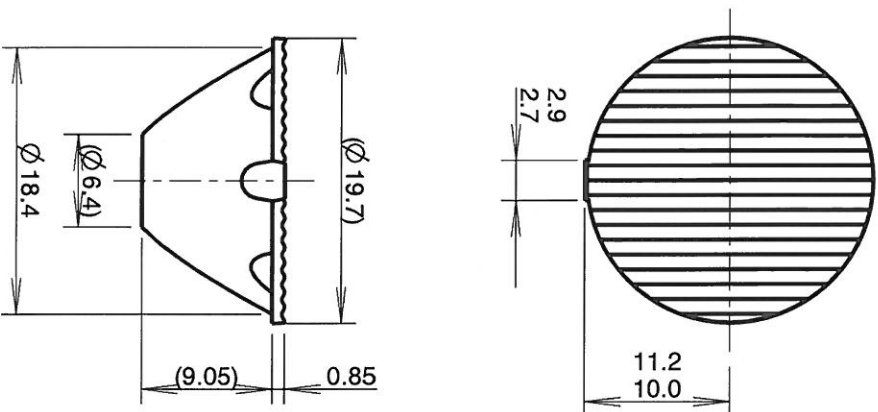

3D VIEW

NOTES:-  
1. MATERIAL: UV STABILISED POLYCARBONATE



technical plastics

CARCLO TECHNICAL PLASTICS (SLOUGH)  
103 BUCKINGHAM AVE, SLOUGH  
SL1 4PF, ENGLAND  
TEL: +44 1753 610800 FAX: +44 1753 811359  
e-mail: [design@carclo-optics.com](mailto:design@carclo-optics.com)

### GENERAL TOLERANCES (UNLESS STATED)

LINEAR	ANGULAR
X +/- 0.25	X +/- 1°
X.X +/- 0.1	X.X +/- 0.5°
X.XX +/- 0.05	X.XX +/- 0.1°

CUSTOMER

CARCLO

TITLE

LED Optic 25 Deg Linear  
Orthogonal Variant

DRAWN

AJD DATE 28-Jul-06

CHKD

DATE

APP'D

DATE

SCALE

CARCLO PART No.

2:1 10192

SIZE

CARCLO DRG. No.

SHEET

A4 60430 2 OF 2