



Chipsmall Limited consists of a professional team with an average of over 10 year of expertise in the distribution of electronic components. Based in Hongkong, we have already established firm and mutual-benefit business relationships with customers from,Europe,America and south Asia,supplying obsolete and hard-to-find components to meet their specific needs.

With the principle of “Quality Parts,Customers Priority,Honest Operation,and Considerate Service”,our business mainly focus on the distribution of electronic components. Line cards we deal with include Microchip,ALPS,ROHM,Xilinx,Pulse,ON,Everlight and Freescale. Main products comprise IC,Modules,Potentiometer,IC Socket,Relay,Connector.Our parts cover such applications as commercial,industrial, and automotives areas.

We are looking forward to setting up business relationship with you and hope to provide you with the best service and solution. Let us make a better world for our industry!



Contact us

Tel: +86-755-8981 8866 Fax: +86-755-8427 6832

Email & Skype: info@chipsmall.com Web: www.chipsmall.com

Address: A1208, Overseas Decoration Building, #122 Zhenhua RD., Futian, Shenzhen, China



SERIES

**103R
103**



Micro i® Chip Inductors

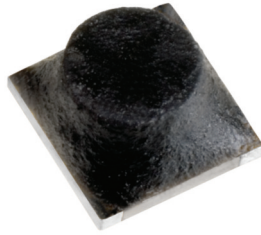
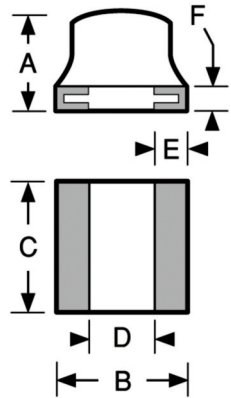

Actual Size

Military Specifications MIL-PRF-83446/04

Physical Parameters

	Inches	Millimeters
A	0.075 Max.	1.91 Max.
B	0.100 ± 0.010	2.54 ± 0.25
C	0.100 ± 0.010	2.54 ± 0.25
D	0.050 Min.	1.27 Min.
E	0.015 Min. (Typ.)	0.38 Min. (Typ.)
F	0.020 Max. (Typ.)	0.51 Max. (Typ.)

Weight Max. (Grams) 0.03

Current Rating at 90°C Ambient 35°C Rise

Operating Temperature Range -55°C to +125°C

Maximum Power Dissipation at 90°C 0.135 Watts

****Note**

Self Resonant Frequency (SRF) Values above 250 MHz are calculated and for reference only.

Termination Finish Options (Part # Code)

Gold over Nickel (Standard): As shown.

Tin/Lead over Nickel: Add suffix "S" to part # (e.g., 103-102KS).

Mil type "A:" Gold over Nickel (Standard)

Mil type "B" or "F:" Tin/Lead (solder) over Nickel.

RoHS type: Order 103R - XXXKS

Mechanical Configuration

Units are epoxy encapsulated.

Contact areas for reflow soldering are gold plated per MIL-G-45204 Type 1-Grade A. Internal connections are thermal compression bonded.

Packaging Tape & reel (8mm): 7" reel, 2000 pieces max.; 13" reel, 8000 pieces max.

Made In the U.S.A.

DASH NUMBER*	MIL DASH #	INDUCTANCE (µH) (see Note 3)	TOLERANCE	TEST FREQUENCY Q MINIMUM	SRF MINIMUM (MHz)	MAXIMUM (MHz)**	DC RESISTANCE MAXIMUM (OHMS)	CURRENT RATING MAXIMUM (mA)
--------------	------------	---------------------------------	-----------	-----------------------------	-------------------	-----------------	---------------------------------	--------------------------------

M83446/04- SERIES 103 PHENOLIC CORE								
-100M/K	30/37	0.010	± 20% / ± 10%	60	50.0	2700	0.060	1270
-120K	38	0.012	± 10%	57	50.0	2450	0.069	1190
-150M/K	31/39	0.015	± 20% / ± 10%	55	50.0	2200	0.078	1110
-180K	40	0.018	± 10%	52	50.0	2000	0.093	1030
-220M/K	32/41	0.022	± 20% / ± 10%	50	50.0	1800	0.108	950
-270K	42	0.027	± 10%	49	50.0	1625	0.114	925
-330M/K	33/43	0.033	± 20% / ± 10%	48	50.0	1450	0.120	900
-390K	44	0.039	± 10%	45	50.0	1335	0.133	860
-470M/K	34/45	0.047	± 20% / ± 10%	42	50.0	1220	0.145	820
-560K	46	0.056	± 10%	39	50.0	1110	0.170	760
-680M/K	35/47	0.068	± 20% / ± 10%	36	50.0	1000	0.195	705
-820K	48	0.082	± 10%	34	50.0	915	0.212	675
-101M/K	36/49	0.100	± 20% / ± 10%	32	50.0	830	0.230	650

M83446/04- SERIES 103 FERRITE CORE								
-121K	01	0.12	± 10%	30	25.0	750	0.125	880
-151K	02	0.15	± 10%	25	25.0	650	0.175	745
-181K	03	0.18	± 10%	25	25.0	550	0.200	695
-221K	04	0.22	± 10%	25	25.0	450	0.220	665
-271K	05	0.27	± 10%	25	25.0	375	0.230	650
-331K	06	0.33	± 10%	25	25.0	300	0.235	645
-391K	07	0.39	± 10%	22	25.0	235	0.240	635
-471K	08	0.47	± 10%	22	25.0	215	0.260	610
-561K	09	0.56	± 10%	22	25.0	195	0.278	590
-681K	10	0.68	± 10%	22	25.0	175	0.520	435
-821K	11	0.82	± 10%	22	25.0	160	0.530	430
-102K	12	1.0	± 10%	22	25.0	145	0.540	425
-122K	13	1.2	± 10%	22	7.9	130	0.740	360
-152K	14	1.5	± 10%	22	7.9	115	0.840	340
-182K	15	1.8	± 10%	22	7.9	105	0.920	325
-222K	16	2.2	± 10%	22	7.9	85	1.00	310
-272K	17	2.7	± 10%	24	7.9	77	1.15	290
-332K	18	3.3	± 10%	24	7.9	70	1.40	260
-392K	19	3.9	± 10%	24	7.9	68	1.55	250
-472K	20	4.7	± 10%	24	7.9	60	1.80	230
-562K	21	5.6	± 10%	22	7.9	55	2.00	220
-682K	22	6.8	± 10%	22	7.9	50	2.20	210
-822K	23	8.2	± 10%	22	7.9	48	2.50	195
-103K	24	10.0	± 10%	24	7.9	40	3.45	165
-123K	25	12.0	± 10%	25	2.5	35	3.80	160
-153K	26	15.0	± 10%	25	2.5	30	5.60	135
-183K	27	18.0	± 10%	25	2.5	28	5.80	130
-223K	28	22.0	± 10%	25	2.5	25	6.40	125
-273K	29	27.0	± 10%	25	2.5	22	6.90	120

Parts listed above are QPL/MIL qualified

Optional Tolerances: J = 5% H = 3% G = 2% F = 1%

*Complete part # must include series # PLUS the dash #

For surface finish information, refer to www.delevanfinishes.com