



Chipsmall Limited consists of a professional team with an average of over 10 year of expertise in the distribution of electronic components. Based in Hongkong, we have already established firm and mutual-benefit business relationships with customers from,Europe,America and south Asia,supplying obsolete and hard-to-find components to meet their specific needs.

With the principle of “Quality Parts,Customers Priority,Honest Operation,and Considerate Service”,our business mainly focus on the distribution of electronic components. Line cards we deal with include Microchip,ALPS,ROHM,Xilinx,Pulse,ON,Everlight and Freescale. Main products comprise IC,Modules,Potentiometer,IC Socket,Relay,Connector.Our parts cover such applications as commercial,industrial, and automotives areas.

We are looking forward to setting up business relationship with you and hope to provide you with the best service and solution. Let us make a better world for our industry!



Contact us

Tel: +86-755-8981 8866 Fax: +86-755-8427 6832

Email & Skype: info@chipsmall.com Web: www.chipsmall.com

Address: A1208, Overseas Decoration Building, #122 Zhenhua RD., Futian, Shenzhen, China



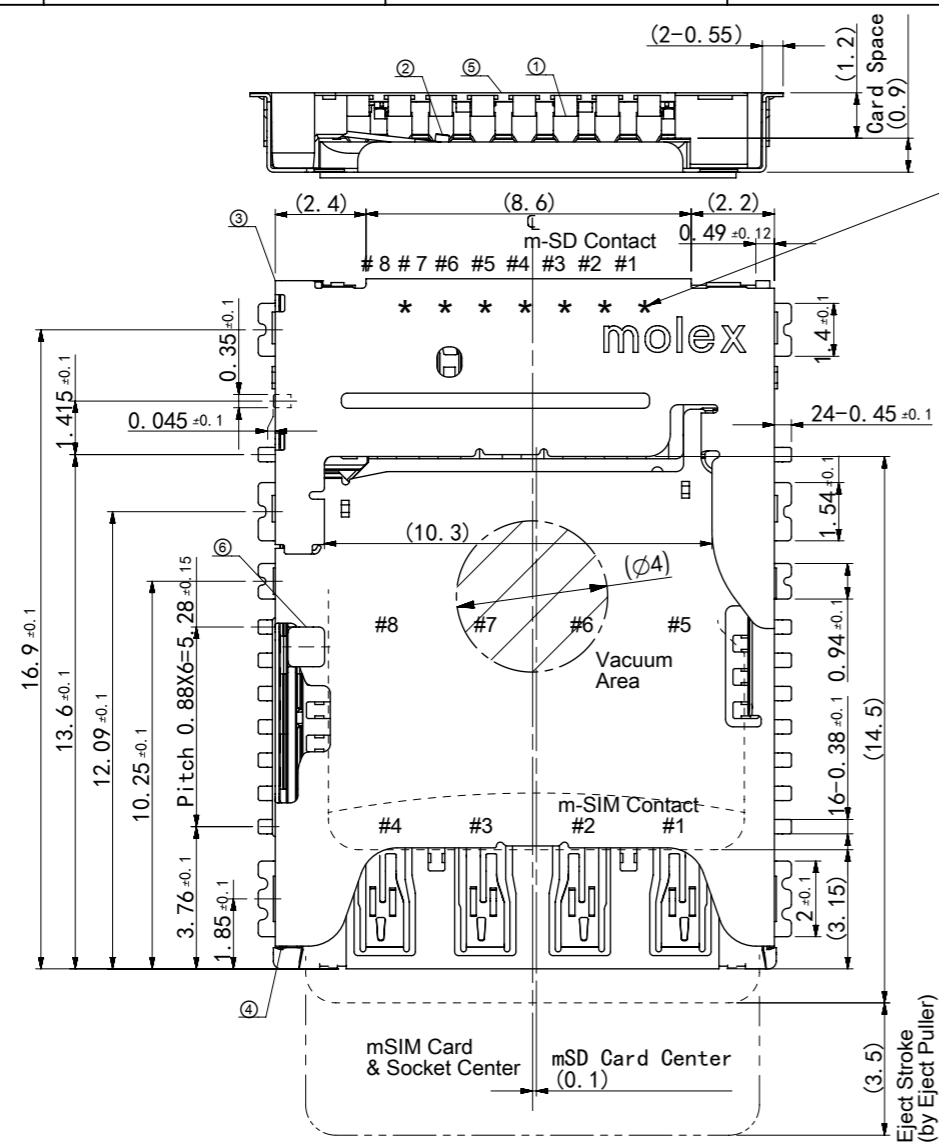

-DATE CODE-
example: MZB15A1
M-> Molex initial
2-> Year(2012)
B-> Month(November) 1, ...,9, A, B, C
15-> Date(15th)
A-> Site initial(Ansan)
1-> Manufacture line number

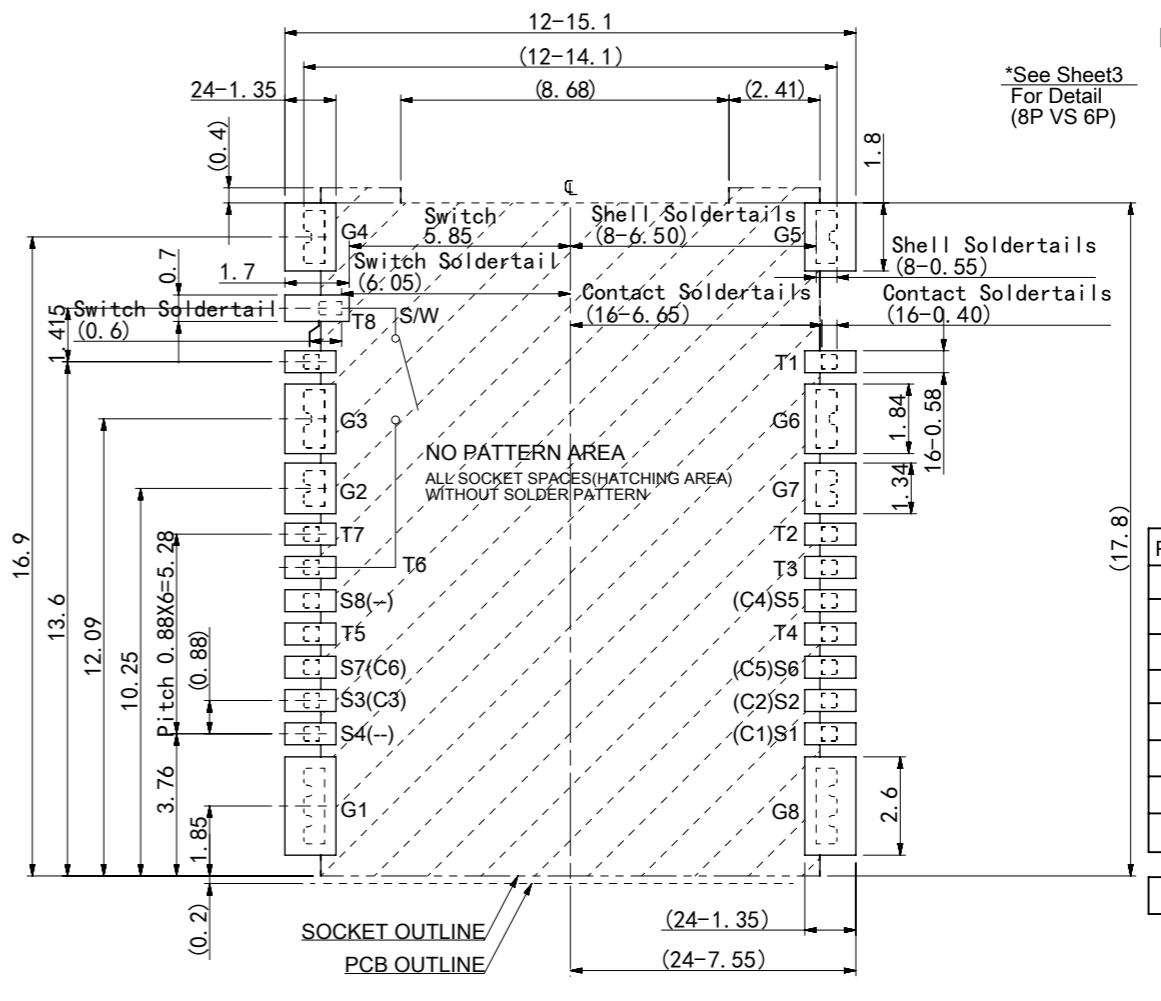
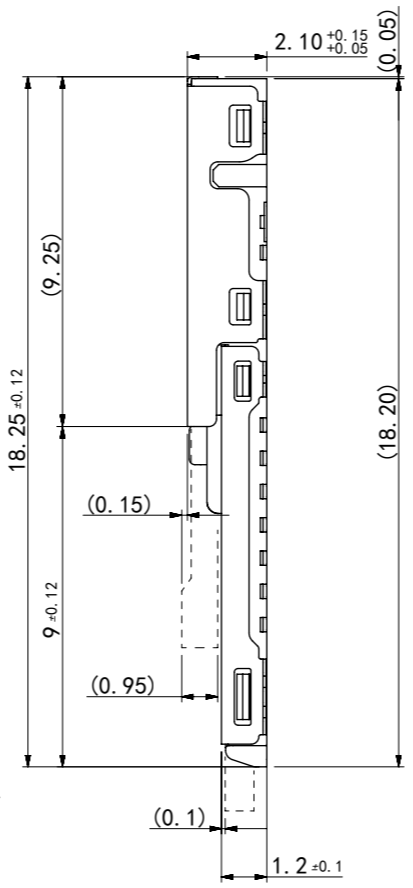

[microSIM CARD PIN-MAP]

8P	6P	DESCRIPTION
S1	C1	Vcc(Supply V)
S2	C2	RST(Reset)
S3	C3	CLK(Clock)
S4	--	Reserved
S5	C4	GND
S6	C5	Vpp(Program V)
S7	C6	I/O
S8	--	Reserved
G1~G8		GND

[microSD CARD PIN-MAP]

PIN NO.	DESCRIPTION
T1	DAT2
T2	CD/DAT3 ²
T3	CMD
T4	Vdd
T5	CLK
T6	Vss(GND)
T7	DAT0
T8	DAT1
S/W	CARD DETECTOR

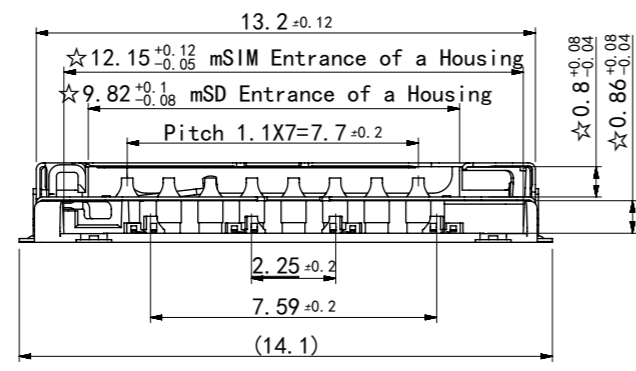

[Circuit diagram for Detection Switch of microSD card]

card insertion condition	card detect switch	Circuit mSD #6pin Switch terminal
Without Card	Open	
Card insertion	Close	

NO.	PARTS NAME	MATERIALS	FINISHES
1	CONTACT TERMINAL (16P)	COPPER ALLOY	CONTACT mSIM: GOLD 0.05µm MIN. OVER Pd-Ni 0.3µm MIN. CONTACT mSD: GOLD 0.05µm MIN. Pd-Ni 0.2µm MIN. SWITCH: GOLD 0.1µm MIN. (Pd-Ni IS PALLADIUM NICKEL) SOLDERS: GOLD 0.05µm MIN. BASE: NICKEL 1.27 MIN.
2	SWITCH TERMINAL	PHOSPHOR BRONZE	
3	microSD SHELL	STAINLESS STEEL	BRIGHT NICKEL 1.27µm MIN.
4	microSIM SHELL	STAINLESS STEEL	BRIGHT NICKEL 1.27µm MIN.
5	HOUSING	LIQUID CRYSTAL POLYMER	NATURAL(IVORY) COLOR, UL94V-0
6	EJECT PULLER	STAINLESS STEEL	NONE

- NOTES
- MATERIALS: SEE TABLE
 - FINISHES: SEE TABLE
 - MATES WITH
-UPPER: microSD Card
-LOWER: microSIM(UICC) Card
 - PRODUCT SPECIFICATIONS: PS-104642-001
 - PACKING SPECIFICATIONS: SPK-104642-002
 - COPLANARITY OF SOLDER TAILS: 0.08mm MAX. BEFORE & AFTER 250°C REFLOW 2TIMES
 - REFERENCE CARD DIMENSIONS ARE WITH STANDARD DIMENSION CARD
 - CUSTOMER'S CTF DIMENSION(☆) IS EQUAL TO MOLEX MAJOR QUALITY SYMBOL(▼)

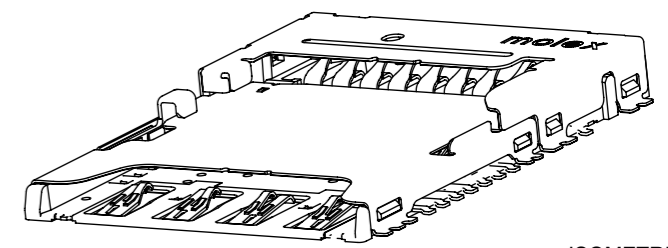

SMD ONLY	104642-1610	1046421610
SOLDER TYPE	PART (ORDER) NO.	MATERIAL NO.

THIS DRAWING CONTAINS INFORMATION THAT IS PROPRIETARY TO MOLEX ELECTRONIC TECHNOLOGIES, LLC AND SHOULD NOT BE USED WITHOUT WRITTEN PERMISSION

QUALITY SYMBOLS	<ul style="list-style-type: none"> FA = 0 FE = 0 FB = 0 ▼ = 1 C = 0 ⊗ = 0 ■ = 0 ▽ = 0 	<p>REDRAWN</p> <p>EC NO: 107531 DRWN: ECKIM CHK'D: SHCHU APPR: YSKIM02</p> <p>2016/09/01 2016/08/29 2016/08/29</p>	<p>GENERAL TOLERANCES (UNLESS SPECIFIED)</p> <p>ANGULAR TOL ± 1.0 °</p> <p>4 PLACES ±</p> <p>3 PLACES ± 0.12</p> <p>2 PLACES ± 0.12</p> <p>1 PLACE ± 0.15</p> <p>0 PLACES ± 0.15</p> <p>DRAFT WHERE APPLICABLE MUST REMAIN WITHIN DIMENSIONS</p>	<p>DIMENSION UNITS: MM</p> <p>SCALE: 5:1</p> <p>DRWN BY: YHJUNG02</p> <p>DATE: 2016/04/14</p> <p>CHK'D BY: SHCHU</p> <p>DATE: 2016/08/29</p> <p>APPR BY: YSKIM02</p> <p>DATE: 2016/08/29</p> <p>DRAWING SIZE: A3</p> <p>THIRD ANGLE PROJECTION</p>	<p>molex</p> <p>COMBO 2.10H PULLER TYPE MICROSD/MICROSIM 8P/8P WITH S/W</p> <p>PRODUCT CUSTOMER DRAWING</p> <p>SERIES: 104642</p> <p>MATERIAL NUMBER: 1046421610</p> <p>CUSTOMER: GENERAL</p> <p>DOCUMENT NUMBER: 1046421610</p> <p>DOC TYPE: PSD</p> <p>DOC PART: 000</p> <p>SHEET NUMBER: 1 OF 3</p>
-----------------	---	--	--	--	---

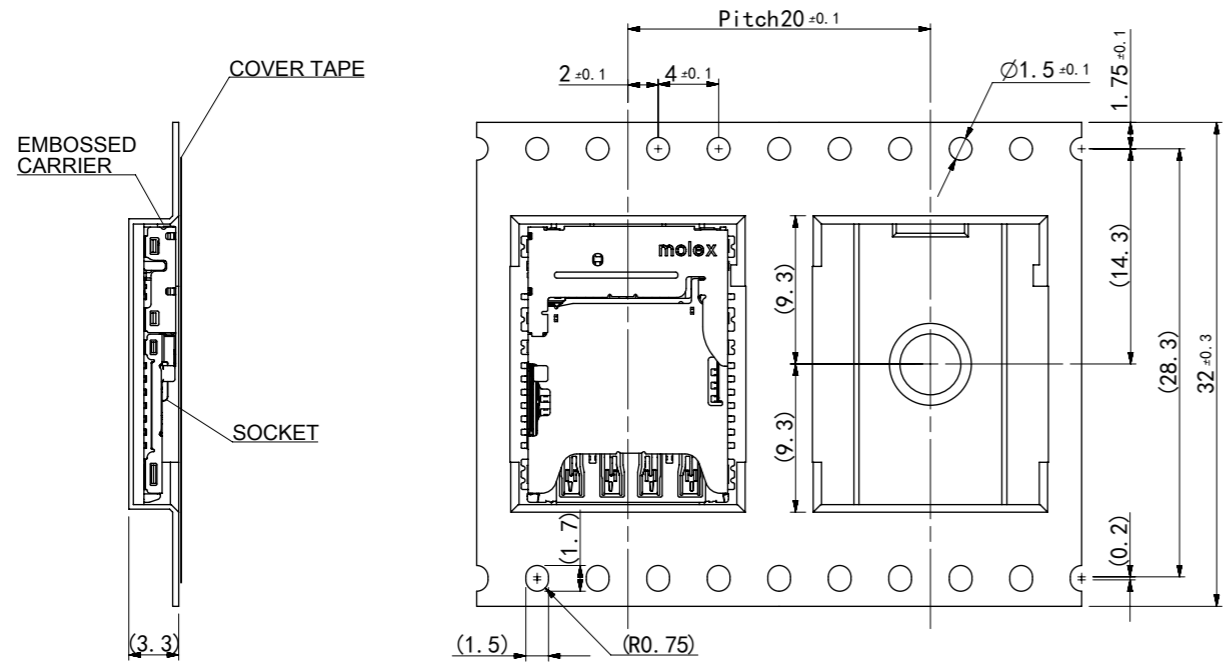

TOP VIEW OF EMBOSSED CARRIER

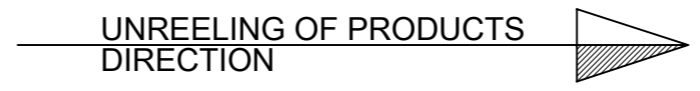

NOTES

1. QUANTITY OF PRODUCTS: 1,500 PCS /1 REEL
2. LEAD LENGTH
 - COVER TAPE NON-BONDED PART: 25 ±10
 - NUMBER OF EMPTY PART: 10~20PCS
 - UNREELING DIRECTION
 - COVER TAPE
 - TAIL PART (EMPTY) (60MIN.)
 - COMPONENT SUPPLIER
 - 400 ±80
3. PEELING OFF FORCE OF COVER TAPE: 0.1N~0.59N(10.2~60gf)
 (PEELING DIRECTION AS BELOW)
 -PEELING OFF SPEED: 300mm/Min.(Ref.)
 - REEL OFF DIRECTION
 - 10°
 - UNREELING DIRECTION
4. MATERIALS OF EMBOSSED CARRIER AND COVER TAPE: PET(POLYETHYLEN TEREPHTHALATE)

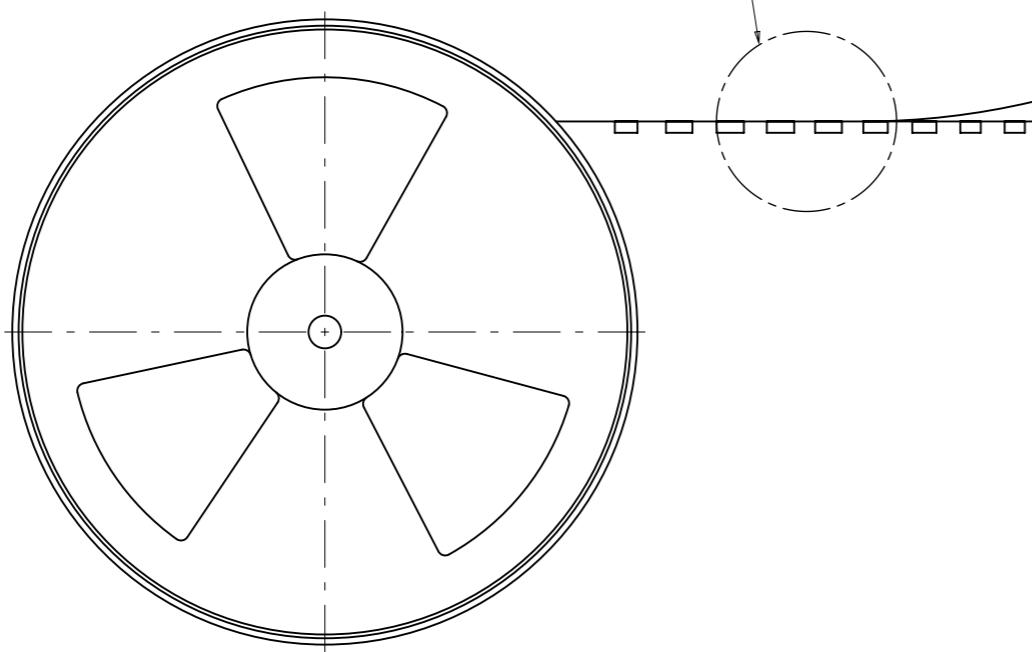
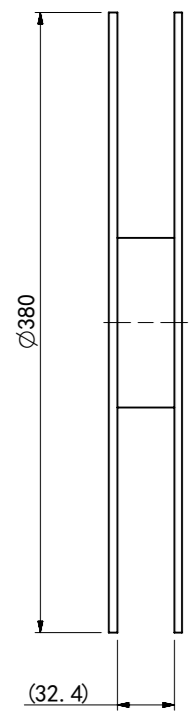

THIS DRAWING CONTAINS INFORMATION THAT IS PROPRIETARY TO MOLEX ELECTRONIC TECHNOLOGIES, LLC AND SHOULD NOT BE USED WITHOUT WRITTEN PERMISSION											
QUALITY SYMBOLS	EC NO: 107531 DRWN: ECKIM CHK'D: SHCHU APPR: YSKIM02	GENERAL TOLERANCES (UNLESS SPECIFIED)		DIMENSION UNITS	SCALE						
		ANGULAR TOL ± 1.0 °		MM	2:1						
FA = 0	REDRAWN 2016/09/01 2016/08/29 2016/08/29	4 PLACES ±		DRWN BY	DATE	COMBO 2.10H PULLER TYPE MICROSD/MICROSIM 8P/8P WITH S/W					
FE = 0		3 PLACES ± 0.12		YHJUNG02	2016/04/14						
FB = 0		2 PLACES ± 0.12		CHK'D BY	DATE						
FC = 0		1 PLACE ± 0.15		SHCHU	2016/08/29						
FD = 0		0 PLACES ± 0.15		APPR BY	DATE						
FE = 0		DRAFT WHERE APPLICABLE MUST REMAIN WITHIN DIMENSIONS		YSKIM02	2016/08/29						
FF = 0	EC NO: 107531	A3		DRAWING SIZE	THIRD ANGLE PROJECTION	PRODUCT CUSTOMER DRAWING					
FG = 0	DRWN: ECKIM	A3		A3		SERIES	MATERIAL NUMBER	CUSTOMER			
FH = 0	CHK'D: SHCHU	A3				104642	SEE SHEET 1	GENERAL			
FI = 0	APPR: YSKIM02	A3				DOCUMENT NUMBER		DOC TYPE	DOC PART	SHEET NUMBER	
FJ = 0		A3				1046421610		PSD	000	2 OF 3	

REFERENCE DRAWING

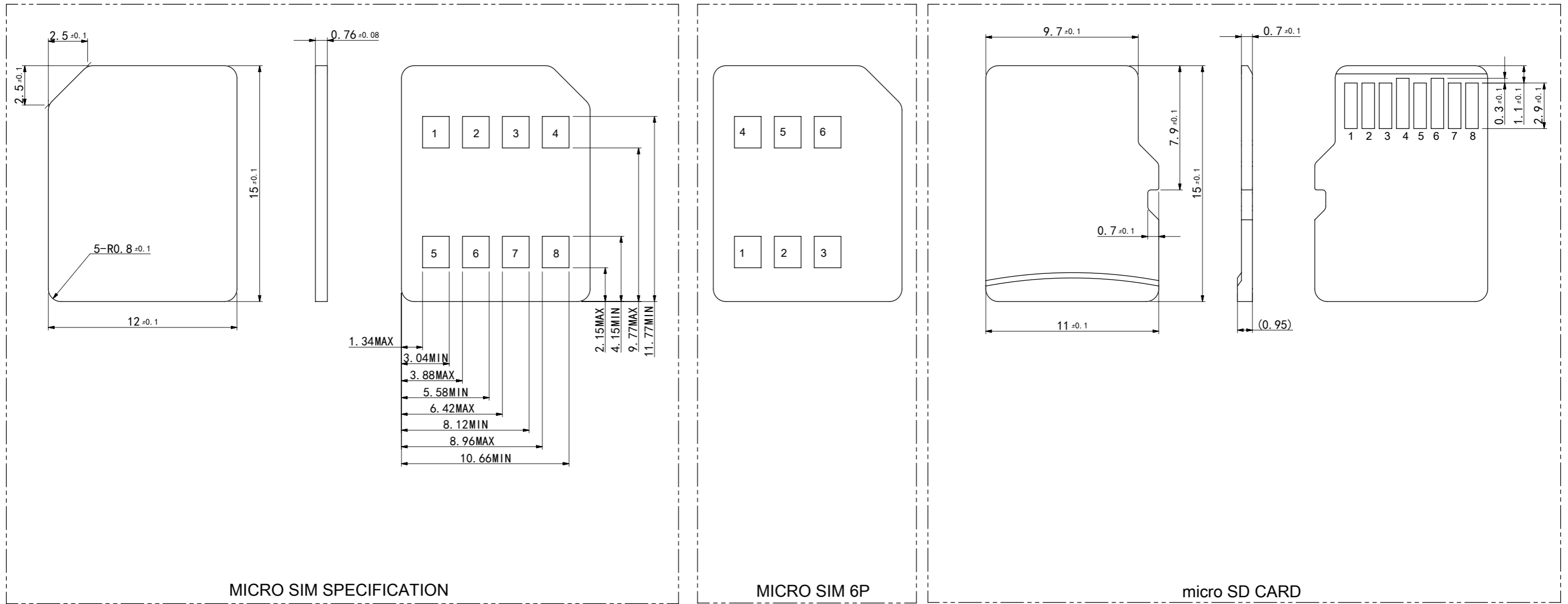

MICRO SIM SPECIFICATION

MICRO SIM 6P

micro SD CARD

[Reference Standards]
 -.microSD CArd Addendum Versopm 3.0 Draft 0.8
 -.ETSI TS 102 221 V9.1.0, Smart Cards, UICC-Terminal interface, Physical and logical characteristics

QUALITY SYMBOLS FA = 0 FE = 0 FP = 0 FV = 0 FC = 0 FX = 0 FS = 0 FT = 0	THIS DRAWING CONTAINS INFORMATION THAT IS PROPRIETARY TO MOLEX ELECTRONIC TECHNOLOGIES, LLC AND SHOULD NOT BE USED WITHOUT WRITTEN PERMISSION										
	REDRAWN EC NO: 107531 DRWN: ECKIM CHK'D: SHCHU APPR: YSKIM02	2016/09/01		2016/08/29		2016/08/29		GENERAL TOLERANCES (UNLESS SPECIFIED)		DIMENSION UNITS: MM SCALE: 4:1	
		ANGULAR TOL ± 1.0 °						DRWN BY: YHJUNG02		DATE: 2016/04/14	
		4 PLACES ±		3 PLACES ± 0.12		2 PLACES ± 0.12		CHK'D BY: SHCHU		DATE: 2016/08/29	
		1 PLACE ± 0.15		0 PLACES ± 0.15		APPR BY: YSKIM02		DATE: 2016/08/29		PRODUCT CUSTOMER DRAWING	
		DRAFT WHERE APPLICABLE MUST REMAIN WITHIN DIMENSIONS						DRAWING SIZE: A3		THIRD ANGLE PROJECTION	
	SERIES: 104642			MATERIAL NUMBER: SEE SHEET 1			CUSTOMER: GENERAL				
	DOCUMENT NUMBER: 1046421610			DOC TYPE: PSD		DOC PART: 000		SHEET NUMBER: 3 OF 3			