



Chipsmall Limited consists of a professional team with an average of over 10 year of expertise in the distribution of electronic components. Based in Hongkong, we have already established firm and mutual-benefit business relationships with customers from,Europe,America and south Asia,supplying obsolete and hard-to-find components to meet their specific needs.

With the principle of “Quality Parts,Customers Priority,Honest Operation,and Considerate Service”,our business mainly focus on the distribution of electronic components. Line cards we deal with include Microchip,ALPS,ROHM,Xilinx,Pulse,ON,Everlight and Freescale. Main products comprise IC,Modules,Potentiometer,IC Socket,Relay,Connector.Our parts cover such applications as commercial,industrial, and automotives areas.

We are looking forward to setting up business relationship with you and hope to provide you with the best service and solution. Let us make a better world for our industry!



## Contact us

Tel: +86-755-8981 8866 Fax: +86-755-8427 6832

Email & Skype: info@chipsmall.com Web: www.chipsmall.com

Address: A1208, Overseas Decoration Building, #122 Zhenhua RD., Futian, Shenzhen, China



13	12	11	10	9	8	7	6	5	4	3	2	1			
CONNECTOR P/N	CONNECTOR TYPE	FERRULE HOLE $\phi D$ ( $\mu m$ )	FERRULE HOLE CONCENTRICITY $\phi d$ ( $\mu m$ )	HOUSING COLOR	BOOT COLOR	BOOT LOGO VERSION									
1060257420	SINGLE MODE	125.5	1.0	BLUE	WHITE	MOLEX LOGO									
1060257451					BLUE										
1060257452					BEIGE										
1060247453					YELLOW										
1060257454					WHITE										
1060257455		RED			126.0		NO LOGO	GREEN							
1060257456		BLUE													
1060257457		BEIGE													
1060257458		YELLOW													
1060257459		WHITE													
1060257460	MULTIMODE	127.0	3.0	BEIGE	RED	MOLEX LOGO									
1060257461					GREEN										
1060257462					BEIGE										
1060257470					WHITE										
1060257471															

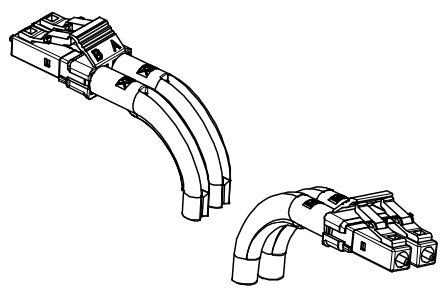
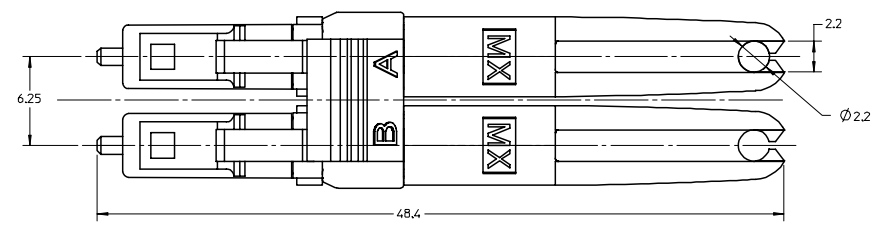

ISOMETRIC VIEWS  
SCALE 1.5:1

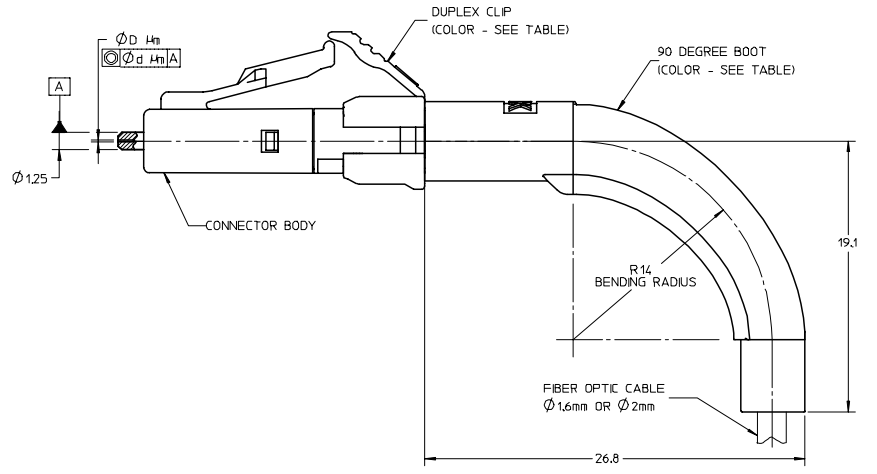
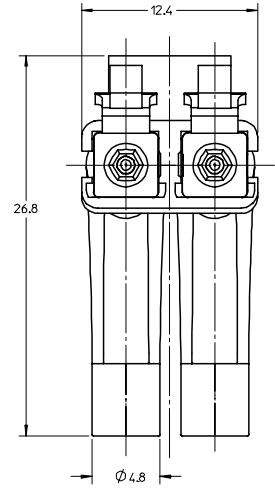

- NOTES:
1. ALL DIMENSIONS ARE FOR REFERENCE ONLY.
  2. DUST CAPS ARE NOT SHOWN.
  3. DUPLEX CLIP AND 90 DEGREE BOOTS SHOULD BE ASSEMBLED AFTER POLISHING OPERATION.

ENTER DESCRIPTION EC NO: MF2008-0240 DRAWN: IGM:IN 2007/12/04 CHKD: 2007/12/04 APPR: IGM:IN 2007/12/05 REVISIONS	QUALITY SYMBOLS	GENERAL TOLERANCES (UNLESS SPECIFIED) 4 PLACES ± --- ± --- 3 PLACES ± --- ± --- 2 PLACES ± --- ± --- 1 PLACE ± --- ± --- ANGULAR ±1/2°	DIMENSION STYLE	SCALE	DESIGN UNITS	THIRD ANGLE PROJECTION
			MM ONLY	4:1	METRIC	

DRAWN BY	DATE	TITLE
BG	12/01/05	LC DUPLEX CONNECTOR, 90 DEG. TIGHT BEND BOOT, 1.6&2.0MM CABLE
CHECKED BY	DATE	
APPROVED BY	DATE	
MATERIAL NO.	DOCUMENT NO.	SHEET NO.
SEE TABLE	SD-106025-74XX	1 OF 1

DRAFT WHERE APPLICABLE MUST REMAIN WITHIN DIMENSIONS		THIS DRAWING CONTAINS INFORMATION THAT IS PROPRIETARY TO MOLEX INCORPORATED AND SHOULD NOT BE USED WITHOUT WRITTEN PERMISSION	
--	--	---	--