



Chipsmall Limited consists of a professional team with an average of over 10 year of expertise in the distribution of electronic components. Based in Hongkong, we have already established firm and mutual-benefit business relationships with customers from,Europe,America and south Asia,supplying obsolete and hard-to-find components to meet their specific needs.

With the principle of “Quality Parts,Customers Priority,Honest Operation,and Considerate Service”,our business mainly focus on the distribution of electronic components. Line cards we deal with include Microchip,ALPS,ROHM,Xilinx,Pulse,ON,Everlight and Freescale. Main products comprise IC,Modules,Potentiometer,IC Socket,Relay,Connector.Our parts cover such applications as commercial,industrial, and automotives areas.

We are looking forward to setting up business relationship with you and hope to provide you with the best service and solution. Let us make a better world for our industry!



Contact us

Tel: +86-755-8981 8866 Fax: +86-755-8427 6832

Email & Skype: info@chipsmall.com Web: www.chipsmall.com

Address: A1208, Overseas Decoration Building, #122 Zhenhua RD., Futian, Shenzhen, China



10	9	8	7	6	5	4	3	2	1
P/N OF CONNECTOR	COLOR OF BOOT	φ D (μm)	CABLE DIAMETER	CABLE TYPE					
106053-0400	BLACK	127 ⁺³ ₋₀	3.0 mm	MULTIMODE					
106053-2400	YELLOW	125.5 ⁺¹ ₋₀		SINGLE MODE					
106053-2470	BLACK			SINGLE MODE					
106053-2480	RED	128 ⁺² ₋₀		MULTIMODE					
106053-3400	BLACK			MULTIMODE					
106053-4400	YELLOW	125 ^{+0.5} ₋₀		SINGLE MODE					
106053-5400	YELLOW	126.0 ⁺¹ ₋₀							
106053-5470	BLACK								
106053-5480	RED								

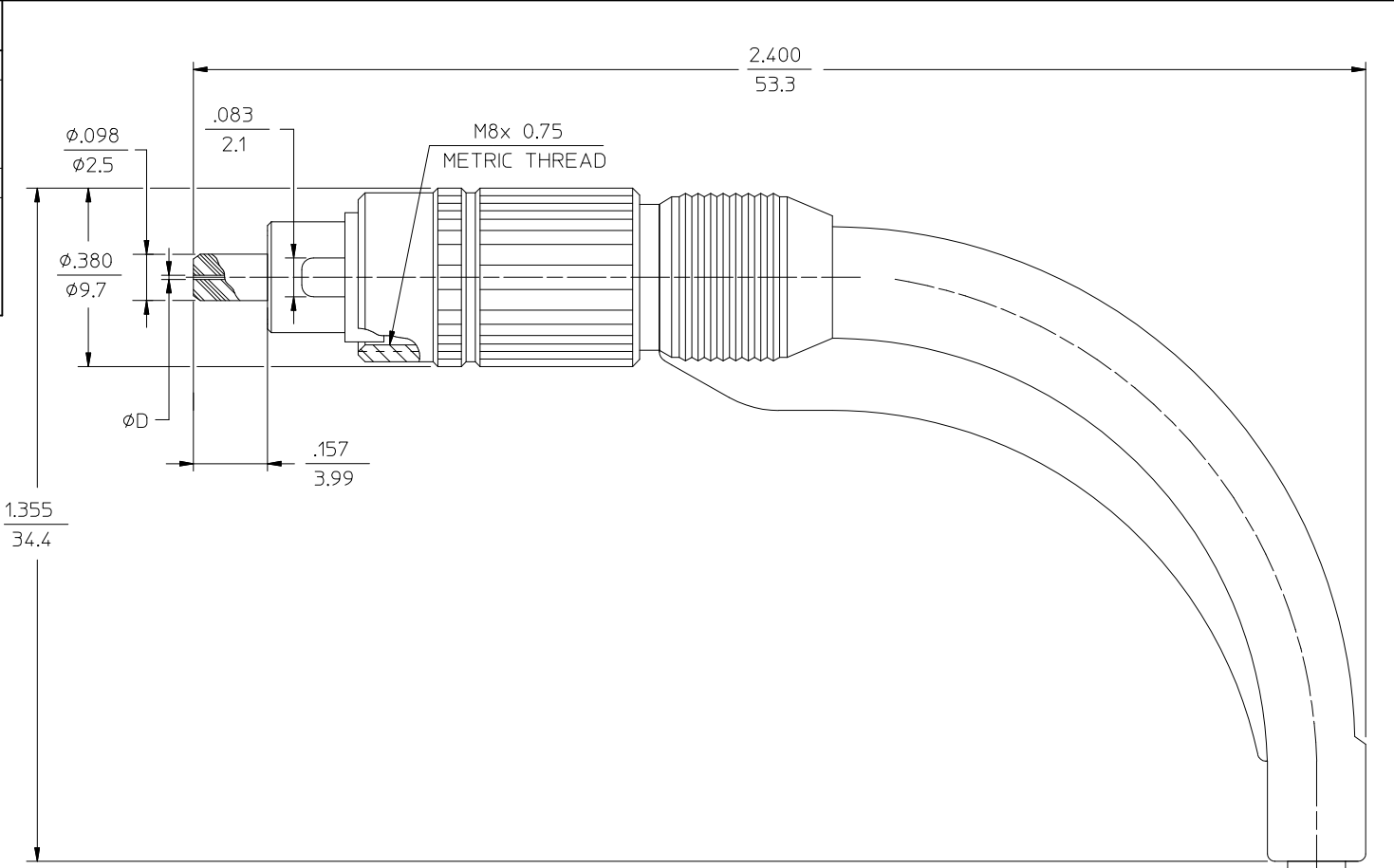

FIBER OPTIC CABLE

NOTE:
1. DUST CAP INCLUDED, BUT NOT SHOWN.

ENTER DESCRIPTION EC NO: MF2012-0610 DRAWN: MGHAYERE 2012/06/06 CHKD: LGUMIN 2012/06/08 APPR: LGUMIN 2012/06/08 REV: A1	QUALITY SYMBOLS ▽=0 ▽7=0	GENERAL TOLERANCES (UNLESS SPECIFIED) <table border="1"> <thead> <tr> <th></th> <th>mm</th> <th>INCH</th> </tr> </thead> <tbody> <tr> <td>4 PLACES</td> <td>± ---</td> <td>± ---</td> </tr> <tr> <td>3 PLACES</td> <td>± ---</td> <td>± ---</td> </tr> <tr> <td>2 PLACES</td> <td>± ---</td> <td>± ---</td> </tr> <tr> <td>1 PLACE</td> <td>± ---</td> <td>± ---</td> </tr> <tr> <td>0 PLACE</td> <td>±</td> <td>±</td> </tr> </tbody> </table>		mm	INCH	4 PLACES	± ---	± ---	3 PLACES	± ---	± ---	2 PLACES	± ---	± ---	1 PLACE	± ---	± ---	0 PLACE	±	±	DIMENSION STYLE IN/MM	SCALE 4:1	DESIGN UNITS INCH	THIRD ANGLE PROJECTION
		mm	INCH																					
	4 PLACES	± ---	± ---																					
	3 PLACES	± ---	± ---																					
	2 PLACES	± ---	± ---																					
1 PLACE	± ---	± ---																						
0 PLACE	±	±																						
DRAWN BY: PGIBLIN DATE: 2005/10/24 CHECKED BY: DATE:		APPROVED BY: DATE: 2012/03/21		TITLE FC CONNECTOR WITH 90D BOOT																				
MATERIAL NO. SEE TABLE		DOCUMENT NO. SD-106053-ZZZO		SHEET NO. 1 OF 1																				
ANGULAR ±1/2° DRAFT WHERE APPLICABLE MUST REMAIN WITHIN DIMENSIONS																								
THIS DRAWING CONTAINS INFORMATION THAT IS PROPRIETARY TO MOLEX INCORPORATED AND SHOULD NOT BE USED WITHOUT WRITTEN PERMISSION																								